

STATE OF KANSAS  
STATE CORPORATION COMMISSION

Form CP-4

Give All Information Completely  
Make Required Affidavit  
Mail or Deliver Report to:  
Conservation Division  
State Corporation Commission  
P. O. Box 17027  
Wichita, Kansas 67217

WELL PLUGGING RECORD

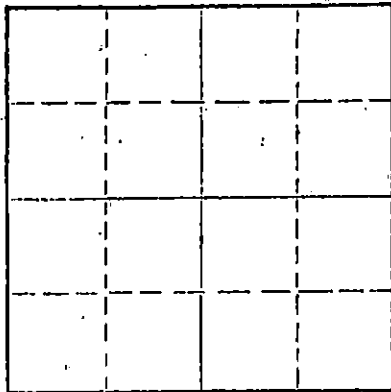

Locate well correctly on above  
Section Plat

Pratt County, Sec. 21 Twp. 27S Rge. 11W (EX) (W)  
Location as "NE/CNW/SW" or footage from lines C NW NW  
Lease Owner Gemini Oil Company  
Lease Name Swisher Well No. 1  
Office Address 1408 Philtower, Tulsa, Oklahoma 74108  
Character of Well (completed as Oil, Gas or Dry Hole) Dry Hole  
Date well completed August 25, 1973 19  
Application for plugging filed August 24, 1973 19  
Application for plugging approved August 24, 1973 19  
Plugging commenced 7:00 AM, August 25, 1973 19  
Plugging completed 9:00 AM, August 24, 1973 19  
Reason for abandonment of well or producing formation Dry Hole

If a producing well is abandoned, date of last production 19  
Was permission obtained from the Conservation Division or its agents before plugging was commenced? Yes

Name of Conservation Agent who supervised plugging of this well G. R. Biberstein  
Producing formation \_\_\_\_\_ Depth to top \_\_\_\_\_ Bottom \_\_\_\_\_ Total Depth of Well 3995' Feet  
Show depth and thickness of all water, oil and gas formations.

OIL, GAS OR WATER RECORDS

CASING RECORD

FORMATION	CONTENT	FROM	TO	SIZE	PUT IN	PULLED OUT
				8 5/8"	271.75'	None

Describe in detail the manner in which the well was plugged, indicating where the mud fluid was placed and the method or methods used in introducing it into the hole. If cement or other plugs were used, state the character of same and depth placed, from \_\_\_\_\_ feet to \_\_\_\_\_ feet for each plug set.

Filled hole with heavy mud.  
Heavy mud to 240', set Howco plug and hulls -  
25 sacks cement. Filled hole to 40', set Howco  
plug and hulls - 15 sacks cement.

RECEIVED  
STATE CORPORATION COMMISSION

9-17-73 SEP 17 1973

CONSERVATION DIVISION  
Wichita, Kansas

(If additional description is necessary, use BACK of this sheet)

Name of Plugging Contractor Sterling Drilling Company  
Address P. O. Box 129, Sterling, Kansas 67579

STATE OF KANSAS, COUNTY OF RICE, ss.  
F. A. Wuellner (employee of owner) or (owner or operator) of the above-described well, being first duly sworn on oath, says: That I have knowledge of the facts, statements, and matters herein contained and the log of the above-described well as filed and that the same are true and correct. So help me God. STERLING DRILLING COMPANY

(Signature) *F. A. Wuellner*  
F. A. Wuellner, Secretary  
P. O. Box 129, Sterling, Kansas 67579  
(Address)

SUBSCRIBED AND SWORN TO before me this 28th day of August, 1973

*Bernard Laudermilk*  
Bernard Laudermilk, Notary Public.

My commission expires  
BERNARD LAUDERMILK - NOTARY PUBLIC  
My Commission Expires Jan. 22, 1974

**KANSAS DRILLERS LOG**

**IMPORTANT**  
Kans. Geo. Survey request  
samples on this well.

S. 21 T. 27 R. 11 <sup>K</sup>/<sub>W</sub>

Loc. C NW NW

County Pratt

API No. 15 — 151 — 20,213  
County Number

Operator Gemini Oil Co.

Address 1408 Philtower Building  
Tulsa, Oklahoma

Well No. #1 Lease Name Swisher

Footage Location 660 660  
feet from (N) line feet from (W) line

Principal Contractor Sterling Drilling Co. Geologist Allen Siemens

Spud Date August 14, 1973 Total Depth 3995 P.B.T.D. --

Date Completed August 25, 1973 Oil Purchaser --

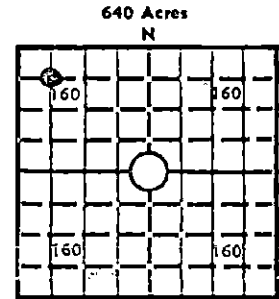

Locate well correctly  
Elev.: Gr. 1830

DF -- KB --

**CASING RECORD**

Report of all strings set—surface, intermediate, production, etc.

Purpose of string	Size hole drilled	Size casing set (in O.D.)	Weight lbs/ft.	Setting depth	Type cement	Sacks	Type and percent additives
Surface	12 $\frac{1}{4}$	8-5/8	28#	271.75	Regular	250	3% Calcium Chloride

**LINER RECORD**

**PERFORATION RECORD**

Top, ft.	Bottom, ft.	Sacks cement	Shots per ft.	Size & type	Depth interval
--			--		

Size	Setting depth	Packer set at
--		

**ACID, FRACTURE, SHOT, CEMENT SQUEEZE RECORD**

Amount and kind of material used	Depth interval treated

**INITIAL PRODUCTION**

Date of first production <u>D&amp;A</u>		Producing method (flowing, pumping, gas lift, etc.)			
RATE OF PRODUCTION PER 24 HOURS	Oil	Gas	Water	Gas-oil ratio	
	bbls.	MCF	bbls.	CFPB	
Disposition of gas (vented, used on lease or sold)			Producing interval (s)		

INSTRUCTIONS: As provided in KCC Rule 82-2-125, within 90 days after completion of a well, one completed copy of this Drillers Log shall be transmitted to the State Geological Survey of Kansas, 4150 Monroe Street, Wichita, Kansas 67209. Copies of this form are available from the Conservation Division, State Corporation Commission, 3830 So. Meridian (P.O. Box 17027), Wichita, Kansas 66217. Phone AC 316-522-2206. If confidential custody is desired, please note Rule 82-2-125. Drillers Logs will be on open file in the Oil and Gas Division, State Geological Survey of Kansas, Lawrence, Kansas 66044.

Operator \_\_\_\_\_ DESIGNATE TYPE OF COMP.: OIL, GAS, DRY HOLE, SWDW, ETC.:

Well No. 1 Lease Name Swisher Dry Hole

S 21 T 27 R 11 ~~EX~~ W

**WELL LOG**

Show all important zones of porosity and contents thereof; cored intervals, and all drill-stem tests, including depth interval tested, cushion used, time tool open, flowing and shut-in pressures, and recoveries.

SHOW GEOLOGICAL MARKERS, LOGS RUN, OR OTHER DESCRIPTIVE INFORMATION.

FORMATION DESCRIPTION, CONTENTS, ETC.	TOP	BOTTOM	NAME	DEPTH
Clay, sand & red beds	0	279	Electric Log Tops	
Shale & red bed	279	1100	Herington	1826 (+4)
Lime & Shale	1100	2625	Winfield	1900 (-70)
Sand, Shale & Lime	2625	2665	Cottonwood	2346 (-516)
Lime & Shale	2665	3080	Red Eagle	2475 (-645)
Lime	3080	3190	Tarkio	2772 (-942)
Lime, Chert & Shale	3190	3295	Heebner	3471 (-1641)
Lime & Shale	3295	3715	Brown	
Lime	3715	3995 TD	Limestone	3641 (-1811)
			Lansing	3664 (-1834)

Ran Welex Radiation-Guard & Density Logs (Copy enclosed)  
 Ran 3 Halliburton drill stem tests on Lansing zones (Charts enclosed)

DST#1 3740-75 30Min/30/30/30  
 Recovered 75 rotary mud  
 HP 1998 lbs/IFP 35/CIP 629  
 FFP 43/CIP 515/HP 1989  
 DST #2 3824-50 30 min./30/60/60  
 Rec 3730' gas in pipe. 400 oil & gas cut mud 135 salt water  
 HP 2068 lbs. FP 70 CIP 400  
 FP 227 CIP 1259 HP 2042  
 DST #3 3960-80 60 min/60  
 Recovered 30 rotary mud HP 2121 lbs.  
 FP 17-35 SIP 1145 HP 2104

**RECEIVED**  
 STATE CORPORATION COMMISSION

SEP 17 1973

CONSERVATION DIVISION  
 Wichita, Kansas

USE ADDITIONAL SHEETS, IF NECESSARY, TO COMPLETE WELL RECORD.

Date Received \_\_\_\_\_

  
 Signature  
 President  
 Title  
 9/10/73  
 Date

ENCLOSURE

STERLING DRILLING COMPANY  
P. O. Box 129  
Sterling, Kansas 67579

WELL LOG ----- SWISHER #1  
Located: C NW NW, Section 21-27S-11W, Pratt County, Kansas

OWNER: Gemini Oil Company  
ROTARY DRILLING CONTRACTOR: Sterling Drilling Company

COMMENCED: August 14, 1973  
COMPLETED: August 25, 1973

TOTAL DEPTH: 3995'

<u>LOG</u>	<u>CASING RECORD</u>
0 - 279 Clay, Sand & Red Bed	Ran 6 joints of 8 5/8" 28# used seamless casing, 269.25' pipe set at 271.75' GL. cemented with 250 sacks regular with 3% cc. Plug down at 11:00 PM, 8/14/73.
279 - 1100 Shale and Red Bed	
1100 - 2625 Lime and Shale	
2625 - 2665 Sand, Shale and Lime	
2665 - 3080 Lime and Shale	
3080 - 3190 Lime	
3190 - 3295 Lime, Chert, Shale	
3295 - 3415 Lime and Shale	
3415 - 3515 Lime, Chert, Sand	
3515 - 3715 Lime and Shale	
3715 - 3995 Lime	Plugged.

RECEIVED  
STATE CORPORATION COMMISSION

SEP 17 1973

CONSERVATION DIVISION  
Wichita, Kansas