

Give All Information Completely
Make Required Affidavit
Mail or Deliver Report to:
Conservation Division
State Corporation Commission
211 No. Broadway
Wichita, Kansas

WELL PLUGGING RECORD

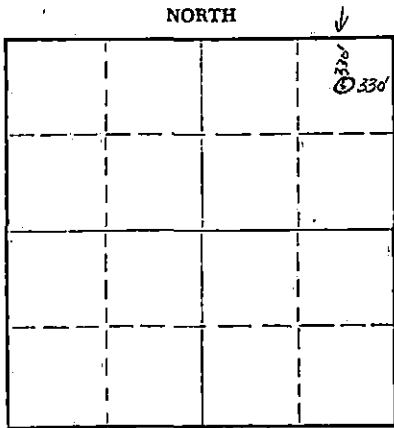

Pratt County, Sec. 34 Twp. 26S Rge. (E) 11 (W)
Location as "NE/CNW/SW" or footage from lines NE NE NE
Lease Owner Cleary Petroleum, Inc.
Lease Name Nicklin Well No. 1-34
Office Address 310 Kermac Building, Oklahoma City, Oklahoma 73102
Character of Well (completed as Oil, Gas or Dry Hole) Dry hole
Date well completed 6-16 1966
Application for plugging filed 6-16 1966
Application for plugging approved 6-20 1966
Plugging commenced 6-16 1966
Plugging completed 6-16 1966
Reason for abandonment of well or producing formation Dry Hole

If a producing well is abandoned, date of last production ---- 19
Was permission obtained from the Conservation Division or its agents before plugging was commenced? Yes

Name of Conservation Agent who supervised plugging of this well Archie Elving, Pratt, Kansas
Producing formation ----- Depth to top --- Bottom --- Total Depth of Well 4565 Feet
Show depth and thickness of all water, oil and gas formations.

OIL, GAS OR WATER RECORDS

CASING RECORD

FORMATION	CONTENT	FROM	TO	SIZE	PUT IN	PULLED OUT

Describe in detail the manner in which the well was plugged, indicating where the mud fluid was placed and the method or methods used in introducing it into the hole. If cement or other plugs were used, state the character of same and depth placed, from _____ feet to _____ feet for each plug set.

Heavy mud to 400'. Wooden plug @ 400' w/ 1/2 sack hulls on top of wooden plug, then 25 sacks cement. Heavy mud to 40'. Wooden plug, 1/2 sack hulls, 10 sx. cement. Rat hole plugged with 2' sx cement.

RECEIVED
STATE CORPORATION COMMISSION

JUN 23 1966

CONSERVATION DIVISION
Wichita, Kansas

(If additional description is necessary, use BACK of this sheet)

Name of Plugging Contractor Garvey Drilling Company
Address R. R. #2, Great Bend, Kansas

STATE OF Oklahoma, COUNTY OF Oklahoma, ss.
Cleary Petroleum, Inc. (employee of owner) or (owner or operator) of the above-described well, being first duly sworn on oath, says: That I have knowledge of the facts, statements, and matters herein contained and the log of the above-described well as filed and that the same are true and correct. So help me God.

(Signature) Jack Richardson
Jack Richardson, Engineer
310 Kermac Building, Oklahoma City, Oklahoma
(Address)

SUBSCRIBED AND SWORN TO before me this 22nd day of June, 19 66

My commission expires 2-4-68

Judy C. Mills
Notary Public.