

7/12/90

SIDE ONE

STATE CORPORATION COMMISSION OF KANSAS
OIL & GAS CONSERVATION DIVISION
WELL COMPLETION OR RECOMPLETION FORM
ACO-1 WELL HISTORY
DESCRIPTION OF WELL AND LEASE

API NO. 15-185-22,585-0000
County... Stafford
NW NW SW Sec. 27 Twp. 25S Rge. 13 East
West

Operator: License # 6111
Name INEP Company, Inc. *Peter Morland*
Address P.O. Box 506
City/State/Zip Russell, KS 67665-0506

2310 Ft North from Southeast Corner of Section
4950 Ft West from Southeast Corner of Section
(Note: Locate well in section plat below)

Purchaser

Lease Name Shore Well # 1-27

Operator Contact Person Peter Morland
Phone (303)-825-0120

Field Name
Producing Formation

Contractor: License # 8241
Name Emphasis Oil Operations

Elevation: Ground 1930' KB 1935'

Wellsite Geologist Peter Morland
Phone (303)-825-0120

Designate Type of Completion
 New Well Re-Entry Workover
 Oil SWD Temp Abd
 Gas Inj Delayed Comp.
 Dry Other (Core, Water Supply etc.)
If OWWO: old well info as follows:
Operator
Well Name
Comp. Date Old Total Depth

KANSAS GEOLOGICAL SURVEY
WICHITA BRANCH
JUL 26 1990

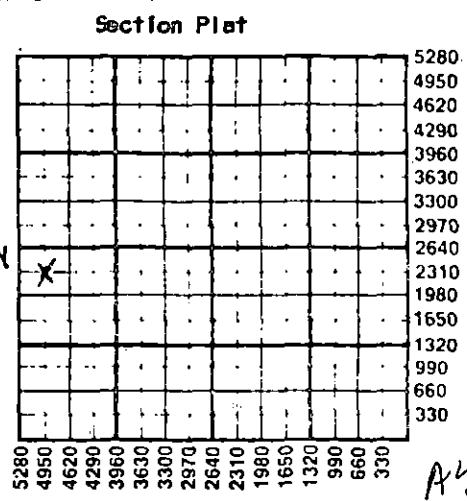

ALT I
DIA

WELL HISTORY

Drilling Method:
 Mud Rotary Air Rotary Cable
4/8/89 4/16/89 4-16-89
Spud Date Date Reached TD Completion Date
4370' PBD
Total Depth
Amount of Surface Pipe Set and Cemented at 243 feet
Multiple Stage Cementing Collar Used? Yes No
If yes, show depth set feet
If alternate 2 completion, cement circulated from feet depth to w/ SX cmt
Cement Company Name
Invoice #

WATER SUPPLY INFORMATION
Disposition of Produced Water: Disposal
Docket # Repressuring

Questions on this portion of the ACO-1 call:
Water Resources Board (913) 296-3717
Source of Water:
Division of Water Resources Permit #
 Groundwater 2310 Ft North from Southeast Corner (Well) 4950 Ft West from Southeast Corner of Sec 27 Twp 25S Rge 13 East West
 Surface Water Ft North from Southeast Corner (Stream, pond etc) Ft West from Southeast Corner Sec Twp Rge East West
 Other (explain) (purchased from city, R.W.D. #)

INSTRUCTIONS: This form shall be completed in triplicate and filed with the Kansas Corporation Commission, 200 Colorado Derby Building, Wichita, Kansas 67202, within 120 days of the spud date of any well. Rule 82-3-130, 82-3-107 and 82-3-106 apply. Information on side two of this form will be held confidential for a period of 12 months if requested in writing and submitted with the form. See rule 82-3-107 for confidentiality in excess of 12 months. One copy of all wireline logs and drillers time log shall be attached with this form. Submit CP-4 form with all plugged wells. Submit CP-111 form with all temporarily abandoned wells.

All requirements of the statutes, rules and regulations promulgated to regulate the oil and gas industry have been fully complied with and the statements herein are complete and correct to the best of my knowledge.

Signature *Peter Morland*
Title President Date 7-10-89

Subscribed and sworn to before me this 10th day of July 1989
Notary Public
Date Commission Expires 8-23-90

K.C.C. OFFICE USE ONLY
 Letter of Confidentiality Attached
 Wireline Log Received
 Drillers Time Log Received
Distribution
 KCC SWD/Rep NGPA
 KGS Plug Other
(Specify)

RECEIVED
JUL 12 1989

Operator Name N-B Company, Inc. Lease Name Shore Well # 1-27

Sec. 27 Twp. 25S Rge. 13 East West County Stafford

RELEASED

WELL LOG

SEP 10 1990

INSTRUCTIONS: Show important tops and base of formations penetrated. Detail all cores. Report all drill stem tests giving interval tested, time tool open and closed, flowing and shut-in pressure, formation pressure, pressure reached static level, hydrostatic pressures, bottom hole temperature, fluid recovery, and flow rates if gas to surface during test. Attach extra sheet if more space is needed. Attach copy of log.

Drill Stem Tests Taken Yes No
 Samples Sent to Geological Survey Yes No
 Cores Taken Yes No

Formation Description
 Log Sample

DST# 1 3843-3854 ("H" zone)
 Times: 15-30-45-90
 Rec: 960' GIP, 15' M&Wtr cut oil, 60' VSOCM & Wtr, 120' SM Wtr w/Tr oil
 IH 1869# FF 77-99# BHT 117°F
 IF 44-55# FSI 1057#
 ISI 1057# FH 1858#

DST# 2 4087-4115 (Miss)
 Times: 15-30-45-90
 Rec: 200' GIP, 30' Mud w/ Tr of oil
 IH 2012# FF 44-33# BHT 118°F
 IF 55-44# FSI 154# ISI 88# FH 2001#

DST# 3 4276 4288 (Simpson)
 Times: 15-30-15-30
 Rec: 30' Mud, no show of oil or gas
 IH 2099# FF 44-33# BHT 112°F
 IF 44-33# FSI 1460# ISI 1463# FH 2056#

Name	Top	Bottom
Anhy	792	816
Hebner	3522	3525
Toronto	3536	3561
Douglas	3561	3675
Brown Lime	3675	3683
Lansing	3707	
Base KC		3994
Miss	4085	4111
Kinderhook	4111	4173
Viola	4173	4278
Simpson	4278	4347
Arbuckle	4347	Not Reached
TD	4370	

CASING RECORD New Used
 Report all strings set-conductor, surface, intermediate, production, etc.

Purpose of String	Size Hole Drilled	Size Casing Set (In O.D.)	Weight Lbs/Ft.	Setting Depth	Type of Cement	#Sacks Used	Type and Percent Additives
SURFACE	12 1/4"	8 5/8"	20 #	243'	60/40 Pcs	165	3% CC, 2% Gel

PERFORATION RECORD

Shots Per Foot	Specify Footage of Each Interval Perforated	Acid, Fracture, Shot, Cement Squeeze Record (Amount and Kind of Material Used)	Depth

TUBING RECORD

Size	Set At	Packer at	Liner Run	<input type="checkbox"/> Yes <input type="checkbox"/> No

Date of First Production: _____ Producing Method: Flowing Pumping Gas Lift Other (explain) _____

Estimated Production Per 24 Hours	Oil Bbls	Gas MCF	Water Bbls	Gas-Oil Ratio	Gravity CFPB

METHOD OF COMPLETION

Production Interval

Disposition of gas: Vented Open Hole Perforation
 Sold Other (Specify) _____
 Used on Lease Dually Completed _____
 Commingled _____