

Expected Spud Date July 15, 1991 month day year
 C- N/2 NW Sec 29 Twp 25 S, Rg 9 East West

OPERATOR: License # 30561
 Name: WILDCAT OIL & GAS, INC.
 Address: P. O. Box 90
 City/State/Zip: Lyons, Kansas 67554
 Contact Person: Bill Chew
 Phone: 316/257-5587

4620 feet from South line of Section
3960 feet from East line of Section
 (Note: Locate well on Section Plat on Reverse Side)

County: Reno
 Lease Name: Schmucker Well #: 1
 Field Name: Unknown
 Is this a Prorated Field? ... yes no
 Target Formation(s): Viola
 Nearest lease or unit boundary: 660'
 Ground Surface Elevation: 1699' feet MSL
 Domestic well within 330 feet: ... yes no
 Municipal well within one mile: ... yes no
 Depth to bottom of fresh water: 80'
 Depth to bottom of usable water: 130'
 Surface Pipe by Alternate: 1 2
 Length of Surface Pipe Planned to be set: 150'
 Length of Conductor pipe required: N/A
 Projected Total Depth: 4100'
 Formation at Total Depth: Viola
 Water Source for Drilling Operations:
 ... well ... farm pond other

CONTRACTOR: License #: 5929
 Name: DUKE DRILLING CO. INC.

Well Drilled For: Well Class: Type Equipment:
 Oil ... Inj Infield Mud Rotary
 Gas ... Storage ... Pool Ext. ... Air Rotary
 OWWO ... Disposal ... Wildcat ... Cable
 Seismic; ... # of Holes

If OWWO: old well information as follows:
 Operator: _____
 Well Name: _____
 Comp. Date: _____ Old Total Depth _____

Directional, Deviated or Horizontal wellbore? ... yes no
 If yes, total depth location: _____

WAS: Operator = Chew Oil & Gas # 6153

IS: Operator = Wildcat Oil & Gas # 30561

AFFIDAVIT

The undersigned hereby affirms that the drilling, completion and eventual plugging of this well will comply with K.S.A. 55-101, et. seq.

- It is agreed that the following minimum requirements will be met:
1. The appropriate district office shall be notified before setting surface pipe;
 2. The minimum amount of surface pipe as specified above shall be set by circulating cement to the top; in all cases surface pipe shall be set through all unconsolidated materials plus a minimum of 20 feet into the underlying formation;
 3. If the well is dry, a plugging proposal shall be submitted to the district office. An agreement between the operator and the district office on plug length and placement is necessary prior to plugging;
 4. The appropriate district office will be notified before well is either plugged or production casing is cemented in;
 5. If an Alternate II completion, production pipe shall be cemented from below any usable water to surface within 120 days of spud date. In all cases, notify district office prior to any cementing.
- I hereby certify that the statements made herein are true and to the best of my knowledge and belief.

Date: July 15, 1991. Signature of Operator or Agent: Sally R. Byers Title: Agent

**WAS: #6153
 Chew Oil & Gas Co.

FOR KCC USE:
 API # 15- 155-21,172-0000
 Conductor pipe required None feet
 Minimum surface pipe required 150 feet per Alt. 1
 Approved by: MWD 7-22-91, Aug 7-12-91
 EFFECTIVE DATE: 7-17-91
 This authorization expires: 1-12-92
 (This authorization void if drilling not started within 6 months of effective date.)
 Spud date: _____ Agent: _____

RECEIVED
 STATE CONSERVATION COMMISSION
 JUL 15 1991
 CONSERVATION DIVISION
 Wichita, Kansas
29 25 91

B

REMEMBER TO:

- File Drill Pit Application (form CDP-1) with Intent to Drill;
- File Completion Form ACO-1 within 120 days of spud date;
- File acreage attribution plat according to field proration orders;
- Notify appropriate district office 48 hours prior to workover or re-entry;
- Submit plugging report (CP-4) after plugging is completed;
- Obtain written approval before disposing or injecting salt water.

PLAT OF ACREAGE ATTRIBUTABLE TO A WELL

State Corporation Commission, Conservation Division
200 Colorado Derby Bldg. Wichita, Kansas 67202

** OPERATOR WILDCAT OIL & GAS, INC. LOCATION OF WELL:
 LEASE Schmucker 4620 feet north of SE corner
 WELL NUMBER 1 3960 feet west of SE corner
 FIELD Unknown NW/4 Sec. 29 T 25S R 9 ~~W~~
 COUNTY Reno
 NO. OF ACRES ATTRIBUTABLE TO WELL 10 IS SECTION X REGULAR IRREGULAR?
 DESCRIPTION OF ACREAGE NW/4 IF IRREGULAR, LOCATE WELL FROM NEAREST
 CORNER BOUNDARY.

NOTE: If plat depicted is insufficient for your circumstances, you may attach your own scaled or surveyed plat.

PLAT

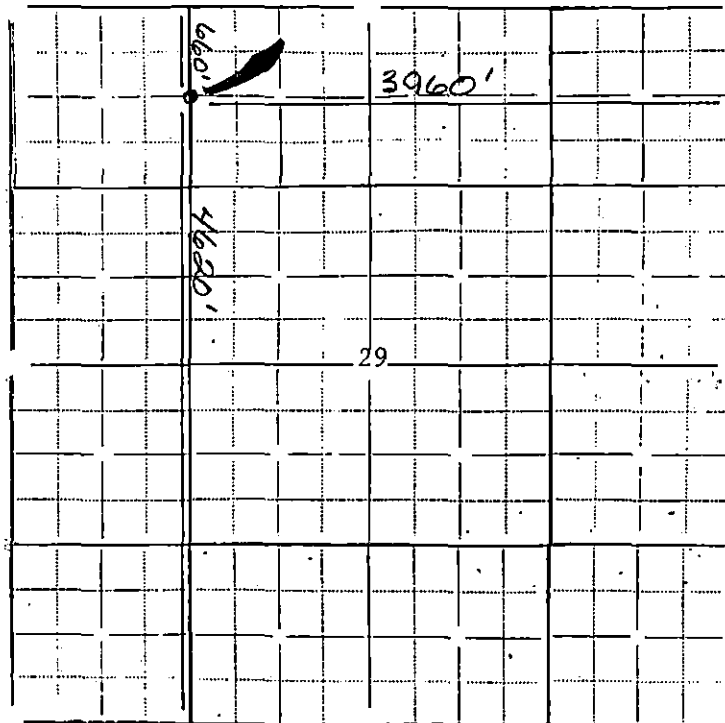

In plotting the proposed location of the well, you must show:

- 1) The manner in which you are using the depicted plat by identifying section lines, i.e. 1 section, 1 section with 8 surrounding partial sections, 4 sections, 16 sections, etc.;
- 2) the well's location relative to the location of other wells producing from the same common source of supply in adjoining drilling units, pursuant to K.A.R. 82-3-108, 82-3-207, 82-3-312, or special orders of the Commission;
- 3) the distance of the proposed drilling location from the section's east and south lines; and
- 4) the distance to the nearest lease or unit boundary line.

I hereby certify that the statements made herein are true and to the best of my knowledge and belief.

Signature of Operator or Agent Sally G. Byers
 Date July 15, 1991 Title Agent