

STATE CORPORATION COMMISSION OF KANSAS
OIL & GAS CONSERVATION DIVISION
WELL COMPLETION OR RECOMPLETION FORM
ACO-1 WELL HISTORY
DESCRIPTION OF WELL AND LEASE

Operator: License # 06838
Name Africa Exploration Inc. LTD.
Address 2225 E. 21st
Wichita, Kansas
City/State/Zip 67214

Purchaser Continental Oil Company
Ponca City, Oklahoma

Operator Contact Person Mike Hanson
Phone (316) 463-6785

Contractor: License # 5107
Name H-30 Drilling

Wellsite Geologist Donald J. Mclland
Phone (316) 241-7947

Designate Type of Completion
 New Well Re-Entry Workover
 Oil SWD Temp Abd
 Gas Inj Delayed Comp.
 Dry Other (Core, Water Supply etc.)

If OWWO: old well info as follows:
Operator
Well Name
Comp. Date Old Total Depth.....

WELL HISTORY

Drilling Method:
 Mud Rotary Air Rotary Cable

8-29-81 10-6-81 10-21-81
Spud Date Date Reached TD Completion Date
3368
Total Depth PBD

Amount of Surface Pipe Set and Cemented at 408 feet
Multiple Stage Cementing Collar Used? Yes No
If yes, show depth set.....feet
If alternate 2 completion, cement circulated
from.....feet depth to 408 w/ 325 SX cmt
Cement Company Name Halliburton
Invoice # 117977

API NO. 15-155-20,801-0000

County RENO

SE SE SW Sec. 8 Twp. 24 Rge. 4 East
KE-KE West

330 Ft North from Southeast Corner of Section
210378 Ft West from Southeast Corner of Section
(Note: Locate well in section plat below)

Lease Name STONE Well # 4

Field Name BURTON

Producing Formation MISSISSIPPIAN-DSAGE

Elevation: Ground 1476 KB 1481

Section Plat

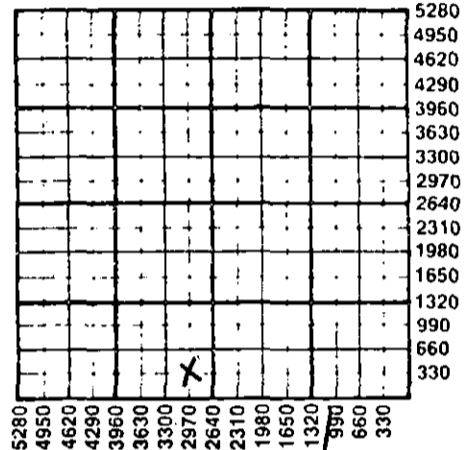

WATER SUPPLY INFORMATION

Disposition of Produced Water: Disposal
Docket # CD-28251 Repressuring

Questions on this portion of the ACO-1 call:

Water Resources Board (913) 296-3717
Source of Water:
Division of Water Resources Permit # T.81-635

1 Groundwater 330 Ft North from Southeast Corner
(Well) 210378 Ft West from Southeast Corner of
Sec. 8 Twp. 24 Rge. East 4 West
Surface Water.....Ft North from Southeast Corner
(Stream, pond etc).....Ft West from Southeast Corner
Sec. 8 Twp. 24 Rge. East 4 West
Other (explain).....
(purchased from city, R.W.D. #)

INSTRUCTIONS: This form shall be completed in triplicate and filed with the Kansas Corporation Commission, 200 Colorado Derby Building, Wichita, Kansas 67202, within 120 days of the spud date of any well. Rule 82-3-130, 82-3-107 and 82-3-106 apply.
Information on side two of this form will be held confidential for a period of 12 months if requested in writing and submitted with the form. See rule 82-3-107 for confidentiality in excess of 12 months.
One copy of all wireline logs and drillers time log shall be attached with this form. Submit CP-4 form with all plugged wells. Submit CP-111 form with all temporarily abandoned wells.

All requirements of the statutes, rules and regulations promulgated to regulate the oil and gas industry have been fully complied with and the statements herein are complete and correct to the best of my knowledge.

Signature [Signature]
Title Vice President Date 7-19-86

Subscribed and sworn to before me this 17th day of July
1986
Notary Public [Signature]
Date Commission Expires Nov. 13, 1988

EVELYN P. HORTON
NOTARY PUBLIC
STATE OF KANSAS
My Appt. Exp. 11-13-88

K.C.C. OFFICE USE ONLY
F Letter of Confidentiality Attached
C Wireline Log Received
C Drillers Timelog Received
Distribution
 KCC SWD/Rep NGPA
 KGS Plug Other
(Specify)
STATE CORPORATION COMMISSION

Form ACO-1 (5-86) 7

CONSERVATION DIVISION
Wichita, Kansas

SEP 25 1986
9-25-86

Sec. 8 Twp. 24 Rge. 4E

Operator Name Africa Exploration Inc. LTD Lease Name STONE Well # 4

Sec. 8 Twp. 24 Rge. 4 East West County RENO

WELL LOG

INSTRUCTIONS: Show important tops and base of formations penetrated. Detail all cores. Report all drill stem tests giving interval tested, time tool open and closed, flowing and shut-in pressures, whether shut-in pressure reached static level, hydrostatic pressures, bottom hole temperature, fluid recovery, and flow rates if gas to surface during test. Attach extra sheet if more space is needed. Attach copy of log.

Drill Stem Tests Taken Yes No
 Samples Sent to Geological Survey Yes No
 Cores Taken Yes No

Formation Description
 Log Sample

Name	Top	Bottom
MISSISSIPPIAN	3312	
OSAGE	3354	
RTD	3360	

CASING RECORD <input checked="" type="checkbox"/> New <input type="checkbox"/> Used							
Report all strings set-conductor, surface, intermediate, production, etc.							
Purpose of String	Size Hole Drilled	Size Casing Set (in O.D.)	Weight Lbs/Ft.	Setting Depth	Type of Cement	#Sacks Used	Type and Percent Additives
Surface Production	12 1/4	8 3/8 5 1/2	25 14 1/2	400 3356	COMMON SXB	325 75	3% CAL. CHL. 2% GEL
PERFORATION RECORD				Acid, Fracture, Shot, Cement Squeeze Record			
Shots Per Foot	Specify Footage of Each Interval Perforated			(Amount and Kind of Material Used)		Depth	
				10000 lbs. SAND		3368	
				5000 BBLS. SALT-WATER			
				Pressure 1050			
TUBING RECORD				Liner Run <input type="checkbox"/> Yes <input type="checkbox"/> No			
Size	Set At	Packer at					
2 1/2	3364						
Date of First Production		Producing Method					
10-31-81		<input type="checkbox"/> Flowing <input checked="" type="checkbox"/> Pumping <input type="checkbox"/> Gas Lift <input type="checkbox"/> Other (explain).....					
Estimated Production Per 24 Hours	Oil	Gas	Water	Gas-Oil Ratio	Gravity		
	8.31 Bbls	TRACE MCF	19. Bbls		39 CFPB		

METHOD OF COMPLETION

Production Interval

Disposition of gas: Vented Open Hole Perforation
 Sold Other (Specify)
 Used on Lease Dually Completed
 Commingled