

15-047-20869-0000

WELL PLUGGING RECORD

Give All Information Completely  
 Make Required Affidavit

COUNTY EDWARDS SEC. 21 TWP. 26S RGE. 16 EW  
 Location as in quarters or footage from lines:

2140' FWL & 2310' ESL

Lease Owner BENSON MINERAL GROUP, INC.

Lease Name SCHULTZ M Well No. 1-21

Office Address 1726 CHAMPA ST., SUITE 600 DENVER, COLO. 80202

Character of Well (Completed as Oil, Gas or Dry Hole): OIL

Date Well Completed 7-20-81

Application for plugging filed 8-16-82

Plugging commenced 9-21-82

Plugging completed 9-23-82

Reason for abandonment of well or producing formation DRY

Locate Well  
 correctly on above  
 Section Platt.

Was permission obtained from the Conservation Division or it's  
 Agent's before plugging was commenced? YES

Name of Conservation Agent who supervised plugging of this well STEVE DURRANT

Producing formation \_\_\_\_\_ Depth to top \_\_\_\_\_ bottom \_\_\_\_\_ T.D. 4675'

Show depth and thickness of all water, oil and gas formations.

OIL, GAS OR WATER RECORDS

Casing Record

Formation	Content	From	To	Size	Put in	Pulled Out
				4 1/2"		2,787.40'

Describe in detail the manner in which the well was plugged, indicating where the mud  
 fluid was placed and the method or methods used in introducing it into the hold. If cement  
 or other plugs were used, state the character of same and depth placed, from \_\_\_\_\_ feet  
 to \_\_\_\_\_ feet for each plug set.

SET BOTTOM PLUG AT 4480' - 15' ROCK BRIDGE 4 SX CEMENT

ALLIED CAME OUT 9-27-82 AND FILLED WITH 3 HULL- 10 JEL - 50 SX CEMENT -  
 1 HULL - 15 JEL - WOODEN PLUG - 100 SX CEMENT 50/50 POZ. 2% JEL 3% c.c.

(If additional description is necessary, use BACK of this sheet)

Name of Plugging Contractor H & H CASING PULLING CO.  
2900 ACRES RD. # 107 HUTCHINSON, KS. 67501

STATE OF KANSAS COUNTY OF RENO, ss.

DONALD H. HURST (employee of owner) or (owner or operator) of the  
 above-described well, being first duly sworn on oath, says: That I have knowledge of the  
 facts, statements, and matters herein contained and the log of the above-described well as  
 filed and that the same are true and correct. So help me God.

(Signature) Donald H. Hurst  
2900 Acres Rd. Apt 107  
Hutchinson, KS. (Address)

SUBSCRIBED AND SWORN to before me this 24<sup>th</sup> day of Sept., 19 82

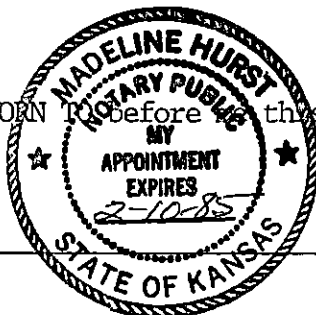

Madeline Hurst  
 STATE CORPORATION COMMISSION Notary Public.

My Commission expires: \_\_\_\_\_

OCT 04 1982 10-4-82

WELL COMPLETION REPORT AND DRILLER'S LOG

API No. 15 - 047 - 20,869-0000  
County Number

S. 21 T. 26S R. 16 K  
W  
Loc. 2140' FWL & 2310' FSL  
County Edwards

Operator Benson Mineral Group, Inc.

Address 1726 Champa St., Suite 600, Denver, CO 80202

Well No. 1-21 Lease Name Schultz M

Footage Location 2310 feet from XX(S) line 2140 feet from XX(W) line

Principal Contractor DaMac Drilling Geologist

Spud Date 5-19-81 Date Completed 7-20-81 Total Depth 4675 P.B.T.D. 4560

Directional Deviation Oil and/or Gas Purchaser

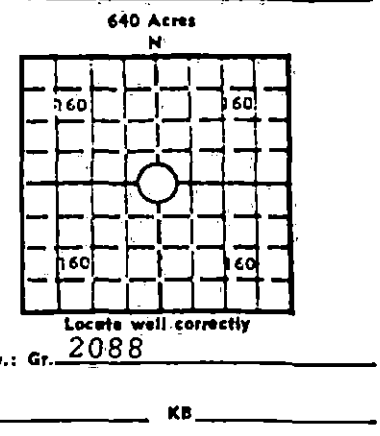

CASING RECORD

Report of all strings set — surface, intermediate, production, etc.

Purpose of string	Size hole drilled	Size casing set (in O.D.)	Weight lbs/ft.	Setting depth	Type cement	Sacks	Type and percent additives
Surface	12 1/2	8 5/8		469	60-40 POZ	400	3% CaCl
Production	7 7/8	4 1/2	10.5	4661	60-40 POZ	150	18% salt, 2% gel

LINER RECORD

PERFORATION RECORD

Top, ft.	Bottom, ft.	Sacks cement	Shots per ft.	Size & type	Depth interval
			2		4530-50

ACID, FRACTURE, SHOT, CEMENT SQUEEZE RECORD

Amount and kind of material used	Depth interval treated
SWHYF x 25000# sn, 26000 gal 30# gel water	4530-50
Pmp 10000# 20-40 sn, 15000# 10-20 sn, 1000 gal 15%	
HCl.	

INITIAL PRODUCTION

CONSERVATION DIVISION  
Wichita, Kansas

Date of first production 8-81	Producing method (flowing, pumping, gas lift, etc.) pumping
RATE OF PRODUCTION PER 24 HOURS	Oil 2 bbls. Gas 0 MCF Water 50 bbls. Gas-oil ratio CFPB
Disposition of gas (vented, used on lease or sold)	Producing interval(s)

INSTRUCTIONS: As provided in KCC Rule 82-2-125, within 90 days after completion of a well, one completed copy of this Drillers Log shall be transmitted to the State Geological Survey of Kansas, 4150 Monroe Street, Wichita, Kansas 67209. Copies of this form are available from the Conservation Division, State Corporation Commission, 245 No. Water, Wichita, Kansas 67202. Phone AC 316-522-2206. If confidential custody is desired, please note Rule 82-2-125. Drillers Logs will be on open file in the Oil and Gas Division, State Geological Survey of Kansas, Lawrence, Kansas 66044.

Phone 913-483-2627, Russell, Kansas  
 Phone 316-793-5861, Great Bend, Kansas

15-047-20864-0000  
 Phone Plainville 913-434-2812  
 Phone Kiowa 316-825-4618

# ALLIED CEMENTING CO., INC.

Home Office P. O. Box 31.

Russell, Kansas 67665

No 30721

DLD

Date	7-27-82	Sec.	21	Twp.	26	Range	16W	Called Out	5:00	On Location	11:30	Job Start	12:15	Finish	1:50
Lease	1/1/82	Well No.	1-121	Location	Toussaint Lake #25 Ploc				County	Edwards	State	KAN.			

Contractor	?
Type Job	Old Hole Plug
Hole Size	2 3/4" T.D. 4560
Csg. Size	Depth
Tbg. Size	Depth
Drill Pipe	Depth
Tool	Depth
Cement Left in Csg.	Shoe Joint
Press Max.	300 Minimum 100
Meas Line	Displace x
Perf.	

Owner	To Allied Cementing Co., Inc. You are hereby requested to rent cementing equipment and furnish cementer and helper to assist owner or contractor to do work as listed.
Charge To	B M + G
Street	
City	State
The above was done to satisfaction and supervision of owner agent or contractor.	
Purchase Order No.	X Kenneth J. Hunt

### EQUIPMENT

Pumptrk	No 65	Cementor	WESTON
		Helper	Jim
Pumptrk	No	Cementor	
		Helper	
Bulktrk	168	Driver	Russell
Bulktrk	16	Driver	Kent

<b>CEMENT</b>	
Amount Ordered	150 2 1/2 bags 3 tons
Consisting of	2 1/2 gal 4 holes
Common	
Poz. Mix	
Gel.	
Chloride	
Quickset	

<b>DEPTH of Job</b>	
Reference:	Dunn & Co #2103
	Sub Total
	Tax
	Total

Handling		Sales Tax	
Mileage	29 1982	Sub Total	
		Total	

Remarks: 100 lb cement 3 holes 10 gal 50 cement 15 gal 1 1/2" old hole plug

Floating Equipment

Thank you