

STATE CORPORATION COMMISSION OF KANSAS
OIL & GAS CONSERVATION DIVISION
WELL COMPLETION OR RECOMPLETION FORM
ACO-1 WELL HISTORY
DESCRIPTION OF WELL AND LEASE

Operator: License # 5144
Name Mull Drilling Company, Inc.
Address P.O. Box 2758
City/State/Zip Wichita, KS 67217

Purchaser Panhandle Eastern

Operator Contact Person Paul Gunzelman
Phone (316) 264-6366

Contractor: License # Blue Goose
Name Great Bend

Wellsite Geologist Roger Martin
Phone

Designate Type of Completion
New Well Re-Entry Workover

Oil Gas plugged SWD Inj Temp Abd
Dry Other (Core, Water Supply etc.)

If OWO: old well Info as follows:
Operator
Well Name
Comp. Date Old Total Depth

WELL HISTORY

Drilling Method:
Mud Rotary Air Rotary Cable
4/17/80 4/28/80 9/12/80
Spud Date Date Reached TD Completion Date
4450'
Total Depth PBTD

Amount of Surface Pipe Set and Cemented at 451 feet
Multiple Stage Cementing Collar Used? Yes X No
If yes, show depth set...feet
If alternate 2 completion, cement circulated from...feet depth to...w/...SX cmt
Cement Company Name
Invoice #

API No. 15-151-20,754-0000
County Pratt
SW...NW. NW. Sec. 17. Twp 26S. Rge 15...XX West

4290 Ft North from Southeast Corner of Section
4950 Ft West from Southeast Corner of Section
(Note: Locate well in section plat below)

Lease Name Doggett Well # 4

Field Name Hopewell (South)

Producing Formation Kinderhook

Elevation: Ground 2047 KB 2054

Section Plat

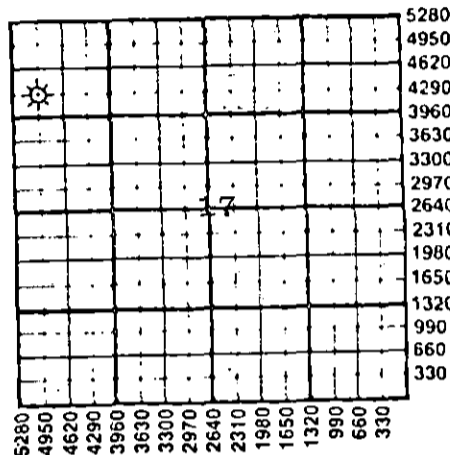

WATER SUPPLY INFORMATION

Disposition of Produced Water: X Disposal
Docket # So. Leitsburg, Stafford, KS

Questions on this portion of the ACO-1 call:

Water Resources Board (913) 296-3717

Source of Water:
Division of Water Resources Permit #

Groundwater...Ft North from Southeast Corner (Well) ...Ft West from Southeast Corner of Sec Twp Rge East West

Surface Water...Ft North from Southeast Corner (Stream, pond etc)...Ft West from Southeast Corner Sec Twp Rge East West

Other (explain) (purchased from city, R.W.D. #)

INSTRUCTIONS: This form shall be completed in duplicate and filed with the Kansas Corporation Commission, 200 Colorado Derby Building, Wichita, Kansas 67202, within 90 days after completion or recompletion of any well. Rule 82-3-130 and 82-3-107 apply.

Information on side two of this form will be held confidential for a period of 12 months if requested in writing and submitted with the form. See rule 82-3-107 for confidentiality in excess of 12 months. One copy of all wireline logs and drillers time log shall be attached with this form. Submit CP-4 form with all plugged wells. Submit CP-111 form with all temporarily abandoned wells.

All requirements of the statutes, rules and regulations promulgated to regulate the oil and gas industry have been fully complied with and the statements herein are complete and correct to the best of my knowledge.

Signature Paul M. Gunzelman
Title Geologist Date 10/1/87

PATRICIA L. UNGLEICH
NOTARY PUBLIC
STATE OF KANSAS
My Appt. Exp. 3/27/91

Subscribed and sworn to before me this 1st day of October 1987
Notary Public Patricia L. Ungleich
Date Commission Expires March 27, 1991

K.C.C. OFFICE USE ONLY
F Letter of Confidentiality Attached
C Wireline Log Received
C Drillers Timelog Received
Distribution
KCC SWD/Rep NGPA
KGS Plug Other
RECEIVED
STATE CORPORATION COMMISSION
OCT 5 1987

10-5-87

Sec 17 Twp 26 Rge 15

Sit.

MULL DRILLING COMPANY, INC.

DOGGETT

4

Operator Name Lease Name Well #.....

Sec. 17 Twp. 26S Rge. 15 [] East [X] West County PRATT

WELL LOG

INSTRUCTIONS: Show important tops and base of formations penetrated. Detail all cores. Report all drill stem tests giving interval tested, time tool open and closed, flowing and shut-in pressures, whether shut-in pressure reached static level, hydrostatic pressures, bottom hole temperature, fluid recovery, and flow rates if gas to surface during test. Attach extra sheet if more space is needed. Attach copy of log.

Drill Stem Tests Taken [] Yes [] No
Samples Sent to Geological Survey [] Yes [] No
Cores Taken [] Yes [] No

Formation Description [] Log [] Sample

Name Top Bottom

SEE ATTACHED C-10

SEE ATTACHED C-10

CASING RECORD [] New [] Used
Report all strings set-conductor, surface, intermediate, production, etc.
Purpose of String Size Hole Size Casing Weight Setting Type of #Sacks Type and Percent
Drilled Set (in O.D.) Lbs/Ft. Depth Cement Used Additives
PERFORATION RECORD Acid, Fracture, Shot, Cement Squeeze Record
Shots Per Foot Specify Footage of Each Interval Perforated (Amount and Kind of Material Used) Depth
TUBING RECORD Size Set At Packer at Liner Run [] Yes [] No
Date of First Production Producing Method [] Flowing [] Pumping [] Gas Lift [] Other (explain)
Estimated Production Per 24 Hours Oil Gas Water Gas-Oil Ratio Gravity
Bbls MCF Bbls CFPB

METHOD OF COMPLETION

Production Interval

Disposition of gas: [] Vented [] Sold [] Used on Lease

[] Open Hole [] Perforation [] Other (Specify)

[] Dually Completed [] Commingled

KANSAS DRILLERS LOG

API No. 15 — 151 — 20,754
 County Number

S. 17 T. 26S R. 15W ^E/_W
 Loc. SW/NW/NW
 County PRATT CO., KS

Operator
MULL DRILLING COMPANY, INC.

Address
 221 N Main - Suite 300 - Wichita, KS 67202

Well No. 4 Lease Name **DOGGETT**

Footage Location
 990' feet from (N) line 330' feet from ~~EE~~ (W) line

Principal Contractor **Blue Goose Drllg Co.** Geologist **Roger L. Martin**

Spud Date 4/17/80 Total Depth 4450' P.B.T.D. 4450'

Date Completed 4/29/80 Oil Purchaser

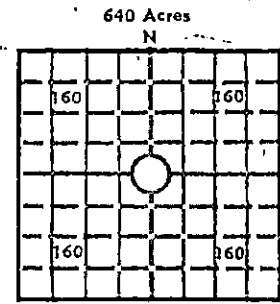

Locate well correctly
 Elev.: Gr. 2047
 DF _____ KB 2054

CASING RECORD

Report of all strings set — surface, intermediate, production, etc.

Purpose of string	Size hole drilled	Size casing set (in O.D.)	Weight lbs/ft.	Setting depth	Type cement	Sacks	Type and percent additives
Surface	12 $\frac{1}{2}$	8-5/8	20#	451'	Cmmn	325sx	3%Ch 2% gel
Production	7-7/8	4 $\frac{1}{2}$ "	10 $\frac{1}{2}$ #	4457'	50-50 poz	25sx 150 sx	10% salt

LINER RECORD

PERFORATION RECORD

Top, ft.	Bottom, ft.	Sacks cement	Shots per ft.	Size & type	Depth interval
			4		4350-4358

TUBING RECORD

Size	Setting depth	Packer set at

ACID, FRACTURE, SHOT, CEMENT SQUEEZE RECORD

Amount and kind of material used	Depth interval treated

INITIAL PRODUCTION

Date of first production <u>9/18 1980</u>	Producing method (flowing, pumping, gas lift, etc.) FLOWING
RATE OF PRODUCTION PER 24 HOURS <u>X</u>	Oil _____ Gas <u>9285 MCFG</u> Water _____ Gas-oil ratio _____ CFPB
Disposition of gas (vented, used on lease or sold) Sold	Panhandle Eastern Wellhead OpenFlow Producing interval (s) Test MISSISSIPPIAN

INSTRUCTIONS: As provided in KCC Rule 82-2-125, within 90 days after completion of a well, one completed copy of this Drillers Log shall be transmitted to the State Geological Survey of Kansas, 4150 Monroe Street, Wichita, Kansas 67209. Copies of this form are available from the Conservation Division, State Corporation Commission, 3830 So. Meridian (P.O. Box 17027), Wichita, Kansas 66217. Phone AC 316-522-2206. If confidential custody is desired, please note Rule 82-2-125. Drillers Logs will be on open file in the Oil and Gas Division, State Geological Survey of Kansas, Lawrence, Kansas 66044.

Operator MULL DRILLING COMPANY, INC.

DESIGNATE TYPE OF COMP.: OIL, GAS, DRY HOLE, SWDW, ETC.:

Well No. 4	Lease Name DOGGETT	GAS
---------------	-----------------------	-----

s 17 T 26SR 15W^E_W

WELL LOG

Show all important zones of porosity and contents thereof; cored intervals, and all drill-stem tests, including depth interval tested, cushion used, time tool open, flowing and shut-in pressures, and recoveries.

SHOW GEOLOGICAL MARKERS, LOGS RUN, OR OTHER DESCRIPTIVE INFORMATION.

FORMATION DESCRIPTION, CONTENTS, ETC.	TOP	BOTTOM	NAME	DEPTH
Winfield	2226			
Towanda	2291			
FtRiley	2343			
Heebner	3722			
BrnLime	3877			
Lansing	3890			
Stark	4114			
B/KC	4180			
Mississippi	4316			
Kinderhk	4348			
KindrhkSh	4370			
Viola	4425			
LTD	4458			
RTD	4450			
DST #1 3888-3916 / 30-45-60-60				
GTS / 7 min.				
1st: Gauge:	10 min/57,700	CFG		
	20 min/57,700			
	30 min/44,700			
2nd: Gauge:	5 min/66,600	CFG		
	10 min/44,800			
	20 min/31,600			
	30 min/28,300			
	(stabilized)			
	60 min/28,300			
Recovered: 90 feet of gas cut mud				
600 feet of gassy saltwater(Ch-159,000ppm)				
ISIP 1311 IFP 179-211 FFP 254-300 FSIP 1311 IHP 1930 FHP 1909				
DST #2 4018-4040 / 30-45-60-60 ('H' zone)				
1st Gauge:	5 min/241	MCFG		
	10 min/231			
	20 min/209			
	30 min/197			
2nd Gauge:	5 min/287	MCFG		
	10 min/278			
	20 min/241			
	30 min/197			

Cont'd

USE ADDITIONAL SHEETS, IF NECESSARY, TO COMPLETE WELL RECORD.

Date Received	
	<p><i>Robert O. Wall</i> Robert O. Wall Signature PRESIDENT Title <i>July 9</i> Date RECEIVED STATE CORPORATION COMMISSION 1980 OCT 5 1987</p>

MULL DRILLING COMPANY, INC.

221 Main - Suite 300

Wichita, Kansas 67202

DOGGETT #4
SW NW NW Sec 17-26S-15W
PRATT COUNTY, KANSAS

Contractor: Blue Goose Drill Co.
Geologist: Roger L. Martin
GL: 2047 KB: 2054

SPUD: 4/17/80
8-5/8" csg @ 451' w/ 325 sx cmmn
3% cc, 2% gel

DST #1 3888-3916 / 30-45-60-60

GTS: 7 min.

1st Gauge: 10 min/57,700 CFG
20 57,700
30 44,700
2nd Gauge: 5 66,600
10 44,800
20 31,600
30 28,300

Recovered: 90 feet of gas cut mud
600 feet of gassy saltwater (Ch= 159,000 ppm)
ISIP 1511 IFP 179-211 FFP 254-360 FSIP 1311
IHP 1930 FHP 1909

DST #2 4018-4040' / 30-45-60-60 ('H' zone)

1st Gauge: 5 min/241,000 CFG
10 231,000
20 209,000
30 197,000
2nd Gauge: 5 287,000
10 278,000
20 241,000
30 197,000
40 170,000
50 156,000
60 156,000

Rec: 5 feet slightly oil cut mud
61 feet gassy oil cut mud
61 feet very foamy gassy oil
61 feet gassy oil

Total Fluid: 188 feet

ISIP 1091 IFP 73-84 FFP 95-84
FSIP 1060 IHP 1983 FHP 1962

DST #3 4059-4096 / 30-45-60-60 ('J' zone)

Strong blow off bttm bucket/7 min.

Rec: 55 feet watery mud
62 feet muddy water
1115 feet saltwater (Ch= 136,000 ppm)

Total Fluid: 1232 feet

ISIP 1416 IFP 34-317 FFP 402-633
FSIP 1416 IHP 2035 FHP 2014

DST #4 4106-4133 / 30-45-60-60

Strong blow off bottom bucket/25 min.

Rec: 180 feet gas

Cont'd Page -2-

RECEIVED
STATE CORPORATION COMMISSION

OCT 5 1987

CONSERVATION DIVISION
Wichita, Kansas

MULL DRILLING COMPANY, INC.

DOGGETT #4
SW NW NW Sec 17-26S-15W
Pratt County, Kansas

Page -2-

DST #4 cont'd

40 feet heavy oil cut watery mud
61 feet oil spotted muddy water
122 feet oil spotted water
183 feet saltwater

Total Fluid: 406 feet
ISIP 1269 IFP 63-137 FFP 169-222
FSIP 1217

DST #5 4301-4329' / 30-45-60-60

Good blow 3" from bottom bucket
Rec: 30 feet oil spotted mud
ISIP 84 IFP 63-63 FFP 84-105 FSIP 317

DST #6 4300-4371' / 30-45-60-60

Gas to surface/ 1 min.
1st Gauge: 6379 MCFG / 5 min. 1½" orifice
6498 10
6737 20
6737 30
2nd Gauge: 5690 5 2" orifice
5690 10
5690 20
6160 30
(stabilized)
6160 60 min.

Rec: 15 feet gas cut mud
ISIP 1154 IFP 893-997 FFP 1081-1102
FSIP 1154 (gas sample saved)

E-LOG TOPS:

Winfield 2226 - 172
Towanda 2291 - 237
Ft Riley 2343 - 289
Heebner 3722 -1668
BrnLime 3877 -1823
Lansing 3890 -1836
Stark 4114 -2060
B/KC 4180 -2126
Miss 4316 -2262
Kinderhk 4348 -2294
KinderhkSh 4370 -2316
Viola 4425 -2371
LTD 4458 -2404
RTD 4450 -2396

4-1½" Production csg @ 4457'
w/ 25- sx cmmn, 150- sx 50-50 poz mix-
10% salt.

Cont'd Page -3-

RECEIVED
STATE CORPORATION COMMISSION

OCT 5 1987

CONSERVATION DIVISION
Wichita, Kansas

Mull Drilling Company, Inc.

DOGGETT #4
SW NW NW Sec 17-26S-15W
Pratt County, Kansas

Page -3-

5/22/80 Perforated 4 shots / 4350-4358'

7/25/80 Waiting on gasline hookup

9/17/80 Finished hooking up to Panhandle Eastern gasline

Panhandle Eastern Wellhead Open Flow Test: 9285 MCFG

RECEIVED
STATE CORPORATION COMMISSION

OCT 5 1987

CONSERVATION DIVISION
Wichita, Kansas

LAUGHLIN-SIMMONS & CO. OF KANSAS INC.
 OIL FIELD SURVEYING
 1337 NORTH MERIDIAN, SUITE 2
 WICHITA, KANSAS 67203

(316) 933-3351

KN04118019

INVOICE NO.

4-14-80

DATE

Pratt COUNTY 17 26s 15w LOCATION
S T R SW NW NW

Mull Drilling OPERATOR 4 NO. Doggett FARM

ELEVATION: 2047 gr

Mull Drilling Company
 221 N. Main
 Suite 300
 Wichita, Kansas 67202

AUTHORIZED BY: Pat

PHONE # _____ RUSH by 4-14

1 Mile to flagged
 "STOP" on B.T. @ Hopewell

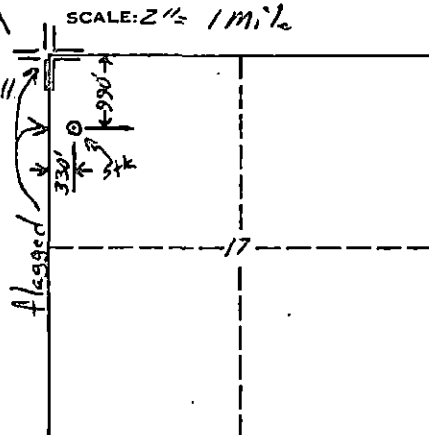

5' wood stake in
 slightly sloping wheat
 stubble

MINIMUM STAKING CHARGE: \$95.00 +50.00 Rush
 (INCLUDES GROUND ELEVATION)

EXTRA TIME & MILEAGE: _____

ELEVATION CHARGE: _____

TOTAL: \$145.00

Thank You!
[Signature]

RECEIVED
 STATE CORPORATION COMMISSION

OCT 5 1987

CONSERVATION DIVISION
 Wichita, Kansas

WELL LOG
Doggett #4
SW NW NW Sec.17-26S-15W
Pratt County, Kansas

Name of Operator: Mull Drilling Co., Inc.
221 N. Main, Suite 300
Wichita, Kansas 67202

Date Completed: April 29, 1980

<u>FROM</u>	<u>TO</u>	
0	466	Surface sand & shale
466	1825	Shale
1825	3900	Lime & shale
3900	4458	Lime
4458		Total Depth

STATE OF KANSAS

COUNTY OF BARTON ss

George E. Miller, Jr., President of Blue Goose Drilling Co., Inc. being first duly sworn on oath says: That I have knowledge of the facts statements and matters herein contained and the log of the above described well as filed and that the same are true and correct.

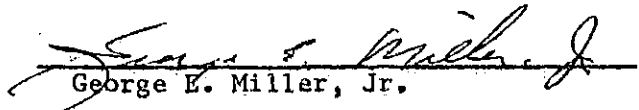
George E. Miller, Jr.

Subscribed and sworn before me this 2nd day of May, 1980.

Notary Public Barton County

My Commission Expires 8-1-81

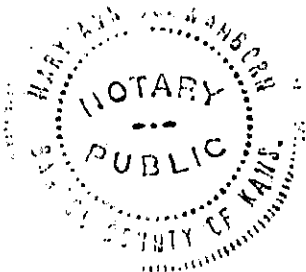

OCT 5 1987

**WORK ORDER CONTRACT
AND PRE-TREATMENT DATA**

ATTACH TO INVOICE & TICKET NO. 622507

DISTRICT Platt KS

DATE 9-15-87

TO: HALLIBURTON SERVICES YOU ARE HEREBY REQUESTED TO FURNISH EQUIPMENT AND SERVICEMEN TO DELIVER AND OPERATE

THE SAME AS AN INDEPENDENT CONTRACTOR TO: Mill Duncan (CUSTOMER)
AND DELIVER AND SELL PRODUCTS, SUPPLIES, AND MATERIALS FOR THE PURPOSE OF SERVICING

WELL NO. [REDACTED] LEASE [REDACTED] SEC. 17 TWP. 26 RANGE 15
FIELD _____ COUNTY Platt STATE KS OWNED BY _____

THE FOLLOWING INFORMATION WAS FURNISHED BY THE CUSTOMER OR HIS AGENT

FORMATION NAME	TYPE	NEW USED	WEIGHT	SIZE	FROM	TO	MAX. ALLOW. P.S.I.
FORMATION THICKNESS	FROM TO						
PACKER: TYPE	SET AT						
TOTAL DEPTH	MUD WEIGHT						
BORE HOLE							SHOTS/FT.
INITIAL PROD: OIL _____ BPD, H ₂ O _____ BPD, GAS _____ MCF							
PRESENT PROD: OIL _____ BPD, H ₂ O _____ BPD, GAS _____ MCF							
PERFORATIONS							
PERFORATIONS							
PERFORATIONS							

PREVIOUS TREATMENT: DATE _____ TYPE _____ MATERIALS _____

TREATMENT INSTRUCTIONS: TREAT THRU TUBING ANNULUS CASING TUBING/ANNULUS HYDRAULIC HORSEPOWER ORDERED.

1 1/2" WELL WITH 25 SK CASING @ 4150' Full on by 112" SPACER
Fill on by 35 SK 1000' to surface - mix (35) SK DOWN ANNULUS

CEMENT USED 105SK ECONOLITE

CUSTOMER OR HIS AGENT WARRANTS THE WELL IS IN PROPER CONDITION TO RECEIVE THE PRODUCTS, SUPPLIES, MATERIALS, AND SERVICES

THIS CONTRACT MUST BE SIGNED BEFORE WORK IS COMMENCED

As consideration, the above-named Customer agrees:

- (a) To pay Halliburton in accord with the rates and terms stated in Halliburton's current price lists.
- (b) Halliburton shall not be responsible for and Customer shall secure Halliburton against any liability for damage to property of Customer and of the well owner (if different from Customer), unless caused by the willful misconduct or gross negligence of Halliburton, this provision applying to but not limited to subsurface damage and surface damage arising from subsurface damage.
- (c) Customer shall be responsible for and secure Halliburton against any liability for reservoir loss or damage, or property damage resulting from subsurface pressure, losing control of the well and/or a well blowout, unless such loss or damage is caused by the willful misconduct or gross negligence of Halliburton.
- (d) Customer shall be responsible for and secure Halliburton against any and all liability of whatsoever nature for damages as a result of subsurface trespass, or an action in the nature thereof, arising from a service operation performed by Halliburton hereunder.
- (e) Customer shall be responsible for and secure Halliburton against any liability for injury to or death of persons, other than employees of Halliburton, or damage to property (including, but not limited to, injury to the well), or any damages whatsoever, irrespective of cause, growing out of or in any way connected with the use of radioactive material in the well hole; unless such damage shall be caused by the willful misconduct or gross negligence of Halliburton.
- (f) Halliburton makes no guarantee of the effectiveness of the products, supplies or materials, nor of the results of any treatment or service.
- (g) Customer shall, at its risk and expense, attempt to recover any Halliburton equipment, tools or instruments which are lost in the well and if such equipment, tools or instruments are not recovered, Customer shall pay Halliburton its replacement cost unless such loss is due to the sole negligence of Halliburton. If Halliburton equipment, tools or instruments are damaged in the well, Customer shall pay Halliburton the lesser of its replacement cost or the cost of repairs unless such damage is caused by the sole negligence of Halliburton. In the case of equipment, tools or instruments for marine operations, Customer shall, in addition to the foregoing, be fully responsible for loss of or damage to any of Halliburton's equipment, tools or instruments which occurs at any time after delivery to Customer at the landing until returned to the landing, unless such loss or damage is caused by the sole negligence of Halliburton.
- (h) Because of the uncertainty of variable well conditions and the necessity of relying on facts and supporting services furnished by others, Halliburton is unable to guarantee the accuracy of any chart interpretation, research analysis, job recommendation or other data furnished by Halliburton. Halliburton personnel will use their best efforts in gathering such information and their best judgment in interpreting it, but Customer agrees that Halliburton shall not be responsible for any damages arising from the use of such information except where due to Halliburton's gross negligence or willful misconduct in the preparation or furnishing of it.
- (i) Halliburton warrants only title to the products, supplies and materials and that the same are free from defects in workmanship and materials. THERE ARE NO WARRANTIES, EXPRESS OR IMPLIED, OF MERCHANTABILITY, FITNESS OR OTHERWISE WHICH EXTEND BEYOND THOSE STATED IN THE IMMEDIATELY PRECEDING SENTENCE. Halliburton's liability and Customer's exclusive remedy in any cause of action (whether in contract, tort, breach of warranty or otherwise) arising out of the sale or use of any products, supplies or materials in expressly limited to the replacement of such products, supplies or materials on their return to Halliburton or, at Halliburton's option, to the allowance to the Customer of credit for the cost of such items. In no event shall Halliburton be liable for special, incidental, indirect, punitive or consequential damages.
- (j) Invoices payable NET by the 20th of the following month after date of invoice. Upon Customer's default in payment of Customer's account by the last day of the month following the month in which the invoice is dated, Customer agrees to pay interest thereon after default at the highest lawful contract rate applicable but never to exceed 18% per annum. In the event it becomes necessary to employ an attorney to enforce collection of said account, Customer agrees to pay all collection costs and attorney fees in the amount of 20% of the amount of the unpaid account.
- (k) This contract shall be governed by the law of the state where services are performed or equipment or materials are furnished.
- (l) Halliburton shall not be bound by any changes or modifications in this contract, except where such change or modification is made in writing by a duly authorized executive officer of Halliburton.

I HAVE READ AND UNDERSTAND THIS CONTRACT AND REPRESENT THAT I AM AUTHORIZED TO SIGN THE SAME AS CUSTOMER'S AGENT.

SIGNED [Signature] CUSTOMER
DATE 9-15-87 1:15 1987
TIME 1:15 P.M.

We certify that the Fair Labor Standards Act of 1938, as amended, has been complied with in the production of goods and/or with respect to services furnished under this contract.

CUSTOMER