

STATE CORPORATION COMMISSION OF KANSAS
OIL & GAS CONSERVATION DIVISION
WELL COMPLETION OR RECOMPLETION FORM
ACO-1 WELL HISTORY
DESCRIPTION OF WELL AND LEASE

Operator: License # 5144
Name Mull Drilling Company, Inc.
Address P.O. Box 2758
City/State/Zip Wichita, KS 67201

Purchaser Panhandle Eastern

Operator Contact Person Paul Gunzelman
Phone (316) 264-6366

Contractor: License # Blue Goose
Name Great Bend

Wellsite Geologist Roger Martin
Phone

Designate Type of Completion
New Well Re-Entry Workover
Oil SWD Temp Abd
X Gas Plugged Inj Delayed Comp.
Dry Other (Core, Water Supply etc.)

If CW/O: old well info as follows:
Operator
Well Name
Comp. Date Old Total Depth

WELL HISTORY

Drilling Method:
X Mud Rotary Air Rotary Cable
5/27/81 6/7/81 8/11/81
Spud Date Date Reached TD Completion Date
4450'
Total Depth PBTD

Amount of Surface Pipe Set and Cemented at 444 feet
Multiple Stage Cementing Collar Used? Yes X No
If yes, show depth set feet
If alternate 2 completion, cement circulated from feet depth to w/SX cmt
Cement Company Name
Invoice #

API No. 15-151-20,920-6060
County Pratt
100' E of East
NW NW NE Sec. 17. Twp 26S. Rge. 15. XXX West
4950 Ft North from Southeast Corner of Section
2210 Ft West from Southeast Corner of Section
(Note: Locate well in section plat below)

Lease Name DOGGETT Well # 6
Field Name Hopewell (South)
Producing Formation Mississippian
Elevation: Ground 2047 KB 2054

Section Plat

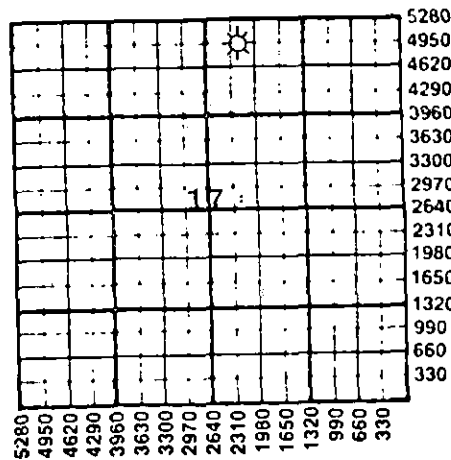

WATER SUPPLY INFORMATION

Disposition of Produced Water: X Disposal
Docket # So. Leitsburg, Stafford, KS
Questions on this portion of the ACO-1 call:
Water Resources Board (913) 296-3717
Source of Water:
Division of Water Resources Permit #
Groundwater Ft North from Southeast Corner (Well) Ft West from Southeast Corner of Sec Twp Rge East West
Surface Water Ft North from Southeast Corner (Stream, pond etc) Ft West from Southeast Corner Sec Twp Rge East West
Other (explain) (purchased from city, R.W.D. #)

INSTRUCTIONS: This form shall be completed in duplicate and filed with the Kansas Corporation Commission, 200 Colorado Derby Building, Wichita, Kansas 67202, within 90 days after completion or recompletion of any well. Rule 82-3-130 and 82-3-107 apply.
Information on side two of this form will be held confidential for a period of 12 months if requested in writing and submitted with the form. See rule 82-3-107 for confidentiality in excess of 12 months.
One copy of all wireline logs and drillers time log shall be attached with this form. Submit CP-4 form with all plugged wells. Submit CP-111 form with all temporarily abandoned wells.

All requirements of the statutes, rules and regulations promulgated to regulate the oil and gas industry have been fully complied with and the statements herein are complete and correct to the best of my knowledge.

Signature Paul M. Gunzelman
Title Geologist Date 10/1/87

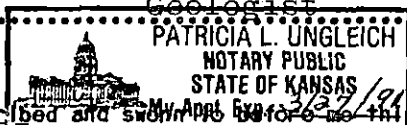

Subscribed and sworn to before me this 2nd day of October 1987
Notary Public Patricia L. Ungleich
Date Commission Expires March 27, 1991

K.C.C. OFFICE USE ONLY
F Letter of Confidentiality Attached
C Wireline Log Received
C Drillers Timelog Received
Distribution
KCC SWD/Rep NGPA
KGS Plug Other
RECEIVED
STATE CORPORATION COMMISSION
OCT 5 1987

Sec. 17 Twp 26 Rge. 15 SW

311

Operator Name MULL DRILLING COMPANY, INC. Lease Name DOGGETT Well #. 6

Sec. 17 Twp. 26S Rge. 15W East West County Pratt

WELL LOG

INSTRUCTIONS: Show important tops and base of formations penetrated. Detail all cores. Report all drill stem tests giving interval tested, time tool open and closed, flowing and shut-in pressures, whether shut-in pressure reached static level, hydrostatic pressures, bottom hole temperature, fluid recovery, and flow rates if gas to surface during test. Attach extra sheet if more space is needed. Attach copy of log.

Drill Stem Tests Taken Yes No
 Samples Sent to Geological Survey Yes No
 Cores Taken Yes No

Formation Description
 Log Sample

Name Top Bottom

SEE ATTACHED C-10

SEE ATTACHED C-10

CASING RECORD <input type="checkbox"/> New <input type="checkbox"/> Used							
Report all strings set-conductor, surface, intermediate, production, etc.							
Purpose of String	Size Hole Drilled	Size Casing Set (in O.D.)	Weight Lbs/Ft.	Setting Depth	Type of Cement	#Sacks Used	Type and Percent Additives
.....
.....
.....
PERFORATION RECORD				Acid, Fracture, Shot, Cement Squeeze Record			
Shots Per Foot	Specify Footage of Each Interval Perforated			(Amount and Kind of Material Used)		Depth	
.....	
.....	
.....	
.....	
TUBING RECORD				Liner Run <input type="checkbox"/> Yes <input type="checkbox"/> No			
Size	Set At	Packer at					
.....					
Date of First Production		Producing Method					
.....		<input type="checkbox"/> Flowing <input type="checkbox"/> Pumping <input type="checkbox"/> Gas Lift <input type="checkbox"/> Other (explain).....					
Estimated Production Per 24 Hours	Oil	Gas	Water	Gas-Oil Ratio	Gravity		
	Bbls	MCF	Bbls	CFPB			
.....		

METHOD OF COMPLETION

Disposition of gas: Vented Open Hole Perforation
 Sold Other (Specify)
 Used on Lease Dually Completed
 Commingled

WORK ORDER CONTRACT AND PRE-TREATMENT DATA

FORM 1908 R-4

A Division of Halliburton Company DUNCAN, OKLAHOMA 73530

ATTACH TO INVOICE & TICKET NO. 622504

DISTRICT MPR 15

DATE 9-15-87

TO: HALLIBURTON SERVICES YOU ARE HEREBY REQUESTED TO FURNISH EQUIPMENT AND SERVICEMEN TO DELIVER AND OPERATE THE SAME AS AN INDEPENDENT CONTRACTOR TO: 17111 17111111 (CUSTOMER) AND DELIVER AND SELL PRODUCTS, SUPPLIES, AND MATERIALS FOR THE PURPOSE OF SERVICING

WELL NO. [REDACTED] LEASE [REDACTED] SEC. 17 TWP. 26 S RANGE 15 W
FIELD _____ COUNTY Nowa STATE KS OWNED BY _____

THE FOLLOWING INFORMATION WAS FURNISHED BY THE CUSTOMER OR HIS AGENT

Table with columns: FORMATION NAME, TYPE, NEW USED, WEIGHT, SIZE, FROM, TO, MAX. ALLOW. P.S.I. Rows include CASING, LINER, TUBING, OPEN HOLE, PERFORATIONS.

PREVIOUS TREATMENT: DATE _____ TYPE _____ MATERIALS _____

TREATMENT INSTRUCTIONS: TREAT THRU TUBING ANNULUS CASING TUBING/ANNULUS HYDRAULIC HORSEPOWER ORDERED _____
Well as follows - 25 SKS CMT W/INSTRUMENTS DUAL TRK @ 4056
Balance Ann - 35 SKS TOWN FT 7. Surface Down to 2.000 - 45 SKS
Dr 1 Annulus - Cement used was - (115) SKS EQUIVALENT 1/1090
CSL - 2% EQUIVALENTS

CUSTOMER OR HIS AGENT WARRANTS THE WELL IS IN PROPER CONDITION TO RECEIVE THE PRODUCTS, SUPPLIES, MATERIALS, AND SERVICES

THIS CONTRACT MUST BE SIGNED BEFORE WORK IS COMMENCED

- As consideration, the above-named Customer agrees:
(a) To pay Halliburton in accord with the rates and terms stated in Halliburton's current price lists.
(b) Halliburton shall not be responsible for and Customer shall secure Halliburton against any liability for damage to property of Customer and of the well owner...
(c) Customer shall be responsible for and secure Halliburton against any liability for reservoir loss or damage...
(d) Customer shall be responsible for and secure Halliburton against any and all liability of whatsoever nature for damages as a result of subsurface trespass...
(e) Customer shall be responsible for and secure Halliburton against any liability for injury to or death of persons...
(f) Halliburton makes no guarantee of the effectiveness of the products, supplies or materials...
(g) Customer shall, at its risk and expense, attempt to recover any Halliburton equipment, tools or instruments which are lost in the well...
(h) Because of the uncertainty of variable well conditions and the necessity of relying on facts and supporting services furnished by others...
(i) Halliburton warrants only title to the products, supplies and materials and that the same are free from defects in workmanship and materials...
(j) Invoices payable NET by the 20th of the following month after date of invoice...
(k) This contract shall be governed by the law of the state where services are performed...
(l) Halliburton shall not be bound by any changes or modifications in this contract...

I HAVE READ AND UNDERSTAND THIS CONTRACT AND REPRESENT THAT I AM AUTHORIZED TO SIGN THE SAME AS CUSTOMER'S AGENT.

SIGNED [Signature] CUSTOMER

DATE 9-15-87 OCT 5 1987

TIME A.M. P.M.

We certify that the Fair Labor Standards Act of 1938, as amended, has been complied with in the production of goods and/or with respect to services furnished under this contract.

CUSTOMER

REGISTRATION DIVISION Wichita, Kansas

WELL COMPLETION REPORT AND DRILLER'S LOG

S.17 T.26S R.15W E W

API No. 15 - PRATT - 151-20,920
County Number

Loc. 100' E of NW NW NE
County Pratt County, KS.

Operator: MULL DRILLING COMPANY, INC.

Address: 221 N Main - Suite 300 - Wichita, Kansas 67202

Well No. 6 Lease Name DOGGETT

Footage Location: 330' feet from (N) line 330' feet from (W) line

Principal Contractor: Blue Goose Drllg-Rig # Geologist: Vern Schrag

Spud Date: May 27, 1981 Date Completed: June 8, 1981 Total Depth: 4450' P.B.T.D.

Directional Deviation Oil and/or Gas Purchaser

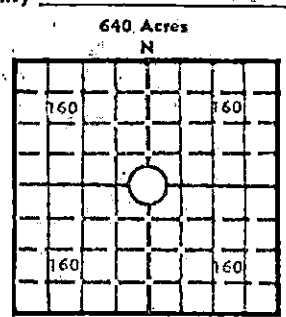

Elev.: Gr. 2047
DF KB 2054

CASING RECORD

Report of all strings set - surface, intermediate, production, etc.

Purpose of string	Size hole drilled	Size casing set (in O.D.)	Weight lbs/ft.	Setting depth	Type cement	Sacks	Type and percent additives
Surface	12 1/2"	8-5/8"	20#	444'	Common	300	3% cc 2% gel
Production	7-7/8"	4-1/2"	10 1/2#	4449'	Scavenger	25	
					50-50 poz	150	2% gel, 10% salt
							.75% CFR2

LINER RECORD

PERFORATION RECORD

Top, ft.	Bottom, ft.	Sacks cement	Shots per ft.	Size & type	Depth interval
			4		4342-4350'

Size	Setting depth	Packer set at

ACID, FRACTURE, SHOT, CEMENT SQUEEZE RECORD

Amount and kind of material used	Depth interval treated
After perf (4342-4350') 500 gal BDA & 500 gal MCA	4342-4350'
Frac 15,000# 20-40 Sand - 450 Bbls frac wtr	(as above)

INITIAL PRODUCTION

Date of first production: 8/11/81 Producing method (flowing, pumping, gas lift, etc.): Flowing

8/11/81 Mull Drllg Co. Test 120# TP 290# AP

RATE OF PRODUCTION PER 24 HOURS: Oil _____ bbls. Gas Mull Drllg Co. Test 82,700 CEG MCF Water _____ bbls. Gas-oil ratio _____ CFPB

Disposition of gas (vented, used on lease or sold): Shut In Gas Well Producing interval (s): Mississippian

INSTRUCTIONS: As provided in KCC Rule 82-2-125, within 90 days after completion of a well, one completed copy of this report shall be submitted to the State Geological Survey of Kansas, 4150 Monroe Street, Wichita, Kansas 67209. Copies of this form are available from the Conservation Division, State Corporation Commission, 245 No. Water, Wichita, Kansas 67202. Phone AC 316-522-2206. If confidential custody is desired, please note Rule 82-2-125. Drillers Logs will be on open file in the Oil and Gas Division, State Geological Survey of Kansas, Lawrence, Kansas 66044.

RECEIVED
STATE CORPORATION COMMISSION
OCT 5 1987
CONSERVATION DIVISION
Wichita, Kansas

DESIGNATE TYPE OF COMP.: OIL, GAS, DRY HOLE, SWDW, ETC.: Gas

Operator MULL DRILLING COMPANY INC.

Well No. #6 Lease Name DOGGETT

S 17 T 26S R 15W E W

WELL LOG

Show all important zones of porosity and contents thereof; cored intervals, and all drill-stem tests, including depth interval tested, cushion used, time tool open, flowing and shut-in pressures, and recoveries.

SHOW GEOLOGICAL MARKERS, LOGS RUN, OR OTHER DESCRIPTIVE INFORMATION.

FORMATION DESCRIPTION, CONTENTS, ETC.	TOP	BOTTOM	NAME	DEPTH
Heebner	3724	-1670		
Toronto	3743	-1689		
Brn Lm	3878	-1824		
Lansing	3890	-1836		
Stark Shale	4115	-2061		
B/KC	4174	-2120		
Miss	4342	-2288		
Viola	4411	-2357		
LTD	4431	-2377		
<p>DST #1 3908-3925' / 30-45-60-60</p> <p>Strong blow off bottom bucket-1st opening</p> <p>Recovered: 869' slightly gassy water (Chl=145,000 ppm)</p> <p>ISIP 1391 IFP 194-216 FFP 259-367 FSIP 1348</p> <p>DST #2 4021-4042' / 30-45-60-60</p> <p>Gas to surface / 11 min.</p> <p>Recovered: 30' Oil cut mud (1st stand) (10% oil, 80% mud, 10% gas)</p> <p>217' Heavy oil cut mud (Upr Stand: 10% O, 60% M, 25% W, 5% Gas) (Lwr Stand: 15% O, 50% M, 25% W, 10% Gas)</p> <p>Total Fluid: 247'</p> <p>ISIP 789 IFP 166-176 FFP 239-232 FSIP 758</p> <p>DST #3 4057-4081 / 30-30-45-30</p> <p>Very weak blow - DST tool did not open and close properly</p> <p>Recovered: 60' muddy oil (96% O, 3% M, 1% W) 60' oil cut mud (15% O, 50% M, 25% W, 10% G) (Chl=45,000 ppm)</p> <p>Total Fluid: 120'</p> <p>ISIP 1298 FFP 93-93</p> <p>DST #4 (See Attachment Page)</p>				

USE ADDITIONAL SHEETS, IF NECESSARY, TO COMPLETE WELL RECORD.

Date Received

Robert O. Wall
Robert O. Wall

PRESIDENT

Title

August 14, 1981

Date

RECEIVED

STATE CORPORATION COMMISSION

OCT 5 1981

CONSERVATION DIVISION
Wichita, Kansas

MULL DRILLING COMPANY, INC.

#6 DOGGETT

Section 17-26S-15W

Pratt County, Kansas

#6 DOGGETT

DST #4 4303-4365' / 30-45-60-60

Gas to surface / 10 min.

Gauge: (1st Opening)

15 min.	86.3 MCFG	1/2" Orifice
20 min.	116	1/2
30 min.	134	1/2

Gauge: (2nd Opening)

5 min.	129	1/2
10 min.	147	1/2
20 min.	153	1/2
30 min.	159	1/2
40,50,60	166	1/2

Stabilized

Recovered: 120' gas cut mud

ISIP 640 IFP 108-108 FFP 108-75 FSIP 646

RTD: 4450

LTD: 4431

Waiting on connections

8/13/81

RECEIVED
STATE CORPORATION COMMISSION

OCT 5 1987

CONSERVATION DIVISION
Wichita, Kansas

WELL LOG

DOGGETT # 6
NW NW NE Sec 17-26-S-15W
Pratt County, KS

NAME OF OPERATOR: Mull Drilling Company, Inc.
221 North Main Suite 300
Wichita, KS 67202

DATE COMPLETED: June 8, 1981

FROM	TO	
0	215	Sand
215	449	Shale
449	1525	Red Bed and Shale
1525	2560	Shale and Lime
2560	2990	Shale and Shells
2990	3840	Lime and Shale
3840	4000	Lime
4000	4135	Lime and Shale
4135	4450	Lime
4450		T.D.

STATE OF KANSAS

COUNTY OF BARTON SS

George E. Miller, Jr., President of Blue Goose Drilling Company, Inc. being first duly sworn on oath says: That I have knowledge of the facts, statements and matters herein contained and the log of the above described well as filed and that the same are true and correct.

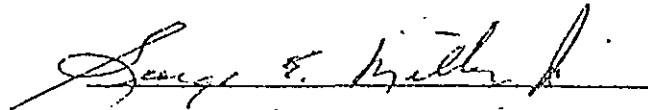
George E. Miller, Jr.

Subscribed and sworn before me this 9th Day of June 1981.

STATE OF KANSAS
HELEN C. STANDLEY
Barton County, Kansas
My Appt. Exp. 12-8-83

RECEIVED
STATE CORPORATION COMMISSION

OCT 8 1987
Notary Public

My Commission Expires: 12-8-83

CONSERVATION DIVISION
Wichita, Kansas

LAUGHLIN-SIMMONS & CO. OF KANSAS, INC.
 OIL FIELD SURVEYING
 1337 NORTH MERIDIAN, SUITE 2 WICHITA, KANSAS 67203

KW3258125

(316) 943-5351

INVOICE NO.

4-13-81
DATE

Pratt COUNTY 17 26s 15w LOCATION NW NW NE 150' E of

Mull Drilling Company OPERATOR 6 NO. Doggett FARM

ELEVATION: 2047.9



Mull Drilling Company
 221 N. Main
 Suite 300
 Wichita, Kansas 67202

AUTHORIZED BY: Pat PHONE # routine

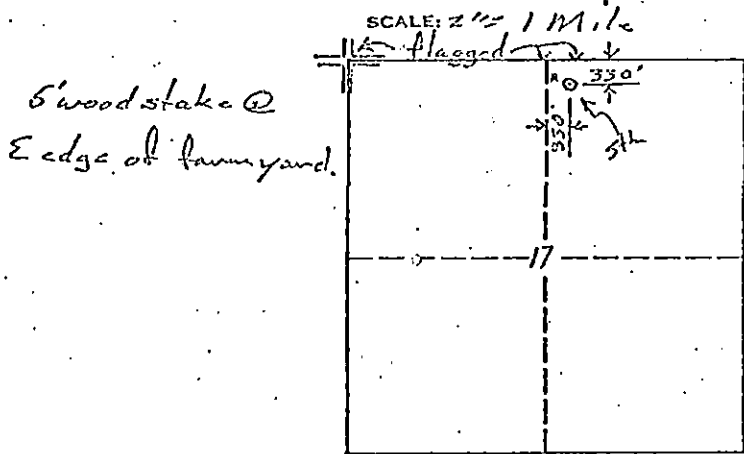

MINIMUM STAKING CHARGE: \$115.00
 (INCLUDES GROUND ELEVATION)
 EXTRA TIME & MILEAGE: _____
 ELEVATION CHARGE: _____

TOTAL: \$115.00 17
 L-S SURVEYOR

Laughlin-Simmons & Co. of Kansas, Inc. is not liable in case of errors and/or omissions.

RECEIVED
 STATE CORPORATION COMMISSION

OCT 5 1987

CONSERVATION DIVISION
 Wichita, Kansas