

15-451-60054-0000

STATE CORPORATION COMMISSION OF KANSAS  
OIL & GAS CONSERVATION DIVISION  
WELL COMPLETION OR RECOMPLETION FORM  
ACO-1 WELL HISTORY  
DESCRIPTION OF WELL AND LEASE

API NO. 15-.....None Issued (Comp. 4/15/58)

County.....Pratt.....

NE. NE. SW. Sec. 17 Twp. 26S Rge. 15. XX East West

..2310!.. Ft North from Southeast Corner of Section  
..2970... Ft West from Southeast Corner of Section  
(Note: Locate well in section plat below)

Lease Name...DOGGETT.....Well #..#1...

Field Name...Hopewell Pool.....

Producing Formation...Lansing-KC 'H'.....

Elevation: Ground..2041'.....KB..2046'.....

Operator: License # .....5144  
Name Mull Drilling Company, Inc.  
Address P.O. Box 2758  
.....Wichita.....  
City/State/Zip .....Kansas 67201.....

Purchaser Koch Oil/Panhandle Eastern.....

Operator Contact Person Paul Gunzelman.....  
Phone ..(316) 264-6366.....

Contractor: License # Mull-5144  
Name Mull Drilling Company, Inc.

Wellsite Geologist C.R. Sullivan.....  
Phone.....

Designate Type of Completion  
\_\_\_ New Well \_\_\_ Re-Entry \_\_\_ Workover

OTT \_\_\_ SWD \_\_\_ Temp Abd  
 Gas \_\_\_ Inj \_\_\_ Delayed Comp.  
 Dry Plugged \_\_\_ Other (Core, Water Supply etc.)

If ~~OWN~~ Old well info as follows:  
Operator .....  
Well Name .....  
Comp. Date .....Old Total Depth.....

WELL HISTORY

Drilling Method:  
 Mud Rotary \_\_\_ Air Rotary \_\_\_ Cable  
3/14/58 3/31/58 plugged 9-15-87  
..... 4/15/58.....  
Spud Date Date Reached TD Completion Date  
4685..... ..4090!.....  
Total Depth PBTD

Amount of Surface Pipe Set and Cemented at 1029 feet  
Multiple Stage Cementing Collar Used? \_\_\_ Yes  No  
If yes, show depth set.....feet  
If alternate 2 completion, cement circulated  
from.....feet depth to.....w/.....SX cmt  
Cement Company Name .....  
Invoice # .....

Section Plat

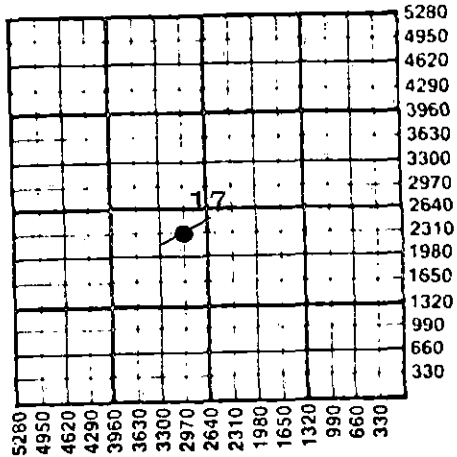

WATER SUPPLY INFORMATION

Disposition of Produced Water:  Disposal  
Docket # .....  Repressuring

So. Leitsburg/Stafford County

Questions on this portion of the ACO-1 call:

Water Resources Board (913) 296-3717

Source of Water: ..  
Division of Water Resources Permit #.....

\_\_\_ Groundwater.....Ft North from Southeast Corner  
(Well) .....Ft West from Southeast Corner of  
Sec Twp Rge \_\_\_ East \_\_\_ West

\_\_\_ Surface Water.....Ft North from Southeast Corner  
(Stream, pond etc).....Ft West from Southeast Corner  
Sec Twp Rge \_\_\_ East \_\_\_ West

\_\_\_ Other (explain).....  
(purchased from city, R.W.D. #)

INSTRUCTIONS: This form shall be completed in duplicate and filed with the Kansas Corporation Commission, 200 Colorado Derby Building, Wichita, Kansas 67202, within 90 days after completion or recompletion of any well. Rule 82-3-130 and 82-3-107 apply.

Information on side two of this form will be held confidential for a period of 12 months if requested in writing and submitted with the form. See rule 82-3-107 for confidentiality in excess of 12 months. One copy of all wireline logs and drillers time log shall be attached with this form. Submit CP-4 form with all plugged wells. Submit CP-111 form with all temporarily abandoned wells.

All requirements of the statutes, rules and regulations promulgated to regulate the oil and gas industry have been fully complied with and the statements herein are complete and correct to the best of my knowledge.

Signature Paul M. Gunzelman  
..... Paul M. Gunzelman .....

Title Geologist Kansas Div. Date 9/30/87



Subscribed and sworn to before me this 30th day of September 1987.  
Notary Public Patricia L. Ungleich

Date Commission Expires March 27, 1991

K.C.C. OFFICE USE ONLY  
F \_\_\_ Letter of Confidentiality Attached  
C \_\_\_ Wireline Log Received  
C \_\_\_ Drillers Timelog Received  
Distribution  
 KCC RECEIVED  SWD/Rep  NGPA  
 Res.  Plug  Other  
STATE CORPORATION COMMISSION (Specify)  
OCT 5 1987

Sec. 17 Twp. 26S Rge. 15E

10-5-87

Operator Name Mull Drilling Company, Inc. Lease Name DOGGETT Well # 1

Sec. 17 Twp. 26S Rge. 15W  East  West County Pratt

WELL LOG

INSTRUCTIONS: Show important tops and base of formations penetrated. Detail all cores. Report all drill stem tests giving interval tested, time tool open and closed, flowing and shut-in pressures, whether shut-in pressure reached static level, hydrostatic pressures, bottom hole temperature, fluid recovery, and flow rates if gas to surface during test. Attach extra sheet if more space is needed. Attach copy of log.

Drill Stem Tests Taken  Yes  No  
 Samples Sent to Geological Survey  Yes  No  
 Cores Taken  Yes  No

Formation Description  
 Log  Sample

DST #1 4024-4037/ Open 2 hrs., 10 min.  
 1,250.mcf. Gas in.3 min.  
 Stabil. in 40 min. @ 1,630 mcf  
 Rec: 100' sgc. IBH 1500 FBH 1480  
 IFP 295 FFP 360

DST #2 4037-4049/ Open 2 hrs. Gas in 6 min.  
 TSTM. Rec: 135' MO. IF 155 FF 260  
 IBH 1490 FBH 1490 30 min.

DST #3 4309-4331. Open 40 min. Light  
 blow 22 min. and died. Rec: 25' mud.  
 FP 45# .BH (30 min.) 120# & 55#.

Name	Top	Bottom
Heebner	3718	
Brn Lime	3870	
Lansing	3883	
Marmaton	4233	
Miss	4307	
Viola	4416	
Simpson	4597	
Arbuckle	4646	

CASING RECORD <input type="checkbox"/> New <input type="checkbox"/> Used							
Report all strings set-conductor, surface, intermediate, production, etc.							
Purpose of String	Size Hole Drilled	Size Casing Set (In O.D.)	Weight Lbs/Ft.	Setting Depth	Type of Cement	#Sacks Used	Type and Percent Additives
Surface	12 1/4"	8-5/8"	24#	1029'	Cmn	500	SX
Prod.	7-7/8"	5-1/2"	15#	4090'	Cmn	120	SX

PERFORATION RECORD		Acid, Fracture, Shot, Cement Squeeze Record	
Shots Per Foot	Specify Footage of Each Interval Perforated	(Amount and Kind of Material Used)	Depth
4031-4037	(4SPF) Lan-KC'H' (4/7/58)	Ac 500 BDA	
	(4/13/58)	Ac 3500 (500 reg/3000 retarded)	
4026-4034	(4SPF) " " (3/11/80)	Ac 3000 gal 15% NE acid	

TUBING RECORD	Size	Set At	Packer at	Liner Run <input type="checkbox"/> Yes <input type="checkbox"/> No
---------------	------	--------	-----------	--

Date of First Production	Producing Method
5-1-58 5-1-58	<input type="checkbox"/> Flowing <input checked="" type="checkbox"/> Pumping <input type="checkbox"/> Gas Lift <input type="checkbox"/> Other (explain).....

Estimated Production Per 24 Hours	Oil Bbls	Gas MCF	Water	Gas-Oil Ratio	Gravity
	None	6.5 mcf			

METHOD OF COMPLETION

Disposition of gas:  Vented  Sold  Used on Lease  
 Open Hole  Perforation  Other (Specify) ..... 4026-4034  
 Dually Completed  Conmingled

## WORK ORDER CONTRACT AND PRE-TREATMENT DATA

ATTACH TO INVOICE & TICKET NO. 672506

DISTRICT W-1770 KS

DATE 9-15-87

TO: HALLIBURTON SERVICES - YOU ARE HEREBY REQUESTED TO FURNISH EQUIPMENT AND SERVICEMEN TO DELIVER AND OPERATE THE SAME AS AN INDEPENDENT CONTRACTOR TO: Bill Dill (CUSTOMER) AND DELIVER AND SELL PRODUCTS, SUPPLIES, AND MATERIALS FOR THE PURPOSE OF SERVICING

WELL NO. [REDACTED] LEASE [REDACTED] SEC. 17 TWP. 26 RANGE 15  
FIELD \_\_\_\_\_ COUNTY Wagoner STATE KS OWNED BY \_\_\_\_\_

THE FOLLOWING INFORMATION WAS FURNISHED BY THE CUSTOMER OR HIS AGENT

FORMATION NAME \_\_\_\_\_ TYPE \_\_\_\_\_  
FORMATION THICKNESS \_\_\_\_\_ FROM \_\_\_\_\_ TO \_\_\_\_\_  
PACKER: TYPE \_\_\_\_\_ SET AT \_\_\_\_\_  
TOTAL DEPTH \_\_\_\_\_ MUD WEIGHT \_\_\_\_\_  
BORE HOLE \_\_\_\_\_  
INITIAL PROD: OIL \_\_\_\_\_ BPD, H<sub>2</sub>O \_\_\_\_\_ BPD, GAS \_\_\_\_\_ MCF  
PRESENT PROD: OIL \_\_\_\_\_ BPD, H<sub>2</sub>O \_\_\_\_\_ BPD, GAS \_\_\_\_\_ MCF

	NEW USED	WEIGHT	SIZE	FROM	TO	MAX. ALLOW. P.S.I.
CASING		15.5	5 1/2	CL	4285	
LINER						
TUBING						
OPEN HOLE						SHOTS/FT.
PERFORATIONS				4031	4037	
PERFORATIONS						
PERFORATIONS						

PREVIOUS TREATMENT: DATE #1 TYPE \_\_\_\_\_ MATERIALS \_\_\_\_\_

TREATMENT INSTRUCTIONS: TREAT THRU TUBING  ANNULUS  CASING  TUBING/ANNULUS  HYDRAULIC HORSEPOWER ORDERED \_\_\_\_\_  
25 SKS in Holes Down 5 1/2" Casing by 1 1/2" SPACER C.L. 4037  
by 50' @ 1000 FT to Surface - 25 SKS Down Annulus  
CIPRANTOSE 150SK ECONOLITE

CUSTOMER OR HIS AGENT WARRANTS THE WELL IS IN PROPER CONDITION TO RECEIVE THE PRODUCTS, SUPPLIES, MATERIALS, AND SERVICES

THIS CONTRACT MUST BE SIGNED BEFORE WORK IS COMMENCED

As consideration, the above-named Customer agrees:

- (a) To pay Halliburton in accord with the rates and terms stated in Halliburton's current price lists.
- (b) Halliburton shall not be responsible for and Customer shall secure Halliburton against any liability for damage to property of Customer and of the well owner (if different from Customer), unless caused by the willful misconduct or gross negligence of Halliburton, this provision applying to but not limited to subsurface damage and surface damage arising from subsurface damage.
- (c) Customer shall be responsible for and secure Halliburton against any liability for reservoir loss or damage, or property damage resulting from subsurface pressure, losing control of the well and/or a well blowout, unless such loss or damage is caused by the willful misconduct or gross negligence of Halliburton.
- (d) Customer shall be responsible for and secure Halliburton against any and all liability of whatsoever nature for damages as a result of subsurface trespass, or an action in the nature thereof, arising from a service operation performed by Halliburton hereunder.
- (e) Customer shall be responsible for and secure Halliburton against any liability for injury to or death of persons, other than employees of Halliburton, or damage to property (including, but not limited to, injury to the well), or any damages whatsoever, irrespective of cause, growing out of or in any way connected with the use of radioactive material in the well hole, unless such damage shall be caused by the willful misconduct or gross negligence of Halliburton.
- (f) Halliburton makes no guarantee of the effectiveness of the products, supplies or materials, nor of the results of any treatment or service.
- (g) Customer shall, at its risk and expense, attempt to recover any Halliburton equipment, tools or instruments which are lost in the well and if such equipment, tools or instruments are not recovered, Customer shall pay Halliburton its replacement cost unless such loss is due to the sole negligence of Halliburton. If Halliburton equipment, tools or instruments are damaged in the well, Customer shall pay Halliburton the lesser of its replacement cost or the cost of repairs unless such damage is caused by the sole negligence of Halliburton. In the case of equipment, tools or instruments for marine operations, Customer shall, in addition to the foregoing, be fully responsible for loss of or damage to any of Halliburton's equipment, tools or instruments which occurs at any time after delivery to Customer at the landing until returned to the landing, unless such loss or damage is caused by the sole negligence of Halliburton.
- (h) Because of the uncertainty of variable well conditions and the necessity of relying on facts and supporting services furnished by others, Halliburton is unable to guarantee the accuracy of any chart interpretation, research analysis, job recommendation or other data furnished by Halliburton. Halliburton personnel will use their best efforts in gathering such information and their best judgment in interpreting it, but Customer agrees that Halliburton shall not be responsible for any damages arising from the use of such information except where due to Halliburton's gross negligence or willful misconduct in the preparation or furnishing of it.
- (i) Halliburton warrants only title to the products, supplies and materials and that the same are free from defects in workmanship and materials. THERE ARE NO WARRANTIES, EXPRESS OR IMPLIED, OF MERCHANTABILITY, FITNESS OR OTHERWISE WHICH EXTEND BEYOND THOSE STATED IN THE IMMEDIATELY PRECEDING SENTENCE. Halliburton's liability and Customer's exclusive remedy in any cause of action (whether in contract, tort, breach of warranty or otherwise) arising out of the sale or use of any products, supplies or materials in expressly limited to the replacement of such products, supplies or materials on their return to Halliburton or, at Halliburton's option, to the allowance to the Customer of credit for the cost of such items. In no event shall Halliburton be liable for special, incidental, indirect, punitive or consequential damages.
- (j) Invoices payable NET by the 20th of the following month after date of invoice. Upon Customer's default in payment of Customer's account by the last day of the month following the month in which the invoice is dated, Customer agrees to pay interest thereon after default at the highest lawful contract rate applicable but never to exceed 18% per annum. In the event it becomes necessary to employ an attorney to enforce collection of said account, Customer agrees to pay all collection costs and attorney fees in the amount of 20% of the amount of the unpaid account.
- (k) This contract shall be governed by the law of the state where services are performed or equipment or materials are furnished.
- (l) Halliburton shall not be bound by any changes or modifications in this contract, except where such change or modification is made in writing by a duly authorized executive officer of Halliburton.

I HAVE READ AND UNDERSTAND THIS CONTRACT AND REPRESENT THAT I AM AUTHORIZED TO SIGN THE SAME AS CUSTOMER'S AGENT.

SIGNED \_\_\_\_\_ CUSTOMER 1987

DATE 9-15-87

TIME \_\_\_\_\_ A.M. P.M.

CONSERVATION DIVISION  
Wichita, Kansas

We certify that the Fair Labor Standards Act of 1938, as amended, has been complied with in the production of goods and/or with respect to services furnished under this contract.

CUSTOMER

ROTARY DRILLERS LOG

COMPANY: Mull Drilling Co., Inc. Et Al  
Wichita, Kansas

ROTARY DRILLING COMMENCED:  
3-14-58

CONTRACTOR: Mull Drilling Co., Inc.  
Wichita, Kansas

ROTARY DRILLING COMPLETED:  
3-31-58

CASING RECORD: 8 5/8" @ 1029' 500 sax cmt.  
5 1/2" @ 4090' 100 sax cmt.

LOCATION: Doggett #1  
NE NE SW 17-26S-15W  
Pratt County, Kansas

(Figures indicate bottom of formation - measurements from top of Rotary Bushing)

1150'	Anhydrite		
3035'	Shale and Lime		
3565'	Sandy Lime and Shale		
3921'	Lime and Shale		
4247'	Lime		
4296'	Lime and Shale		
4341'	Lime		
4467'	Lime, Shale and Chert		
4526'	Chert and Lime		
4568'	Cherty Lime w/Shale		
4597'	Cherty Lime		
4645'	Simpson Shale		
4685'	Arbuckle		
		<u>Log Tops</u>	
		Heibner	3718'
		Brn Lme	3870'
		Lansing	3883'
		Marmaton	4233'
		Miss	4307'
		Viola	4416'
		Simpson	4597'
		Arbuckle	4646'

I hereby certify that this is true and correct copy of the above log to the best of my knowledge.

MULL-DRILLING COMPANY, INC.

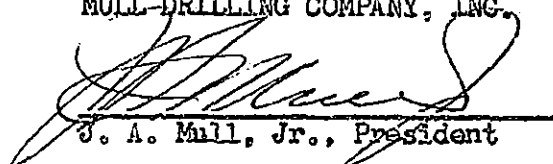
  
J. A. Mull, Jr., President

STATE OF KANSAS )  
                          ) SS  
COUNTY OF SEDGWICK)

Subscribed and sworn to before me this 9th day of April, 1958.

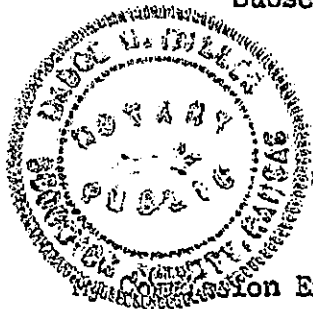

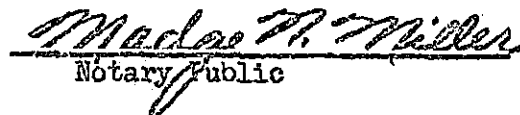
  
Notary Public

RECEIVED  
STATE CORPORATION COMMISSION

OCT 5 1987

CONSERVATION DIVISION  
Wichita, Kansas

Report of Engineer.

*[Handwritten signature]*

FIELD NOTES of a survey made by John A. Maddox, Stafford County Engineer,

under authority of an agreement between Mull Drilling Company, Inc.  
Suite 670 North  
Fourth National Bank Bldg.  
Wichita, Kansas

on the 17th day of February, 1958

PLAT.

Section 17 Town 26 South Range 15 West

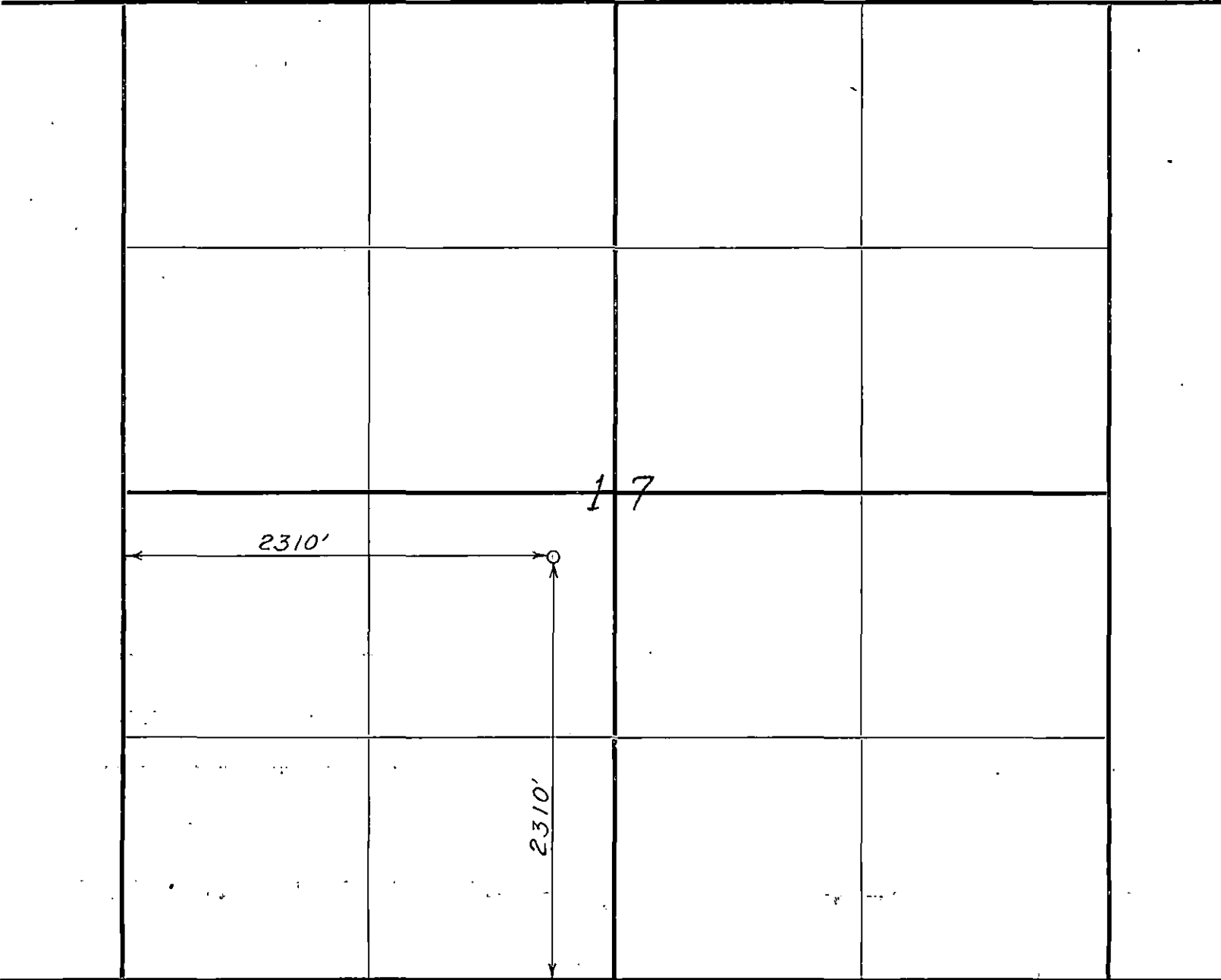

RECEIVED  
STATE CORPORATION COMMISSION

OCT 5 1987

CONSERVATION DIVISION  
Wichita, Kansas

**CERTIFICATE.**

I, John A. Maddox, County Engineer, do hereby certify, that in pursuance of the foregoing agreement, I proceeded, on the 18th day of February, 19 58, to make a survey of the lands described in the foregoing Field-Notes and Plat, and that the report herewith returned conforms strictly to such survey.

J. A. Maddox  
Stafford County Engineer.

**MEMORANDA.**

Staked well location in the center of the Northeast Quarter (NE $\frac{1}{4}$ )  
of the Northeast Quarter (NE $\frac{1}{4}$ ) of the Southwest Quarter (SW $\frac{1}{4}$ ) of  
Section 17, Township 26 South, Range 15 West of the 6th P.M. in  
Pratt County, Kansas.

**Report Of Engineer**

On Sec. 17 Town 26S Range 15W

Between Mull Drilling Company, Inc.  
Suite 670 North  
Fourth National Bank Bldg.  
Wichita 2, Kansas