

WELL PLUGGING RECORD

Give All Information Completely
Make Required Affidavit
Mail or Deliver Report to:
Conservation Division
State Corporation Commission
211 No. Broadway
Wichita, Kansas

Ford County. Sec. 33 Twp. 25S Rge. 21 (X) W (W)

Location as "NE/CNW/SW" or footage from lines C NE NE

Lease Owner Amarex, Inc.

Lease Name Butler Well No. 6

Office Address c/o Malonee-Mahoney Drlg. Co., Box 1257, Liberal, Kan. 67901

Character of Well (completed as Oil, Gas or Dry Hole) OIL

Date well completed 1-1 19 67

Application for plugging filed 4/12 19 71

Application for plugging approved 4/13 19 71

Plugging commenced 5/3/ 19 71

Plugging completed 5/5/ 19 71

Reason for abandonment of well or producing formation NO PRODUCTION

If a producing well is abandoned, date of last production 5/1 19 70

Was permission obtained from the Conservation Division or its agents before plugging was commenced? YES

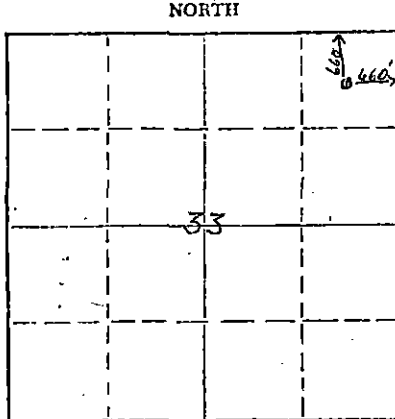

Locate well correctly on above Section Plat

Name of Conservation Agent who supervised plugging of this well ED EVES

Producing formation LANSING-KANSAS CITY Depth to top 4193 Bottom 4257 Total Depth of Well 4257 Feet

Show depth and thickness of all water, oil and gas formations.

OIL, GAS OR WATER RECORDS

CASING RECORD

FORMATION	CONTENT	FROM	TO	SIZE	PUT IN	PULLED OUT

Describe in detail the manner in which the well was plugged, indicating where the mud fluid was placed and the method or methods used in introducing it into the hole. If cement or other plugs were used, state the character of same and depth placed, from _____ feet to _____ feet for each plug set.

Mix 20 sks. cement to plug perfs. Stop plug at 3,900'
35 sks. cement at 200' to 100'.
Put 15 sks. cement at 45' to 0'.

RECEIVED
STATE CORPORATION COMMISSION
MAY 11 1971
CONSERVATION DIVISION
Wichita, Kansas

(If additional description is necessary, use BACK of this sheet)
Name of Plugging Contractor SARGENTS CASING PULLING SERVICE
Address Box 506, Liberal, Kansas 67901

STATE OF KANSAS COUNTY OF SEWARD, ss.
CHESTER A. NORDLING (owner or operator) of the above-described

well, being first duly sworn on oath, says: That I have knowledge of the facts, statements, and matters herein contained and the log of the above-described well as filed and that the same are true and correct. So help me God, SARGENTS CASING PULLING SERVICE

(Signature) Chester A. Nordling, Partner

Box 506, Liberal, Kansas 67901
(Address)

Subscribed and Sworn to before me this 7th day of May, 19 71

Frances Anderson
Notary Public.

FRANCES ANDERSON, NOTARY PUBLIC
MY COMMISSION EXPIRES MAY 7, 1972

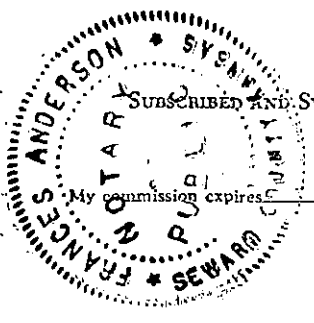

BUTLER #6
C NE NE 33-25S-21W
FORD COUNTY, KANSAS

SET 8 5/8" @ 198'
SET 4 1/2" @ 4258'

CLAY - SAND	0 - 200
CLAY	200 - 525
SHALE - SAND - PYRITE	525 - 750
RED BED - SHALE - ANHYDRITE	750 - 1405
RED BED - SHALE	1405 - 1696
SHALE	1696 - 2095
SHALE - LIME	2095 - 4157
LIME	4157 - 4258
TD	4258

THIS IS A TRUE AND EXACT COPY OF THE FORMATION TAKEN FROM THE
DAILY DRILLING REPORTS.

B. A. CLIFT, PRODUCTION SUP'T.

STATE OF KANSAS
COUNTY OF SEWARD

SWORN TO BEFORE ME THIS 10TH DAY OF MAY, 1971

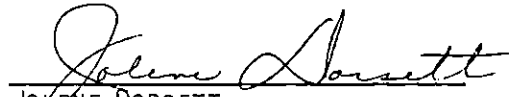

JOLENE DORSETT
NOTARY PUBLIC

MY COMMISSION EXPIRES JANUARY 31, 1975

RECEIVED
STATE CORPORATION COMMISSION
MAY 11 1971
CONSERVATION DIVISION
Wichita, Kansas