

STATE OF KANSAS  
STATE CORPORATION COMMISSION

WELL PLUGGING RECORD

Give All Information Completely  
Make Required Affidavit  
Mail or Deliver Report to  
Conservation Division  
State Corporation Comm.  
245 North Water  
Wichita, KS 67202

Ford County, Sec. 17 Twp. 25S Rge. 23 E/W  
Location as "NE/CNW $\frac{1}{4}$ SW $\frac{1}{4}$ " or footage from lines  
C NW SE

Lease Owner Anadarko Production Company  
Lease Name DYSON "A" Well No. 1  
Office Address P. O. Box 351, Liberal, Kansas 67901  
Character of Well (Completed as Oil, Gas or Dry Hole)

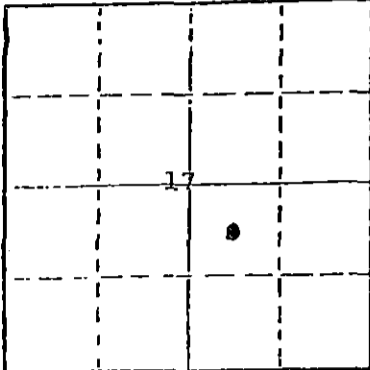

Locate well correctly on above  
Section Plot

Dry Hole  
Date Well completed 5/7 1979  
Application for plugging filed 5/22 1979  
Application for plugging approved verbal 5/6 1979  
Plugging commenced 5/7 1979  
Plugging completed 5/7 1979

Reason for abandonment of well or producing formation  
Dry  
If a producing well is abandoned, date of last production 19

Was permission obtained from the Conservation Division or  
its agents before plugging was commenced? yes

Name of Conservation Agent who supervised plugging of this well Marion Schmidt  
Producing formation Depth to top Bottom Total Depth of Well 5555'  
Show depth and thickness of all water, oil and gas formations.

OIL, GAS OR WATER RECORDS

CASING RECORD

FORMATION	CONTENT	FROM	TO	SIZE	PUT IN	PULLED OUT
				8-5/8"	625'	None

Describe in detail the manner in which the well was plugged, indicating where the mud fluid was placed and the method or methods used in introducing it into the hold. If cement or other plugs were used, state the character of same and depth placed, from feet to feet for each plug set.

Spotted 70 sxs cmt @ 630, 20 sxs 45-0, 3 sxs rathole w/hvy mud between cmt plugs.

STATE RECEIVED  
MAY 23 1979  
CONSERVATION DIVISION

(If additional description is necessary, use BACK of this sheet)

Name of Plugging Contractor Gabbert-Jones, Inc.

STATE OF KANSAS COUNTY OF SEWARD, ss.  
Paul Campbell (employee of owner) or (owner or operator)

of the above-described well, being first duly sworn on oath, says: That I have knowledge of the facts, statements, and matters herein contained and the log of the above-described well as filed and that the same are true and correct. So help me God.

(Signature) *Paul Campbell*  
P. O. Box 351, Liberal, Kansas 67901  
(Address)

SUBSCRIBED AND SWORN TO before me this 22<sup>nd</sup> day of May, 1979

My commission expires BEVERLY J. WILLIAMS  
Seward County, Kansas  
My Appt. Exp. 11/21/82

*Beverly J. Williams*  
Notary Public.

**IMPORTANT**  
 Kans. Geo. Survey request  
 samples on this well.

**KANSAS DRILLERS LOG**

S. 17 T. 25 R. 23 E  
 W

Loc. NW SE

County Ford

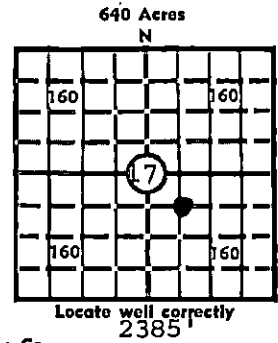

Elev.: Gr. \_\_\_\_\_

DF \_\_\_\_\_ KB \_\_\_\_\_

API No. 15 — 057 — 20,132  
 County Number

Operator  
Anadarko Production Co.

Address  
Box 351 Liberal, Kansas 67901

Well No. # 1 Lease Name Dyson "A"

Footage Location  
1980 feet from ~~SW~~ (S) line 1980 feet from (E) ~~NW~~ line

Principal Contractor Gabbert-Jones, Inc. Geologist \_\_\_\_\_

Spud Date 4/21/79 Total Depth 5555' P.B.T.D. \_\_\_\_\_

Date Completed 5/7/79 Oil Purchaser \_\_\_\_\_

**CASING RECORD**

Report of all strings set— surface, intermediate, production, etc.

Purpose of string	Size hole drilled	Size casing set (in O.D.)	Weight lbs/ft.	Setting depth	Type cement	Sacks	Type and percent additives
Surface	12-1/4"	8-5/8"	20#	625'	Common	600	3% CaCl

**LINER RECORD**

**PERFORATION RECORD**

Top, ft.	Bottom, ft.	Sacks cement	Shots per ft.	Size & type	Depth interval

**TUBING RECORD**

Size	Setting depth	Packer set at

**ACID, FRACTURE, SHOT, CEMENT SQUEEZE RECORD**

Amount and kind of material used	Depth interval treated

RECEIVED  
 STATE CORPORATION COMMISSION  
 MAY 23 1979

**INITIAL PRODUCTION**

Date of first production <u>Dry Hole</u>	Producing method (blowing, pumping, gas lift, etc.) 
RATE OF PRODUCTION PER 24 HOURS	Oil _____ Gas _____ Water _____ Gas-oil ratio _____ <small>bbls. MCF bbls. CFPB</small>
Disposition of gas (vented, used on lease or sold)	Producing interval (s)

CONSERVATION DIVISION  
 WICHITA, KANSAS

INSTRUCTIONS: As provided in KCC Rule 82-2-125, within 90 days after completion of a well, one completed copy of this Drillers Log shall be transmitted to the State Geological Survey of Kansas, 4150 Monroe Street, Wichita, Kansas 67209. Copies of this form are available from the Conservation Division, State Corporation Commission, 3830 So. Meridian (P.O. Box 17027), Wichita, Kansas 66217. Phone AC 316-522-2206. If confidential custody is desired, please note Rule 82-2-125. Drillers Logs will be on open file in the Oil and Gas Division, State Geological Survey of Kansas, Lawrence, Kansas 66044.

Operator  
Anadarko Production Company

DESIGNATE TYPE OF COMP.: OIL, GAS, DRY HOLE, SWDW, ETC.:

Well No. 1 Lease Name DYSON Dry Hole

S 17 T 25 R 23 W

**WELL LOG**

Show all important zones of porosity and contents thereof; cored intervals, and all drill-stem tests, including depth interval tested, cushion used, time tool open, flowing and shut-in pressures, and recoveries.

SHOW GEOLOGICAL MARKERS, LOGS RUN, OR OTHER DESCRIPTIVE INFORMATION.

FORMATION DESCRIPTION, CONTENTS, ETC.	TOP	BOTTOM	NAME	DEPTH
Top Soil-Blue Shale	0'	533'		
Blue Shale	533'	635'		
Shale	635'	2530'		
Shale	2530'	2575'		
Shale & Lime	2575'	4633'		
Lime & Shale	2633'	4725'		
Shale & Lime	4725'	4808'		
Lime & Shale	4808'	5130'		
Shale & Lime	5130'	5195'		
Lime & Shale	5195'	5254'		
Lime	5254'	5373'		
Lime & Shale	5373'	5444'		
Lime:	5444'	5555'		
TD		5555'		
DST #1 2460-2530 (Herrington) 20-40-75-120 open w/wk to strong blo thruout, rec 145' drlg mud, IHP 1327, IFP 20-121, ISIP 486, FFP 61-303, FSIP 506, FHP 1287.				
DST #2 2456-2566 (Herrington) 20-40-90-185 rec 250' sli GCDM, 250' muddy wtr, IFP 129-214, ISIP 632, FFP 224-309, FSIP 642, chamber press 285, rec .45 cu/ft gas, 1850 cc mud.				

USE ADDITIONAL SHEETS, IF NECESSARY, TO COMPLETE WELL RECORD.

Date Received	<i>Paul Campbell</i> Signature
	Paul Campbell, Division Production Manager Title
	May 10, 1979 Date