

FORM MUST BE FILED
FORM C-1 4/90

EFFECTIVE DATE: 5-23-90

State of Kansas
NOTICE OF INTENTION TO DRILL

FORM MUST BE SIGNED
ALL BLANKS MUST BE FILLED

Must be approved by the K.C.C. five (5) days prior to commencing well

(400' FEL & 990' FSL) Ap Ne - Se - Sw East
SW/4 Sec 10 Twp 29 S, Rg 14 X West

Expected Spud Date 5.....21.....90.....
month day year

OPERATOR: License # 5004
Name: Vincent Oil Corporation
Address: 100 No. Main, Suite 500
City/State/Zip: Wichita, Kansas 67202
Contact Person: Julie Stout
Phone: (316) 262-3573

CONTRACTOR: License #: 5422
Name: Abercrombie Drilling, Inc

Well Drilled For: Well Class: Type Equipment:
 Oil ... Inj ... Infield Mud Rotary
... Gas ... Storage Pool Ext. ... Air Rotary
... OWWO ... Disposal ... Wildcat ... Cable
... Seismic; ... # of Holes

If OWWO: old well information as follows:
Operator:
Well Name:
Comp. Date: Old Total Depth

Directional, Deviated or Horizontal wellbore? yes no
If yes, total depth location:

.....990..... feet from South line of Section
.....3040..... feet from East line of Section
(Note: Locate well on Section Plat on Reverse Side)

County: Pratt
Lease Name: Moss Well #: 1
Field Name: Bell
Is this a Prorated Field? yes no
Target Formation(s): Arbuckle
Nearest lease or unit boundary: 400
Ground Surface Elevation: applied for N/A feet MSL
Domestic well within 330 feet: yes no
Municipal well within one mile: yes no
Depth to bottom of fresh water:200-260'....
Depth to bottom of usable water:350.....
Surface Pipe by Alternate: 1 2
Length of Surface Pipe Planned to be set:360.....
Length of Conductor pipe required:n/a.....
Projected Total Depth:4750.....
Formation at Total Depth: Arbuckle
Water Source for Drilling Operations:
..... well farm pond other
DWR Permit #:
Will Cores Be Taken?: yes no
If yes, proposed zone:

AFFIDAVIT

The undersigned hereby affirms that the drilling, completion and eventual plugging of this well will comply with K.S.A. 55-101, et. seq.

- It is agreed that the following minimum requirements will be met:
1. The appropriate district office shall be notified before setting surface pipe;
 2. The minimum amount of surface pipe as specified above shall be set by circulating cement to the top; in all cases surface pipe shall be set through all unconsolidated materials plus a minimum of 20 feet into the underlying formation;
 3. If the well is dry, a plugging proposal shall be submitted to the district office. An agreement between the operator and the district office on plug length and placement is necessary prior to plugging;
 4. The appropriate district office will be notified before well is either plugged or production casing is cemented in;
 5. If an Alternate II completion, production pipe shall be cemented from below any usable water to surface within 120 days of spud date. In all cases, notify district office prior to any cementing.

I hereby certify that the statements made herein are true and to the best of my knowledge and belief.

Date: 5-17-90 Signature of Operator or Agent: Richard A. Hiebsch Title: Vice President

CONTACT DISTRICT
OFFICE PRIOR
TO SPUDDING
FOR APPROVAL
KCC OFFICE USE ONLY
W DPW 11:30am
5-18-90
BT

FOR KCC USE:
API # 15- 151-21,993-0000
Conductor pipe required NONE feet
Minimum surface pipe required 360' feet per Alt.
Approved by: DPW 5-18-90
EFFECTIVE DATE: 5-23-90
This authorization expires: 11-18-90
(This authorization void if drilling not started within 6 months of effective date.)
Spud date: _____ Agent: _____

RECEIVED
MAY 17 1990
STATE CONSERVATION COMMISSION
Wichita, Kansas

5-17-90

10
29
14W

REMEMBER TO:

- File Drill Pit Application (form CDP-1) with Intent to Drill;
- File Completion Form ACO-1 within 120 days of spud date;
- File acreage attribution plat according to field proration orders;
- Notify appropriate district office 48 hours prior to workover or re-entry;
- Submit plugging report (CP-4) after plugging is completed;
- Obtain written approval before disposing or injecting salt water.

PLAT OF ACREAGE ATTRIBUTABLE TO A WELL

State Corporation Commission, Conservation Division
200 Colorado Derby Bldg. Wichita, Kansas 67202

OPERATOR Vincent Oil Corporation LOCATION OF WELL:
 LEASE Moss 990 feet north of SE corner
 WELL NUMBER #1 3040 feet west of SE corner
 FIELD Rell SW/4 Sec. 10 T 29 R 14 E (W)
 COUNTY Pratt
 NO. OF ACRES ATTRIBUTABLE TO WELL 160 IS SECTION x REGULAR IRREGULAR?
 DESCRIPTION OF ACREAGE SW/4 IF IRREGULAR, LOCATE WELL FROM NEAREST
 CORNER BOUNDARY.

NOTE: If plat depicted is insufficient for your circumstances, you may attach your own scaled or surveyed plat.

PLAT

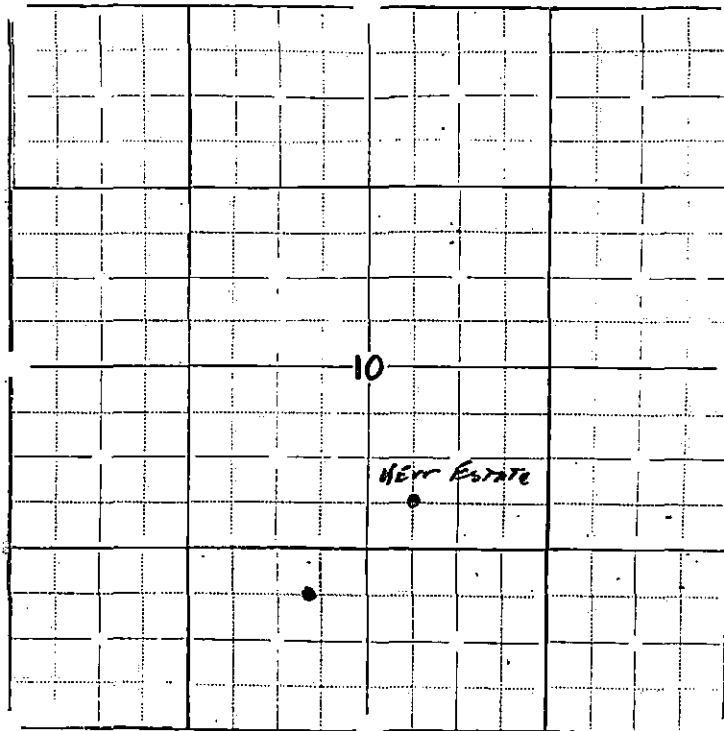

In plotting the proposed location of the well, you must show:

- 1) The manner in which you are using the depicted plat by identifying section lines, i.e. 1 section, 1 section with 8 surrounding partial sections, 4 sections, 16 sections, etc.;
- 2) the well's location relative to the location of other wells producing from the same common-source of supply in adjoining drilling units, pursuant to K.A.R. 82-3-108, 82-3-207, 82-3-312, or special orders of the Commission;
- 3) the distance of the proposed drilling location from the section's east and south lines; and
- 4) the distance to the nearest lease or unit boundary line.

I hereby certify that the statements made herein are true and to the best of my knowledge and belief.

Signature of Operator or Agent Richard A. Diebel

Date 5-17-90 Title Vice President

RECEIVED
MAY 18 1990
OFFICE OF THE
COMMISSIONER
OF REVENUE
STATE OF KANSAS
WICHITA, KANSAS