

15-155-21442-0000

For KCC Use: Effective Date: 5-23-2000 District #: 2 SGA?  Yes  No

KANSAS CORPORATION COMMISSION OIL & GAS CONSERVATION DIVISION

Form C-1 September 1999 Form must be Typed Form must be Signed All blanks must be Filled

NOTICE OF INTENT TO DRILL

Must be approved by KCC five (5) days prior to commencing well

Expected Spud Date May 5, 2000 month day year

Spot  East  West C-N/2 NE SE Sec. 19 Twp. 23S S. R. 8 2310 feet from (S) / N (circle one) Line of Section 660 feet from (E) / W (circle one) Line of Section Is SECTION  Regular  Irregular?

OPERATOR: License# 30080 Name: HONEY OIL COMPANY, INC. Address: 8526 Boxthorn City/State/Zip: Wichita, Kansas 67226 Contact Person: L. V. Bell Phone: 316/265-7300

(Note: Locate well on the Section Plat on reverse side) County: Reno Lease Name: McGONIGLE Well #: 1 Field Name: (SE/A UN-NAMED)

CONTRACTOR: License# 5929 Name: DUKE DRILLING CO., INC.

Is this a Prorated / Spaced Field?  Yes  No Target Information(s): Mississippian

Well Drilled For: Well Class: Type Equipment:  Oil  Enh Rec  Infield  Mud Rotary  Gas  Storage  Pool Ext.  Air Rotary  OWWO  Disposal  Wildcat  Cable  Seismic; # of Holes  Other

Nearest Lease or unit boundary: 660' Ground Surface Elevation: 1677 feet MSL Water well within one-quarter mile:  Yes  No Public water supply well within one mile:  Yes  No

If OWWO: old well information as follows: Operator: Well Name: Original Completion Date: Original Total Depth:

Depth to bottom of fresh water: 120' Depth to bottom of usable water: 180' Surface Pipe by Alternate:  1  2

Directional, Deviated or Horizontal wellbore?  Yes  No If Yes, true vertical depth: Bottom Hole Location: STATE CORPORATION COMMISSION KCC DKT #:

Length of Surface Pipe Planned to be set: 200+ Length of Conductor Pipe required: N/A Projected Total Depth: 3800'

Producing Formation Target: Mississippian Water Source for Drilling Operations: Well  Farm Pond  Other  DWR Permit #:

(Note: Apply for Permit with DWR ) Will Cores be taken?  Yes  No If Yes, proposed zone:

APR 14 2000 4-14-00

AFFIDAVIT

The undersigned hereby affirms that the drilling, completion and eventual plugging of this well will comply with K.S.A. 55-101, et. seq. It is agreed that the following minimum requirements will be met:

- 1. Notify the appropriate district office prior to spudding of well;
2. A copy of the approved notice of intent to drill shall be posted on each drilling rig;
3. The minimum amount of surface pipe as specified below shall be set by circulating cement to the top; in all cases surface pipe shall be set through all unconsolidated materials plus a minimum of 20 feet into the underlying formation.
4. If the well is dry hole, an agreement between the operator and the district office on plug length and placement is necessary prior to plugging;
5. The appropriate district office will be notified before well is either plugged or production casing is cemented in;
6. If an ALTERNATE II COMPLETION, production pipe shall be cemented from below any usable water to surface within 120 days of spud date. In all cases, NOTIFY district office prior to any cementing.

I hereby certify that the statements made herein are true and to the best of my knowledge and belief. Date: 4/13/00 Signature of Operator or Agent: Sally R. Byers Title: Agent

For KCC Use ONLY API # 15 - 155-21442 0000 Conductor pipe required NONE feet Minimum surface pipe required 200 feet per Alt. (1) X Approved by: JK 5-18-2000 This authorization expires: 11-18-2000 (This authorization void if drilling not started within 6 months of effective date.) Spud date: Agent:

- Remember to: - File Drill Pit Application (form CDP-1) with Intent to Drill; - File Completion Form ACO-1 within 120 days of spud date; - File acreage attribution plat according to field proration orders; - Notify appropriate district office 48 hours prior to workover or re-entry; - Submit plugging report (CP-4) after plugging is completed; - Obtain written approval before disposing or injecting salt water.

### IN ALL CASES PLOT THE INTENDED WELL ON THE PLAT BELOW

*Plat of acreage attributable to a well in a prorated or spaced field*

*If the intended well is in a prorated or spaced field, please fully complete this side of the form. If the intended well is in a prorated or spaced field complete the plat below showing that the well will be properly located in relationship to other wells producing from the common source of supply. Please show all the wells and within 1 mile of the boundaries of the proposed acreage attribution unit for gas wells and within 1/2 mile of the boundaries of the proposed acreage attribution unit for oil wells.*

API No. 15 - \_\_\_\_\_  
 Operator: \_\_\_\_\_  
 Lease: \_\_\_\_\_  
 Well Number: \_\_\_\_\_  
 Field: \_\_\_\_\_  
 Number of Acres attributable to well: \_\_\_\_\_  
 QTR / QTR / QTR of acreage: \_\_\_\_\_

Location of Well: County: \_\_\_\_\_  
 \_\_\_\_\_ feet from S / N (circle one) Line of Section  
 \_\_\_\_\_ feet from E / W (circle one) Line of Section  
 Sec. \_\_\_\_\_ Twp. \_\_\_\_\_ S. R. \_\_\_\_\_  East  West  
 Is Section \_\_\_\_\_ Regular or \_\_\_\_\_ Irregular  
 If Section Is Irregular, locate well from nearest corner boundary.  
 Section corner used: \_\_\_NE \_\_\_NW \_\_\_SE \_\_\_SW

### PLAT

*(Show location of the well and shade attributable acreage for prorated or spaced wells.)*

*(Show footage to the nearest lease or unit boundary line.)*

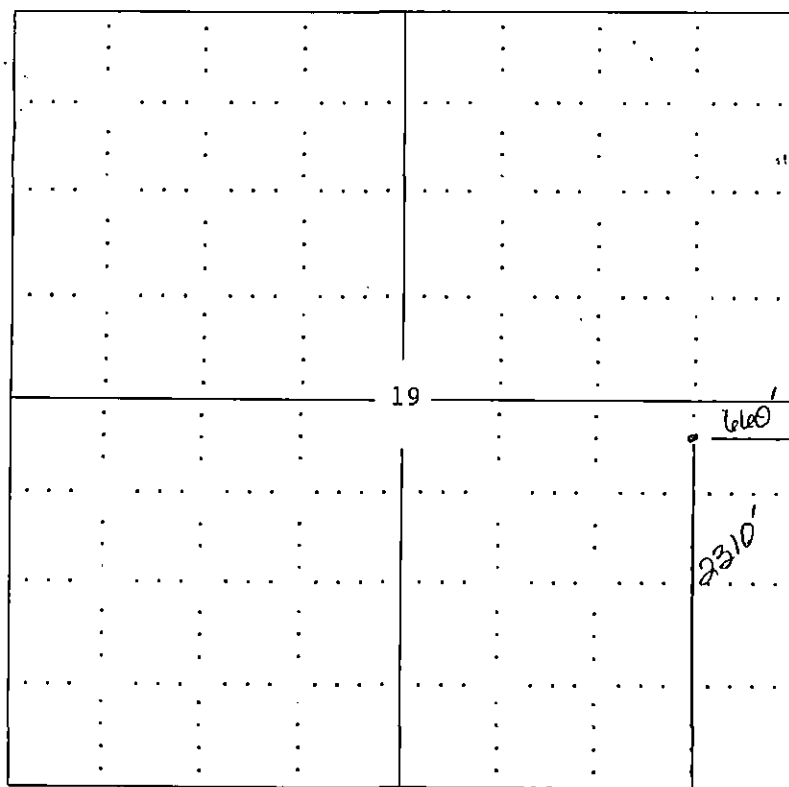

RECEIVED  
 APR 14 2000  
 SHERIFF'S OFFICE  
 CLACKAMAS COUNTY

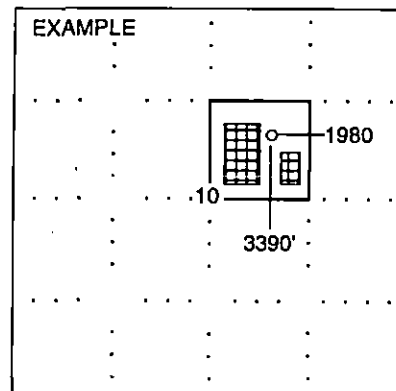

SEWARD CO.

**NOTE: In all cases locate the spot of the proposed drilling location.**

RENO COUNTY

**In plotting the proposed location of the well, you must show:**

1. The manner in which you are using the depicted plat by identifying section lines, i.e. 1 section, 1 section with 8 surrounding sections, 4 sections, etc.
2. The distance of the proposed drilling location from the section's south / north and east / west.
3. The distance to the nearest lease or unit boundary line.
4. If proposed location is located within a prorated or spaced field a certificate of acreage attribution plat must be attached: (CO-7 for oil wells; CG-8 for gas wells).