

# ORIGINAL

SIDE ONE

STATE CORPORATION COMMISSION OF KANSAS  
OIL & GAS CONSERVATION DIVISION  
WELL COMPLETION FORM  
ACO-1 WELL HISTORY  
DESCRIPTION OF WELL AND LEASE

Operator: License # 5004  
Name: Vincent Oil Corporation  
Address: 100 N. Main, Suite 500  
City/State/Zip: Wichita, KS 67202  
Purchaser: \_\_\_\_\_

Operator Contact Person: Julie Stout  
Phone ( 316 ) 262-3573

Contractor: Name: Abercrombie Drilling, Inc.  
License: 5422 7-17-90

Wellsite Geologist: Tyler Sanders

Designate Type of Completion  
 New Well  Re-Entry  Workover  
 Oil  SWD  Temp. Abd.  
 Gas  Inj  Delayed Comp.  
 Dry  Other (Core, Water Supply, etc.)

If OWO: old well info as follows:  
Operator: \_\_\_\_\_

Well Name: \_\_\_\_\_

Comp. Date \_\_\_\_\_ Old Total Depth \_\_\_\_\_

Drilling Method:  
 Mud Rotary  Air Rotary  Cable

5-21-90 5-29-90 5-30-90

Spud Date \_\_\_\_\_ Date Reached TD \_\_\_\_\_ Completion Date \_\_\_\_\_

API NO. 15- 151-21993 DD-DD

County Pratt ✓

NE SE SW Sec. 10 Twp. 29S Rge. 14 East West X

990 ✓ Ft. North from Southeast Corner of Section

3040 ✓ Ft. West from Southeast Corner of Section  
(NOTE: Locate well in section plat below.)

Lease Name Moss ✓ Well # 1

Field Name Rell

Producing Formation \_\_\_\_\_

Elevation: Ground 1990 KB 2002

Total Depth 4675 PBDT \_\_\_\_\_

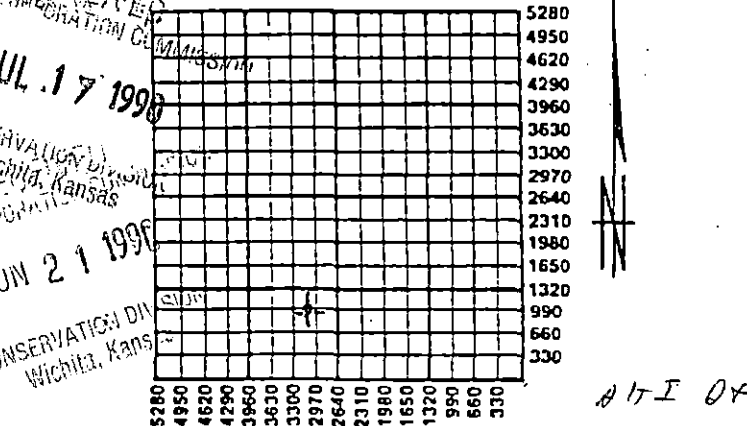

Amount of Surface Pipe Set and Cemented at 380.18 Feet

Multiple Stage Cementing Collar Used?  Yes  No

If yes, show depth set \_\_\_\_\_ Feet

If Alternate II completion, cement circulated from n/a

feet depth to \_\_\_\_\_ w/ \_\_\_\_\_ sx cmt.

INSTRUCTIONS: This form shall be completed in triplicate and filed with the Kansas Corporation Commission, 200 Colorado Derby Building, Wichita, Kansas 67202, within 120 days of the spud date of any well. Rule 82-3-130, 82-3-107 and 82-3-106 apply. Information on side two of this form will be held confidential for a period of 12 months if requested in writing and submitted with the form. See rule 82-3-107 for confidentiality in excess of 12 months. One copy of all wireline logs and drillers time log shall be attached with this form. ALL CEMENTING TICKETS MUST BE ATTACHED. Submit CP-4 form with all plugged wells. Submit CP-111 form with all temporarily abandoned wells. Any recompletion, workover or conversion of a well requires filing of ACO-2 within 120 days from commencement date of such work.

All requirements of the statutes, rules and regulations promulgated to regulate the oil and gas industry have been fully complied with and the statements herein are complete and correct to the best of my knowledge.

Signature Richard A. Hiebsch  
Title Richard A. Hiebsch, Vice President date 6-20-90

Subscribed and sworn to before me this 20th day of June, 19 90.

Notary Public Julie K. Stout

Date Commission Expires July 23, 1993

K.C.C. OFFICE USE ONLY

Letter of Confidentiality Attached  
 Wireline Log Received  
 Drillers Timelog Received

Distribution  
 KCC  SWD/Rep  NGPA  
 KGS  Plug  Other (Specify)

ORIGINAL 21



JAN 1970

SIDE TWO

Operator Name Vincent Oil Corporation Lease Name Moss Well # 1

Sec. 10 Twp. 29S Rge. 14 County Pratt

INSTRUCTIONS: Show important tops and base of formations penetrated. Detail all cores. Report all drill stem tests giving interval tested, time tool open and closed, flowing and shut-in pressures, whether shut-in pressure reached static level, hydrostatic pressures, bottom hole temperature, fluid recovery, and flow rates if gas to surface during test. Attach extra sheet if more space is needed. Attach copy of log.

Drill Stem Tests Taken [X] Yes [ ] No
Samples Sent to Geological Survey [X] Yes [ ] No
Cores Taken [ ] Yes [X] No
Electric Log Run [X] Yes [ ] No

Formation Description table with columns: Name, Top, Bottom. Rows include Onaga Shale, Wabaunsee, Stotler, Heebner, Brown Lime, Lansing, Base Kansas City, Marmaton, Conglomerate, Erosional Viola, Solid Viola, Simpson Sh.

CASING RECORD [ ] New [ ] Used Simpson Sh 4568 (-2566)

Table with columns: Purpose of String, Size Hole Drilled, Size Casing Set, Weight Lbs./Ft., Setting Depth, Type of Cement, # Sacks Used, Type and Percent Additives. Row 1: Surface, 12 1/4, 8 5/8, 28#, 380.18, 60/40 pozmix, 225, 3% cc, 2% gel.

PERFORATION RECORD table with columns: Shots Per Foot, Specify Footage of Each Interval Perforated, Acid, Fracture, Shot, Cement Squeeze Record (Amount and Kind of Material Used), Depth.

TUBING RECORD Size Set At Packer At Liner Run [ ] Yes [ ] No

Date of First Production Producing Method [ ] Flowing [ ] Pumping [ ] Gas Lift [ ] Other (Explain)

Table with columns: Estimated Production Per 24 Hours, Oil Bbls., Gas Mcf, Water Bbls., Gas-Oil Ratio, Gravity.

Disposition of Gas: [ ] Vented [ ] Sold [ ] Used on Lease
METHOD OF COMPLETION: [ ] Open Hole [ ] Perforation [ ] Dually Completed [ ] Commingled
Production Interval

Vincent Oil Corporation

#1, Moss

DST #1 4417-4516  
45/60/45/60  
1st open: Strong blow off bottom in 6 min.  
2nd open: Strong blow thru out  
Rec: 742' of GIP  
40' of Gassy mud with specks of oil  
IFP 67-67# FFP 67-67#  
ISIP 211# FSIP 211#

DST #2 4547-4574  
30/30/30/30  
1st open: Weak 1/2" blow  
2nd open: No blow - flushed tool - no help  
Rec: 5' Mud with specks of oil  
IFP 33-33# FFP 33-33#  
ISIP 33# FSIP 33#  
BHT 119 degrees

DST #3 4548-4582  
30/30/15/30  
1st open: Weak blow died in 20 min.  
2nd open: No blow  
Rec: 3' Mud  
IFP 22-22# FFP 22-22#  
ISIP 22# FSIP 22#  
BHT 119 degrees

DST #4 4657-4675  
45/60/45/60  
1st open: 1/2" building to 4 1/2" blow  
2nd open: Very weak building to 1 1/2"  
Rec: 1' Free oil (gravity low 30's)  
14' Oil specked muddy water  
105' Muddy saltwater Chlds 26,000  
Mud 7,000  
IFP 44-67# FFP 67-100#  
ISIP 1498# FSIP 1442#  
BHT 128 degrees

REC'D  
STATE COMMISSION

JUN 21 1990

CONSERVATION DIVISION  
Wichita Kansas

# ABERCROMBIE DRILLING, INC.

801 UNION CENTER  
WICHITA, KANSAS 67202

## DRILLER'S WELL LOG

Vincent Oil Corporation  
Moss #1  
App. NE SE SW  
Sec. 10-29S-14W  
Pratt County, Kansas

05-21-90	9:15 p.m. to 11:00 p.m.	0 to 220 220 to 245	Top soil and sand Red Beds
05-22-90	11:00 p.m. to 1:00 a.m.	245 to 385	Red Beds
	11:45 a.m. to 12:00 a.m.	385 to 840	Shale and Clay
	3:30 p.m. to 4:15 p.m.	840 to 852 852 to 875	Shale and Shells Anhydrite
	4:30 p.m. to 11:00 p.m.	875 to 1565	Shale and Shells
05-23-90	11:15 p.m. to 4:00 a.m.	1565 to 1995	Shale
	6:00 a.m. to 7:00 a.m.	1995 to 2043	Lime and Shale
	7:00 a.m. to 11:00 p.m.	2043 to 2643	Lime and Shale
05-24-90	11:00 p.m. to 11:00 p.m.	2643 to 3384	Lime and Shale
05-25-90	11:00 p.m. to 11:00 p.m.	3384 to 4020	Lime and Shale
05-26-90	11:00 p.m. to 11:00 p.m.	4020 to 4490	Lime and Shale
05-27-90	11:00 p.m. to 11:00 p.m.	4490 to 4574	Lime and Shale
05-28-90	10:00 a.m. to 10:30 a.m.	4574 to 4582	Lime
	8:00 p.m. to 8:30 p.m.		
	9:30 p.m. to 11:00 p.m.	4582 to 4607	Lime and Shale
05-29-90	11:00 p.m. to 12:45 a.m.	4607 to 4670	Lime and Shale
		4670 to 4675	Lime
			Rotary Total Depth
05-30-90	plugged and abandoned		

RECEIVED  
SEAFAC CORPORATION / COMMISSION

JUN 21 1990

CONSERVATION DIVISION  
Wichita, Kansas

ORIGINAL

RANKEN ENERGY CORP.

HALLIBURTON SERVICES

REMIT TO:  
P.O. BOX 951046  
DALLAS, TX 75395-1046

INVOICE

APR 26 1990

A Halliburton Company

INVOICE NO.	DATE
908244	04/20/1990

WELL LEASE NO./PLANT NAME	WELL/PLANT LOCATION	STATE	WELL/PLANT OWNER
SCHWIETZER 2	NESS	KS	SAME
SERVICE LOCATION	CONTRACTOR	JOB PURPOSE	TICKET DATE
NESS CITY	EMPHASIS	CEMENT SURFACE CASING	04/20/1990
ACCT. NO.	CUSTOMER AGENT	VENDOR NO.	CUSTOMER P.O. NUMBER
724776	T.C. LARSON		
		SHIPPED VIA	FILE NO.
		COMPANY TRUCK	93826

RANKEN ENERGY CORPORATION  
2325 S.W. 15TH  
EDMOND, OK 73013

DIRECT CORRESPONDENCE TO:  
SUITE 600  
COLORADO DERBY BUILDING  
WICHITA, KS 67202-0000

PRICE REF. NO.	DESCRIPTION	QUANTITY	U/M	UNIT PRICE	AMOUNT
PRICING AREA - MID CONTINENT					
000-117	MILEAGE	16	MI	2.20	35.20
		1	UNT		
001-016	CEMENTING CASING	254	FT	395.00	395.00
		1	UNT		
030-503	CMTG PLUG LA-11, CP-1, CP-3, TOP	8 5/8	IN	59.00	59.00
		1	EA		
504-308	STANDARD CEMENT	90	SK	5.45	490.50 *
506-105	POZMIX A	60	SK	2.88	172.80 *
506-121	HALLIBURTON-GEL 2%	3	SK	.00	N/C *
509-406	ANHYDROUS CALCIUM CHLORIDE	4	SK	26.25	105.00 *
500-207	BULK SERVICE CHARGE	158	CFT	.95	150.10 *
500-306	MILEAGE CMTG MAT DEL OR RETURN	108.16	TMI	.70	75.71 *
	INVOICE SUBTOTAL				1,483.31
	DISCOUNT-(BID)				326.31-
	INVOICE BID AMOUNT				1,157.00
	*-KANSAS STATE SALES TAX				32.96
	INVOICE TOTAL - PLEASE PAY THIS AMOUNT				\$1,189.96

Vendor #	
Acct. #	
WELL / PROSPECT NAME	
Well #	Schwieterz #2-11
Amt. \$	
BCP <input checked="" type="checkbox"/>	ACP <input type="checkbox"/>
Due Date	5-26-90

2000 10  
JUL 17 1990  
CONSERVATION DIVISION  
Wichita, Kansas

TERMS INVOICES PAYABLE NET BY THE 20TH OF THE FOLLOWING MONTH AFTER DATE OF INVOICE. UPON CUSTOMER'S DEFAULT IN PAYMENT OF CUSTOMER'S ACCOUNT BY THE LAST DAY OF THE MONTH FOLLOWING THE MONTH IN WHICH THE INVOICE IS DATED, CUSTOMER AGREES TO PAY INTEREST THEREON AFTER DEFAULT AT THE HIGHEST LAWFUL CONTRACT RATE APPLICABLE BUT NEVER TO EXCEED 18% PER ANNUM. IN THE EVENT IT BECOMES NECESSARY TO EMPLOY AN ATTORNEY TO ENFORCE COLLECTION OF SAID ACCOUNT, CUSTOMER AGREES TO PAY ALL COLLECTION COSTS AND ATTORNEY FEES IN THE AMOUNT OF 20% OF THE AMOUNT OF THE UNPAID ACCOUNT.

ORIGINAL

RANKEN ENERGY CORP.



HALLIBURTON SERVICES

REMIT TO: P.O. BOX 951046 DALLAS, TX 75395-1046

INVOICE

MAY 04 1990

A Halliburton Company

INVOICE NO.	DATE
908493	04/28/1990

WELL LEASE NO./PLANT NAME		WELL/PLANT LOCATION		STATE	WELL/PLANT OWNER
SCHWEITZER 2-11		NESS		KS	SAME
SERVICE LOCATION	CONTRACTOR	JOB PURPOSE		TICKET DATE	
NESS CITY	EMPHASIS	CEMENT PRODUCTION CASING		04/28/1990	
ACCT. NO.	CUSTOMER AGENT	VENDOR NO.	CUSTOMER P.O. NUMBER	SHIPPED VIA	FILE NO.
724776	T.C. LARSON			COMPANY TRUCK	94295

DIRECT CORRESPONDENCE TO:

RANKEN ENERGY CORPORATION  
2325 S.W. 15TH  
EDMOND, OK 73013

SUITE 600  
COLORADO DERBY BUILDING  
WICHITA, KS 67202-0000

PRICE REF. NO.	DESCRIPTION	QUANTITY	U/M	UNIT PRICE	AMOUNT
PRICING AREA - MID CONTINENT					
000-117	MILEAGE	19	MI	2.20	41.80
		1	UNT		
007-013	MULT STAGE CEMENTING-1ST STAGE	4520	FT	1,111.00	1,111.00
001-016		1	UNT		
007-161	MULT STAGE CEMENTING-ADD STAGE	1	STG	865.00	865.00
		1	UNT		
018-317	SUPER FLUSH	12	SK	74.00	888.00
314-163	CLAYFIX II	2	GAL	17.25	34.50
26	INSERT VALVE F. S.- 5 1/2" 8RD	1	EA	223.00	223.00 *
847.6318					
27	FILL-UP UNIT 5 1/2"-6 5/8"	1	EA	30.00	30.00 *
815.19311					
71	MULT STAGE CEMENTER 5-1/2" 8RD	1	EA	2,450.00	2,450.00 *
813.10354					
75	PLUG SET 5 1/2"	1	EA	400.00	400.00 *
812.0162					
40	CENTRALIZER 5-1/2" MODEL S-4	9	EA	44.00	396.00 *
807.93022					
320	CEMENT BASKET 5 1/2"	3	EA	90.00	270.00 *
800.8883					
504-118	HALLIBURTON LIGHT CEMENT -PREM	250	SK	4.92	1,230.00 *
504-308	STANDARD CEMENT	125	SK	5.45	681.25 *
504-308	STANDARD CEMENT	75	SK	5.45	408.75 *
506-105	POZMIX A	50	SK	2.88	144.00 *
506-121	HALLIBURTON-GEL 2%	2	SK	.00	N/C *
509-968	SALT	1574	LB	.073	114.90 *
507-775	HALAD-322	88	LB	5.60	492.80 *
507-210	FLOCELE	94	LB	1.23	115.62 *
508-127	CAL SEAL	6	SK	14.90	89.40 *
508-291	GILSONITE	900	LB	.35	315.00 *
504-308	STANDARD CEMENT	50	SK	5.45	272.50 *
509-968	SALT	390	LB	.073	28.47 *

JUL 17 1990

CONSERVATION DIVISION  
Wichita, Kansas

\*\*\*\*\* CONTINUED ON NEXT PAGE \*\*\*\*\*

TERMS INVOICES PAYABLE NET BY THE 20TH OF THE FOLLOWING MONTH AFTER DATE OF INVOICE. UPON CUSTOMER'S DEFAULT IN PAYMENT OF CUSTOMER'S ACCOUNT BY THE LAST DAY OF THE MONTH FOLLOWING THE MONTH IN WHICH THE INVOICE IS DATED, CUSTOMER AGREES TO PAY INTEREST THEREON AFTER DEFAULT AT THE HIGHEST LAWFUL CONTRACT RATE APPLICABLE BUT NEVER TO EXCEED 18% PER ANNUM. IN THE EVENT IT BECOMES NECESSARY TO EMPLOY AN ATTORNEY TO ENFORCE COLLECTION OF SAID ACCOUNT, CUSTOMER AGREES TO PAY ALL COLLECTION COSTS AND ATTORNEY FEES IN THE AMOUNT OF 20% OF THE AMOUNT OF THE UNPAID ACCOUNT.

ORIGINAL

# HALLIBURTON SERVICES

RANKEN ENERGY CORPORATION

P.O. BOX 951046  
DALLAS, TX 75395-1046

INVOICE

MAY 04 1990

A Halliburton Company

INVOICE NO. DATE

908493 04/28/1990

WELL LEASE NO./PLANT NAME WELL/PLANT LOCATION STATE WELL/PLANT OWNER

SCHWEITZER 2-11 NESS KS SAME

SERVICE LOCATION CONTRACTOR JOB PURPOSE TICKET DATE

NESS CITY EMPHASIS CEMENT PRODUCTION CASING 04/28/1990

ACCT. NO. CUSTOMER AGENT VENDOR NO. CUSTOMER P.O. NUMBER SHIPPED VIA FILE NO.

724776 T.C. LARSON COMPANY TRUCK 94295

DIRECT CORRESPONDENCE TO:

RANKEN ENERGY CORPORATION  
2325 S.W. 15TH  
EDMOND, OK 73013

SUITE 600  
COLORADO DERBY BUILDING  
WICHITA, KS 67202-0000

PRICE REF. NO. DESCRIPTION QUANTITY U/M UNIT PRICE AMOUNT

508-291	GILSONITE	350	LB	.35	122.50 *
508-127	CAL SEAL	2	SK	14.90	29.80 *
507-775	HALAD-322	35	LB	5.60	196.00 *
500-207	BULK SERVICE CHARGE	615	CFT	.95	584.25 *
500-306	MILEAGE CMTG. MAT DEL OR RETURN	519.47	TMI	.70	363.63 *

INVOICE SUBTOTAL 11,898.17

DISCOUNT-(BID) 2,974.49-

INVOICE BID AMOUNT 8,923.68

\*--KANSAS STATE SALES TAX 280.97

Vendor # \_\_\_\_\_

Acct. # \_\_\_\_\_

WELL / PROSPECT NAME

Well # Schweitzer 2-11

Amt. \$ \_\_\_\_\_

BCP \_\_\_\_\_ ACP X LOE \_\_\_\_\_

Due Date 6-4-90

JUL 17 1990  
CONSERVATION DIVISION  
Wichita, Kansas

INVOICE TOTAL - PLEASE PAY THIS AMOUNT =====> \$9,204.65

TERMS INVOICES PAYABLE NET BY THE 20TH OF THE FOLLOWING MONTH AFTER DATE OF INVOICE. UPON CUSTOMER'S DEFAULT IN PAYMENT OF CUSTOMER'S ACCOUNT BY THE LAST DAY OF THE MONTH FOLLOWING THE MONTH IN WHICH THE INVOICE IS DATED, CUSTOMER AGREES TO PAY INTEREST THEREON AFTER DEFAULT AT THE HIGHEST LAWFUL CONTRACT RATE APPLICABLE BUT NEVER TO EXCEED 18% PER ANNUM. IN THE EVENT IT BECOMES NECESSARY TO EMPLOY AN ATTORNEY TO ENFORCE COLLECTION OF SAID ACCOUNT, CUSTOMER AGREES TO PAY ALL COLLECTION COSTS AND ATTORNEY FEES IN THE AMOUNT OF 20% OF THE AMOUNT OF THE UNPAID ACCOUNT.