

STATE OF KANSAS
STATE CORPORATION COMMISSION

Give All Information Completely
Make Required Affidavit
Mail or Deliver Report to:
Conservation Division
State Corporation Commission
211 No. Broadway
Wichita, Kansas

WELL PLUGGING RECORD

STAFFORD County, Sec. 19 Twp. 25S Rge. 14W (X) (W)

Location as "NE/CNW/SW" or footage from lines APPROX. C NW NW

Lease Owner PETROLEUM, INC.

Lease Name WILSON, IV Well No. 1

Office Address ROUTE 2, GREAT BEND, KANSAS

Character of Well (completed as Oil, Gas or Dry Hole) DRY HOLE

Date well completed DECEMBER 5, 19 61

Application for plugging filed DECEMBER 5, 19 61

Application for plugging approved DECEMBER 5, 19 61

Plugging commenced DECEMBER 5, 19 61

Plugging completed DECEMBER 5, 19 61

Reason for abandonment of well or producing formation NO PRODUCIBLE FORMATIONS

If a producing well is abandoned, date of last production NONE 19

Was permission obtained from the Conservation Division or its agents before plugging was commenced? YES

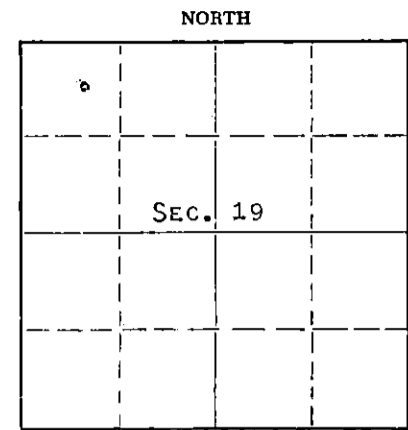

Locate well correctly on above Section Plat

Name of Conservation Agent who supervised plugging of this well W. L. LACKAMP, R.R. #1, STAFFORD, KANSAS

Producing formation _____ Depth to top _____ Bottom _____ Total Depth of Well 4332 Feet

Show depth and thickness of all water, oil and gas formations. (LOGGED R.T.D.)

OIL, GAS OR WATER RECORDS

CASING RECORD

FORMATION	CONTENT	FROM	TO	SIZE	PUT IN	PULLED OUT
				8-5/8"	320'	NONE

Describe in detail the manner in which the well was plugged, indicating where the mud fluid was placed and the method or methods used in introducing it into the hole. If cement or other plugs were used, state the character of same and depth placed, from _____ feet to _____ feet for each plug set.

MUDDED UP WITH HEAVY MUD TO 300' FOLLOWED BY WOODEN PLUG AND 1/4 SACK HULLS. PLACED 25 SACKS CEMENT THROUGH DRILL PIPE ON TO HULLS. MUDDED UP WITH HEAVY MUD TO 35' FOLLOWED BY WOODEN PLUG, 1/4 SACK HULLS AND 10 SACKS CEMENT TO BASE OF WELL CELLAR.

RECEIVED
STATE CORPORATION COMMISSION

JAN 29 1962

CONSERVATION DIVISION
Wichita, Kansas

1-29-62

(If additional description is necessary, use BACK of this sheet)

Name of Plugging Contractor GARVEY DRILLING COMPANY

Address ROUTE #2, GREAT BEND, KANSAS

STATE OF KANSAS, COUNTY OF BARTON, ss.
DON SEARLE (employee of owner) or (XXXXXXXXXXXX) of the above-described

well, being first duly sworn on oath, says: That I have knowledge of the facts, statements, and matters herein contained and the log of the above-described well as filed and that the same are true and correct. So help me God. DON SEARLE, DIST. PROD. SUPT.

(Signature) Don Searle

(Address)

SUBSCRIBED AND SWORN TO before me this 26TH day of JANUARY, 19 62

Arthur J. Wile

Notary Public.

My commission expires APRIL 14, 1963



WELL LOG

COMPANY PETROLEUM, INCORPORATED

SEC. 19 T. 25S R. 14W

FARM WILSON "V" NO. 1

LOC. Approx. C-NW, NW

TOTAL DEPTH 4332'

COUNTY STAFFORD CO., KANSAS

COMM. November 25, 1961 COMP. December 6, 1961

CONTRACTOR GARVEY DRILLING COMPANY

CASING 8-5/8" @ 320' w/275 sax.

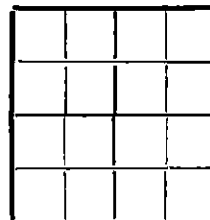

ELEVATION 2000' KB

PRODUCTION D & A

FIGURES INDICATE BOTTOM OF FORMATIONS

195	Surface soil & sand
240	Shale
320	Red bed
805	Red bed & shale
830	Anhydrite
1780	Shale
1965	Shale & lime
2326	Lime
2506	Shale & lime
3420	Lime & shale
3590	Lime
3790	Lime & shale
4202	Lime
4248	Chert
4332	Shale & lime
4332	T. D.

RECEIVED
STATE CORPORATION COMMISSION
JAN 29 1962
CONSERVATION DIVISION
Wichita, Kansas

State of KANSAS }
County of BARTON } ss

I, VERNE A. MORRIS of GARVEY DRILLING COMPANY
upon oath state the above and foregoing is a true and correct copy of the log of the #1 WILSON "V" well.

Subscribed and sworn to before me this 25th day of January 1962

My Commission Expires: April 14, 1963

Verne A. Morris

Arthur J. Miles
NOTARY PUBLIC