

STATE OF KANSAS
STATE CORPORATION COMMISSION

Give All Information Completely
Make Required Affidavit
Mail or Deliver Report to:
Conservation Division
State Corporation Commission
800 Bittling Building
Wichita, Kansas

WELL PLUGGING RECORD

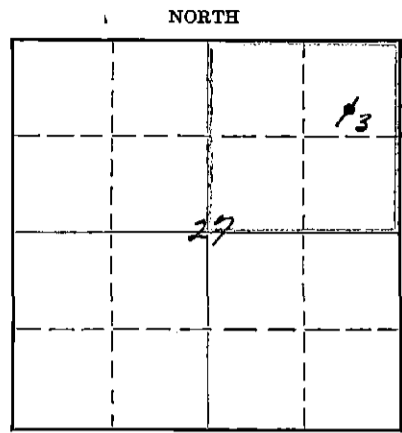

Locate well correctly on above Section Flat

Stafford County. Sec. 27 Twp. 25S Rge. (E) 14 (W)
Location as "NE/CNW 1/4 SW 1/4" or footage from lines C. S./2 NE/4 NE/4
Lease Owner Skelly Oil Company, et al
Lease Name Kipp "A"
Office Address Box 1650, Tulsa, Oklahoma
Character of Well (completed as Oil, Gas or Dry Hole) Oil
Date well completed October 2, 19 41
Application for plugging filed June 13, 19 51
Application for plugging approved June 14, 19 51
Plugging commenced June 26, 19 51
Plugging completed July 18, 19 51
Reason for abandonment of well or producing formation Depleted oil well

If a producing well is abandoned, date of last production January 31, 19 51
Was permission obtained from the Conservation Division or its agents before plugging was commenced? Yes

Name of Conservation Agent who supervised plugging of this well Mr. M. A. Rives
Producing formation Kans. City Lime Depth to top 3839' Bottom 3864' Total Depth of Well 3900 Feet
Show depth and thickness of all water, oil and gas formations.

OIL, GAS OR WATER RECORDS

CASING RECORD

Formation	Content	From	To	OD Size	Put In	Pulled Out
Kansas City Lime	Oil	3839'	3864'	8-5/8"	391'9"	None
				5-1/2"	3868'3"	2606'6"

Describe in detail the manner in which the well was plugged, indicating where the mud fluid was placed and the method or methods used in introducing it into the hole. If cement or other plugs were used, state the character of same and depth placed, from feet to feet for each plug set.

Sand 3900' to 3830'
5 sacks of cement 3830' to 3790'
Mud laden fluid 3790' to 200'
Rock bridge 200' to 190'
8 sacks of cement 190' to 170'
7 sacks of cement 170' to 150'
Mud laden fluid 150' to 30'
10 sacks of cement 30' to 6'
Surface soil 6' to 0'

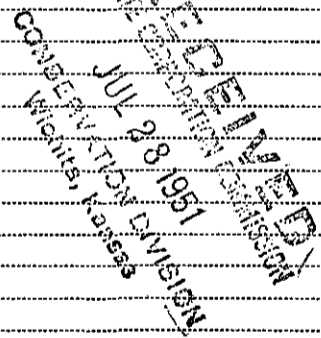

7-28-51

(If additional description is necessary, use BACK of this sheet)

Correspondence regarding this well should be addressed to Skelly Oil Company
Address Box 391
Hutchinson, Kansas

STATE OF Kansas, COUNTY OF Reno, ss.
H. E. Wamsley (employee of owner) in presence of operation of the above-described well,
being first duly sworn on oath, says: That I have knowledge of the facts, statements, and matters herein contained and the log of the above-described well as filed and that the same are true and correct. So help me God.

(Signature) [Signature]
Box 391, Hutchinson, Kansas (Address)

SUBSCRIBED AND SWORN to before me this 27th day of July, 19 51

My commission expires April 7, 1955

Josephine L. Johnson Notary Public.

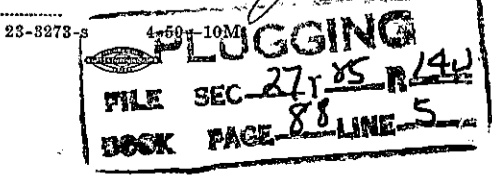

SKELLY OIL COMPANY

REPORT OF CHANGE IN WELL RECORD

Give complete description of all cleaning out, deepening, plugging back and fishing jobs, changes in casing, material lost in hole, etc., not recorded in original well record.

LEASE NAME Kipp "A" (Stafford County, Kans.) WELL NO. 3

CLEANING OUT RECORD				PLUGGING BACK OR DEEPENING RECORD			
Date commenced.....	19.....			Date commenced.....	June 21, 19 51		
Date completed.....	19.....			Date completed.....	July 16, 19 51		
Cleaned out from.....	to.....	T. D.....		Plugged back or deepened from.....	3900' to 0'	T. D.....	P & A
Prod. before.....	bbls. oil.....	bbls. water.....	cu. ft. gas.....	Prod. before.....	0 bbls. oil.....	1000 bbls. water.....	cu. ft. gas.....
Prod. after.....	bbls. oil.....	bbls. water.....	cu. ft. gas.....	Prod. after.....	bbls. oil.....	bbls. water.....	cu. ft. gas.....
Kind of tools used:.....				Kind of tools used:.....	Cable		
Tools owned by:.....				Tools owned by:.....	Barnes & Sons		

SHOT RECORD

Date	Size shot	Shot between	Size of shell	Put in by (Co.)	Length anchor	Distance below casing	Damage to casing or casing shoulder
		Qts.					
		Ft. and Ft.					

CHANGES IN CASING RECORD

SIZE	Wt.	Thds.	Where Set	PULLED OUT			LEFT IN			KIND	Cond'n	CEMENTING	
				Jts.	Feet	In.	Jts.	Feet	In.			Sacks Used	Method Employed
5-1/2"	17 1/2	ER	3840'	83	2606	6	27	1261	9	55 R2	C		

Liner set at..... Length..... Perforated at.....

Packer set at..... Size and kind.....

REMARKS (Give review of work accomplished and any other comment of interest) Moved in and rigged up plugging machine of Barnes & Sons on June 21, 1951. On June 26, plugged back with

Sand 3900' to 3830'

5 sacks of cement 3830' to 3790'

Shot off 5 1/2" casing at 3101', could not pull; spotted 65 barrels

(Use reverse side for continuation of remarks and for formation record).

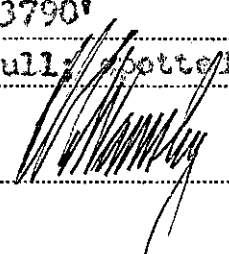

Superintendent.

REMARKS (Continued)

of oil behind casing and could not pull. Shot off casing at 3010', would not move. Shot off at 2914' and casing started, then stuck and would not move. Shot casing at 2821' and pulled 3606'6" of 5 1/2" O.D., 17# casing and finished plugging as follows:

RECORD OF FORMATIONS

FORMATION	TOP	BOTTOM	REMARKS
			Indicate Casing Points, Describe Shows of Oil, Gas and Water, etc.
Mud laden fluid		3790'	to 200'
Rock bridge		200'	to 190'
8 sacks of cement		190'	to 170'
7 sacks of cement		170'	to 150'
Mud laden fluid		150'	to 30'
10 sacks of cement		30'	to 6'
Surface soil		6'	to 0'

Plugged and abandoned July 19, 1951.

SKELLY OIL COMPANY

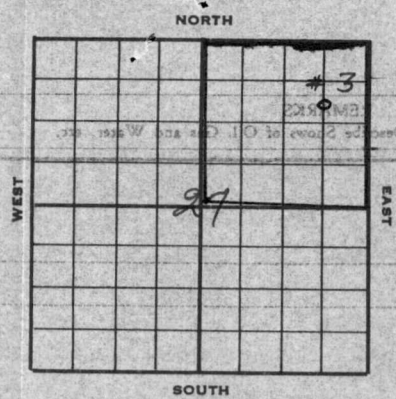

Well Record

Lease Name and No. Kipp "A" 7711 Well No. 3 Elev. 1979' DF

Lease Description N³/₄, section 27-25S-14W

Location made Sept. 3, 1941 by Stafford County Engineer

990 feet from North line 660 feet from East line

990 feet from South line 660 feet from West line of Sec. 27

Work com'd Sept. 4, 1941 Rig comp'd Sept. 6, 1941 Drlg. com'd Sept. 9, 1941 Drlg. comp'd Sept. 29, 1941

Rig Contractor Built by drilling contractor

Drilling Contractor Sodine Drilling Company, Great Bend, Kansas.

Rotary Drilling from Top to 3840' Cable Tool Drilling from 3840' to 3900'

Commenced Producing October 2, 1941 Initial Prod. before shot or acid 800' OIH Bbls.

Dry Gas Well Press. no str., to estb. S.C.O. potential of 606 bbls. Bbls.

Casing Head Gas Pressure _____ Volume _____ Cu. ft.

Braden Head (8-5/8" 251400) Gas Pressure _____ Volume _____ Cu. ft.

Braden Head (_____) Gas Pressure _____ Volume _____ Cu. ft.

PRODUCING FORMATION Kansas City Lime Top 3839' Bottom 3864' TOTAL DEPTH 3900'

CASING RECORD

Size	Wt.	Thds.	Where Set	PULLED OUT			LEFT IN			KIND	Cond'n	CEMENTING	
				Jts.	Feet	In.	Jts.	Feet	In.			Sacks Used	Method Employed
8-5/8"OD	24	8	397				20	391	9	Lapweld "C"		250	Halliburton
5-1/2"OD	17	8	3840				110	3868	3	Seamless "A"		125	Halliburton
(8-5/8" casing set 10' in cellar and 5 1/2" cased to derrick floor)													
(Used one 5 1/2"OD Baker Combination Guide and Float Shoe)													

Liner Set at _____ Length _____ Perforated at _____

Liner Set at _____ Length _____ Perforated at _____

Packer Set at _____ Size and Kind _____

Packer Set at _____ Size and Kind _____

SHOT OR ACID TREATMENT RECORD

	FIRST	SECOND	THIRD	FOURTH
Date	<u>Oct. 1, 1941</u>			
Acid Used	<u>2500</u>			
Size Shot				
Shot Between	<u>3840 Ft. and 3900 Ft.</u>			
Size of Shell				
Put in by (Co.)				
Length anchor				
Distance below Cas'g				
Damage to Casing or Casing Shoulder	<u>None</u>			

SIGNIFICANT GEOLOGICAL FORMATIONS

NAME	Top	Bottom	GAS		OIL		REMARKS
			From	To	From	To	
<u>Topeka Line</u>	<u>3185</u>						
<u>Lansing Line</u>	<u>3678</u>				<u>3777</u>	<u>3780</u>	<u>corous & oil stained</u>
					<u>3839</u>	<u>3853</u>	<u>Pay Formation</u>
					<u>3859</u>	<u>3864</u>	<u>Pay Formation</u>

CLEANING OUT RECORDS

	DATE COMMENCED	DATE COMPLETED	PROD. BEFORE	PROD. AFTER	REMARKS
1st					See Reverse for other details.
2nd					" " " " "
3rd					" " " " "
4th					" " " " "

PLUGGING BACK AND DEEPENING RECORDS

	Date Commenced	Date Completed	No. Feet Plugged Back or Deepened	Prod. Before	Prod. After	REMARKS
1st						See Reverse for other details.
2nd						" " " " "
3rd						" " " " "
4th						" " " " "

(See Reverse for Record of Formation)

RECORD OF FORMATIONS

FORMATION TOP BOTTOM REMARKS
Indicate Casing Points, Describe Shows of Oil, Gas and Water, etc.

Work com'd	19	Well No	19	Lease Name and No	
Packer Set at		Size and Kind		Lease Description	
Packer Set at		Size and Kind		Location made	
Surf. soil and clay	0	20			
Sand	20	215			
Red bed	215	316			
Sand	316	330			
Red bed	330	406			

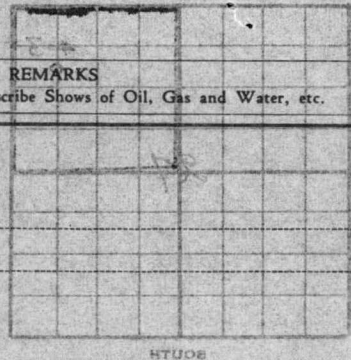

Red rock and shells	406	455			
Red bed	455	460			
Shale	460	1140			
Shale and shells	1140	1455			
Lime and shale	1455	1700			
Lime	1700	1855			
Lime	1855	2020			
Lime and shale	2020	2070			
Shale	2070	2140			
Shale	2140	2195			

Shale	2195	2225			
Sand	2225	2255			
Sandy lime	2255	2390			
Shale and lime	2390	2435			
Broken lime	2435	2525			
Shale and lime	2525	2740			
Lime	2740	2780			
Shale and shells	2780	2865			
Shale and lime	2865	2955			
Lime	2955	3030			
Lime and shale	3030	3090			
Shale	3090	3140			
Shale and lime	3140	3205			

White lime	3205	3280			
Sandy lime	3280	3300			
Lime and shale	3300	3355			
Lime	3355	3405			
Broken lime	3405	3465			
Lime	3465	3540			
Shale	3540	3595			
Broken lime	3595	3610			
Shale	3610	3650			
Sandy shale	3650	3678			
Grey crystalline	3678	3684			
Lime and shale	3684	3750			
Cherty lime	3750	3794			
Soft porous colitic lime	3794	3805			
Medium hard grey lime	3805	3814			
Medium soft grey colitic	3814	3818			
Lime	3818	3833			
Grey shale and lime	3833	3845			
Grey crystalline	3845	3846			

PLUGGING
 FILE SEC 27 T 25 R 140
 BOOK PAGE 88 LINE 5

Shale	3846	3846			
Steel line measurement	3846	3840			

Grey cherty lime	3846	3853			
Grey cherty lime	3853	3859			
Grey and brown colitic lime	3859	3864			
Grey cherty lime	3864	3872			
Grey cherty lime	3872	3884			
Broken colitic lime	3884	3890			
Grey cherty lime	3890	3895			
Grey shale w/ little grey	3895	3900			
"crystalline" lime, hard	3900				

TOTAL DEPTH - 3900' (See Reverse for Record of Formations) Stopped drilling on 9/29/41.

Ran 2" tubing and on Oct. 1st, treated with acid as follows:

ACID TREATMENT NO. 1 - Between 3840' and 3900'

Treatment put in by Morgan Co., 10/1/41, using 2500 gallons of Morgan acid and 151 barrels of oil to fill hole and flush.

TIME	OP	TP	REMARKS:
10:45 AM			Filled hole with 116 barrels of oil then started acid in
10:59 "	1300'	950'	775 gallons of acid in hole
11:08 "	550'	200'	1200 gallons of acid in hole
11:19 "	150'	Vac.	2500 gallons of acid in hole then start oil flush
11:45 "	Vac.	Vac.	Flushed hole with 35 barrels of oil to complete treatment.

After acid treatment, ran rods and PDS 50 barrels of cut oil and acid water in 5 hours.

On Oct. 2nd, PDS 8 hours, 228.72 barrels of oil to establish 24 hour S.O.C. potential of 686 barrels which allows 15 barrels per day for the remainder of October, 1941.

SLOPE TEST DATA

Depth	Angle	Horiz.	Vert.
250'	0		
500'	1/2	2.2	.0
750'	1/2	2.2	.0
1000'	1/2	2.2	.0
1250'	1/2	2.2	.0
1500'	1	4.4	.1
1750'	1	4.4	.1
2000'	1	4.4	.1
2250'	1	4.4	.1
2500'	1-1/2	6.6	.1
2750'	1	4.4	.1
3000'	1/2	2.2	.0
3250'	1	4.4	.1
3500'	1/2	2.2	.0
3750'	1/2	2.2	.0

Total Deflections 48.4' .7'

CASING TALLY

8-5/8"OD		5-1/2"OD									
20	1	48	10	45	11	31	6	30	4	31	2
21	2	42	6	45	6	31	9	31	10	30	2
21	6	41	5	45	7	32	9	31	3	30	7
21	7	46	3	45	3	30	3	29	7	32	5
20	2	47	1	47	2	32	2	30	8	32	0
19	10	46	8	47	7	30	11	31	8	31	7
18	2	46	9	42	7	31	10	31	0	30	9
20	3	46	2	47	8	31	1	31	0	31	11
18	8	46	10	39	11	30	9	31	9	32	0
23	7	45	8	32	5	32	10	30	2	30	8
19	0	46	6	31	1	30	5	32	3	30	0
17	11	46	10	32	0	31	10	31	10	31	6
22	6	46	7	32	1	32	2	31	0	31	9
19	8	46	7	31	10	31	6	30	9	30	10
20	4	47	2	32	3	31	4	32	3	31	11
18	5	47	5	31	4	30	11	32	2	29	3
23	5	46	9	32	0	31	2	30	6	30	11
22	3	46	5	31	9	29	11	29	8	31	0
19	6	46	11	31	2	31	5	32	7	31	0
8	9	47	10	31	11	31	2	31	6	31	5
		31	10	31	8	28	8	30	4	30	3
		31	9	31	11	31	1	31	10	35	5

391 9

3868' 3"

Set 10' in cellar