

STATE CORPORATION COMMISSION OF KANSAS
OIL & GAS CONSERVATION DIVISION
WELL COMPLETION OR RECOMPLETION FORM
ACO-1 WELL HISTORY
DESCRIPTION OF WELL AND LEASE

API No. 15-15-075-20284-0000
County Hamilton
NE/4 Sec 1 Twp 25 Rge 39 East
West

Operator: License # 5855
Name Wallace Oil & Gas Inc
Address 50 Penn Place #850
City/State/Zip Oklahoma City OK 73118

3980 Ft North from Southeast Corner of Section
1300 Ft West from Southeast Corner of Section
(Note: Locate well in section plat below)

Purchaser Greely Gas Co
(successor of interest of Peoples Nat. Gas Co.)

Lease Name Herrmann Well # 1
Field Name Panoma Council Grove

Operator Contact Person Pam Garrett
Phone 405/840-2636

Producing Formation Council Grove

Contractor: License # 5987
Name Service Dring Co

Elevation: Ground 3117' KB 3125'

Wellsite Geologist
Phone

Designate Type of Completion
X New Well Re-Entry Workover
Oil SWD Temp Abd
X Gas Inj Delayed Comp.
Dry Other (Core, Water Supply etc.)

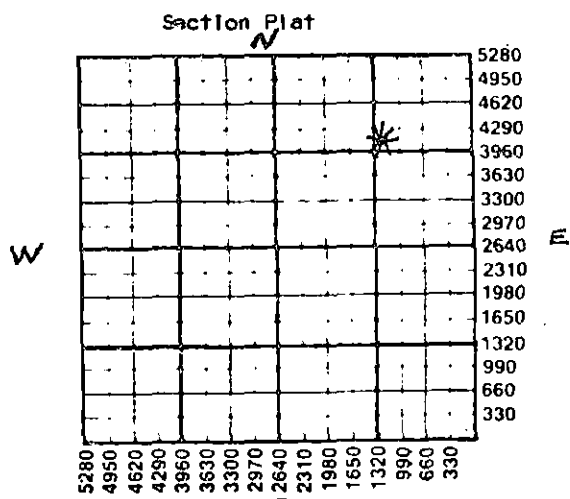

If ONWO: old well info as follows:
Operator
Well Name
Comp. Date Old Total Depth

WATER SUPPLY INFORMATION

Disposition of Produced Water: Disposal
Docket # Repressuring

WELL HISTORY

Drilling Method:
X Mud Rotary Air Rotary Cable

Questions on this portion of the ACO-1 call:
Water Resources Board (913) 296-3717

6/6/79 6/10/79 6/21/79
Spud Date Date Reached TD Completion Date

Source of Water:
Division of Water Resources Permit #

2727' none
Total Depth PBTD

Groundwater Ft North from Southeast Corner (Well) Ft West from Southeast Corner of Sec Twp Rge East West

Amount of Surface Pipe Set and Cemented at 563 feet
Multiple Stage Cementing Collar Used? Yes X No
If yes, show depth set feet
If alternate 2 completion, cement circulated from feet depth to w/SX cmt
Cement Company Name
Invoice #

Surface Water Ft North from Southeast Corner (Stream, pond etc) Ft West from Southeast Corner Sec Twp Rge East West

Other (explain) (purchased from city, R.W.D. #)

INSTRUCTIONS: This form shall be completed in duplicate and filed with the Kansas Corporation Commission, 200 Colorado Derby Building, Wichita, Kansas 67202, within 90 days after completion or recompletion of any well. Rule 82-3-130 and 82-3-107 apply. Information on side two of this form will be held confidential for a period of 12 months if requested in writing and submitted with the form. See rule 82-3-107 for confidentiality in excess of 12 months. One copy of all wireline logs and drillers time log shall be attached with this form. Submit CP-4 form with all plugged wells. Submit CP-111 form with all temporarily abandoned wells.

All requirements of the statutes, rules and regulations promulgated to regulate the oil and gas industry have been fully complied with and the statements herein are complete and correct to the best of my knowledge.

Signature Pamela Garrett

Title Secretary Date 4/24/86

Subscribed and sworn to before me this 24th day of April 1986

Notary Public Jean Huger

Date Commission Expires June 11 1987

K.C.C. OFFICE USE ONLY
F Letter of Confidentiality Attached
C Wireline Log Received
C Drillers Timelog Received
Distribution
KCC SWD/Rep NGPA
KGS Plug Other (Specify)

APR 29 1986
4-29-86
CONSERVATION DIVISION
Wichita, Kansas

Sec. 1, Twp 25 Rge 39 W

Operator Name Wallace Oil & Gas, Inc. Lease Name Herrmann Well # 1

Sec. 1 Twp. 25 Rge. 39 East West County Hamilton

WELL LOG

INSTRUCTIONS: Show important tops and base of formations penetrated. Detail all cores. Report all drill stem tests giving interval tested, time tool open and closed, flowing and shut-in pressures, whether shut-in pressure reached static level, hydrostatic pressures, bottom hole temperature, fluid recovery, and flow rates if gas to surface during test. Attach extra sheet if more space is needed. Attach copy of log.

Drill Stem Tests Taken Yes No
 Samples Sent to Geological Survey Yes No
 Cores Taken Yes No

Formation Description
 Log Sample

Name	Top	Bottom
shale and sand	563	587
shale	587	630
shale and sand	630	1065
anhydrite, shale & sand	1065	1563
shale and sand	1563	1800
anhydrite	1800	1853
sand and shale	1853	2083
anhydrite and shale	2083	2338
shale and dolomite	2338	2400
dolomite	2400	2417
shale and dolomite	2417	2502
limestone & shale	2502	2604
siltstone	2604	2620
conglomerate sandstone & limestone	2620	2726
Top of Chase		2338'
Lower Krider		2400'
Top of Council Grove		2604'

CASING RECORD New Used
 Report all strings set-conductor, surface, intermediate, production, etc.

Purpose of String	Size Hole Drilled	Size Casing Set (in O.D.)	Weight Lbs/Ft.	Setting Depth	Type of Cement	#Sacks Used	Type and Percent Additives
Surface	12 1/4"	8 5/8"	20#	563'	65/35 poz	300	3%cc, 6% gel
Production	7 7/8"	5 1/2"	14#	2727'	50/50 poz	200	12%gil, 3%cc, 3/4%CFR2

Shots Per Foot	Specify Footage of Each Interval Perforated	Acid, Fracture, Shot, Cement Squeeze Record (Amount and Kind of Material Used)	Depth
2	2628'-2650'	used on all perfs;	
2	2662'-2672'	500 gals 15% acid, 2000 gals	
2	2678'-2688'	7 1/2% acid, 62,000 gals gelled KCl water, 62,500# 10/20 sand	

TUBING RECORD Size 2 3/8" Set At 2718.28' Packer at none Liner Run Yes No

Date of First Production SIGW Producing Method Flowing Pumping Gas Lift Other (explain)

Estimated Production Per 24 Hours	Oil Bbls	Gas AOF 2,275 MCF	Water 24 Bbls	Gas-Oil Ratio	Gravity
				CFPB	

METHOD OF COMPLETION

Production Interval

Disposition of gas: Vented Open Hole Perforation 2628'
 Sold Other (Specify)
 Used on Lease Dually Completed 2688'
 Commingled