

STATE OF KANSAS  
STATE CORPORATION COMMISSION

WELL PLUGGING RECORD

Give All Information Completely  
Make Required Affidavit  
Mail or Deliver Report to  
Conservation Division  
State Corporation Comm.  
245 North Water  
Wichita, KS 67202

Hamilton County, Sec. 12 Twp. 25S Rge. 40 W  
Location as "NE/CNW $\frac{1}{4}$ SW $\frac{1}{4}$ " or footage from lines  
2310' FSL x 2310' FEL

Lease Owner Amoco Production Company  
Lease Name Shorter Gas Unit "A" Well No. 1  
Office Address P. O. Box 432 Liberal, KS 67901  
Character of Well (Completed as Oil, Gas or Dry Hole) Dry Hole

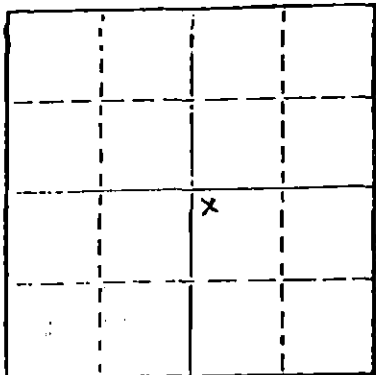

Locate well correctly on above  
Section Plat

Date Well completed 2-6 1979  
Application for plugging filed 1-9 1979  
Application for plugging approved 1-10 1979  
Plugging commenced 2-6 1979  
Plugging completed 2-6 1979

Reason for abandonment of well or producing formation  
Excessive Water Production  
If a producing well is abandoned, date of last production 19

Was permission obtained from the Conservation Division or  
its agents before plugging was commenced? Yes

Name of Conservation Agent who supervised plugging of this well Clarence Thomas  
Producing formation Chase Depth to top 2402 Bottom 2509 Total Depth of Well 2509  
Show depth and thickness of all water, oil and gas formations.

OIL, GAS OR WATER RECORDS

CASING RECORD

| FORMATION | CONTENT | FROM | TO   | SIZE  | PUT IN | PULLED OUT |
|-----------|---------|------|------|-------|--------|------------|
| Chase     | Sand    | 2402 | 2509 | 8-5/8 | 622    | -0-        |
|           |         |      |      | 5-1/2 | 2502   | -0-        |
|           |         |      |      |       |        |            |
|           |         |      |      |       |        |            |

Describe in detail the manner in which the well was plugged, indicating where the mud fluid was placed and the method or methods used in introducing it into the hold. If cement or other plugs were used, state the character of same and depth placed, from feet to feet for each plug set. Pmp 50 sx RFC into casing followed with 250 sx 36/65 poz w/6% Gel. Which filled 5-1/2" casing with cement from TD @ 2509 to within 6 ft. of surface. Cut off csg and welded on cap.

RECEIVED  
STATE CORPORATION COMMISSION

FEB 14 1979

CONSERVATION DIVISION  
Wichita, Kansas

(If additional description is necessary, use BACK of this sheet)  
Name of Plugging Contractor

STATE OF Kansas COUNTY OF Seward, ss.  
(employee of owner) or (owner or operator)  
of the above-described well, being first duly sworn on oath, says: That I have knowledge of the facts, statements, and matters herein contained and the log of the above-described well as filed and that the same are true and correct. So help me God.

(Signature) Dale McCord G. McCord  
P. O. Box 432 Liberal, KS  
(Address)

SUBSCRIBED AND SWORN TO before me this 8 day of February, 1979

J. L. Dressen  
Notary Public.

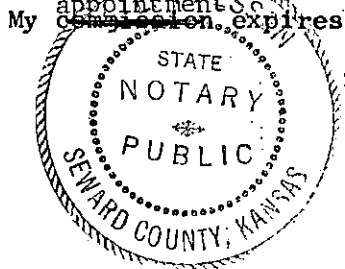

**KANSAS DRILLERS LOG**

S. 12 T. 25S R. 40 <sup>EX</sup><sub>W</sub>  
 Loc. 2310' FSL & 2310' FEL

API No. 15 — 075 — 20214  
 County Number

County Hamilton

Operator  
 Amoco Production Company

Address  
 P. O. Box 432, Liberal, KS 67901

Well No. 1 Lease Name Shorter Gas Unit "A"

Footage Location  
 2310 feet from ~~XXX~~ (S) line 2310 feet from (E) ~~XXX~~ line

Principal Contractor Service Drilling Geologist

Spud Date 12-09-77 Total Depth 2509 P.B.T.D. 2499

Date Completed Oil Purchaser

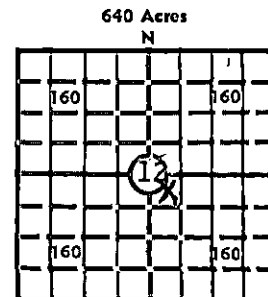

Locate well correctly

Elev.: Gr. 3278

DF KB

**CASING RECORD**

Report of all strings set — surface, intermediate, production, etc.

| Purpose of string | Size hole drilled | Size casing set (in O.D.) | Weight lbs/ft. | Setting depth | Type cement                | Sacks      | Type and percent additives |
|-------------------|-------------------|---------------------------|----------------|---------------|----------------------------|------------|----------------------------|
| Surface           | 12-1/4            | 8-5/8                     | 24             | 630           | Howco Lite<br>50-50 Pozmix | 235<br>150 | 2% CACL<br>3% CACL         |
| Production        | 7-7/8             | 5-1/2                     | 14             | 2508          | Howco Lite<br>Pozmix       | 500<br>100 | 1/4# Flakes<br>18% Salt    |

**LINER RECORD**

**PERFORATION RECORD**

| Top, ft.             | Bottom, ft.   | Sacks cement  | Shots per ft. | Size & type | Depth interval   |
|----------------------|---------------|---------------|---------------|-------------|------------------|
|                      |               |               | 2             | 1/2" JET    | 2404-19, 2424-29 |
| <b>TUBING RECORD</b> |               |               |               |             | 2455-75          |
| Size                 | Setting depth | Packer set at |               |             |                  |

**ACID, FRACTURE, SHOT, CEMENT SQUEEZE RECORD**

| Amount and kind of material used  | Depth interval treated |
|---|------------------------|
| Pmp 2000 gal 15% HCL as spearhead Frac x 100,000 gal trt wtr & 150,000# river sand. | 2404-2475              |

**INITIAL PRODUCTION**

|   |   |
|---|---|
| Date of first production<br>No production | Producing method (flowing, pumping, gas lift, etc.) |
| <b>RATE OF PRODUCTION PER 24 HOURS</b>    | <b>Gas-oil ratio</b>                                |
| Oil bbls.                                 | Gas MCF   |
| Water bbls.                               | CFPB  |

Disposition of gas (vented, used on lease or sold) Producing interval (s)

Excessive water production well will be P&A

INSTRUCTIONS: As provided in KCC Rule 82-2-125, within 90 days after completion of a well, one completed copy of this Drillers Log shall be transmitted to the State Geological Survey of Kansas, 4150 Monroe Street, Wichita, Kansas 67209. Copies of this form are available from the Conservation Division, State Corporation Commission, 3830 So. Meridian (P.O. Box 17027), Wichita, Kansas 66217. Phone AC 316-522-2206. If confidential custody is desired, please note Rule 82-2-125. Drillers Logs will be on open file in the Oil and Gas Division, State Geological Survey of Kansas, Lawrence, Kansas 66044.

Operator Amoco Production Company DESIGNATE TYPE OF COMP.: OIL, GAS, DRY HOLE, SWDW, ETC.:

Well No. 1 Lease Name Shorter Gas Unit "A" Dry hole

S 12 T 25S R 40 Ex W

**WELL LOG**

Show all important zones of porosity and contents thereof; cored intervals, and all drill-stem tests, including depth interval tested, cushion used, time tool open, flowing and shut-in pressures, and recoveries.

SHOW GEOLOGICAL MARKERS, LOGS RUN, OR OTHER DESCRIPTIVE INFORMATION.

| FORMATION DESCRIPTION, CONTENTS, ETC. | TOP  | BOTTOM | NAME | DEPTH |
|---------------------------------------|------|--------|------|-------|
| Sand, Gyp, Shale, Redbed              | 0    | 550    |      |       |
| Red Bed, Shale, Sand                  | 550  | 2232   |      |       |
| Lime                                  | 2232 | 2423   |      |       |
| Shale, Sand                           | 2423 | 2509   |      |       |
| TD                                    |      | 2509   |      |       |
| PBD                                   |      | 2499   |      |       |

USE ADDITIONAL SHEETS, IF NECESSARY, TO COMPLETE WELL RECORD.

Date Received

*Gale McCord*  
Signature  
Gale McCord  
Administrative Supervisor  
Title  
1-9-79  
Date