

ORIGINAL

SIDE ONE

CONFIDENTIAL

STATE CORPORATION COMMISSION OF KANSAS  
OIL & GAS CONSERVATION DIVISION  
WELL COMPLETION FORM  
ACO-1 WELL HISTORY  
DESCRIPTION OF WELL AND LEASE

API NO. 15- 155-21-128-0000 FEB 2 8 1991  
County Reno FROM CONFIDENTIAL  
NW NW NE Sec. 8 Twp. 24 Rge. 8W  East West

Operator: License # 5585  
Name: Clinton Production, Inc.  
Address 330 N. Armour  
City/State/Zip Wichita, KS 67206  
Purchaser: \_\_\_\_\_

4950 Ft. North from Southeast Corner of Section  
2310 Ft. West from Southeast Corner of Section  
(NOTE: Locate well in section plat below.)

Operator Contact Person: Lou Clinton  
Phone (316) 684-7996

Lease Name Farney Well # 2

Contractor: Name: Red Tiger Drilling  
License: 5302

Field Name \_\_\_\_\_

Wellsite Geologist: BILL STOUT

Producing Formation \_\_\_\_\_

Designate Type of Completion  
 New Well  Re-Entry  Workover  
 Oil  SWD  Temp. Abd.  
 Gas  Inj  Delayed Comp.  
 Dry  Other (Core, Water Supply, etc.)

Elevation: Ground \_\_\_\_\_ KB \_\_\_\_\_

Total Depth 4156 PBDT \_\_\_\_\_

If OWM: old well info as follows:  
Operator: \_\_\_\_\_  
Well Name: \_\_\_\_\_  
Comp. Date \_\_\_\_\_ Old Total Depth \_\_\_\_\_

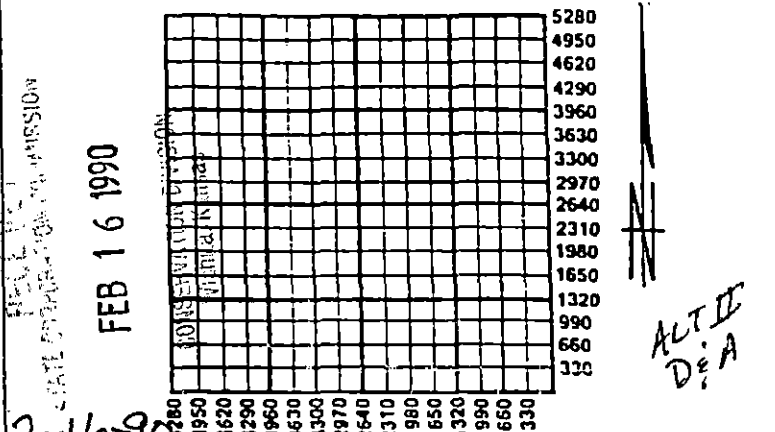

Drilling Method:  
 Mud Rotary  Air Rotary  Cable

1-12-90 1-21-90 1-22-90  
Spud Date Date Reached TD Completion Date

Amount of Surface Pipe Set and Cemented at 280 Feet

Multiple Stage Cementing Collar Used?  Yes  No

If yes, show depth set \_\_\_\_\_ Feet

If Alternate II completion, cement circulated from \_\_\_\_\_

feet depth to \_\_\_\_\_ w/ \_\_\_\_\_ sx cmt.

INSTRUCTIONS: This form shall be completed in triplicate and filed with the Kansas Corporation Commission, 200 Colorado Derby Building, Wichita, Kansas 67202, within 120 days of the spud date of any well. Rule 82-3-130, 82-3-107 and 82-3-106 apply. Information on side two of this form will be held confidential for a period of 12 months if requested in writing and submitted with the form. See rule 82-3-107 for confidentiality in excess of 12 months. One copy of all wireline logs and drillers time log shall be attached with this form. ALL CEMENTING TICKETS MUST BE ATTACHED. Submit CP-4 form with all plugged wells. Submit CP-111 form with all temporarily abandoned wells. Any recompletion, workover or conversion of a well requires filing of ACO-2 within 120 days from commencement date of such work.

All requirements of the statutes, rules and regulations promulgated to regulate the oil and gas industry have been fully complied with and the statements herein are complete and correct to the best of my knowledge.

Signature Lou Clinton

Title Pres. Date \_\_\_\_\_

Subscribed and sworn to before me this 15<sup>th</sup> day of \_\_\_\_\_ 1990

Notary Public Laura Kurbhut

Date Commission Expires 4/15/93

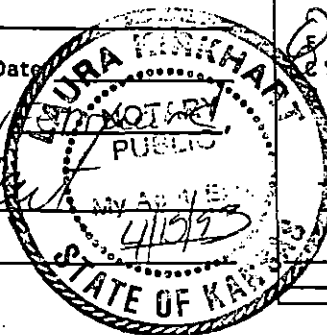

K.C.C. OFFICE USE ONLY  
 Letter of Confidentiality Attached  
 Wireline Log Received  
 Drillers Timelog Received

Distribution  
 KCC  SWD/Rep  NGPA  
 KGS  Plug  Other  
(Specify)

ORIGINAL

CONFIDENTIAL

SIDE TWO

Operator Name Clinton Production, Inc.

Lease Name Farney Well # 2

Sec. 8 Twp. 24 Rge. 8W  East  West

County Reno

INSTRUCTIONS: Show important tops and base of formations penetrated. Detail all cores. Report all drill stem tests giving interval tested, time tool open and closed, flowing and shut-in pressures, whether shut-in pressure reached static level, hydrostatic pressures, bottom hole temperature, fluid recovery, and flow rates if gas to surface during test. Attach extra sheet if more space is needed. Attach copy of log.

RELEASED

Drill Stem Tests Taken  Yes  No  
(Attach Additional Sheets.)

Samples Sent to Geological Survey  Yes  No

Cores Taken  Yes  No

Electric Log Run  Yes  No  
(Submit Copy.)

Formation Description FEB 2 8 1991

Log  ~~Sample~~ FROM CONFIDENTIAL

Name \_\_\_\_\_ Top \_\_\_\_\_ Bottom \_\_\_\_\_

SEE ATTACHED

CASING RECORD  New  Used

Report all strings set-conductor, surface, intermediate, production, etc.

Purpose of String	Size Hole Drilled	Size Casing Set (In O.D.)	Weight Lbs./Ft.	Setting Depth	Type of Cement	# Sacks Used	Type and Percent Additives
surface	12 1/4	8 5/8	23#	280	60/40 poz	160	2% gel, 3%cc

Shots Per Foot	PERFORATION RECORD Specify Footage of Each Interval Perforated	Acid, Fracture, Shot, Cement Squeeze Record (Amount and Kind of Material Used)	Depth

TUBING RECORD

Size \_\_\_\_\_ Set At \_\_\_\_\_ Packer At \_\_\_\_\_ Liner Run  Yes  No

Date of First Production \_\_\_\_\_ Producing Method  Flowing  Pumping  Gas Lift  Other (Explain) \_\_\_\_\_

Estimated Production Per 24 Hours	Oil Bbls.	Gas Mcf	Water Bbls.	Gas-Oil Ratio	Gravity

Disposition of Gas:  Vented  Sold  Used on Lease (If vented, submit ACD-18.)

METHOD OF COMPLETION  Open Hole  Perforation  Dually Completed  Commingled  Other (Specify) \_\_\_\_\_

Production Interval \_\_\_\_\_

CLINTON PRODUCTION, INC.

330 N. ARMOUR — WICHITA, KANSAS 67206

(316) 684-7996

ORIGINAL

CONFIDENTIAL

ATTACHMENT, ACO-1 Well History  
 Farney No. 2 Well  
 NW NW NE Sec. 8-T24S-R8W  
 Reno County, Kansas

RELEASED

FEB 28 1991

FROM CONFIDENTIAL

Formation Description:

<u>Name</u>	<u>Top</u>	<u>Bottom</u>
Heebner	3047	-1377
Douglas	3056	-1386
Brown Lime	3221	-1551
Lansing	3241	-1571
Swope	3524	-1854
Hertha	3561	-1891
Lower Hertha	3594	-1924
Base Kansas City	3624	-1954
Mississippi	3785	-2115
L.T.D.	3835	-2165
Viola	4067	-2397
Simpson Sand	4102	-2432
R.T.D.	4156	-2486

Drill Stem Test #1, 3746'-3800'

Open tool 30 min. with weak blow building to a good six inch blow. Close tool 60 min. Open tool 60 min. with weak steady blow, two inches into bucket. Close tool 90 min. Recovered 180' mud.

IFP	118-118 psi	FFP	153-155 psi
ISIP	1123 psi	FSIP	1157 psi
HP	2037-2019 psi	Temperature	110 degrees

APR 25 1990

KANSAS GEOLOGICAL SURVEY  
 WICHITA BRANCH

Drill Stem Test #2, 4107'-4120'

Open tool 30 min. with weak blow building to good blow 11 inches into bucket. Close tool 60 min. Open tool 60 min. with blow building to bottom of the bucket in 45 min. Close tool 90 min. Recovered 150' thin mud, 252' water - gas cut.

IFP	88-88 psi	FFP	156-191 psi
ISIP	1377 psi	FSIP	1377 psi
HP	2319-2217 psi	Temperature	125 degrees

RECEIVED  
 STATE CORPORATION COMMISSION

FEB 16 1990

CONSERVATION DIVISION  
 Wichita, Kansas