

STATE CORPORATION COMMISSION OF KANSAS
OIL & GAS CONSERVATION DIVISION

WELL COMPLETION OR RECOMPLETION FORM
ACO-1 WELL HISTORY

DESCRIPTION OF WELL AND LEASE

Operator: License # 5056
Name F.G. Hall
Address 6427 E. Kellogg
City/State/Zip Wichita, Ks. 67207

Purchaser NA

Operator Contact Person Wilfred J. Monk
Phone 316-684-8481

Contractor: License # 5142
Name Sterling Drilling Co

Wellsite Geologist Frank Greenbaum
Phone 316-684-8481

Designate Type of Completion
 New Well Re-Entry Workover
 Oil SWD Temp Abd
 Gas Inj Delayed Comp.
 Dry Other (Core, Water Supply etc.)

If OWWO: old well info as follows:
Operator
Well Name
Comp. Date Old Total Depth

WELL HISTORY

Drilling Method:
 Mud Rotary Air Rotary Cable
4-7-85 4-13-85 4-13-85
Spud Date Date Reached TD Completion Date
4645
Total Depth PBSD
Amount of Surface Pipe Set and Cemented at 436 feet
Multiple Stage Cementing Collar Used? Yes No
If yes, show depth set feet
If alternate 2 completion, cement circulated from feet depth to w/SX cmt

API NO. 15-047-21-249-0000
County Edwards
C NE NW 13 26 17W
Sec Twp Rge West

4620 Ft North from Southeast Corner of Section
3300 Ft West from Southeast Corner of Section
(Note: Locate well in section plat below)

Lease Name Rose Mathes Well # 1-13

Field Name Fatzer

Producing Formation NA

Elevation: Ground 2101 KB 2110

Section Plat

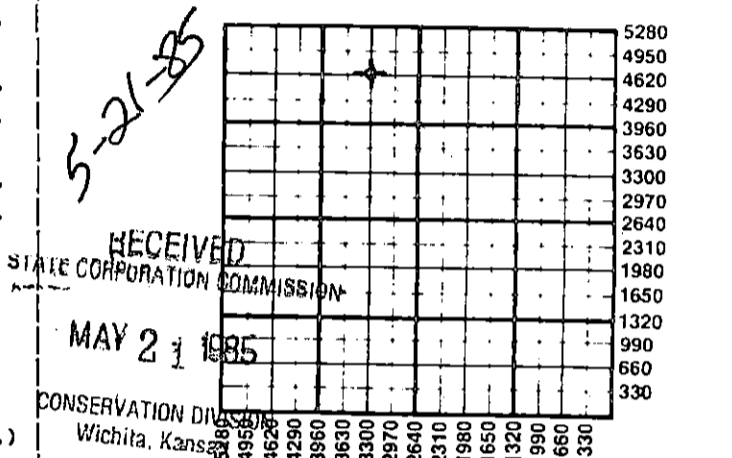

WATER SUPPLY INFORMATION
Disposition of Produced Water: Disposal Repressuring
Docket #

Questions on this portion of the ACO-1 call:
Water Resources Board (913) 296-3717

Source of Water:
Division of Water Resources Permit #
 Groundwater Ft North from Southeast Corner (Well) Ft West from Southeast Corner of Sec Twp Rge East West
 Surface Water Ft North from Southeast Corner (Stream, pond etc) Ft West from Southeast Corner Sec Twp Rge East West
 Other (explain) (purchased from city, R.W.D. #)

INSTRUCTIONS: This form shall be completed in duplicate and filed with the Kansas Corporation Commission, 200 Colorado Derby Building, Wichita, Kansas 67202, within 90 days after completion or recompletion of any well. Rule 82-3-130 and 82-3-107 apply. Information on side two of this form will be held confidential for a period of 12 months if requested in writing and submitted with the form. See rule 82-3-107 for confidentiality in excess of 12 months. One copy of all wireline logs and drillers time log shall be attached with this form. Submit CP-4 form with all plugged wells. Submit CP-111 form with all temporarily abandoned wells.

All requirements of the statutes, rules and regulations promulgated to regulate the oil and gas industry have been fully complied with and the statements herein are complete and correct to the best of my knowledge.

Signature Wilfred J. Monk
Title Geologist Date 4-14-85

Subscribed and sworn to before me this 14 day of May 1985
Notary Public Mary D. Slagle

Date Commission Expires

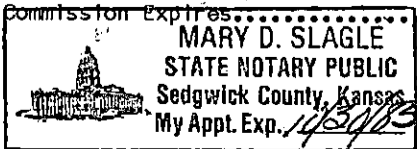

K.C.C. OFFICE USE ONLY
F Letter of Confidentiality Attached
C Wireline Log Received
C Drillers Timelog Received
Distribution
 KCC SWD/Rep NGPA
 KGS Plug Other (Specify)

Sec. 13 Twp. 26 Rge. 17W

SIDE TWO

Operator Name F.G. Holl Lease Name Rose Mathes Well # 1-13

Sec. 13 Twp. 26 Rge. 17W East West County Edwards

WELL LOG

INSTRUCTIONS: Show important tops and base of formations penetrated. Detail all cores. Report all drill stem tests giving interval tested, time tool open and closed, flowing and shut-in pressures, whether shut-in pressure reached static level, hydrostatic pressures, bottom hole temperature, fluid recovery, and flow rates if gas to surface during test. Attach extra sheet if more space is needed. Attach copy of log.

Drill Stem Tests Taken Yes No
 Samples Sent to Geological Survey Yes No
 Cores Taken Yes No

Formation Description
 Log Sample

DST #1 Cher./ Mississippi 4462-4545
 Rcd: 1240' SOCGW
 1st Flow: Tool opened with a strong blow (fluid to surface in 14 minutes) and (gas to surface in 5 minutes).
 2nd Flow: Tool opened with a strong blow, fluid to surface, decreased to water spray in 15 minutes and remained throughout flow period.
 IFP: 796#-814#
 ISIP: 1256#
 FFP: 583#-566#
 FSIP: 1216#

Name	Top	Bottom
Heebner	3842	(-1732)
Brown Lime	3980	(-1870)
LKC	3991	(-1881)
BKC	4296	(-2186)
Cherokee sh	4444	(-2334)
Cherokee ss	4472	(-2362)
Mississippi	4515	(-2405)
Kinderhook sh	4544	(-2434)
Kinderhook ss	4557	(-2447)
Viola	4612	(-2502)
RTD	4645	(-2525)

CASING RECORD <input checked="" type="checkbox"/> New <input type="checkbox"/> Used								
Report all strings set-conductor, surface, intermediate, production, etc.								
Purpose of String	Size Hole Drilled	Size Casing Set (in O.D.)	Weight Lbs/Ft.	Setting Depth	Type of Cement	#Sacks Used	Type and Percent Additives	
Surface		8.5/8"	23#	436'KB	60/40 Poz	350	3%cc	
PERFORATION RECORD				Acid, Fracture, Shot, Cement Squeeze Record				
Shots Per Foot	Specify Footage of Each Interval Perforated			(Amount and Kind of Material Used)			Depth	
TUBING RECORD				Liner Run <input type="checkbox"/> Yes <input checked="" type="checkbox"/> No				
Date of First Production		Producing Method						
NA		<input type="checkbox"/> Flowing <input type="checkbox"/> Pumping <input type="checkbox"/> Gas Lift <input type="checkbox"/> Other (explain).....						
Estimated Production Per 24 Hours	Oil		Gas		Water		Gas-Oil Ratio	Gravity
	NA	Bbls	NA	MCF	NA	Bbls	CFPB	

METHOD OF COMPLETION

Production Interval

Disposition of gas: Vented Open Hole Perforation
 Sold Other (Specify) NA
 Used on Lease Dually Completed
 Commingled