

EFFECTIVE DATE: 8-9-92

FORM MUST BE TYPED

DISTRICT # 2

State of Kansas

FORM MUST BE SIGNED

SEA? Yes No

NOTICE OF INTENTION TO DRILL

ALL BLANKS MUST BE FILLED

Must be approved by the K.C.C. five (5) days prior to commencing well

Expected Spud Date July 31, 1992

Spot W 1/2 SW 1/4 Sec 17, Twp 24 S, Rg 9 East

OPERATOR: License # #6044 / #9855
Name: Stelbar Oil Corp., Inc. / Grand Mesa Operating Co
Address: 155 N. Market, Suite #500
City/State/Zip: Wichita, KS 67202
Contact Person: Roscoe L. Mendenhall
Phone: 316/264-8378

1320 feet from South KKKth line of Section
660 feet from EKK / West line of Section
SECTION X REGULAR IRREGULAR

CONTRACTOR: License #: #03779
Name: Norseman Drilling, Inc

(NOTE: Locate well on the Section Plat on Reverse Side)
County: Reno
Lease Name: Hinshaw Well #: 1-17
Field Name: Undesignated

Well Drilled For: Well Class: Type Equipment:
Oil Enh Rec Infield Mud Rotary
Gas Storage Pool Ext Air Rotary
OWWO Disposal Wildcat Cable
Seismic # of Holes Other

Is this a Prorated/Spaced Field? yes X no
Target Formation(s): Mississippian

If OWWO: old well information as follows:
Operator:
Well Name:
Comp. Date: Old Total Depth

Nearest lease or unit boundary: 660'
Ground Surface Elevation: 1664' feet MSL
Water well within one-quarter mile: yes X no

Directional, Deviated or Horizontal wellbore? yes X no
If yes, true vertical depth:
Bottom Hole Location:

Public water supply well within one mile: yes X no
Depth to bottom of fresh water: 100'
Depth to bottom of usable water: 200'

AFFIDAVIT

The undersigned hereby affirms that the drilling, completion and eventual plugging of this well will comply with K.S.A. 55-101, et. seq.
It is agreed that the following minimum requirements will be met:

- 1. Notify the appropriate district office prior to spudding of well;
2. A copy of the approved notice of intent to drill shall be posted on each drilling rig;
3. The minimum amount of surface pipe as specified below shall be set by circulating cement to the top; in all cases surface pipe shall be set through all unconsolidated materials plus a minimum of 20 feet into the underlying formation;
4. If the well is dry hole, an agreement between the operator and the district office on plug length and placement is necessary prior to plugging;
5. The appropriate district office will be notified before well is either plugged or production casing is cemented in;
6. IF AN ALTERNATE II COMPLETION, PRODUCTION PIPE SHALL BE CEMENTED FROM BELOW ANY USABLE WATER TO SURFACE WITHIN 120 DAYS OF SPUD DATE. IN ALL CASES, NOTIFY DISTRICT OFFICE PRIOR TO ANY CEMENTING.

I hereby certify that the statements made herein are true and to the best of my knowledge and belief.
Date: July 16, 1992 Signature of Operator or Agent: Roscoe L. Mendenhall Title: Petroleum Engineer

FOR KCC USE:
API # 45-155-21209
Conductor pipe required None feet
Minimum surface pipe required 220 feet per Alt. X
Approved by: C.B. 8-4-92
This authorization expires: 2-4-92
(This authorization void if drilling not started within 6 months of effective date.)
Spud date: Agent:

REMEMBER TO:

- File Drill Pit Application (form CDP-1) with Intent to Drill;
- File Completion Form ACO-1 within 120 days of spud date;
- File acreage attribution plat according to field proration orders;
- Notify appropriate district office 48 hours prior to workover or re-entry;
- Submit plugging report (CP-4) after plugging is completed;
- Obtain written approval before disposing or injecting salt water.

Mail to: Conservation Division, 200 Colorado Derby Building, 202 W. First St., Wichita, Kansas 67202-1286.

RECEIVED STATE CORPORATION COMMISSION

JUL 17 1992

CONSERVATION DIVISION Wichita, Kansas

17
24
9

IN ALL CASES PLOT THE INTENDED WELL ON THE PLAT BELOW

PLAT OF ACREAGE ATTRIBUTABLE TO A WELL IN A PRORATED OR SPACED FIELD

If the intended well is in a prorated or spaced field, please fully complete this side of the form. If the intended well is in a prorated or spaced field complete the plat below showing that the well will be properly located in relationship to other wells producing from the common source of supply. Please show all the wells within 1 mile of the boundaries of the proposed acreage attribution unit for gas wells and within 1/2 mile of the boundaries of the proposed acreage attribution unit for oil wells.

API NO. 15- _____
 OPERATOR Stelbar Oil Corp., Inc./Grand Mesa LOCATION OF WELL: COUNTY Reno
 LEASE Hinshaw Operating Co. 1320 feet from south ~~1320'~~ line of section
 WELL NUMBER #1-17 660 feet from east/west line of section
 FIELD Undesignated SECTION 17 TWP 24 South RG 9 West

NUMBER OF ACRES ATTRIBUTABLE TO WELL 80 IS SECTION x REGULAR or _____ IRREGULAR
 QTR/QTR/QTR OF ACREAGE C - W $\frac{1}{2}$ - SW $\frac{1}{4}$ IF SECTION IS IRREGULAR, LOCATE WELL FROM NEAREST
 CORNER BOUNDARY.

Section corner used: _____ NE _____ NW _____ SE _____ SW

PLAT

(Show location of the well and shade attributable acreage for prorated or spaced wells.)
 (Show footage to the nearest lease or unit boundary line.)

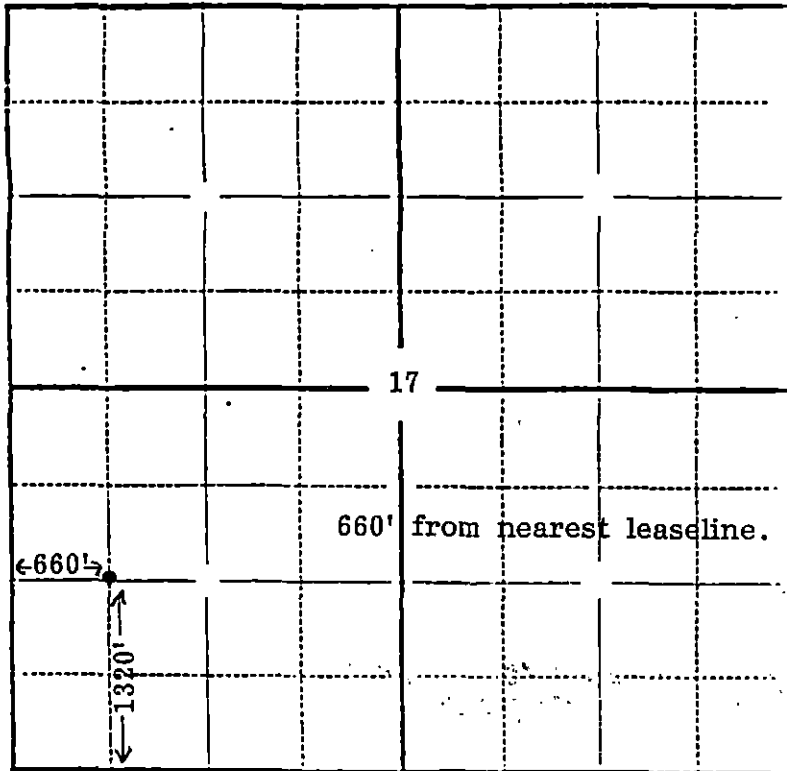

Section 17-T24S-R9W, Reno County, Kansas

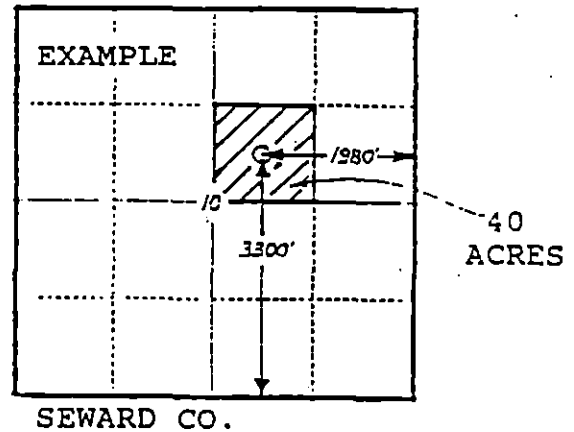

In plotting the proposed location of the well, you must show:

- 1) The manner in which you are using the depicted plat by identifying section lines, i.e. 1 section, 1 section with 8 surrounding sections, 4 sections, etc.;
- 2) the distance of the proposed drilling location from the section's south/north and east/west lines; and
- 3) the distance to the nearest lease or unit boundary line.