

11852-0001  
185-01,032

STATE CORPORATION COMMISSION OF KANSAS  
OIL & GAS CONSERVATION DIVISION  
WELL COMPLETION OR RECOMPLETION FORM  
ACO-1 WELL HISTORY  
DESCRIPTION OF WELL AND LEASE

API No. 15-.....  
County.....Stafford.....  
C... NE... SW... Sec. 15... Twp. 25S... Rge. 15... East  
..... West

Operator: License # ... 8061  
Name ..Oil Producers, Inc. of Kansas  
Address P.O. Box 8647  
.....Wichita, Ks. .... 67208  
City/State/Zip .....

..... 1980... Ft North from Southeast Corner of Section  
..... 3300... Ft West from Southeast Corner of Section  
(Note: Locate well in section plat below)

Purchaser... GasTrak

Lease Name..... Hart A..... Well #..... 2

Operator Contact Person ..Diana Richecky.....  
Phone ... 316-681-0231.....

Field Name..... *Haymes*

Producing Formation..... *LANSING*

Elevation: Ground..... 2028..... KB..... 2033

Contractor: License # ..... 4083  
Name ..Western Kansas Drilling.....

RECEIVED  
STATE CORPORATION COMMISSION

Wellsite Geologist..... NA  
Phone.....

Designate Type of Completion  
 New Well  Re-Entry  Workover  
 Oil  SWD  Temp Abd  
 Gas  Inj  Delayed Comp.  
 Dry  Other (Core, Water Supply etc.)

FEB 14 1989  
2-14-89

CONSERVATION DIVISION  
Wichita, Kansas

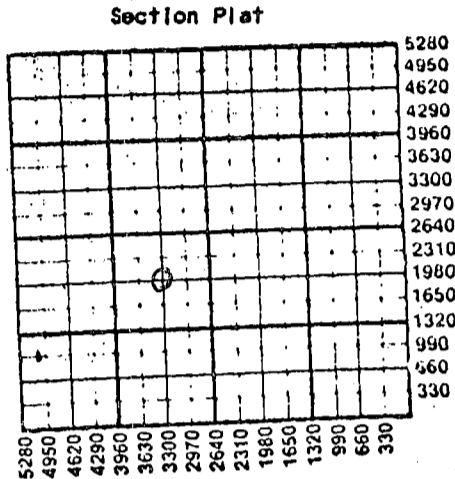

If OWWO: old well info as follows:  
Operator ..NCRA  
Well Name ..Hart #2  
Comp. Date ..11/20/60... Old Total Depth... 4265

WATER SUPPLY INFORMATION

Disposition of Produced Water:  Disposal  
Docket # .....  Repressuring

Questions on this portion of the ACO-1 call:  
Water Resources Board (913) 296-3717

Source of Water:  
Division of Water Resources Permit #.....

Groundwater.....Ft North from Southeast Corner  
(Well) .....Ft West from Southeast Corner of  
Sec Twp Rge East West

Surface Water.....Ft North from Southeast Corner  
(Stream, pond etc).....Ft West from Southeast Corner  
Sec Twp Rge East West

Other (explain)..... Contractor Responsibility  
(purchased from city, R.W.D. #)

WELL HISTORY

Drilling Method:  
 Mud Rotary  Air Rotary  Cable  
10/22/88 ..... 10/23/88 ..... 11/9/88.  
Spud Date Date Reached TD Completion Date  
4266 ..... 4220.....  
Total Depth PBTD Original 240'

Amount of Surface Pipe Set and Cemented at.....feet  
Multiple Stage Cementing Collar Used?  Yes  No  
If yes, show depth set.....feet  
If alternate 2 completion, cement circulated  
from.....feet depth to.....w/.....SX cmt  
Cement Company Name ..  
Invoice # ..

INSTRUCTIONS: This form shall be completed in duplicate and filed with the Kansas Corporation Commission, 200 Colorado Derby Building, Wichita, Kansas 67202, within 90 days after completion or recompletion of any well. Rule 82-3-130 and 82-3-107 apply.  
Information on side two of this form will be held confidential for a period of 12 months if requested in writing and submitted with the form. See rule 82-3-107 for confidentiality in excess of 12 months.  
One copy of all wireline logs and drillers time log shall be attached with this form. Submit CP-4 form with all plugged wells. Submit CP-111 form with all temporarily abandoned wells.

All requirements of the statutes, rules and regulations promulgated to regulate the oil and gas industry have been fully complied with and the statements herein are complete and correct to the best of my knowledge.

Signature .....

Title..... John S. Weir..... Date .....

Subscribed and sworn to before me this 13th day of February 1989.

Notary Public..... Sheryl J. Murphy

Date Commission Expires..... 12-19-92

SHERYL J. MURPHY  
NOTARY PUBLIC  
STATE OF KANSAS

K.C.C. OFFICE USE ONLY  
F  Letter of Confidentiality Attached  
C  Wireline Log Received  
C  Drillers Timelog Received  
Distribution  
 KCC  SWD/Rap  NGPA  
 KGS  Plug  Other  
(Specify)  
2-14-89

Sec 15 Twp 25S Rge 15W

Operator Name Oil Producers, Inc. of Ks Lease Name Hart A Well # 2

Sec 15 Twp 25S Rge 15  East  West County Stafford

WELL LOG

INSTRUCTIONS: Show important tops and base of formations penetrated. Detail all cores. Report all drill stem tests giving interval tested, time tool open and closed, flowing and shut-in pressures, whether shut-in pressure reached static level, hydrostatic pressures, bottom hole temperature, fluid recovery, and flow rates if gas to surface during test. Attach extra sheet if more space is needed. Attach copy of log.

Drill Stem Tests Taken  Yes  No  
 Samples Sent to Geological Survey  Yes  No  
 Cores Taken  Yes  No

Formation Description  
 Log  Sample

Name Top Bottom  
 None

CASING RECORD <input type="checkbox"/> New <input type="checkbox"/> Used							
Report all strings set-conductor, surface, intermediate, production, etc.							
Purpose of String	Size Hole Drilled	Size Casing Set (in O.D.)	Weight Lbs/Ft.	Setting Depth	Type of Cement	#Sacks Used	Type and Percent Additives
PERFORATION RECORD				Acid, Fracture, Shot, Cement Squeeze Record (Amount and Kind of Material Used)			
Shots Per Foot	Specify Footage of Each Interval Perforated					Depth	
2	4183-4198			Acid		1,000 gal 15% FE acid	
4	3916-3922			Frac		40,500 gal MY-T-GEL	
						43,000# sand	
				Acid		1,000 gal 15% FE acid	
TUBING RECORD				Liner Run <input type="checkbox"/> Yes <input type="checkbox"/> No			
Size		Set At		Packer at			
2 3/8"		4034.00					
Date of First Production		Producing Method					
11/9/88		<input type="checkbox"/> Flowing <input checked="" type="checkbox"/> Pumping <input type="checkbox"/> Gas Lift <input type="checkbox"/> Other (explain)					
Estimated Production Per 24 Hours		Oil	Gas	Water	Gas-Oil Ratio	Gravity	
		Bbls	5 MCF	Bbls	CFPB		

METHOD OF COMPLETION

Production Interval

Disposition of gas:  Vented  Sold  Used on Lease  
 Open Hole  Perforation  Other (Specify) .....  
 Dually Completed  Commingled

4183-4198  
 3916-3922