

FOR KCC USE:

FORM C-1 7/91

EFFECTIVE DATE: 10-20-93

DISTRICT # 2

State of Kansas

SEA? Yes No

NOTICE OF INTENTION TO DRILL

FORM MUST BE TYPED
FORM MUST BE SIGNED
ALL BLANKS MUST BE FILLED

Must be approved by the K.C.C. five (5) days prior to commencing well

Expected Spud Date October 18, 1993
month day year

Spot 5'N & 5'W of
C... NE... SW... Sec 18 Twp 24 S, Rg 10 East
X West

OPERATOR: License # 3180
Name: DEUTSCH OIL COMPANY
Address: 107 North Market - Suite 1115
City/State/Zip: Wichita, Kansas 67202
Contact Person: Kent Deutsch
Phone: 316/267-7551

1985 feet from South / North line of Section
3305 feet from East / West line of Section
IS SECTION X REGULAR IRREGULAR

(NOTE: Locate well on the Section Plat on Reverse Side)

CONTRACTOR: License # 5929
Name: DUKE DRILLING CO. INC.

County: Reno
Lease Name: Cushing Well #: 1-18
Field Name: Zenith Peace Creek

Is this a Prorated/Spaced Field? yes NO

Well Drilled For: Well Class: Type Equipment:
X Oil Enh Rec X Infield X Mud Rotary
5as Storage Pool Ext. Air Rotary
OWWD Disposal Wildcat Cable
Seismic: # of Holes Other

Target Formation(s): simpson
Nearest lease or unit boundary: 1985

Ground Surface Elevation: Unknown feet MSL

If OWWD: old well information as follows:
Operator:
Well Name:
Comp. Date: Old Total Depth

Water well within one-quarter mile: yes X no

Public water supply well within one mile: yes X no

Depth to bottom of fresh water: 80'

Depth to bottom of usable water: 120'

Surface Pipe by Alternate: X 1 2

Length of Surface Pipe Planned to be set: 180'

Length of Conductor pipe required: N/A

Projected Total Depth: unknown

Formation at Total Depth: simpson

Water Source for Drilling Operations: X well farm pond other

Directional, Deviated or Horizontal wellbore? yes X no
If yes, true vertical depth:
Bottom Hole Location:

DWR Permit #: Applied For

Will Cores Be Taken? yes X no

If yes, proposed zone:

AFFIDAVIT

The undersigned hereby affirms that the drilling, completion and eventual plugging of this well will comply with K.S.A. 55-101, et. seq.

It is agreed that the following minimum requirements will be met:

- 1. Notify the appropriate district office prior to spudding of well;
2. A copy of the approved notice of intent to drill shall be posted on each drilling rig;
3. The minimum amount of surface pipe as specified below shall be set by circulating cement to the top; in all cases surface pipe shall be set through all unconsolidated materials plus a minimum of 20 feet into the underlying formation;
4. If the well is dry hole, an agreement between the operator and the district office on plug length and placement is necessary prior to plugging;
5. The appropriate district office will be notified before well is either plugged or production casing is cemented in;
6. IF AN ALTERNATE IS COMPLETION, PRODUCTION PIPE SHALL BE CEMENTED FROM BELOW ANY USABLE WATER TO SURFACE WITHIN 120 DAYS OF SPUD DATE. IN ALL CASES, NOTIFY DISTRICT OFFICE PRIOR TO ANY CEMENTING.

I hereby certify that the statements made herein are true and to the best of my knowledge and belief.

Date: 10-20-93 Signature of Operator Title: OWNER

RECEIVED
KANSAS CORPORATION COMMISSION
10-8-93
OCT 08 1993
CONSERVATION DIVISION
WICHITA, KS

FOR KCC USE:
API # 15- 155-21299-000
Conductor pipe required None feet
Minimum surface pipe required 180' feet per Alt.
Approved by: CB 10-20-93
This authorization expires: 4-20-94
(This authorization void if drilling not started within 6 months of effective date.)
Spud date: Agent:

REMEMBER TO:

- File Drill Pit Application (form CDP-1) with Intent to Drill;
- File Completion Form ACO-1 within 120 days of spud date;
- File acreage attribution plat according to field proration orders;
- Notify appropriate district office 48 hours prior to workover or re-entry;
- Submit plugging report (CP-4) after plugging is completed;
- Obtain written approval before disposing or injecting salt water.

Mail to: Conservation Division, 200 Colorado Derby Building, 202 W. First St., Wichita, Kansas 67202-1286.

18
24
10

IN ALL CASES PLOT THE INTENDED WELL ON THE PLAT BELOW

PLAT OF ACREAGE ATTRIBUTABLE TO A WELL IN A PRORATED OR SPACED FIELD

If the intended well is in a prorated or spaced field, please fully complete this side of the form. If the intended well is in a prorated or spaced field complete the plat below showing that the well will be properly located in relationship to other wells producing from the common source of supply. Please show all the wells within 1 mile of the boundaries of the proposed acreage attribution unit for gas wells and within 1/2 mile of the boundaries of the proposed acreage attribution unit for oil wells.

API NO. 15- _____
 OPERATOR DEUTSCH OIL COMPANY LOCATION OF WELL: COUNTY RENO
 LEASE CUSHING _____ 1985 feet from south/~~north~~ line of section
 WELL NUMBER - 1-18 _____ 3305 feet from east/~~west~~ line of section
 FIELD Zenith Peace Creek SECTION 18 TWP 24S RG 10W

NUMBER OF ACRES ATTRIBUTABLE TO WELL 160 IS SECTION X REGULAR or _____ IRREGULAR
 QTR/QTR/QTR OF ACREAGE NE - NE - SW IF SECTION IS IRREGULAR, LOCATE WELL FROM NEAREST CORNER BOUNDARY.

Section corner used: _____ NE _____ NW _____ SE _____ SW
PLAT

(Show location of the well and shade attributable acreage for prorated or spaced wells.)
 (Show footage to the nearest lease or unit boundary line.)

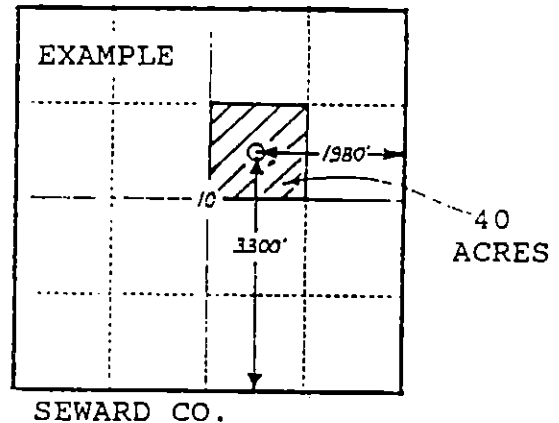
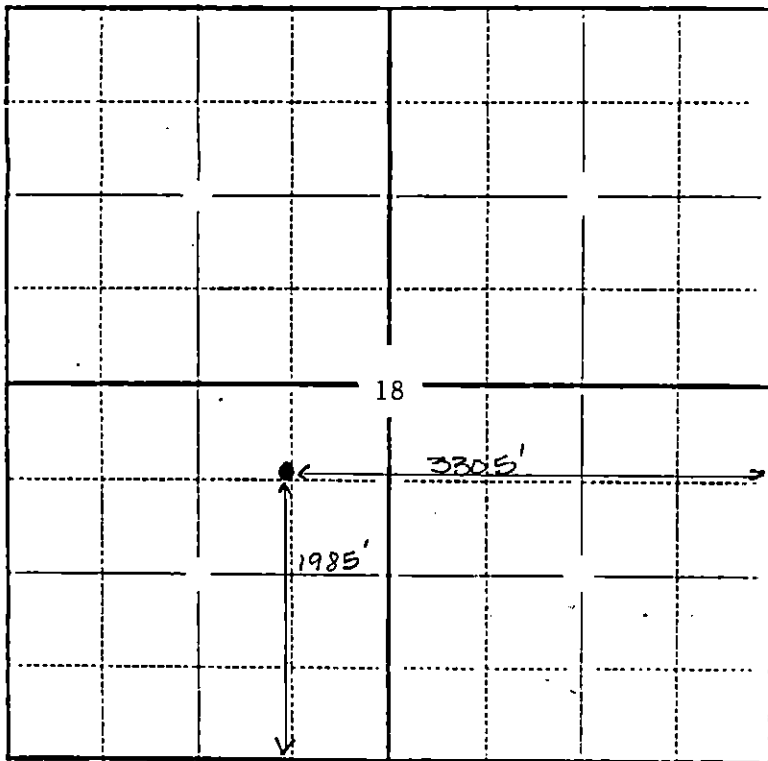

RENO COUNTY

In plotting the proposed location of the well, you must show:

- 1) The manner in which you are using the depicted plat by identifying section lines, i.e. 1 section, 1 section with 8 surrounding sections, 4 sections, etc.;
- 2) the distance of the proposed drilling location from the section's south/north and east/west lines; and
- 3) the distance to the nearest lease or unit boundary line.