

FOR KCC USE:

FORM C-1 7/91

EFFECTIVE DATE: 7-25-94  
DISTRICT # 2

State of Kansas  
NOTICE OF INTENTION TO DRILL

FORM MUST BE TYPED  
FORM MUST BE SIGNED  
ALL BLANKS MUST BE FILLED

SEA7... Yes... No

Must be approved by the K.C.C. five (5) days prior to commencing well

Expected Spud Date July 26, 1994  
month day year

Spot NE 1/4 SW 1/4 SW 1/4 Sec 14 Twp 24S S. Rg 10W East

OPERATOR: License # 6044 / 9855  
Name: Stelbar Oil Corporation, Inc. / Grand Mesa Operating  
Address: 155 N. Market, Suite #500  
City/State/Zip: Wichita, KS 67202  
Contact Person: Roscoe L. Mendenhall  
Phone: 316/264-8378

970 feet from South / West line of Section  
920 feet from East / West line of Section  
SECTION XX REGULAR IRREGULAR?

CONTRACTOR: License #: 5142  
Name: Sterling Drilling Company  
FAX 316-278-3392

County: Reno  
Lease Name: Edwards Well #: 1-14  
Field Name: Undesignated

Well Drilled For: Well Class: Type Equipment:  
X Oil Enh Rec Infield X Mud Rotary  
Gas Storage Pool Ext. Air Rotary  
OWMO Disposal X Wildcat Cable  
Seismic; # of Holes Other

Is this a Prorated/Spaced Field? yes X no  
Target Formation(s): Mississippian  
Nearest lease or unit boundary: 920 Ft.  
Ground Surface Elevation: Not Yet Available 1725 feet MSL

If OWMO: old well information as follows:

Water well within one-quarter mile: yes XX no  
Public water supply well within one mile: yes XX no  
Depth to bottom of fresh water: 75 FT. 100'  
Depth to bottom of usable water: 20-140 Ft.

Operator:  
Well Name:  
Comp. Date: Old Total Depth

Surface Pipe by Alternate: X. 1 2  
Length of Surface Pipe Planned to be set: (220 Ft.) 140  
Length of Conductor pipe required: N/A  
Projected Total Depth: 4300 Ft.  
Formation at Total Depth: Viola

Directional, Deviated or Horizontal wellbore? yes X no  
If yes, true vertical depth:  
Bottom Hole Location:

Water Source for Drilling Operations:  
X well farm pond other  
DWR Permit #: Applied For

Will Cores Be Taken?: yes X no  
If yes, proposed zone:

AFFIDAVIT

The undersigned hereby affirms that the drilling, completion and eventual plugging of this well will comply with K.S.A. 55-101, et. seq.  
It is agreed that the following minimum requirements will be met:

- 1. Notify the appropriate district office prior to spudding of well;
- 2. A copy of the approved notice of intent to drill shall be posted on each drilling rig;
- 3. The minimum amount of surface pipe as specified below shall be set by circulating cement to the top; in all cases surface pipe shall be set through all unconsolidated materials plus a minimum of 20 feet into the underlying formation;
- 4. If the well is dry hole, an agreement between the operator and the district office on plug length and placement is necessary prior to plugging;
- 5. The appropriate district office will be notified before well is either plugged or production casing is cemented in;
- 6. IF AN ALTERNATE IS COMPLETION, PRODUCTION PIPE SHALL BE CEMENTED FROM BELOW ANY USABLE WATER TO SURFACE WITHIN 120 DAYS OF SPUD DATE. IN ALL CASES, NOTIFY DISTRICT OFFICE PRIOR TO ANY CEMENTING.

I hereby certify that the statements made herein are true and to the best of my knowledge and belief.  
Date: July 20, 1994 Signature of Operator or Agent: Roscoe L. Mendenhall Title: Petroleum Engineer

FOR KCC USE:  
API # 15- 155-21325-0000  
Conductor pipe required 0 feet  
Minimum surface pipe required 140 feet per Alt. 1 X  
Approved by: CB 7-25-94  
This authorization expires: 1-25-95  
(This authorization void if drilling not started within 6 months of effective date.)  
Spud date: Agent:

7-21-94  
RECEIVED  
STATE CORPORATION COMMISSION  
JUL 21 1994  
CONSERVATION DIVISION  
WICHITA, KANSAS

REMEMBER TO:

- File Drill Pit Application (form CDP-1) with Intent to Drill;
- File Completion Form ACO-1 within 120 days of spud date;
- File acreage attribution plat according to field proration orders;
- Notify appropriate district office 48 hours prior to workover or re-entry;
- Submit plugging report (CP-4) after plugging is completed;
- Obtain written approval before disposing or injecting salt water.

Mail to: Conservation Division, 200 Colorado Derby Building, 202 W. First St., Wichita, Kansas 67202-1286.

14 24 10

IN ALL CASES PLOT THE INTENDED WELL ON THE PLAT BELOW

PLAT OF ACREAGE ATTRIBUTABLE TO A WELL IN A PRORATED OR SPACED FIELD

If the intended well is in a prorated or spaced field, please fully complete this side of the form. If the intended well is in a prorated or spaced field complete the plat below showing that the well will be properly located in relationship to other wells producing from the common source of supply. Please show all the wells within 1 mile of the boundaries of the proposed acreage attribution unit for gas wells and within 1/2 mile of the boundaries of the proposed acreage attribution unit for oil wells.

API NO. 15- \_\_\_\_\_  
 OPERATOR Stelbar Oil Corporation, Inc./Grand Mesa LOCATION OF WELL: COUNTY Reno  
 LEASE Edwards Operating Co. 970 feet from south/north line of section  
 WELL NUMBER #1-14 920 feet from east/west line of section  
 FIELD Undesignated SECTION 14 TWP 24 South RG 10 West

NUMBER OF ACRES ATTRIBUTABLE TO WELL 10 IS SECTION x REGULAR or \_\_\_\_\_ IRREGULAR  
 QTR/QTR/QTR OF ACREAGE NE 1/4 - SW 1/4 - SW 1/4 IF SECTION IS IRREGULAR, LOCATE WELL FROM NEAREST  
CORNER BOUNDARY.

Section corner used: \_\_\_\_\_ NE \_\_\_\_\_ NW \_\_\_\_\_ SE x SW

**PLAT**

(Show location of the well and shade attributable acreage for prorated or spaced wells.)  
 (Show footage to the nearest lease or unit boundary line.)

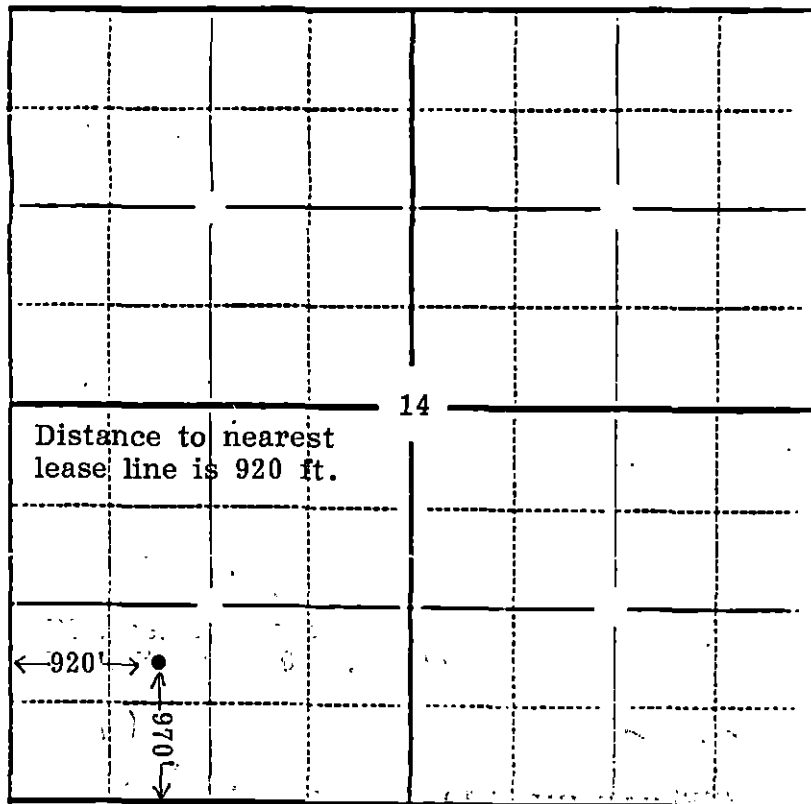

Section 14-T24S-R10 West, Reno County, Kansas

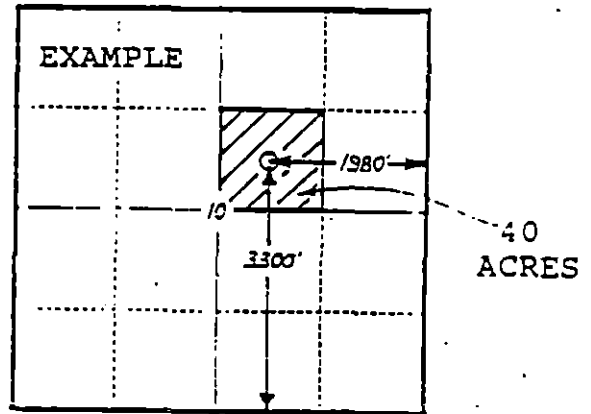

*goodhead  
 am oppor.  
 inspect offis:  
 71 22/94  
 as per manifest copy log  
 CS 4118  
 2/25/94*

In plotting the proposed location of the well, you must show:

- 1) The manner in which you are using the depicted plat by identifying section lines, i.e. 1 section, 1 section with 8 surrounding sections, 4 sections, etc.;
- 2) the distance of the proposed drilling location from the section's south/north and east/west lines; and
- 3) the distance to the nearest lease or unit boundary line.