

EFFECTIVE DATE: 1-2-94

State of Kansas

FORM MUST BE TYPED

DISTRICT # 2

NOTICE OF INTENTION TO DRILL

FORM MUST BE SIGNED

SGA7. Yes. No.

ALL BLANKS MUST BE FILLED

Must be approved by the K.C.C. five (5) days prior to commencing well

Expected Spud Date 12 31 1993
month day year

Spot
C NW NE Sec 35 Twp 24 S. Rg 9 East
West

OPERATOR: License # 5420
Name: White & Ellis Drilling, Inc.
Address: P.O. Box 48848
City/State/Zip: Wichita, KS 67201-8848
Contact Person: Michael L. Considine
Phone: 316-263-1102

4620 feet from South X line of Section
1980 feet from East X line of Section
IS SECTION X REGULAR IRREGULAR?

(NOTE: Locate well on the Section Plat on Reverse Side)

County: Reno
Lease Name: Cole Well #: 1-35
Field Name: Wildcat
Is this a Prorated/Spaced Field? yes X no
Target Formation(s): Mississippi
Nearest lease or unit boundary: 660'
Ground Surface Elevation: 1668' feet HSL
Water well within one-quarter mile: yes X no
Public water supply well within one mile: yes X no
Depth to bottom of fresh water: 90'
Depth to bottom of usable water: 120' 180'
Surface Pipe by Alternate: X 1 2
Length of Surface Pipe Planned to be set: (220') 200'
Length of Conductor pipe required: N/A NONE
Projected Total Depth: 3950'
Formation at Total Depth: Kinderhook
Water Source for Drilling Operations:
... well ... farm pond X ... other
DWR Permit #: ...
Will Cores Be Taken? yes X no
If yes, proposed zone: ...

Well Drilled For: Well Class: Type Equipment:
Oil Enh Rec Infield X Mud Rotary
X Gas Storage Pool Ext. Air Rotary
OUWO Disposal X Wildcat Cable
Seismic: # of Holes Other
Other

If old well information as follows:

Operator: ...
Well Name: ...
Comp. Date: ... Old Total Depth ...

Directional, Deviated or Horizontal wellbore? yes no

If yes, true vertical depth: ...

Bottom Hole Location: ...

AFFIDAVIT

The undersigned hereby affirms that the drilling, completion and eventual plugging of this well will comply with K.S.A. 55-101, et. seq.

It is agreed that the following minimum requirements will be met:

1. Notify the appropriate district office prior to spudding of well;
2. A copy of the approved notice of intent to drill shall be posted on each drilling rig;
3. The minimum amount of surface pipe as specified below shall be set by circulating casing; in all cases surface pipe shall be set through all unconsolidated materials plus a minimum of 20 feet into the underlying formation;
4. If the well is dry hole, an agreement between the operator and the district office on plug length and placement is necessary prior to plugging;
5. The appropriate district office will be notified before well is either plugged or production casing is cemented in;
6. IF AN ALTERNATE IS COMPLETION, PRODUCTION PIPE SHALL BE CEMENTED FROM BELOW ANY USABLE WATER TO SURFACE WITHIN 120 DAYS OF SPUD DATE. IN ALL CASES, NOTIFY DISTRICT OFFICE PRIOR TO ANY CEMENTING.

I hereby certify that the statements made herein are true and to the best of my knowledge and belief.

Date: 12-27-93 Signature of Operator or Agent: Michael L. Considine Title: Sec.-Treas.

FO2 KCC USE:
API # 15- 155-21306-0000
Conductor pipe required None foot
Minimum surface pipe required 200' feet per Alt. X
Approved by: CB 12-28-93
This authorization expires: 6-28-94
(This authorization void if drilling not started within 6 months of effective date.)
Spud date: Agent:

REMEMBER TO:

- File Drill Pit Application (form CDP-1) with Intent to Drill;
- File Completion Form ACO-1 within 120 days of spud date;
- File acreage attribution plat according to field proration orders;
- Notify appropriate district office 48 hours prior to workover or re-entry;
- Submit plugging report (CP-4) after plugging is completed;
- Obtain written approval before disposing or injecting salt water.

Mail to: Conservation Division, 200 Colorado Dorby Building, 202 W. First St., Wichita, Kansas 67202-1286.

RECEIVED
KANSAS CORPORATION COMMISSION

DEC 28 1993

12-28-93

CONSERVATION DIVISION

WICHITA, KS

35

24

9

IN ALL CASES PLOT THE INTENDED WELL ON THE PLAT BELOW

PLAT OF ACREAGE ATTRIBUTABLE TO A WELL IN A PRORATED OR SPACED FIELD

If the intended well is in a prorated or spaced field, please fully complete this side of the form. If the intended well is in a prorated or spaced field complete the plat below showing that the well will be properly located in relationship to other wells producing from the common source of supply. Please show all the wells within 1 mile of the boundaries of the proposed acreage attribution unit for gas wells and within 1/2 mile of the boundaries of the proposed acreage attribution unit for oil wells.

API NO. 15- _____

OPERATOR White & Ellis Drilling, Inc. LOCATION OF WELL: COUNTY Reno
 LEASE Cole 4620 feet from south/north line of section
 WELL NUMBER 1-35 1980 feet from east/west line of section
 FIELD Wildcat SECTION 35 TWP 24S RG 9W

NUMBER OF ACRES ATTRIBUTABLE TO WELL 40 IS SECTION X REGULAR or IRREGULAR
 QTR/QTR/QTR OF ACREAGE C - NW - NE IF SECTION IS IRREGULAR, LOCATE WELL FROM NEAREST CORNER BOUNDARY.

Section corner used: NE NW X SE SW

PLAT

(Show location of the well and shade attributable acreage for prorated or spaced wells.)
 (Show footage to the nearest lease or unit boundary line.)

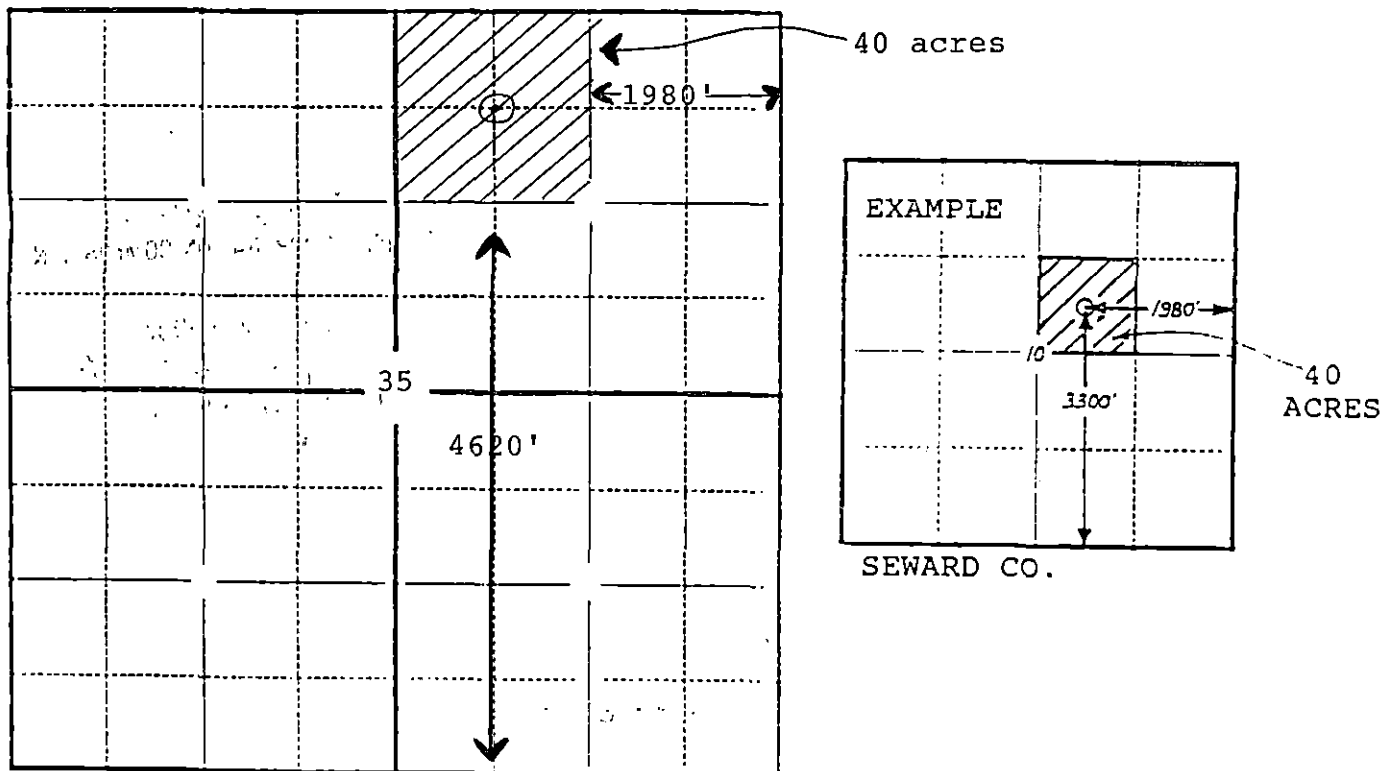

In plotting the proposed location of the well, you must show:

- 1) The manner in which you are using the depicted plat by identifying section lines, i.e. 1 section, 1 section with 8 surrounding sections, 4 sections, etc.;
- 2) the distance of the proposed drilling location from the section's south/north and east/west lines; and
- 3) the distance to the nearest lease or unit boundary line.