

FOR KCC USE:

\* 120' NO LESS SURFACE CASING

FORM C-1 7/9  
FORM MUST BE TYPE  
FORM MUST BE SIZED  
ALL BLANKS MUST BE FILLED

EFFECTIVE DATE: 10-17-94  
DISTRICT 0 2  
SEAT Yes No

State of Kansas

NOTICE OF INTENTION TO DRILL CASING

Must be approved by the K.C.C. five (5) days prior to commencing well

Expected Spud Date 10 16 1994  
month day year

Spot 145' N & E of  
NE SW SE Sec 11 24 9 Eas  
SE NE  
Well #

OPERATOR: License # 5058  
Name: Griggs Oil, Inc.  
Address: 100 N. Main, Suite 1010  
City/State/Zip: Wichita, KS 67202  
Contact Person: Jim Collins  
Phone: 316-267-7779

2165 feet from South North line of Section  
1505 feet from East West line of Section  
IS SECTION X REGULAR IRREGULAR?

(NOTE: Locate well on the Section Plat on Reverse Side.  
County: Reno  
Lease Name: Cagnebin Gas Unit Well #: 2  
Field Name: Wildcat

CONTRACTOR: License #: 5142  
Name: Sterling Drilling Company

Is this a Prorated/Spaced Field? yes no X  
Target Formation(s): Mississippi  
Nearest lease or unit boundary: 475'  
Ground Surface Elevation: 1684 feet MSL

Well Drilled For: Well Class: Type Equipment:  
X Oil ... Enh Moc ... Infield X Mud Rotary  
... Gas ... Storage ... Pool Ext. ... Air Rotary  
... OWD ... Disposal X Wildcat ... Cable  
... Seismic; ... # of Holes ... Other

Water well within one-quarter mile: yes X no  
Public water supply well within one mile: yes X no  
Depth to bottom of fresh water: 80'  
Depth to bottom of usable water: 115' 110'

If OWD: old well information as follows:  
Operator:  
Well Name:  
Comp. Date: Old Total Depth

Surface Pipe by Alternate: X 1 2  
Length of Surface Pipe Planned to be set: 120  
Length of Conductor pipe required: 0  
Projected Total Depth: 3950'  
Formation at Total Depth: Kinderhook

Directional, Deviated or Horizontal wellbore? yes X no  
If yes, true vertical depth:  
Bottom Hole Location:

Water Source for Drilling Operations:  
X well ... farm pond ... other  
OWR Permit #: To be applied for  
Will Cores Be Taken?: yes X no  
If yes, proposed zone:

AFFIDAVIT

The undersigned hereby affirms that the drilling, completion and eventual plugging of this well will comply with K.S.A. 55-101, et. seq.  
It is agreed that the following minimum requirements will be met:

- 1. Notify the appropriate district office prior to spudding of well;
- 2. A copy of the approved notice of intent to drill shall be posted on each drilling rig;
- 3. The minimum amount of surface pipe as specified below shall be set by circulating cement to the top; in all cases surface pipe shall be set through all unconsolidated materials plus a minimum of 20 feet into the underlying formation;
- 4. If the well is dry hole, an agreement between the operator and the district office on plug length and placement is necessary prior to plugging;
- 5. The appropriate district office will be notified before well is either plugged or production casing is cemented in;
- 6. IF AN ALTERNATE IS COMPLETED, PRODUCTION PIPE SHALL BE CEMENTED FROM BELOW ANY USABLE WATER TO SURFACE WITHIN 120 DAYS OF SPUD DATE. IN ALL CASES, NOTIFY DISTRICT OFFICE PRIOR TO ANY CEMENTING.

I hereby certify that the statements made herein are true and to the best of my knowledge and belief.  
Date: 10-6-94 Signature of Operator or Agent: Jim Collins Title: Vice President

FOR KCC USE:  
API # 15- 155-21339-0000  
Conductor pipe required NONE feet  
Minimum surface pipe required 120 feet per Alt. X  
Approved by: CR 10-12-94  
This authorization expires: 4-12-95  
(This authorization void if drilling not started within 6 months of effective date.)  
Spud date: Agent:

REMEMBER TO:

- File Drill Pit Application (form GDP-1) with Intent to Drill;
  - File Completion Form ACO-1 within 120 days of spud date;
  - File acreage attribution plat according to field proration orders;
  - Notify appropriate district office 48 hours prior to workover or re-entry;
  - Submit plugging report (CP-4) after plugging is completed;
  - Obtain written approval before disposing or injecting salt water.
- Mail to: Conservation Division, 200 Colorado Derby Building, 202 W. First St., Wichita, Kansas 67202-1286.

10-7-94  
OCT 07 1994

11  
24  
9

IN ALL CASES PLOT THE INTENDED WELL ON THE PLAT BELOW

PLAT OF ACREAGE ATTRIBUTABLE TO A WELL IN A PRORATED OR SPACED FIELD

If the intended well is in a prorated or spaced field, please fully complete this side of the form. If the intended well is in a prorated or spaced field complete the plat below showing that the well will be properly located in relationship to other wells producing from the common source of supply. Please show all the wells within 1 mile of the boundaries of the proposed acreage attribution unit for gas wells and within 1/2 mile of the boundaries of the proposed acreage attribution unit for oil wells.

API NO. 15- \_\_\_\_\_  
 OPERATOR Griggs Oil, Inc.  
 LEASE Gagnebin Gas Unit  
 WELL NUMBER #2  
 FIELD Wildcat

LOCATION OF WELL: COUNTY Reno  
2165 feet from south (north) line of sect:  
1505 feet from (east) west line of section  
 SECTION 11 TWP 24S RG 9W

NUMBER OF ACRES ATTRIBUTABLE TO WELL 40  
 QTR/QTR/QTR OF ACREAGE NE - SW - SE  
145' N & E of

IS SECTION X REGULAR or IRREGULAR  
 IF SECTION IS IRREGULAR, LOCATE WELL FROM NEAREST  
CORNER BOUNDARY.

Section corner used: X NE      NW      SE      SW  
PLAT

(Show location of the well and shade attributable acreage for prorated or spaced wells.)  
 (Show footage to the nearest lease or unit boundary line.)

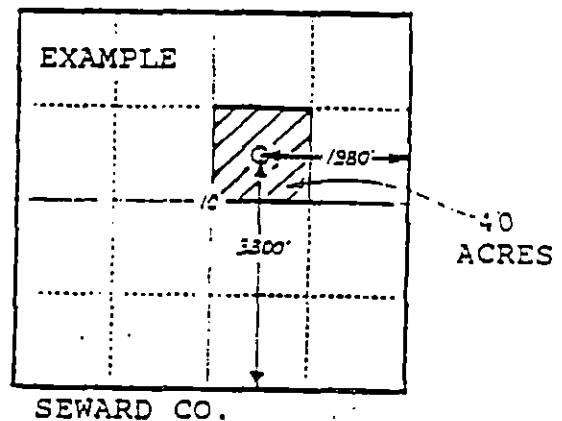
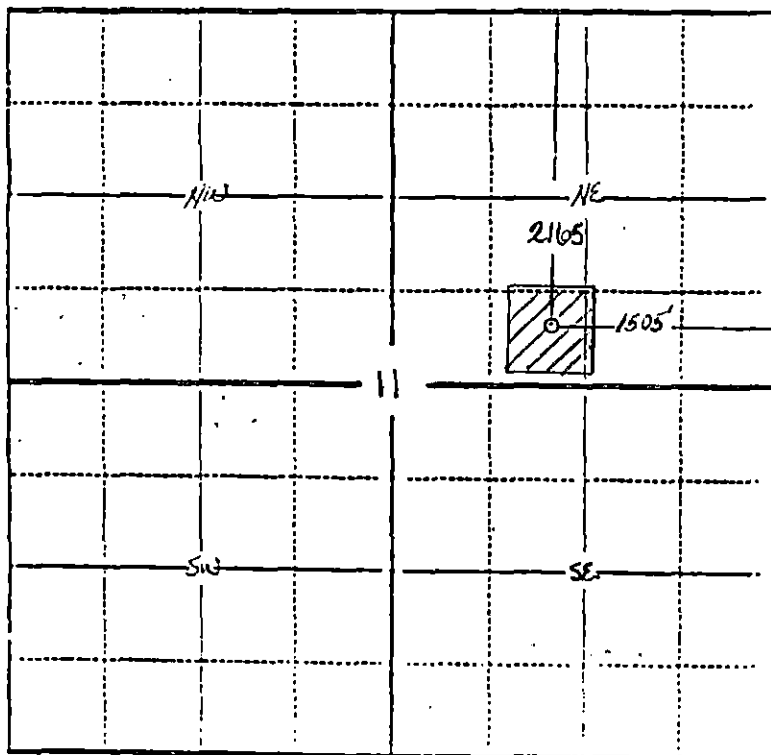

In plotting the proposed location of the well, you must show:

- 1) The manner in which you are using the depicted plat by identifying section lines, i.e. 1 section, 1 section with 8 surrounding sections, 4 sections, etc.;
- 2) the distance of the proposed drilling location, from the section's south/north and east/west lines; and
- 3) the distance to the nearest lease or unit boundary line.