

STATE CORPORATION COMMISSION OF KANSAS
OIL & GAS CONSERVATION DIVISION
WELL COMPLETION FORM
ACO-1 WELL HISTORY
DESCRIPTION OF WELL AND LEASE

ORIGINAL

API NO. 15- 055-20,924-10600
County Finney ✓
APP SE Sec. 19 Twp. 26S Rge. 34 X East West

Operator: License # 4549

1250 ✓ Ft. North from Southeast Corner of Section

Name: Anadarko Petroleum Corporation

1250 ✓ Ft. West from Southeast Corner of Section
(NOTE: Locate well in section plat below.)

Address P.O. Box 351

Lease Name Devlin "A" ✓ Well # 1H

City/State/Zip Liberal, Kansas 67905-0351

Field Name Hugoton

Purchaser: Panhandle Eastern Pipe Line Company
(Transporter)

Producing Formation Chase

Operator Contact Person: J. L. Ashton

Elevation: Ground 2999 KB NA

Phone (316) 624-6253

Total Depth 2878 PBTD 2861

Contractor: Name: Gabbert-Jones, Inc.

License: 5842

Wellsite Geologist: NA

Designate Type of Completion
 New Well Re-Entry Workover

Oil SWD Temp. Abd.
 Gas 52 Inj Delayed Comp.
 Dry Other (Core, Water Supply, etc.)

If OWO: old well info as follows:
Operator: _____

Well Name: _____

Comp. Date _____ Old Total Depth _____

Drilling Method:
 Mud Rotary Air Rotary Cable

8-6-90 8-9-90 1-15-91
Spud Date Date Reached TD Completion Date

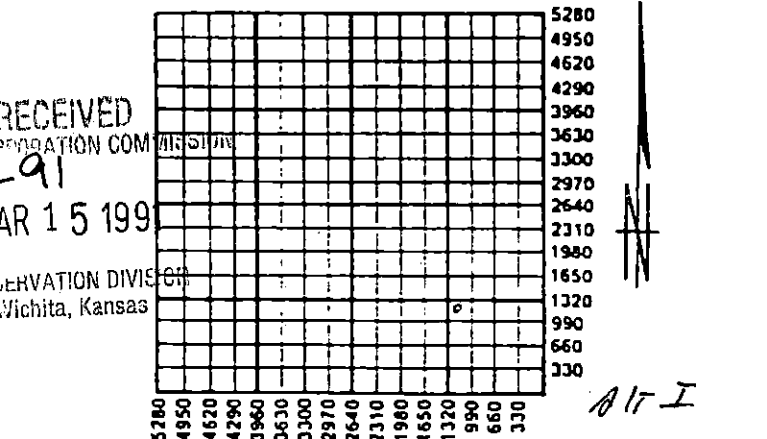

Amount of Surface Pipe Set and Cemented at 869 Feet

Multiple Stage Cementing Collar Used? Yes No

If yes, show depth set _____ Feet

If Alternate II completion, cement circulated from _____

feet depth to _____ w/ _____ sx cmt.

INSTRUCTIONS: This form shall be completed in triplicate and filed with the Kansas Corporation Commission, 200 Colorado Derby Building, Wichita, Kansas 67202, within 120 days of the spud date of any well. Rule 82-3-130, 82-3-107 and 82-3-106 apply. Information on side two of this form will be held confidential for a period of 12 months if requested in writing and submitted with the form. See rule 82-3-107 for confidentiality in excess of 12 months. One copy of all wireline logs and drillers time log shall be attached with this form. ALL CEMENTING TICKETS MUST BE ATTACHED. Submit CP-4 form with all plugged wells. Submit CP-111 form with all temporarily abandoned wells. Any recompletion, workover or conversion of a well requires filing of ACO-2 within 120 days from commencement date of such work.

All requirements of the statutes, rules and regulations promulgated to regulate the oil and gas industry have been fully complied with and the statements herein are complete and correct to the best of my knowledge.

Signature Beverly W. Williams
Beverly W. Williams

Title Engineering Technician Date 2-7-91

Subscribed and sworn to before me this 7th day of February, 19 91.

Notary Public Cheryl Steers

Date Commission Expires _____

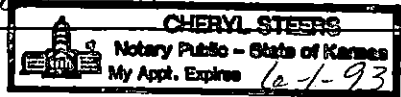

K.C.C. OFFICE USE ONLY
F Letter of Confidentiality Attached
C Wireline Log Received
C Drillers Timelog Received

Distribution
 KCC SWD/Rep NGPA
 KGS Plug Other (Specify)

PI

Operator Name Anadarko Petroleum Corporation

Lease Name Devlin "A"

Well # 1H

Sec. 19 Twp. 26S Rge. 34

East

County Finnéy

West

INSTRUCTIONS: Show important tops and base of formations penetrated. Detail all cores. Report all drill stem tests giving interval tested, time tool open and closed, flowing and shut-in pressures, whether shut-in pressure reached static level, hydrostatic pressures, bottom hole temperature, fluid recovery, and flow rates if gas to surface during test. Attach extra sheet if more space is needed. Attach copy of log.

Drill Stem Tests Taken Yes No
(Attach Additional Sheets.)

Samples Sent to Geological Survey Yes No

Cores Taken Yes No

Electric Log Run (Submit Copy.) Yes No

Formation Description		
	<input checked="" type="checkbox"/> Log	<input type="checkbox"/> Sample
Name	Top	Bottom
Blaine	956	992
Cedar Hills	1284	1346
Stone Corral	1819	1897
Chase	2499	NA
Council Grove	NA	NA
TD		2878

CASING RECORD New Used

Report all strings set-conductor, surface, intermediate, production, etc.

Purpose of String	Size Hole Drilled	Size Casing Set (In O.D.)	Weight Lbs./Ft.	Setting Depth	Type of Cement	# Sacks Used	Type and Percent Additives
Surface	12 1/4	8 5/8	24	864	Pozmix & Common	520	2% cc 3% cc
Production	7 7/8	5 1/2	14	2876	Class "C"	225	20% DCD 10% DCD

Shots Per Foot	PERFORATION RECORD Specify Footage of Each Interval Perforated	Acid, Fracture, Shot, Cement Squeeze Record (Amount and Kind of Material Used)	Depth
2	2696-2730	None	2696-2730
2	2638-78, 2564-2601, 2530-2555, 2501-2513	Brk dwn w/16,800 gals 2% KCL wtr & 370 BS. Frac w/117,000 gals x-linked 2% KCL wtr & 300,700# 12/20 sand.	2501-2678

TUBING RECORD

Size None Set At _____ Packer At _____ Liner Run Yes No

Date of First Production _____ Producing Method Flowing Pumping Gas Lift Other (Explain) _____

SI WO Pipeline

Estimated Production Per 24 Hours	Oil -- Bbls.	Gas 1450 Mcf	Water Bbls.	Gas-Oil Ratio	Gravity
-----------------------------------	--------------	--------------	-------------	---------------	---------

Disposition of Gas: Vented Sold Used on Lease (If vented, submit ACO-18.)

METHOD OF COMPLETION: Open Hole Perforation Dually Completed Commingled Other (Specify) _____

Production Interval: 2501-2730

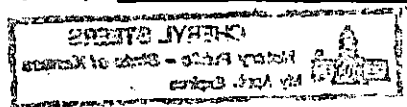

ORIGINAL

WELL NAME: DEVLIN "A" 1H
1250' FSL & 1250' FEL
SEC. 19-26S-34W
FINNEY COUNTY, KANSAS

COMMENCED: 8-6-90

COMPLETED: 8-9-90

OPERATOR: ANADARKO PETROLEUM CORPORATION

15-055-20924-0000

R-11

Depth		Formation	Remarks
From	To		
0	365	Sand - Gravel Redbed Glorietta Sand Lime - Shale	Ran 21 jts of 24# 8 5/8" set @ 870 w/370 sks 25/75 Posmix - 2% CC - 1/4# FS 150 sks Common - 3% CC 1/4# FS PD @ 11:15 AM 8-7-90
365	1420		
1420	1557		
1557	2878		
	2878 TD		Ran 68 jts of 14# 5 1/2" csg set @ 2876 w/185 sks Class C - 20% Diacel D 2% CC - 1/4# FS 40 sks Class C - 10% Diacel D - 2% CC - 1/4# FS PD @ 5:45 PM 8-9-90. RR @ 6:45 PM 8-9-90.

RECEIVED
STATE CORPORATION COMMISSION

MAR 15 1991

Cl...
Wichita, Kansas

STATE OF KANSAS
COUNTY OF SEDGWICK

) I, the undersigned, being duly sworn on oath,
) state that the above Drillers' Well Log is true
) and correct to the best of my knowledge and
belief and according to the records of this office.

GABBERT-JONES, INC.

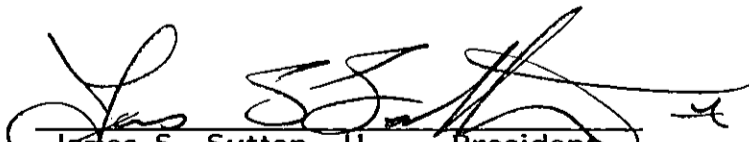
James S. Sutton, II. -- President

Subscribed & sworn to before me this
13th day of August 1990

Lola Lenore Costa

My commission expires Nov. 21, 1992

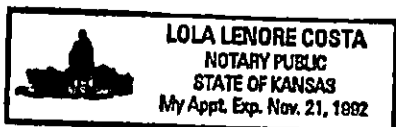



INVOICE

HALLIBURTON SERVICES ORIGINAL

A Halliburton Company

INVOICE NO.	DATE
990422	08/07/1990

WELL LEASE NO./PLANT NAME		WELL/PLANT LOCATION		STATE	WELL/PLANT OWNER	
DEVLIN A-1H		FINNEY		KS	SAME	
SERVICE LOCATION		CONTRACTOR	JOB PURPOSE		TICKET DATE	
LIBERAL		GABBERT & JONES #11	CEMENT SURFACE CASING		08/07/1990	
ACCT. NO.	CUSTOMER AGENT	VENDOR NO.	CUSTOMER P.O. NUMBER	SHIPPED VIA	FILE NO.	
019595	JOHN SHILLING		33876	COMPANY TRUCK	99615	

ANADARKO PETROLEUM CORP
P. O. BOX 351
LIBERAL, KS 67905-0351

DIRECT CORRESPONDENCE TO:
SUITE 1300
LIBERTY TOWER
100 BROADWAY AVENUE
OKLAHOMA CITY, OK 73102-0000

PRICE REF. NO.	DESCRIPTION	QUANTITY	U/M	UNIT PRICE	AMOUNT
000-117	PRICING AREA - MID CONTINENT MILEAGE	52	MI	2.35	122.20
		1	UNT		
001-016	CEMENTING CASING	873	FT	630.00	630.00
		1	UNT		
030-018	CEMENTING PLUG 5W, PLASTIC TOP	8	5/8 IN	100.00	100.00
		1	EA		
504-043	PREMIUM CEMENT	150	SK	6.85	1,027.50
504-043	PREMIUM CEMENT	278	SK	6.85	1,904.30
506-105	POZMIX A	92	SK	3.91	359.72
506-121	HALLIBURTON-GEL 2%	7	SK	.00	N/C
507-210	FLOCELE	130	LB	1.30	169.00
509-406	ANHYDROUS CALCIUM CHLORIDE	11	SK	26.25	288.75
500-207	BULK SERVICE CHARGE	551	CFT	1.10	606.10
500-306	MILEAGE CMTG MAT DEL OR RETURN	487.100	TMI	.75	365.33
INVOICE SUBTOTAL					5,572.90
DISCOUNT-(BID)					1,671.85-
INVOICE BID AMOUNT					3,901.05
*-KANSAS STATE SALES TAX					143.42
*-SEWARD COUNTY SALES TAX					33.74
INVOICE TOTAL - PLEASE PAY THIS AMOUNT =====>					\$4,078.21

4179-2041

John Shilling

8-13-90

TERMS INVOICES PAYABLE NET BY THE 20TH OF THE FOLLOWING MONTH AFTER DATE OF INVOICE. UPON CUSTOMER'S DEFAULT IN PAYMENT OF CUSTOMER'S ACCOUNT BY THE LAST DAY OF THE MONTH FOLLOWING THE MONTH IN WHICH THE INVOICE IS DATED. CUSTOMER AGREES TO PAY INTEREST THEREON AFTER DEFAULT AT THE HIGHEST LAWFUL CONTRACT RATE APPLICABLE BUT NEVER TO EXCEED 18% PER ANNUM. IN THE EVENT IT BECOMES NECESSARY TO EMPLOY AN ATTORNEY TO ENFORCE COLLECTION OF SAID ACCOUNT. CUSTOMER AGREES TO PAY ALL COLLECTION COSTS AND ATTORNEY FEES IN THE AMOUNT OF 20% OF THE AMOUNT OF THE UNPAID ACCOUNT.



HALLIBURTON SERVICES ORIGINAL

INVOICE

A Halliburton Company

INVOICE NO.	DATE
990424	08/09/1990

WELL LEASE NO./PLANT NAME		WELL/PLANT LOCATION		STATE	WELL/PLANT OWNER	
DEVLIN A-1H		FINNEY		KS	SAME	
SERVICE LOCATION		CONTRACTOR		JOB PURPOSE		TICKET DATE
LIBERAL		GABBERT & JONES #11		CEMENT PRODUCTION CASING		08/09/1990
ACCT. NO.	CUSTOMER AGENT	VENDOR NO.	CUSTOMER P.O. NUMBER	SHIPPED VIA	FILE NO.	
019595	J N SHILLING		33876	COMPANY TRUCK	99919	

ANADARKO PETROLEUM CORP
P. O. BOX 351
LIBERAL, KS 67905-0351

DIRECT CORRESPONDENCE TO:
SUITE 1300
LIBERTY TOWER
100 BROADWAY AVENUE
OKLAHOMA CITY, OK 73102-0000

PRICE REF. NO.	DESCRIPTION	QUANTITY	U/M	UNIT PRICE	AMOUNT
000-117	PRICING AREA - MID CONTINENT MILEAGE	20	MI	2.35	47.00
001-016	CEMENTING CASING	2876	FT	1,045.00	1,045.00
030-018	CEMENTING PLUG SW, PLASTIC TOP	5.5	IN	53.00	53.00
218-738	CLAYFIX II	2	GAL	20.00	40.00
018-315	MUD FLUSH	1260	GAL	.45	567.00
504-050	PREMIUM PLUS CEMENT	225	SK	7.08	1,593.00
507-210	FLOCELE	56	LB	1.30	72.80
509-406	ANHYDROUS CALCIUM CHLORIDE	5	SK	26.25	131.25
500-959	CELITE	3900	LB	.42	1,638.00
500-207	BULK SERVICE CHARGE	473	CFT	1.10	520.30
500-306	MILEAGE CMTG MAT DEL OR RETURN	255.060	TMI	.75	191.30
INVOICE SUBTOTAL					5,898.65
DISCOUNT-(BID)					2,064.51-
INVOICE BID AMOUNT					3,834.14
*-KANSAS STATE SALES TAX					116.01
*-SEWARD COUNTY SALES TAX					27.28
INVOICE TOTAL - PLEASE PAY THIS AMOUNT =====>					\$3,977.43

John Sheen

4179-2041

8-22-90

TERMS INVOICES PAYABLE NET BY THE 20TH OF THE FOLLOWING MONTH AFTER DATE OF INVOICE. UPON CUSTOMER'S DEFAULT IN PAYMENT OF CUSTOMER'S ACCOUNT BY THE LAST DAY OF THE MONTH FOLLOWING THE MONTH IN WHICH THE INVOICE IS DATED, CUSTOMER AGREES TO PAY INTEREST THEREON AFTER DEFAULT AT THE HIGHEST LAWFUL CONTRACT RATE APPLICABLE BUT NEVER TO EXCEED 18% PER ANNUM. IN THE EVENT IT BECOMES NECESSARY TO EMPLOY AN ATTORNEY TO ENFORCE COLLECTION OF SAID ACCOUNT, CUSTOMER AGREES TO PAY ALL COLLECTION COSTS AND ATTORNEY FEES IN THE AMOUNT OF 20% OF THE AMOUNT OF THE UNPAID ACCOUNT.