

STATE CORPORATION COMMISSION OF KANSAS
OIL & GAS CONSERVATION DIVISION

WELL COMPLETION OR RECOMPLETION FORM
ACO-1 WELL HISTORY

DESCRIPTION OF WELL AND LEASE

Operator: License # 5253
Name Northern Pump Company
Address Box 937
City/State/Zip Garden City, Ks. 67846

Purchaser Northwest Central Pipeline

Operator Contact Person J. Leo Fife
Phone 316-276-3267

Contractor: License # 6033
Name Murfin Drlg. Co.

Wellsite Geologist Steve Harpham
Phone 303-572-8686

Designate Type of Completion
 New Well Re-Entry Workover
 Oil SWD Temp Abd
 Gas Inj Delayed Comp.
 Dry Other (Core, Water Supply etc.)

If OWWO: old well info as follows:
Operator
Well Name
Comp. Date Old Total Depth

WELL HISTORY

Drilling Method:
 Mud Rotary Air Rotary Cable
2/14/86 2/18/86 3/18/86
Spud Date Date Reached TD Completion Date
3,000 ft. 2,956 ft.
Total Depth PBTD

Amount of Surface Pipe Set and Cemented at: 903 feet
Multiple Stage Cementing Collar Used? Yes No
If yes, show depth set.....feet
If alternate 2 completion, cement circulated from 903 feet depth to Surface/500 SX cmt

API NO. 15-055-20,641-0000
County Finney
NE SE NW/4 29 24 Rge 32 East West

3,655 Ft North from Southeast Corner of Section
3,080 Ft West from Southeast Corner of Section
(Note: Locate well in section plat below)

Lease Name Burnside Well # 29-2

Field Name Hugoton

Producing Formation Chase

Elevation: Ground 2,853' KB 2,858'

Section Plat

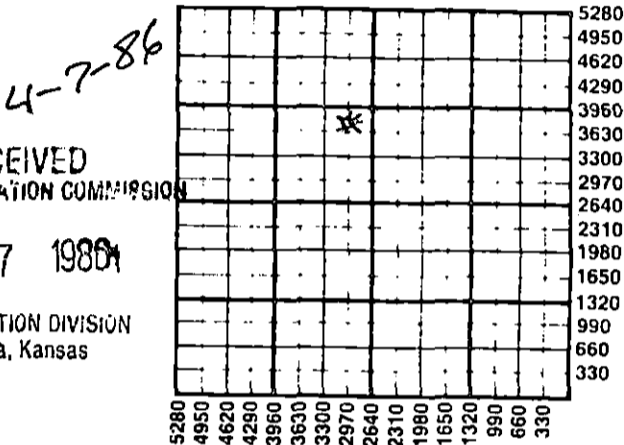

WATER SUPPLY INFORMATION

Disposition of Produced Water: Disposal Repressuring
Docket #

Questions on this portion of the ACO-1 call:
Water Resources Board (913) 296-3717

Source of Water:
Division of Water Resources Permit # T 86 - 77

Groundwater 3655 Ft North from Southeast Corner (Well) 2955 Ft West from Southeast Corner of Sec 29 Twp 24 Rge 32 East West

Surface Water.....Ft North from Southeast Corner (Stream, pond etc).....Ft West from Southeast Corner Sec Twp Rge East West

Other (explain).....
(purchased from city, R.W.D. #)

INSTRUCTIONS: This form shall be completed in duplicate and filed with the Kansas Corporation Commission, 200 Colorado Derby Building, Wichita, Kansas 67202, within 90 days after completion or recompletion of any well. Rule 82-3-130 and 82-3-107 apply.

Information on side two of this form will be held confidential for a period of 12 months if requested in writing and submitted with the form. See rule 82-3-107 for confidentiality in excess of 12 months. One copy of all wireline logs and drillers time log shall be attached with this form. Submit CP-4 form with all plugged wells. Submit CP-111 form with all temporarily abandoned wells.

All requirements of the statutes, rules and regulations promulgated to regulate the oil and gas industry have been fully complied with and the statements herein are complete and correct to the best of my knowledge.

Signature J. Leo Fife
Title Production Supt Date 4-3-86

Subscribed and sworn to before me this 3rd day of April 1986

Notary Public Dale L. Hyslop

Date Commission Expires November 12, 1988

K.C.C. OFFICE USE ONLY
F Letter of Confidentiality Attached
C Wireline Log Received
C Drillers Time Log Received
Distribution
 KCC SWD/Rep NGPA
 KGS Plug Other
(Specify)

Section 21 Range 32 W

SIDE TWO

Operator Name Northern Pump Company Lease Name Burnside Well # 29-2

Sec. 29 Twp. 24 Rge. 32 East West County Finney

WELL LOG

INSTRUCTIONS: Show important tops and base of formations penetrated. Detail all cores. Report all drill stem tests giving interval tested, time tool open and closed, flowing and shut-in pressures, whether shut-in pressure reached static level, hydrostatic pressures, bottom hole temperature, fluid recovery, and flow rates if gas to surface during test. Attach extra sheet if more space is needed. Attach copy of log.

Drill Stem Tests Taken Yes No
 Samples Sent to Geological Survey Yes No
 Cores Taken Yes No

Formation Description
 Log Sample

Name	Top	Bottom
Spectral Density Dual Spaced Neutron Log		
Compensated Spectral Natural Gamma Ray Log		
Wlecal Log		
Borehole Profile Plot Log		
Herrington	2648-60	2524-43
Krider	2584-96	
Winfield	2524-43	2648-60

CASING RECORD <input checked="" type="checkbox"/> New <input type="checkbox"/> Used							
Report all strings set-conductor, surface, intermediate, production, etc.							
Purpose of String	Size Hole Drilled	Size Casing Set (in O.D.)	Weight Lbs/Ft.	Setting Depth	Type of Cement	#Sacks Used	Type and Percent Additives
Surface	12 1/4"	8-5/8"	24#	903	Light Wt. Class H	350	2% CC
Production	7-7/8"	5-1/2"	15.5#	3000	Light Class H	400	3% CC
						150	3% per sk

PERFORATION RECORD			Acid, Fracture, Shot, Cement Squeeze Record	
Shots Per Foot	Specify Footage of Each Interval Perforated		(Amount and Kind of Material Used)	Depth
4	2648-60		2000 Gal. 15% HCL Acid	
4	2584-96		1000 Gal. MRSI -1000SCF Nitrogen per. BBL. Fluid	
4	2524-43		Fraced w/108# sand 52,000 gal. Cross link Gel.	

TUBING RECORD		Size	Set At	Packer at	Liner Run	<input type="checkbox"/> Yes <input checked="" type="checkbox"/> No
		2-3/8"	2,682'			

Date of First Production	Producing Method				
Not hooked up	<input checked="" type="checkbox"/> Flowing <input checked="" type="checkbox"/> Pumping <input type="checkbox"/> Gas Lift <input type="checkbox"/> Other (explain).....				
	Oil	Gas	Water	Gas-Oil Ratio	Gravity
Estimated Production Per 24 Hours	Bbls	500 MCF	10 Bbls		CFPB

D65

METHOD OF COMPLETION Production Interval

Disposition of gas: Vented Open Hole Perforation
 Sold Other (Specify) 2648-60
 Used on Lease 2584-96
 Dually Completed 2524-43
 Commingled