

KANSAS

FORM CP-3
Rev. 5-5-81

STATE CORPORATION COMMISSION

CONSERVATION DIVISION AGENT REPORT

Authority April 6, 1981
API Number 15-075-20, 849

200 Colorado Derby Bldg.
Wichita, KS 67202

Operator's Full Name Dietrich Petroleum Corporation

Complete Address # 2450, 410 17th St, Denver Colo. 80202

Lease Name B. A. Tate Well No. 27-13.

Location App. C. E 1/2 W 1/2 Sw. Sec. 27 Twp. 24 Rge. 41 (East) (West)

County Hamilton Total Depth 2700'

Abandoned Oil Well Gas Well Input Well SWD Well D & A

Other well as hereafter indicated _____

Plugging Contractor Halliburton Cementing

Address Lamar Colo. License No. _____

Operation Completed: Hour: 11:00 AM Day: 17 Month: July Year: 1981

Plugging Operations attended by Agent? All Part None

The above well was plugged as follows:

There was 319' of 8 1/8" surface casing
5 1/2" set to 2700'. Plug at back 2400'
perforations were 2390-2382. 1st plug
on bottom with 20 lbs cement heavy
mud to 450'. 25 lbs cement heavy
mud to 45. 5 lbs from 45-0. There
was no salvage.

RECEIVED 6-20-81
STATE CORPORATION COMMISSION

JUL 20 1981

I hereby certify that the above well was plugged as herein stated.

Signed: Shirley Thomas
Conservation Division Agent

INVOICED

DATE 8-28-81

NOV. NO. 6146-W

CONSERVATION DIVISION
Wichita, Kansas

15-075-20349-0000

IMPORTANT
 Kans. Geo. Survey request samples on this well.

KANSAS

WELL COMPLETION REPORT AND DRILLER'S LOG

API No. 15 — 075 — 20349
 County Number

Operator
 Dietrich Petroleum Corporation

Address
 1741 Crestridge Drive, Littleton, Colorado 80121

Well No. 27-13 Lease Name Tate

Footage Location
 1320 feet from (N) (S) line 1000' feet from (E) (W) line

Principal Contractor Lakin Drilling Company Geologist R.L. Higginbottom

Spud Date 11-27-80 Date Completed 7-17-81 Total Depth 2700' RTD P.B.T.D. 2698'

Directional Deviation None Oil and/or Gas Purchaser No Production

S. 27 T. 24S R. 41 ^{XX}W
 Loc. 1320 FSL, 1000' FWL
 County Hamilton

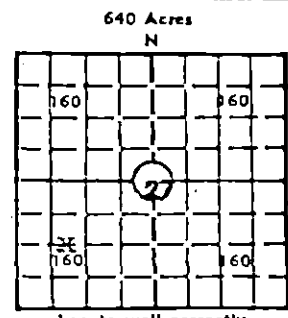

Elev.: Gr. 3335'
 DF KB 3342'

CASING RECORD

Report of all strings set— surface, intermediate, production, etc.

Purpose of string	Size hole drilled	Size casing set (in O.D.)	Weight lbs/ft.	Setting depth	Type cement	Sacks	Type and percent additives
Surface	12 1/2"	8-5/8"	20#	328'	Class "H"	300	3% CaCl ₂
Production	7-7/8"	5 1/2"	15.5#	2700'	Class "H"	400	4 1/2% Gel 18% Salt
cement circulated to surface on both 8-5/8" and 5 1/2" casing strings							

LINER RECORD

PERFORATION RECORD

Top, ft.	Bottom, ft.	Sacks cement	Shots per ft.	Size & type	Depth interval
			1	jets	2382-90' (Winfield)

TUBING RECORD

Size	Setting depth	Packer set at
2-3/8"	2394'	None

ACID, FRACTURE, SHOT, CEMENT SQUEEZE RECORD

Amount and kind of material used	Depth interval treated
Az w/ 500 gal. 15% HCL	2382-90'
Frac w/ 15,000 gal gelled KCL water-20,000#	2382-90'
20-40 Sand-22 tons CO ₂	

INITIAL PRODUCTION

RECEIVED
 STATE CORPORATION COMMISSION

Date of first production Producing method (flowing, pumping, gas lift, etc.)
 SEP - 2 1981

RATE OF PRODUCTION PER 24 HOURS	Oil	Gas	Water	Gas-oil ratio
	bbls.	MCF	bbls.	

Disposition of gas (vented, used on lease or sold) Producing interval (s)
 CONSERVATION DIVISION
 Wichita, Kansas

INSTRUCTIONS: As provided in KCC Rule 82-2-125, within 90 days after completion of a well, one completed copy of this Drillers Log shall be transmitted to the State Geological Survey of Kansas, 4150 Monroe Street, Wichita, Kansas 67209. Copies of this form are available from the Conservation Division, State Corporation Commission, 245 No. Water, Wichita, Kansas 67202. Phone AC 316-522-2206. If confidential custody is desired, please note Rule 82-2-125. Drillers Logs will be on an open file in the Oil and Gas Division, State Geological Survey of Kansas, Lawrence, Kansas 66044.

Operator **Dietrich Petroleum Corporation** DESIGNATE TYPE OF COMP.: OIL, GAS, DRY HOLE, SWDW, ETC.: **Dry Hole**

Well No. **27-13** Lease Name **Tate**

S 27 T 24S R 41 ~~E~~
W

WELL LOG

Show all important zones of porosity and contents thereof; cored intervals, and all drill-stem tests, including depth interval tested, cushion used, time tool open, flowing and shut-in pressures, and recoveries.

SHOW GEOLOGICAL MARKERS, LOGS RUN, OR OTHER DESCRIPTIVE INFORMATION.

FORMATION DESCRIPTION, CONTENTS, ETC.	TOP	BOTTOM	NAME	DEPTH
Stone Corral		1870 (+1472)	Welex GR - ACV	2707'
Upper Winfield-Gas, SW		2374 (+968)		
No Cores				
No DST's				
<p>This well was tested extensively from 1-17-81 through 3-11-81 while pumping off saltwater at a final rate of approximately 170 barrels per day while producing approximately 40-50 MCFGPD against an average wellhead pressure of 5-10#. The well was plugged and abandoned 7-17-81 as non-commercial. Plugs set as follows:</p> <p>20 sacks at 2220'-2400' 25 sacks at 225'-450' 20 sacks at surface mud spotted between all plugs Plugging witnessed by Clarence Thomas, State Corporation Commission, Garden City, Kansas.</p>				

USE ADDITIONAL SHEETS, IF NECESSARY, TO COMPLETE WELL RECORD.

Date Received	<i>Ray Dietrich</i> Signature
	President Title
	8-10-81 Date

