

STATE OF KANSAS
STATE CORPORATION COMMISSION

WELL PLUGGING RECORD

Give All Information Completely
Make Required Affidavit
Mail or Deliver Report to:
Conservation Division
State Corporation Commission
211 No. Broadway
Wichita, Kansas

HODGEMAN County, Sec. 9 Twp. 24s Rge. 21W (W)

Location as "NE/CNW/SW" or footage from lines APPROX. C NE SW

Lease Owner PETROLEUM, INC.,

Lease Name STRECKER "D" Well No. 1

Office Address R.R. #2, GREAT BEND, KANSAS

Character of Well (completed as Oil, Gas or Dry Hole) DRY HOLE

Date well completed 11/6/ 19 63

Application for plugging filed 11/6/ 19 63

Application for plugging approved 11/6/ 19 63

Plugging commenced 11/6/ 19 63

Plugging completed 11/6/ 19 63

Reason for abandonment of well or producing formation NO PRODUCIBLE ZONES

If a producing well is abandoned, date of last production - 19

Was permission obtained from the Conservation Division or its agents before plugging was commenced? YES

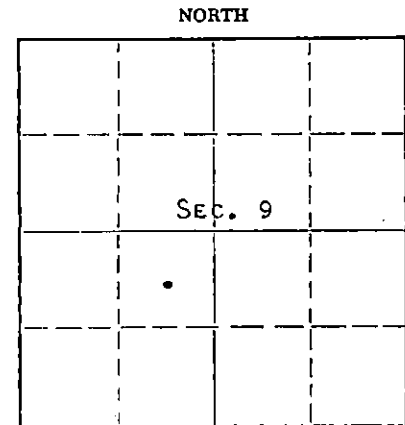

Locate well correctly on above Section Plat

Name of Conservation Agent who supervised plugging of this well HUGH E. SCOTT

Producing formation - - Depth to top - - Bottom - - Total Depth of Well 4699 Feet

Show depth and thickness of all water, oil and gas formations.

OIL, GAS OR WATER RECORDS

CASING RECORD

FORMATION	CONTENT	FROM	TO	SIZE	PUT IN	PULLED OUT
				8-5/8	258	NONE

Describe in detail the manner in which the well was plugged, indicating where the mud fluid was placed and the method or methods used in introducing it into the hole. If cement or other plugs were used, state the character of same and depth placed, from feet to feet for each plug set.

MUDDING UP WITH HEAVY MUD TO 540', FOLLOWED BY A WOODEN PLUG & 20 SACKS OF CEMENT. MUDDING UP WITH HEAVY MUD TO 240', FOLLOWED BY WOODEN PLUG AND 20 SACKS CEMENT, MUDDING UP WITH HEAVY MUD TO 40', FOLLOWED BY A WOODEN PLUG. PLACED 10 SACKS CEMENT ON TOP OF WOODEN PLUG TO BASE OF WELL CELLAR.

RECEIVED
STATE CORPORATION COMMISSION

NOV 18 1963

CONSERVATION DIVISION
Wichita, Kansas

(If additional description is necessary, use BACK of this sheet)

Name of Plugging Contractor GARVEY DRILLING COMPANY
Address R. R. #2, GREAT BEND, KANSAS

STATE OF KANSAS, COUNTY OF BARTON, ss. MONTE CHADD

(employee of owner) or (owner or operator) of the above-described well, being first duly sworn on oath, says: That I have knowledge of the facts, statements, and matters herein contained and the log of the above-described well as filed and that the same are true and correct. So help me God. MONTE CHADD, DIST. PROD. SUPT.

(Signature) *Monte Chadd*
R. R. #2, GREAT BEND, KANSAS
(Address)

SUBSCRIBED AND SWORN TO before me this 14TH day of NOVEMBER, 19 63

My commission expires SEPTEMBER 23, 1967

Howard E. Bair
Notary Public.

15-083-10172-0000
WELL LOG

COMPANY Petroleum, Inc.

SEC. 9 T.24S R. 21W

FARM Strecker D-1

NO. D-1

LOC. NE SW

TOTAL DEPTH 4699'

COUNTY Hodgeman

COMM. 10=25=63

COMP. 11=6=63

CONTRACTOR Garvey Drilling Company



CASING 8 5/8" @ 258' w/175 sx

ELEVATION 2363 D.F.

PRODUCTION D & A

FIGURES INDICATE BOTTOM OF FORMATIONS

- 75' Surface Clay and Sand
- 205' Blue Shale
- 225' Sand
- 258' Shale
- 950' Shale and Sand
- 1060' Sand
- 1470' Sand and Shale
- 1487' Anhydrite
- 2255' Red Bed and Shale
- 2570' Shale and Lime
- 2750' Lime and Shale
- 3430' Shale and Lime
- 3492' Lime and Shale
- 4060' Shale and Lime
- 4135' Lime and Shale
- 4273' Lime
- 4362' Lime and Shale
- 4585' Lime
- 4612' Lime and Shale
- 4688' Lime
- 4695' Lime and Chert
- 4699' Chert
- 4699' RTD

RECEIVED
STATE CORPORATION COMMISSION

NOV 18 1963

CONSERVATION DIVISION
Wichita, Kansas

State of Kansas }
County of Barton } ss

I, Sam N. Stephens of Garvey Drilling Company
upon oath state the above and foregoing is a true and correct copy of the log of the Strecker D-1 well.

Sam N. Stephens

Subscribed and sworn to before me this 13th day of November 19 63

My Commission Expires: September 23, 1967

Richard O. Davis
NOTARY PUBLIC