

WELL PLUGGING RECORD

Give All Information Completely
Make Required Affidavit
Mail or Deliver Report to:
Conservation Division
State Corporation Commission
211 No. Broadway
Wichita, Kansas

Reno County. Sec. 34 Twp. 25 Rge. 4 (E) W (W)
Location as "NE/CNWxSWx" or footage from lines. SW NW SW
Lease Owner Clay Phillips
Lease Name Newby #1 Well No.
Office Address 430 West 23
Character of Well (completed as Oil, Gas or Dry Hole) Exhausted Oil well
Date well completed Nov. 16 1943
Application for plugging filed April 9 1956
Application for plugging approved April 12 1956
Plugging commenced 4-13-56 19
Plugging completed 4-20-56 19
Reason for abandonment of well or producing formation Exhausted

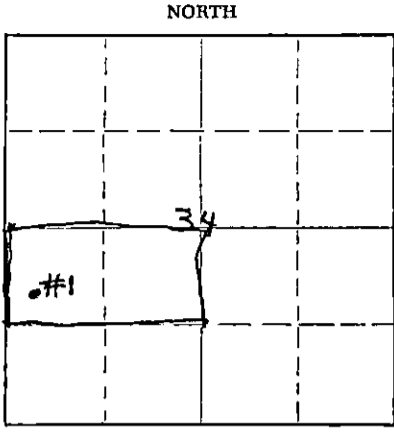

Locate well correctly on above Section Plat

If a producing well is abandoned, date of last production 19
Was permission obtained from the Conservation Division or its agents before plugging was commenced? Yes

Name of Conservation Agent who supervised plugging of this well Mr. Durkee
Producing formation Viola Lime Depth to top 4092' Bottom 4096' Total Depth of Well 4096' Feet
Show depth and thickness of all water, oil and gas formations.

OIL, GAS OR WATER RECORDS

CASING RECORD

FORMATION	CONTENT	FROM	TO	SIZE	PUT IN	PULLED OUT
Lansing Lime-2852'				10 3/4"	300'	No recovery
Mississippi Lime-3651'				6 5/8"	4092'	3502-95
Viola Lime-4092'						

Describe in detail the manner in which the well was plugged, indicating where the mud fluid was placed and the method or methods used in introducing it into the hole. If cement or other plugs were used, state the character of same and depth placed, from _____ feet to _____ feet for each plug set.

Fill hole with chat from 4096' to 4080'
Run 6 sks. cement from 4080' to 4050'
Fill hole with mud to 350' & make solid with rock
Run 30 sks. cement at 300'
Fill with mud to 15' and make solid with rock
Cap with 5 sks. cement to cellar base.

(If additional description is necessary, use BACK of this sheet)
Name of Plugging Contractor Morgan Well Plugging Service
Address 102 West 18th-Hutchinson, Kansas

STATE OF Kansas COUNTY OF Reno, ss.
Clay Phillips (employee of owner) or (owner or operator) of the above-described well, being first duly sworn on oath, says: That I have knowledge of the facts, statements, and matters herein contained and the log of the above-described well as filed and that the same are true and correct. So help me God.

(Signature) Clay Phillips
430 W 23 St (Address)

SUBSCRIBED AND SWORN to before me this 25th day of April, 1956

My commission expires January 6, 1958

Margaret Morgan Notary Public.

RECEIVED
STATE CORPORATION COMMISSION

APR 26 1956 4-26-56
CONSERVATION DIVISION
Wichita, Kansas

PLUGGING
FILE SEC 34 T 25 R 4W
BOOK PAGE 52 LINE 29

15-155-02714-0000

FORM N47A REV.

Sold to Clay Phillips effective April 9, 1956

SKELLY OIL COMPANY

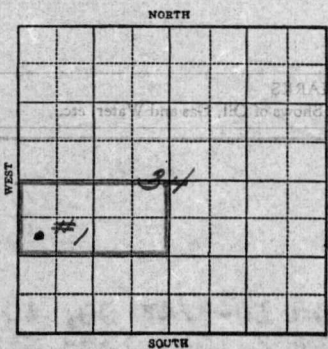

WELL RECORD

Lease Name and No. R. M. Newby #23635 Well No. 1 Elev. 1545' DF
 Lease Description North Half of southwest quarter (N/2 SW/4) Section 34, Twp. 25 S, Range 4 W, Reno County, Kansas
 Location made Sept. 10 1943 by Goold Randolph
 feet from North line..... feet from East line } N/2 SW/4
330 feet from South line..... 330 feet from West line } Sec. 34

Work com'd Sept. 16 1943 Rig com'd Sept. 17 1943 Drlg. com'd Sept. 29 1943 Drlg. comp'd Nov. 16 1943
 Rig Contractor Bodine Drilling Company
 Drilling Contractor Bodine Drilling Company, Great Bend, Kansas

Rotary Drilling from Top to 4094' Cable Tool Drilling from 4094' to 4096'

Commenced Producing November 17 1943 { Initial Prod. before shot or acid 3727 Bbls. (Indicated prod-activity by seismometer to establish max. 25 ft. initial prod. after shot or acid 3.0.0. potential of 3000 Bbls.

Dry Gas Well Press..... Volume..... Cu. ft.
 Casing Head Gas Pressure..... Volume..... Cu. ft.
 Braden Head (10-3/4" x 6-5/8") Gas Pressure..... Volume..... Cu. ft.
 Braden Head (.....) Gas Pressure..... Volume..... Cu. ft.

PRODUCING FORMATION Viola Line (Name) Top 4092' Bottom 4096' TOTAL DEPTH 4096'

CASING RECORD

4-26-56

Size	Wt.	Thds.	Where Set	PULLED OUT			LEFT IN			KIND	Cond'n	CEMENTING	
				Jts.	Feet	In	Jts.	Feet	In			Sacks Used	Method Employed
10-3/4" OD 40 1/8 V			300'				10	297	3	Seamless	A	250	Halliburton
10-3/4" Casing: Grade "C", Range 2													
6-5/8" OD 24 1/0 V			4092'				135	4127	6	Seamless	S.H.	150	Halliburton
6-5/8" Casing: Grade ?, Range 2													
(10-3/4" Casing set 6' in cellar and 6-5/8" cased to derrick floor)													
(Used 1 - Halliburton Combination Guide & Float shoe)													

Liner Set at..... Length..... Perforated at.....
 Liner Set at..... Length..... Perforated at.....

Packer Set at..... Size and Kind.....
 Packer Set at..... Size and Kind.....

SHOT OR ACID TREATMENT RECORD

Date	FIRST		SECOND		THIRD		FOURTH	
	Ft. and	Ft.	Ft. and	Ft.	Ft. and	Ft.	Ft. and	Ft.
Acid Used		Gals. Qts.		Gals. Qts.		Gals. Qts.		Gals. Qts.
Size Shot								
Shot Between								
Size of Shell								
Put in by (Co.)								
Length anchor								
Distance below Cas'g								
Damage to Casing or Casing Shoulder								

SIGNIFICANT GEOLOGICAL FORMATIONS

NAME	Top	Bottom	GAS		OIL		REMARKS
			From	To	From	To	
Lensing Blue	2852'						
Mississippi Lime	3651'						
Viola Line	4092'				4092'	4094'	Slight porosity & saturation
					4094'	4096'	Saturated
							FAY FORMATION

CLEANING OUT RECORDS

	DATE COMMENCED	DATE COMPLETED	PROD. BEFORE	PROD. AFTER	REMARKS
1st.					See Reverse for other details.
2nd					" " " " "
3rd					" " " " "
4th					" " " " "

PLUGGING BACK AND DEEPENING RECORDS

	Date Commenced	Date Completed	No. Feet Plugged Back or Deepened	Prod. Before	Prod. After	REMARKS
1st						See Reverse for other details.
2nd						" " " " "
3rd						" " " " "
4th						" " " " "

(See Reverse for Record of Formation)

PLUGGING
 FILE SEC 34 T 25 R 4W
 BOOK PAGE 52 LINE 29

15-100-02714-0000
 Sold to Clay Phillips effective April 9, 1933

RECORD OF FORMATIONS

FORMATION	TOP	BOTTOM	REMARKS
Surface soil and clay	0	20	
Red bed	20	50	
Sand	50	100	
Sand, red bed & shale	100	290	
Grey shale & shells	290	305	
Sand	305	325	
Grey shale	325	615	
Shale and shells	615	925	
Shale	925	1000	
Lime	1000	1085	
Shale and lime	1085	1215	
Sandy lime	1215	1335	
Lime	1335	1430	
Shale and shells	1430	1515	
Shale and lime	1515	1725	
Shale	1725	1835	
Sand and shale	1835	1905	
Shale and shells	1905	2005	
Shale	2005	2115	
Shale and sand	2115	2135	
Lime	2135	2145	
Lime and shale	2145	2455	
Lime	2455	2515	
Broken lime	2515	2550	
Lime	2550	2728	
Lime and shale	2728	2750	
Shale	2750	2920	
Shale and lime	2920	2960	
Broken lime	2960	3005	
Lime	3005	3040	
Broken lime and shale	3040	3100	
Shale	3100	3140	
Shale and lime	3140	3165	
Hard dark grey lime	3165	3200	
Lime	3200	3225	
Shale	3225	3270	
Grey lime	3270	3295	
Broken lime	3295	3320	
Lime	3320	3355	
Shale	3355	3651	
Lime	3651	3720	
Shale	3720	3750	
Lime	3750	3762	
Shale	3762	3767	
Lime	3767	3795	
Shale and lime	3795	3865	
Shale	3865	3885	
Shale and lime	3885	3930	
Shale	3930	3942	
Lime and shale	3942	3950	
Lime	3950	3960	
Sandy shale	3960	3980	
Shale	3980	4092	

Set and cemented 10-3/4" OD, 40.50#, Grade "C", Range 2, Seamless Steel casing at 300' with 250 sacks of cement.

TOP LANSING LINE 2852'

TOP MISSISSIPPI LINE 3651'

TOP VIOLA LINE 4092'

Slight porosity and saturation set and cemented 6-5/8" OD, 24#, S.H. 10" V-thread, Range 2, Seamless Steel casing at 4092' with 50 sacks of cement. Finished cementing at 7:35 AM November 5, 1943, and while shut down waiting on cement to set, moved in and rigged up cable tools. Finished rigging up and bailed the hole dry on November 15, 1943, and 6-5/8" casing tested OK. Drilled cement plug and cement job tested OK, no shows.

FORMATION	TOP	BOTTOM	REMARKS
Grey and brown coarsely crystalline lime and dolomite	4092	4094	
DRILLED			
brown porous coarsely crystalline dolomite	4094	4096	
Saturated - 2900' OIH in 1 hour, 3000' OIH 2 hours, 3800' OIH in 2 1/2 hours			
TOTAL DEPTH		4096'	

Bailed hole clean, 3900' OIH, laid down tools and ran 2" tubing and rods. FOB 8 hours on pretest for potential test, 168 barrels of oil and no water. On November 17th, FOB 12 hours with Echometer, 192 barrels of oil and no water for indicated productivity of 3727 barrels to establish Maximum 24 hour State Corporation Commission potential of 3000 barrels. This potential allows 70 barrels per day for the remainder of November, 1943.

PLUGGING
 NOV 23 1943
 15-100-02714-0000

(See Reverse for Record of Formation)

SLOPE TEST DATA

<u>DEPTH</u>	<u>ANGLE OF DEFLECTION</u>	<u>HORIZ.</u>	<u>VERT.</u>
250'	0 Degrees		
500'	0 "		
750'	0 "		
1000'	0 "		
1250'	0 "		
1500'	0 "		
1750'	1/2 "	2.2	
2000'	1/2 "	2.2	
2250'	1/2 "	2.2	
2500'	1/2 "	2.2	
2750'	0 "		
3000'	0 "		
3250'	0 "		
3500'	1 "	4.4	.1
3750'	1/2 "	2.2	
4000'	1/2 "	2.2	
Total Deflection		17.6'	.1'

Vertical Curvature
MADISONVILLE

MISSOURI
CONSERVATION DIVISION
MAY 27 1939
STATE GEOLOGICAL SURVEY

PLUGGING
FILE SEC 34 25 4W
BOOK PAGE 52 LINE 29