

FOR KCC USE:

EFFECTIVE DATE:

DISTRICT # 2

SEAT... Yes ☒ No

State of Kansas

NOTICE OF INTENTION TO DRILL

FORM C-1 7/91

FORM MUST BE TYPED

FORM MUST BE SIGNED

ALL BLANKS MUST BE FILLED

Must be approved by the K.C.C. five (5) days prior to commencing well

Expected Spud Date November 10, 1992  
month day year

Spot SE NE NW Sec 26 Twp 25 S. Rg 4 East ☒ West

OPERATOR: License # 30217  
Name: Robba Exploration, Inc.  
Address: 230 N. Market  
City/State/Zip: Wichita, Kansas 67202  
Contact Person: Richard A. Robba  
Phone: (316) 264-6653

990' feet from: North line of Section  
2310' feet from: West line of Section  
IS SECTION ☒ REGULAR ☐ IRREGULAR?

(NOTE: Locate well on the Section Plat on Reverse Side)

County: RENO  
Lease Name: Barlow Well #: 1-26  
Field Name: Wildcat

CONTRACTOR: License #: 5418  
Name: Allen Drilling Co.

Is this a Prorated/Spaced Field? yes ☒ no  
Target Formation(s): Viola  
Nearest lease or unit boundary: 990'  
Ground Surface Elevation: 1513 feet MSL  
Water well within one-quarter mile: yes ☒ no  
Public water supply well within one mile: yes ☒ no  
Depth to bottom of fresh water: 100'  
Depth to bottom of usable water: 120' / 150'  
Surface Pipe by Alternate: X 1 2  
Length of Surface Pipe Planned to be set: 175'  
Length of Conductor pipe required: none  
Projected Total Depth: 4100'  
Formation at Total Depth: Viola  
Water Source for Drilling Operations:

Well Drilled For: Well Class: Type Equipment:  
☒ Oil ... Enh Rec ... Infield ☒ Mud Rotary  
... Gas ... Storage ... Pool Ext. ... Air Rotary  
... DWMO ... Disposal ☒ Wildcat ... Cable  
... Seismic; ... # of Holes ... Other  
... Other

If DWMO: old well information as follows:  
Operator: NA  
Well Name: NA  
Comp. Date: NA Old Total Depth

Directional, Deviated or Horizontal wellbore? yes ☒ no  
If yes, true vertical depth: NA  
Bottom Hole Location: NA

... well ... farm pond ☒ other  
DWR Permit #: to be provided by contractor  
Will Cores Be Taken? yes ☒ no  
If yes, proposed zone: NA

AFFIDAVIT

The undersigned hereby affirms that the drilling, completion and eventual plugging of this well will comply with K.S.A. 55-101, et. seq.

It is agreed that the following minimum requirements will be met:

1. Notify the appropriate district office prior to spudding of well;
2. A copy of the approved notice of intent to drill shall be posted on each drilling rig;
3. The minimum amount of surface pipe as specified below shall be set by circulating cement to the top; in all cases surface pipe shall be set through all unconsolidated materials plus a minimum of 20 feet into the underlying formation;
4. If the well is dry hole, an agreement between the operator and the district office on plug length and placement is necessary prior to plugging;
5. The appropriate district office will be notified before well is either plugged or production casing is cemented in;
6. IF AN ALTERNATE IS COMPLETION, PRODUCTION PIPE SHALL BE CEMENTED FROM BELOW ANY USABLE WATER TO SURFACE WITHIN 120 DAYS OF SPUD DATE. IN ALL CASES, NOTIFY DISTRICT OFFICE PRIOR TO ANY CEMENTING.

I hereby certify that the statements made herein are true and to the best of my knowledge and belief.

Date: Nov. 1, 1992 Signature of Operator or Agent: Richard A. Robba Title: geologist

FOR KCC USE:  
API # 15- 155-21,226-0000  
Conductor pipe required None feet  
Minimum surface pipe required 170' feet per Alt. ☒  
Approved by: CB 11-3-92  
This authorization expires: 5-3-93  
(This authorization void if drilling not started within 6 months of effective date.)  
Spud date: \_\_\_\_\_ Agent: \_\_\_\_\_

REMEMBER TO:

- File Drill Pit Application (form CDP-1) with Intent to Drill;
- File Completion Form ACD-1 within 120 days of spud date;
- File acreage attribution plat according to field proration orders;
- Notify appropriate district office 48 hours prior to workover or re-entry;
- Submit plugging report (CP-4) after plugging is completed;
- Obtain written approval before disposing or injecting salt water.

Mail to: Conservation Division, 200 Colorado Derby Building, 202 W. First St., Wichita, Kansas 67202-1286.

RECEIVED  
STATE CORPORATION COMMISSION

NOV 3 1992

11-3-92

WICHITA, KANSAS

IN ALL CASES PLOT THE INTENDED WELL ON THE PLAT BELOW

PLAT OF ACREAGE ATTRIBUTABLE TO A WELL IN A PRORATED OR SPACED FIELD

If the intended well is in a prorated or spaced field, please fully complete this side of the form. If the intended well is in a prorated or spaced field complete the plat below showing that the well will be properly located in relationship to other wells producing from the common source of supply. Please show all the wells within 1 mile of the boundaries of the proposed acreage attribution unit for gas wells and within 1/2 mile of the boundaries of the proposed acreage attribution unit for oil wells.

API NO. 15- \_\_\_\_\_  
OPERATOR \_\_\_\_\_  
LEASE \_\_\_\_\_  
WELL NUMBER \_\_\_\_\_  
FIELD \_\_\_\_\_

LOCATION OF WELL: COUNTY \_\_\_\_\_  
\_\_\_\_\_ feet from south/north line of section  
\_\_\_\_\_ feet from east/west line of section  
SECTION \_\_\_\_\_ TWP \_\_\_\_\_ RG \_\_\_\_\_

NUMBER OF ACRES ATTRIBUTABLE TO WELL \_\_\_\_\_  
QTR/QTR/QTR OF ACREAGE \_\_\_\_\_

IS SECTION \_\_\_\_\_ REGULAR or \_\_\_\_\_ IRREGULAR  
IF SECTION IS IRREGULAR, LOCATE WELL FROM NEAREST CORNER BOUNDARY.

Section corner used: \_\_\_\_\_ NE \_\_\_\_\_ NW \_\_\_\_\_ SE \_\_\_\_\_ SW

PLAT

(Show location of the well and shade attributable acreage for prorated or spaced wells.)  
(Show footage to the nearest lease or unit boundary line.)

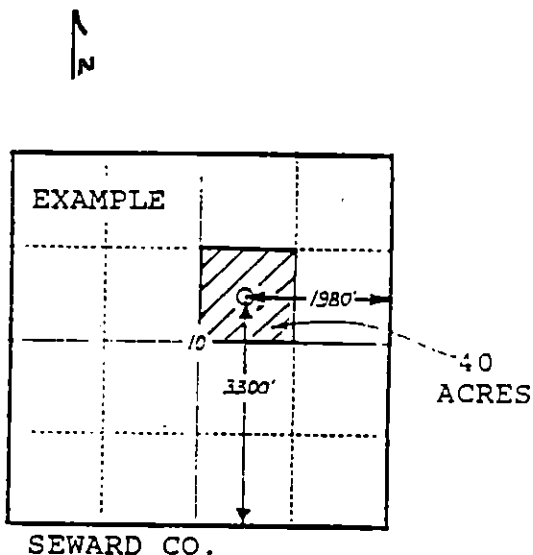
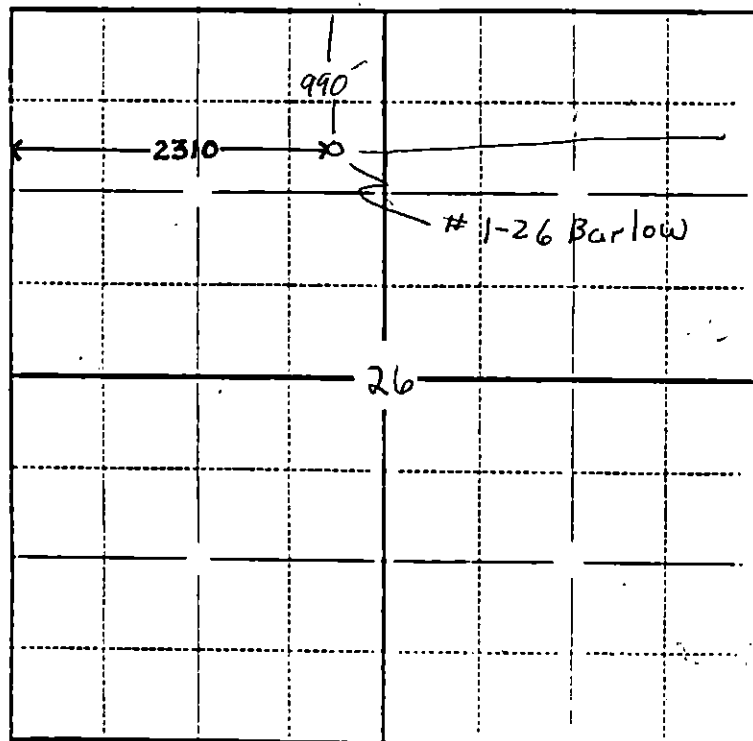

In plotting the proposed location of the well, you must show:

- 1) The manner in which you are using the depicted plat by identifying section lines, i.e. 1 section, 1 section with 8 surrounding sections, 4 sections, etc.;
- 2) the distance of the proposed drilling location from the section's south/north and east/west lines; and
- 3) the distance to the nearest lease or unit boundary line.