

EFFECTIVE DATE: 7-5-93

DISTRICT # 2

SEAT: X Yes No

State of Kansas

NOTICE OF INTENTION TO DRILL

ALL BLANKS MUST BE FILLED

Must be approved by the K.C.C. five (5) days prior to commencing well

Expected Spud Date July 1, 1993 month day year

Spot SW 1/4 - NW 1/4 - SE 1/4 Sec 3 Twp 25 S, Rg 8 East West

OPERATOR: License # 6044/9855 Name: Stelbar Oil Corp., Inc./Grand Mesa Oper. Co. Address: 155 North Market, Suite #500 Wichita, Kansas 67202 Contact Person: Roscoe L. Mendenhall Phone: 316/264-8378

1772 feet from South / West line of Section 2270 feet from East / West line of Section IS SECTION REGULAR X IRREGULAR?

(NOTE: Locate well on the Section Plat on Reverse Side)

County: Reno Lease Name: Trembley Well #: 2-3 Field Name: Unknown

CONTRACTOR: License #: 5142 Name: Sterling Drilling Company

Is this a Prorated/Spaced Field? yes X no Target Formation(s): Mississippi

Nearest Lease or unit boundary: 330 ft. Ground Surface Elevation: 1614 feet MSL

Well Drilled For: Well Class: Type Equipment: X Oil Enh Rec X Infield X Mud Rotary Gas Storage Pool Ext. Air Rotary OWD Disposal Wildcat Cable Seismic # of Holes Other

Water well within one-quarter mile: yes X no Public water supply well within one mile: yes X no

Depth to bottom of fresh water: 75 ft. 90 Depth to bottom of usable water: 140 ft.

Surface Pipe by Alternate: X 1 2 Length of Surface Pipe Planned to be set: (200 ft) 110

Length of Conductor pipe required: N/A Projected Total Depth: 4100 ft.

Formation at Total Depth: Arbuckle Water Source for Drilling Operations: X well farm pond other

If OWD: old well information as follows: Operator: Well Name: Comp. Date: Old Total Depth

DWR Permit #: Applied for Will Cores Be Taken?: yes X no

Directional, Deviated or Horizontal wellbore? yes X no If yes, true vertical depth: Bottom Hole Location:

If yes, proposed zone:

AFFIDAVIT

The undersigned hereby affirms that the drilling, completion and eventual plugging of this well will comply with K.S.A. 55-101, et. seq.

It is agreed that the following minimum requirements will be met:

- 1. Notify the appropriate district office prior to spudding of well; 2. A copy of the approved notice of intent to drill shall be posted on each drilling rig; 3. The minimum amount of surface pipe as specified below shall be set by circulating cement to the top; in all cases surface pipe shall be set through all unconsolidated materials plus a minimum of 20 feet into the underlying formation; 4. If the well is dry hole, an agreement between the operator and the district office on plug length and placement is necessary prior to plugging; 5. The appropriate district office will be notified before well is either plugged or production casing is cemented in; 6. IF AN ALTERNATE IS COMPLETION, PRODUCTION PIPE SHALL BE CEMENTED FROM BELOW ANY USABLE WATER TO SURFACE WITHIN 120 DAYS OF SPUD DATE. IN ALL CASES, NOTIFY DISTRICT OFFICE PRIOR TO ANY CEMENTING.

I hereby certify that the statements made herein are true and to the best of my knowledge and belief.

Date: June 28, 1993. Signature of Operator or Agent: Roscoe L. Mendenhall Title: Petroleum Engineer

6-28-93

CONSERVATION DIVISION WICHITA, KS

JUN 28 1993

RECEIVED KANSAS CORPORATION COMMISSION

FOR KCC USE: API # 15- 155-21268-0000 Conductor pipe required None feet Minimum surface pipe required 110 feet per Alt. (X) Approved by: C.B. 6-30-93 This authorization expires: 12-30-93 (This authorization void if drilling not started within 6 months of effective date.) Spud date: Agent:

REMEMBER TO:

- File Drill Pit Application (form CDP-1) with Intent to Drill; File Completion Form ACO-1 within 120 days of spud date; File acreage attribution plat according to field proration orders; Notify appropriate district office 48 hours prior to workover or re-entry; Submit plugging report (CP-4) after plugging is completed; Obtain written approval before disposing or injecting salt water.

Mail to: Conservation Division, 200 Colorado Derby Building, 202 W. First St., Wichita, Kansas 67202-1286.

3 25 8

IN ALL CASES PLOT THE INTENDED WELL ON THE PLAT BELOW
PLAT OF ACREAGE ATTRIBUTABLE TO A WELL IN A PRORATED OR SPACED FIELD

If the intended well is in a prorated or spaced field, please fully complete this side of the form. If the intended well is in a prorated or spaced field complete the plat below showing that the well will be properly located in relationship to other wells producing from the common source of supply. Please show all the wells within 1 mile of the boundaries of the proposed acreage attribution unit for gas wells and within 1/2 mile of the boundaries of the proposed acreage attribution unit for oil wells.

API NO. 15- _____
 OPERATOR Stelbar Oil Corp., Inc./Grand Mesa
 LEASE Trembley Oper. Co. _____
 WELL NUMBER 2-3
 FIELD Unknown

LOCATION OF WELL: COUNTY Reno
1772 feet from south/~~north~~ line of section
2270 feet from east/~~west~~ line of section
 SECTION 3 TWP 25 South RG 8 West

NUMBER OF ACRES ATTRIBUTABLE TO WELL 10
 QTR/QTR/QTR OF ACREAGE SW₄ - NW₄ - SE₄

IS SECTION _____ REGULAR or X IRREGULAR
 IF SECTION IS IRREGULAR, LOCATE WELL FROM NEAREST CORNER BOUNDARY.

Section corner used: _____ NE _____ NW X SE _____ SW

PLAT

(Show location of the well and shade attributable acreage for prorated or spaced wells.)
 (Show footage to the nearest lease or unit boundary line.)

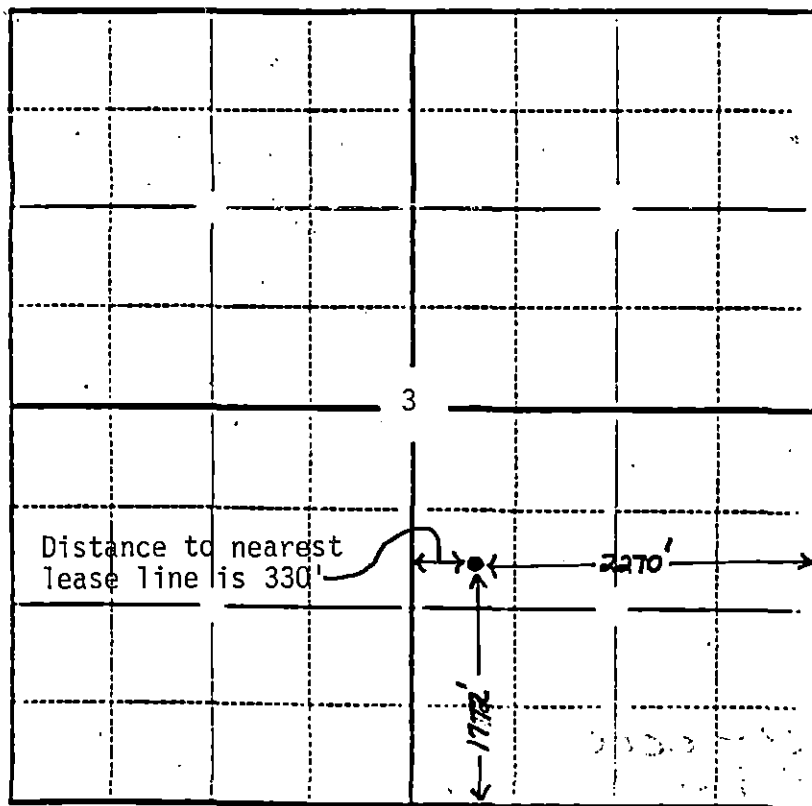

Section 3-T25S-R8W, Reno County, Kansas

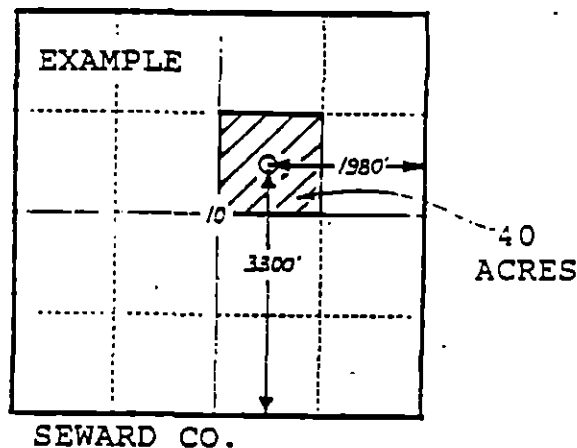

In plotting the proposed location of the well, you must show:

- 1) The manner in which you are using the depicted plat by identifying section lines, i.e. 1 section, 1 section with 8 surrounding sections, 4 sections, etc.;
- 2) the distance of the proposed drilling location from the section's south/north and east/west lines; and
- 3) the distance to the nearest lease or unit boundary line.