

FOR KCC USE:

FORM C-1 7/91

FORM MUST BE TYPED

FORM MUST BE SIGNED

ALL BLANKS MUST BE FILLED

EFFECTIVE DATE: 8-31-92  
DISTRICT # 2  
SGA?  Yes,  No

State of Kansas  
NOTICE OF INTENTION TO DRILL

Must be approved by the K.C.C. five (5) days prior to commencing well

Expected Spud Date August 28, 1992  
month day year

Spot SW - SW 1/4 - NE 1/4 Sec 10 Twp 25 S, Rg 8 East  West

OPERATOR: License # #6044/#9855  
Name: Stelbar Oil Corp., Inc./Grand Mesa Oper. Co.  
Address: 155 North Market, Suite #500  
City/State/Zip: Wichita, Kansas 67202  
Contact Person: Roscoe L. Mendenhall  
Phone: (316) 264-8378

3240 feet from South / ~~XXXX~~ Line of Section  
2020 feet from East / ~~XXXX~~ Line of Section  
IS SECTION  REGULAR  IRREGULAR?

CONTRACTOR: License # #03779  
Name: Norseman Drilling, Inc.

(NOTE: Locate well on the Section Plat on Reverse Side)  
County: Reno  
Lease Name: Call Well #: 1-10  
Field Name: Arlington Township South Wildcat

Well Drilled For: Well Class: Type Equipment:  
 Oil ... Enh Rec  Infield  Mud Rotary  
... Gas ... Storage ... Pool Ext. ... Air Rotary  
... OWMO ... Disposal ... Wildcat ... Cable  
... Seismic; ... # of Holes ... Other  
If OWMO: old well information as follows:  
Operator: \_\_\_\_\_  
Well Name: \_\_\_\_\_  
Comp. Date: \_\_\_\_\_ Old Total Depth \_\_\_\_\_

Is this a Prorated/Spaced Field? ... yes  no  
Target Formation(s): Mississippian  
Nearest lease or unit boundary: 410'  
Ground Surface Elevation: Not yet available feet MSL  
Water well within one-quarter mile:  yes  no  
Public water supply well within one mile:  yes  no  
Depth to bottom of fresh water: 100'  
Depth to bottom of usable water: 200'  
Surface Pipe by Alternate:  1  2  
Length of Surface Pipe Planned to be set: 240'  
Length of Conductor pipe required: -0-  
Projected Total Depth: 4100'  
Formation at Total Depth: Mississippian  
Water Source for Drilling Operations:  
 well  farm pond  other

Directional, Deviated or Horizontal wellbore? ... yes  no   
If yes, true vertical depth: \_\_\_\_\_  
Bottom Hole Location: \_\_\_\_\_

DWR Permit #: \_\_\_\_\_  
Will Cores Be Taken?: ... yes  no  
If yes, proposed zone: \_\_\_\_\_

AFFIDAVIT

The undersigned hereby affirms that the drilling, completion and eventual plugging of this well will comply with K.S.A. 55-101, et. seq.  
It is agreed that the following minimum requirements will be met:

1. Notify the appropriate district office prior to spudding of well;
2. A copy of the approved notice of intent to drill shall be posted on each drilling rig;
3. The minimum amount of surface pipe as specified below shall be set by circulating cement to the top; in all cases surface pipe shall be set through all unconsolidated materials plus a minimum of 20 feet into the underlying formation;
4. If the well is dry hole, an agreement between the operator and the district office on plug length and placement is necessary prior to plugging;
5. The appropriate district office will be notified before well is either plugged or production casing is cemented in;
6. IF AN ALTERNATE II COMPLETION, PRODUCTION PIPE SHALL BE CEMENTED FROM BELOW ANY USABLE WATER TO SURFACE WITHIN 120 DAYS OF SPUD DATE. IN ALL CASES, NOTIFY DISTRICT OFFICE PRIOR TO ANY CEMENTING.

I hereby certify that the statements made herein are true and to the best of my knowledge and belief.  
Date: August 25, 1992 Signature of Operator or Agent: Roscoe L. Mendenhall Title: Petroleum Engineer

FOR KCC USE:  
API # 15- 155-21213-0000  
Conductor pipe required None feet  
Minimum surface pipe required 240 feet per Alt.   
Approved by: CB 8-26-92  
This authorization expires: 2-26-92  
(This authorization void if drilling not started within 6 months of effective date.)  
Spud date: \_\_\_\_\_ Agent: \_\_\_\_\_

8-25-92  
KANSAS CORPORATION COMMISSION  
**RECEIVED**  
10 25 8  
AUG 25 1992  
CONSERVATION DIVISION  
WICHITA, KS

REMEMBER TO:

- File Drill Pit Application (form CDP-1) with Intent to Drill;
- File Completion Form ACO-1 within 120 days of spud date;
- File acreage attribution plat according to field proration orders;
- Notify appropriate district office 48 hours prior to workover or re-entry;
- Submit plugging report (CP-4) after plugging is completed;
- Obtain written approval before disposing or injecting salt water.

Mail to: Conservation Division, 200 Colorado Derby Building, 202 W. First St., Wichita, Kansas 67202-1286.

**IN ALL CASES PLOT THE INTENDED WELL ON THE PLAT BELOW**

**PLAT OF ACREAGE ATTRIBUTABLE TO A WELL IN A PRORATED OR SPACED FIELD**

If the intended well is in a prorated or spaced field, please fully complete this side of the form. If the intended well is in a prorated or spaced field complete the plat below showing that the well will be properly located in relationship to other wells producing from the common source of supply. Please show all the wells within 1 mile of the boundaries of the proposed acreage attribution unit for gas wells and within 1/2 mile of the boundaries of the proposed acreage attribution unit for oil wells.

API NO. 15- \_\_\_\_\_  
 OPERATOR Stelbar Oil Corp., Inc./Grand Mesa LOCATION OF WELL: COUNTY Reno  
 LEASE Call Operating Co. 3240 feet from south/~~north~~ line of section  
 WELL NUMBER #1-10 2020 feet from east/~~west~~ line of section  
 FIELD Arlington Township South SECTION 10 TWP 25 South RG 8 West

NUMBER OF ACRES ATTRIBUTABLE TO WELL 40 IS SECTION \_\_\_\_\_ REGULAR or X IRREGULAR  
 QTR/QTR/QTR OF ACREAGE C - SW $\frac{1}{4}$  - NE $\frac{1}{4}$  **IF SECTION IS IRREGULAR, LOCATE WELL FROM NEAREST CORNER BOUNDARY.**

Section corner used: NE NW X SE SW

**PLAT**

(Show location of the well and shade attributable acreage for prorated or spaced wells.)  
 (Show footage to the nearest lease or unit boundary line.)

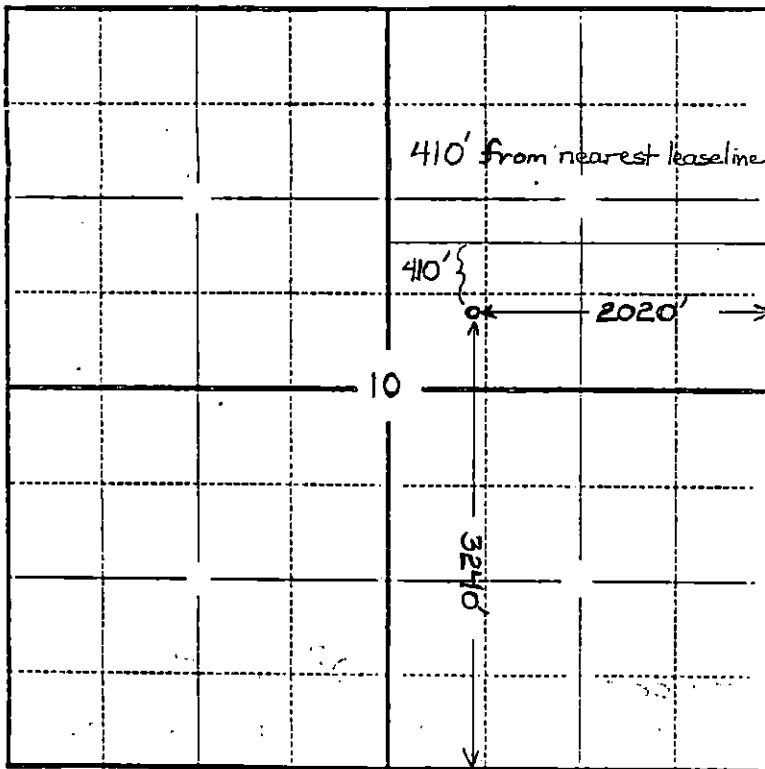

Section 10-T25S-R8W, Reno County, Kansas

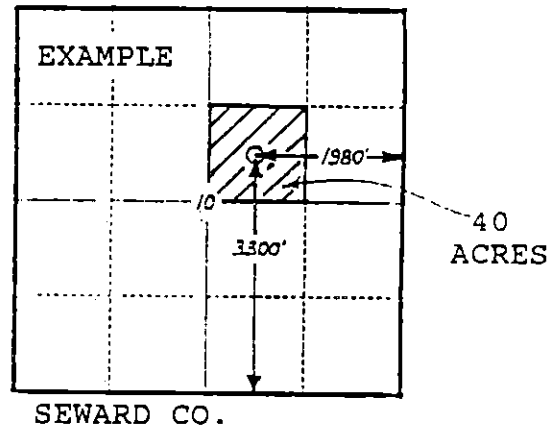

**In plotting the proposed location of the well, you must show:**

- 1) The manner in which you are using the depicted plat by identifying section lines, i.e. 1 section, 1 section with 8 surrounding sections, 4 sections, etc.;
- 2) the distance of the proposed drilling location from the section's south/north and east/west lines; and
- 3) the distance to the nearest lease or unit boundary line.