

FOR KCC USE:

EFFECTIVE DATE: 2-3-92

DISTRICT # 2

SGA? Yes No

"ONWO" ✓

FORM C-1 7/91

FORM MUST BE TYPED

FORM MUST BE SIGNED

ALL BLANKS MUST BE FILLED

State of Kansas
NOTICE OF INTENTION TO DRILL

Must be approved by the K.C.C. five (5) days prior to commencing well

Expected Spud Date January 29 1992 Spot SE 1/4 NW 1/4 East X West X
month day year Sec 10 Twp 25 S. Rg 8

OPERATOR: License # #6044 / #9855
Name: Stelbar Oil Corp., Inc. / Grand Mesa Operating Co.
Address: 155 N. Market, Suite #500
City/State/Zip: Wichita, Kansas 67202
Contact Person: Roscoe Mendenhall
Phone: 316/264-8378

1985 feet from ~~South~~ / North line of Section
1955 feet from ~~East~~ / West line of Section

IS SECTION REGULAR IRREGULAR? (NOTE: Locate well on the Section Plat on Reverse Side)

County: Reno

Lease Name: Cadice Well #: 1

Field Name: Undesignated

Is this a Prorated/Spaced Field? yes no

Target Formation(s): Mississippi

Nearest lease or unit boundary: 635'

Ground Surface Elevation: 1612 feet MSL

Water well within one-quarter mile: yes no

Public water supply well within one mile: yes no

Depth to bottom of fresh water: 7.5'

Depth to bottom of usable water: 200' 140'

Surface Pipe by Alternate: 1 2

Length of Surface Pipe 261' set: 261'

Length of Conductor pipe required: 0

Projected Total Depth: 4100'

Formation at Total Depth: Arbuckle

Water Source for Drilling Operations:

well farm pond other

DWR Permit #: _____

Will Cores Be Taken?: yes no

If yes, proposed zone: _____

CONTRACTOR: License #: 5929
Name: Duke Drilling Company, Inc.

Well Drilled For:	Well Class:	Type Equipment:
<input checked="" type="checkbox"/> Oil	<input type="checkbox"/> Enh Rec	<input checked="" type="checkbox"/> Infield
<input type="checkbox"/> Gas	<input type="checkbox"/> Storage	<input type="checkbox"/> Pool Ext.
<input checked="" type="checkbox"/> ONWO	<input type="checkbox"/> Disposal	<input type="checkbox"/> Air Rotary
<input type="checkbox"/> Seismic;	<input type="checkbox"/> # of Holes	<input type="checkbox"/> Wildcat
<input type="checkbox"/> Other	<input type="checkbox"/> Other	<input type="checkbox"/> Cable

If ONWO: old well information as follows:
Operator: Albert J. Gebart-Byron E. Hummon, Jr.
Well Name: Kuhns #1
Comp. Date: Not Compl. Old Total Depth 4175'

Directional, Deviated or Horizontal wellbore? yes no

If yes, true vertical depth: _____

Bottom Hole Location: _____

AFFIDAVIT

The undersigned hereby affirms that the drilling, completion and eventual plugging of this well will comply with K.S.A. 55-101, et. seq.

It is agreed that the following minimum requirements will be met:

1. Notify the appropriate district office prior to spudding of well;
2. A copy of the approved notice of intent to drill shall be posted on each drilling rig;
3. The minimum amount of surface pipe as specified below shall be set by circulating cement to the top; in all cases surface pipe shall be set through all unconsolidated materials plus a minimum of 20 feet into the underlying formation;
4. If the well is dry hole, an agreement between the operator and the district office on plug length and placement is necessary prior to plugging;
5. The appropriate district office will be notified before well is either plugged or production casing is cemented in;
6. IF AN ALTERNATE II COMPLETION, PRODUCTION PIPE SHALL BE CEMENTED FROM BELOW ANY USABLE WATER TO SURFACE WITHIN 120 DAYS OF SPUD DATE. IN ALL CASES, NOTIFY DISTRICT OFFICE PRIOR TO ANY CEMENTING.

I hereby certify that the statements made herein are true and to the best of my knowledge and belief.

Date: Jan. 28, 1992 Signature of Operator or Agent: Roscoe Mendenhall Title: Petroleum Engineer

FOR KCC USE:
 API # 15- 155-01,013-0002
 Conductor pipe required: None feet
 Minimum surface pipe required: 160 feet per Alt. ①
 Approved by: mm 1-29-92
 This authorization expires: 7-29-92
 (This authorization void if drilling not started within 6 months of effective date.)
 Spud date: _____ Agent: _____

REMEMBER TO:

- File Drill Pit Application (form CDP-1) with Intent to Drill;
- File Completion Form ACO-1 within 120 days of spud date;
- File acreage attribution plat according to field proration orders;
- Notify appropriate district office 48 hours prior to workover or re-entry;
- Submit plugging report (CP-4) after plugging is completed;
- Obtain written approval before disposing or injecting salt water.

Nail to: Conservation Division, 200 Colorado Derby Building, 202 W. First St., Wichita, Kansas 67202-1286.

RECEIVED
KANSAS CORPORATION COMMISSION
JAN 28 1992
CONSERVATION DIVISION
WICHITA, KS

1-28-92

10
25
800

IN ALL CASES PLOT THE INTENDED WELL ON THE PLAT BELOW

PLAT OF ACREAGE ATTRIBUTABLE TO A WELL IN A PRORATED OR SPACED FIELD

If the intended well is in a prorated or spaced field, please fully complete this side of the form. If the intended well is in a prorated or spaced field complete the plat below showing that the well will be properly located in relationship to other wells producing from the common source of supply. Please show all the wells within 1 mile of the boundaries of the proposed acreage attribution unit for gas wells and within 1/2 mile of the boundaries of the proposed acreage attribution unit for oil wells.

API NO. 15- _____
 OPERATOR Stelbar Oil Corp., Inc. / Grand Mesa LOCATION OF WELL: COUNTY Reno
 LEASE Cadice Operating Co. 1985 feet from ~~south~~/north line of section
 WELL NUMBER #1 1955 feet from ~~east~~/west line of section
 FIELD Undesignated SECTION 10 TWP 25 South RG 8 West

NUMBER OF ACRES ATTRIBUTABLE TO WELL 20 IS SECTION _____ REGULAR or x IRREGULAR
 QTR/QTR/QTR OF ACREAGE SE 1/4 - NW 1/4 IF SECTION IS IRREGULAR, LOCATE WELL FROM NEAREST CORNER BOUNDARY.

Section corner used: _____ NE x NW _____ SE _____ SW

PLAT

(Show location of the well and shade attributable acreage for prorated or spaced wells.)
 (Show footage to the nearest lease or unit boundary line.)

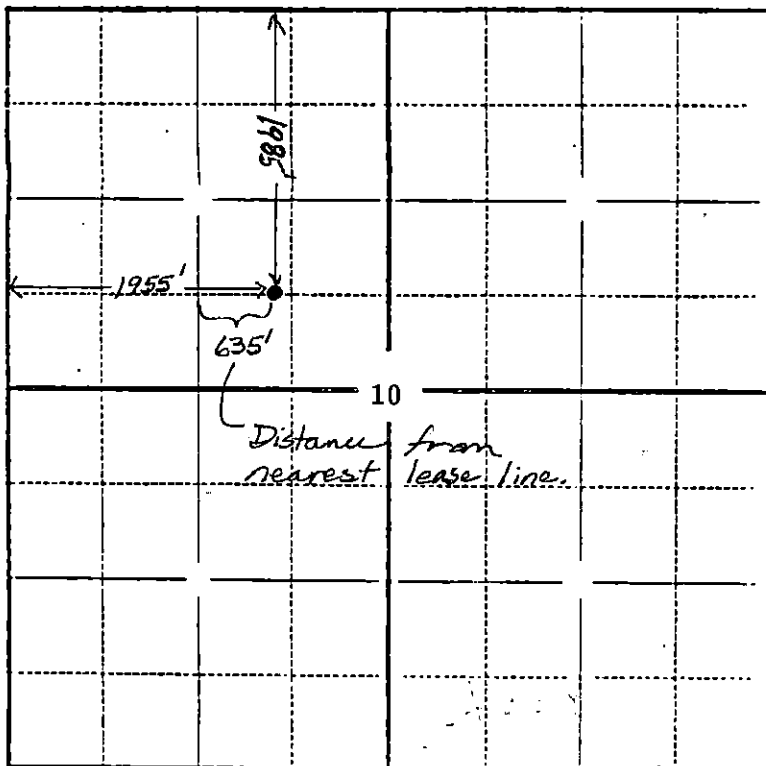

Section 10-T25S-R8W, Reno Co.

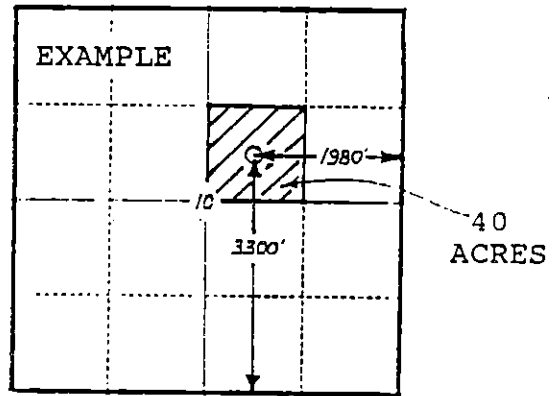

In plotting the proposed location of the well, you must show:

- 1) The manner in which you are using the depicted plat by identifying section lines, i.e. 1 section, 1 section with 8 surrounding sections, 4 sections, etc.;
- 2) the distance of the proposed drilling location from the section's south/north and east/west lines; and
- 3) the distance to the nearest lease or unit boundary line.