

STATE OF KANSAS
STATE CORPORATION COMMISSION

WELL PLUGGING RECORD

Give All Information Completely
Make Required Affidavit
Mail or Deliver Report to
Conservation Division
State Corporation Comm.
245 North Water
Wichita, KS 67202

Hamilton County, Sec. 14 Twp. 24 Rge. 41W E/W
Location as "NE/CNW $\frac{1}{4}$ SW $\frac{1}{4}$ " or footage from lines
App/C/NW

Lease Owner Ladd Petroleum Corporation
Lease Name HCU Well No. 1441

Office Address Box 520, Great Bend, KS 67530

Character of Well (Completed as Oil, Gas or Dry Hole)
Oil

Date Well completed 19

Application for plugging filed 19

Application for plugging approved 19

Plugging commenced October 27 1980

Plugging completed October 29 1980

Reason for abandonment of well or producing formation
Depleted

If a producing well is abandoned, date of last production
19

Was permission obtained from the Conservation Division or
its agents before plugging was commenced? Yes

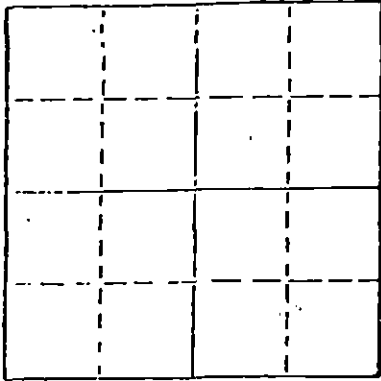

Locate well correctly on above
Section Plat

Name of Conservation Agent who supervised plugging of this well Clarence Thomas, Jr.
Producing formation _____ Depth to top _____ Bottom _____ Total Depth of Well 2339'
Show depth and thickness of all water, oil and gas formations.

OIL, GAS OR WATER RECORDS

CASING RECORD

FORMATION	CONTENT	FROM	TO	SIZE	PUT IN	PULLED OUT
				7"	157'	None
				4 1/2"	2320'	128.82'

Describe in detail the manner in which the well was plugged, indicating where the mud fluid was placed and the method or methods used in introducing it into the hold. If cement or other plugs were used, state the character of same and depth placed, from _____ feet to _____ feet for each plug set.

Dumped sand to 2290' and 4 sacks cement.

Shot pipe at 300', 220' and 140', pulled 5 joints 4 1/2" casing.

Halliburton plugged well with 25 sacks cement at 140' and 10 sacks cement from 40' to surface.

(If additional description is necessary, use BACK of this sheet)

Name of Plugging Contractor Rockhold Engineering, Inc.

STATE OF Kansas COUNTY OF Barton, ss.
James W. Rockhold (employee of owner) or (owner or operator)
of the above-described well, being first duly sworn on oath, says: That I have knowledge of the facts, statements, and matters herein contained and the log of the above-described well as filed and that the same are true and correct. So help me God.

(Signature)

James W. Rockhold
James W. Rockhold, Box 698, Great Bend,
_____ (Address) Ks. 67530

SUBSCRIBED AND SWORN TO before me this 3rd day of December, 1980

Ruth L. Sloan Notary Public.

My commission expires September 27, 1981

RECEIVED
STATE CORPORATION COMMISSION

12-5-80

DEC - 5 1980

CONSERVATION DIVISION
Wichita, Kansas

15-075-10087-0000

FEDERAL LEASE

KANSAS DRILLERS LOG

S. 14 T. 24 R. 41 **(W)**

API No. 15 _____
County _____ Number _____

Loc. C NW/4

County Hamilton

Operator
Ladd Petroleum Corporation

Address
830 Denver Club Bldg., Denver, CO 80202

Well No. 1441 Lease Name HCU

Footage Location
1400 feet from **(N)** (S) line 1320 feet from **(E)** **(W)** line

Principal Contractor Geologist
Wakefield

Spud Date Total Depth P.B.T.D.
11/24/61 2320

Date Completed Oil Purchaser
11/30/61

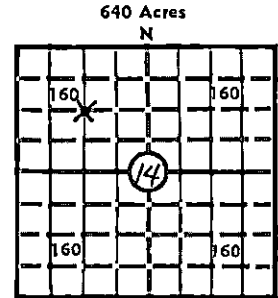

Elev.: Gr. 3269'

DF _____ KB _____

CASING RECORD

Report of all strings set— surface, intermediate, production, etc.

Purpose of string	Size hole drilled	Size casing set (in O.D.)	Weight lbs/ft.	Setting depth	Type cement	Sacks	Type and percent additives
surface	9-7/8"	7-5/8"	24	227	common	325	3% HA-5
production	6-3/4"	4 1/2"	9.5	2320	common	260	16% gel, .2% HR-7, 3% salt

LINER RECORD

PERFORATION RECORD

Top, ft.	Bottom, ft.	Sacks cement	Shots per ft.	Size & type	Depth interval
					2324-2330'

TUBING RECORD

Size	Setting depth	Packer set at
1 1/4"	2279'	---

ACID, FRACTURE, SHOT, CEMENT SQUEEZE RECORD

Amount and kind of material used	Depth interval treated
RECEIVED STATE CORPORATION COMMISSION	
SEP 29 1980	
CONSERVATION DIVISION Wichita, Kansas	

INITIAL PRODUCTION

Date of first production 1/27/64	Producing method (flowing, pumping, gas lift, etc.) gas lift
RATE OF PRODUCTION PER 24 HOURS	Oil --- bbls. Gas 565 open flow MCF Water --- bbls. Gas-oil ratio --- CFPB
Disposition of gas (vented, used on lease or sold) sold	Producing interval (s) Winfield (2324-2330')

INSTRUCTIONS: As provided in KCC Rule 82-2-125, within 90 days after completion of a well, one completed copy of this Drillers Log shall be transmitted to the State Geological Survey of Kansas, 4150 Monroe Street, Wichita, Kansas 67209. Copies of this form are available from the Conservation Division, State Corporation Commission, 3830 So. Meridian (P.O. Box 17027), Wichita, Kansas 66217. Phone AC 316-522-2206. If confidential custody is desired, please note Rule 82-2-125. Drillers Logs will be on open file in the Oil and Gas Division, State Geological Survey of Kansas, Lawrence, Kansas 66044.

DESIGNATE TYPE OF COMP.: OIL, GAS, DRY HOLE, SWDW, ETC.:

Operator

Ladd Petroleum Corporation

Well No.

1441

Lease Name

HCU

S 14 T 24 R 41 E (W)

WELL LOG

Show all important zones of porosity and contents thereof; cored intervals, and all drill-stem tests, including depth interval tested, cushion used, time tool open, flowing and shut-in pressures, and recoveries.

SHOW GEOLOGICAL MARKERS, LOGS RUN, OR OTHER DESCRIPTIVE INFORMATION.

FORMATION DESCRIPTION, CONTENTS, ETC.	TOP	BOTTOM	NAME	DEPTH
Winfield	2317	2339		

USE ADDITIONAL SHEETS, IF NECESSARY, TO COMPLETE WELL RECORD.

Date Received

Michael J. Wendling
Signature

Production Engineer
Title

9/24/80
Date