

STATE CORPORATION COMMISSION OF KANSAS
OIL & GAS CONSERVATION DIVISION
WELL COMPLETION OR RECOMPLETION FORM
ACO-1 WELL HISTORY
DESCRIPTION OF WELL AND LEASE

S

API NO. 15-155-21,092-0000
County Reno
CTR. SE SW Sec. 12 Twp 22S Rge. 8 East
X West

Operator: License # 5120
Name Range Oil Company, Inc.
Address 1120 KSB&T Building
125 N. Market
City/State/Zip Wichita, Kansas 67202

660 Ft North from Southeast Corner of Section
3300 Ft West from Southeast Corner of Section
(Note: Locate well in section plat below)

Purchaser None

Lease Name Cooper "A" Well # 1

Operator Contact Person John Washburn
Phone (316) 265-6231

Field Name Wildcat

Producing Formation NONE

Contractor: License # 5124
Name Range Drilling Co., Inc.

Elevation: Ground 1643 KB 1648

Wellsite Geologist Tim Lauer
Phone (316) 265-6231

Designate Type of Completion
XX New Well Re-Entry Workover
Oil SWD Temp Abd
Gas Inj Delayed Comp.
X Dry Other (Core, Water Supply etc.)

If ONWO: old well info as follows:
Operator
Well Name
Comp. Date Old Total Depth

CONFIDENTIAL

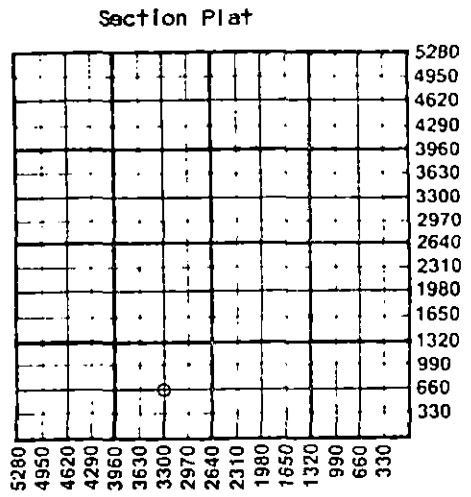

WELL HISTORY

Drilling Method:
X Mud Rotary Air Rotary Cable
12-15-86 12-21-86 1-8-87
M.I.R.T. Date Reached TD Completion Date to P&A A.S.A.P.
3622 NONE
Total Depth PSTD

Amount of Surface Pipe Set and Cemented at 258 feet
Multiple Stage Cementing Collar Used? Yes No
If yes, show depth set feet
If alternate 2 completion, cement circulated from feet depth to w/SX cmt
Cement Company Name
Invoice #

WATER SUPPLY INFORMATION
Disposition of Produced Water: Disposal
Docket # NA Repressuring

Questions on this portion of the ACO-1 call:
Water Resources Board (913) 296-3717
Source of Water:
Division of Water Resources Permit #
Groundwater Ft North from Southeast Corner (Well) Ft West from Southeast Corner of Sec Twp Rge East West
Surface Water Ft North from Southeast Corner (Stream, pond etc) Ft West from Southeast Corner Sec Twp Rge East West
Other (explain) (purchased from city, R.W.D. #)

INSTRUCTIONS: This form shall be completed in duplicate and filed with the Kansas Corporation Commission, 200 Colorado Derby Building, Wichita, Kansas 67202, within 90 days after completion or recompletion of any well. Rule 82-3-130 and 82-3-107 apply.
Information on side two of this form will be held confidential for a period of 12 months if requested in writing and submitted with the form. See rule 82-3-107 for confidentiality in excess of 12 months.
One copy of all wireline logs and drillers time log shall be attached with this form. Submit CP-4 form with all plugged wells. Submit CP-111 form with all temporarily abandoned wells.

All requirements of the statutes, rules and regulations promulgated to regulate the oil and gas industry have been fully complied with and the statements herein are complete and correct to the best of my knowledge.

Signature Harry G. McMahon, III
Title Geologist Date 1-19-87

Subscribed and sworn to before me this 19th day of January 1987
Notary Public Carmen Froelich

Date Commission Expires

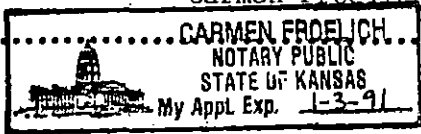

K.C.C. OFFICE USE ONLY
F Letter of Confidentiality Attached
C Wireline Log Received
C Drillers Time Log Received
Distribution
KCC SWD/Rep NGPA
KGS Plug Other
RECEIVED (Specify)
STATE CORPORATION COMMISSION
JAN 24 1987 1-22-87
Form ACO-1 (7-84)

Sec. 12, Twp. 22S, Rge. 8 East

Operator Name Range Oil Company, Inc. Lease Name Cooper "A" Well # 1

Sec. 12 Twp. 22S Rge. 8 East West County Reno

WELL LOG

INSTRUCTIONS: Show important tops and base of formations penetrated. Detail all cores. Report all drill stem tests giving interval tested, time tool open and closed, flowing and shut-in pressures, whether shut-in pressure reached static level, hydrostatic pressures, bottom hole temperature, fluid recovery, and flow rates if gas to surface during test. Attach extra sheet if more space is needed. Attach copy of log.

Drill Stem Tests Taken Yes No
 Samples Sent to Geological Survey Yes No
 Cores Taken Yes No

Formation Description Log Sample

		Name	Top	DATUM
DST (1) 3490-3527 30-30-60-60 Blow:wk Rec: 60' O&GCM (10% O) + 60' SOGCM (5% O) IFP 50-50 ISIP 240 FFP 60-75 FSIP 315		Hb	2843	-1195
		Dg Sh	2867	-1219
		Brn Ls	3017	-1369
		Lans	3036	-1388
DST (2) 3527-3537 30-30-60-60 GTS in 45 min. stab @ 2.92 MCF/GPD Rec: 120' WCGO (40% O, 40% G, 20% W - 115,000 ppm) + 150' SMCWCGO (40% O, 40% G, 20% W - 105,000 ppm) + 270' SW (110,000 ppm) IFP 75-115 ISIP 930 FFP 145-230 FSIP 880 T:118° F.		BKC	3408	-1760
		Mct	3522	-1874
		Kd	3604	-1956
		RTD	3622	-1974
		LTD	3621	-1973

CONFIDENTIAL

RELEASED

FFS 11 1988

FROM CONFIDENTIAL

CASING RECORD <input checked="" type="checkbox"/> New <input checked="" type="checkbox"/> Used Report all strings set-conductor, surface, intermediate, production, etc.							
Purpose of String	Size Hole Drilled	Size Casing Set (in O.D.)	Weight Lbs/Ft.	Setting Depth	Type of Cement	#Sacks Used	Type and Percent Additives
Surface	12.25	8.625 (new)	23	258	Common	175	3% CaCl
Production	7.825	4.5 (used)	9.5	3620	Common	75	Range Blend
PERFORATION RECORD				Acid, Fracture, Shot, Cement Squeeze Record			
Shots Per Foot	Specify Footage of Each Interval Perforated			(Amount and Kind of Material Used)		Depth	
2	3525-3533			200 Gal. 10% FE Acid		3525-3533	
TUBING RECORD							
Size	Set At	Packer at	Liner Run	<input type="checkbox"/> Yes <input checked="" type="checkbox"/> No			
Date of First Production	Producing Method <input type="checkbox"/> Flowing <input type="checkbox"/> Pumping <input type="checkbox"/> Gas Lift <input type="checkbox"/> Other (explain).....						
Estimated Production Per 24 Hours	Oil	Gas	Water	Gas-Oil Ratio	Gravity		
	Bbls	MCF	Bbls	CFPB			

METHOD OF COMPLETION

Production Interval

Disposition of gas: Vented Open Hole Perforation
 Sold Other (Specify)
 Used on Lease Dually Completed
 Commingled