

STATE CORPORATION COMMISSION OF KANSAS
OIL & GAS CONSERVATION DIVISION
WELL COMPLETION OR RECOMPLETION FORM
ACO-1 WELL HISTORY
DESCRIPTION OF WELL AND LEASE

API NO. 15-047-21,325-6000

County Edwards

C.NW.NW Sec.20 Twp.24 Rge.16W West

Operator: License # 5056
Name F.G. Holl Company
Address P.O. Box 781067
6427 E. Kellogg
City/State/Zip Wichita, Ks. 67278-0167

4620 Ft North from Southeast Corner of Section
4620 Ft West from Southeast Corner of Section
(Note: Locate well in section plat below)

Lease Name Brasfield Well #. 2-20.

Purchaser

Field Name

Producing Formation NA

Operator Contact Person Becky Norris
Phone (316) 684-8481

Elevation: Ground 2086 KB 2095

Contractor: License # 5142
Name Sterling Drilling Co.

Wellsite Geologist Bryce Bidleman
Phone (316) 684-8481

Designate Type of Completion
 New Well Re-Entry Workover
 Oil SWD Temp Abd
 Gas Inj Delayed Comp.
 Dry Other (Core, Water Supply etc.)

If ONWO: old well info as follows:
Operator
Well Name
Comp. Date Old Total Depth

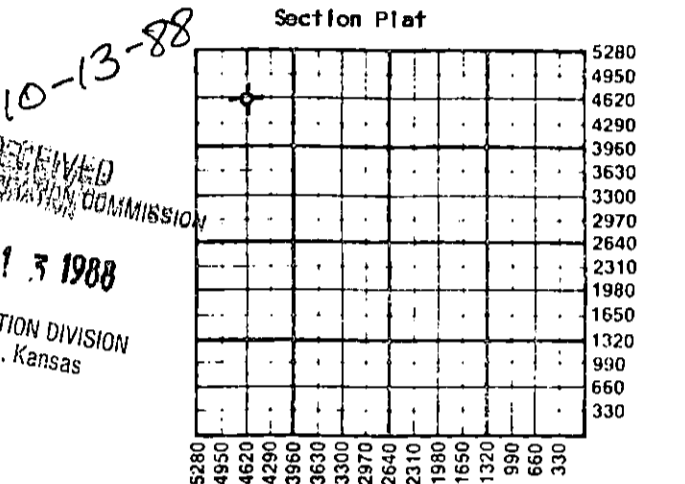

WATER SUPPLY INFORMATION
Disposition of Produced Water: Disposal
Docket # Repressuring

Questions on this portion of the ACO-1 call:
Water Resources Board (913) 296-3717
Source of Water:
Division of Water Resources Permit #
 Groundwater.....Ft North from Southeast Corner
(Well)Ft West from Southeast Corner of
Sec Twp Rge East West
 Surface Water.....Ft North from Southeast Corner
(Stream, pond etc).....Ft West from Southeast Corner
Sec Twp Rge East West
 Other (explain).....
(purchased from city, R.W.D. #)

WELL HISTORY

Drilling Method:
 Mud Rotary Air Rotary Cable
8-20-88 8-27-88 plugged 8-27-88
Spud Date Date Reached TD Completion Date
4433'
Total Depth PBD
Amount of Surface Pipe Set and Cemented at 307 feet
Multiple Stage Cementing Collar Used? Yes No
If yes, show depth set.....feet
If alternate 2 completion, cement circulated
from.....feet depth to.....w/.....SX cmt
Cement Company Name
Invoice #

RECEIVED
STATE CORPORATION COMMISSION
OCT 13 1988
CONSERVATION DIVISION
Wichita, Kansas

INSTRUCTIONS: This form shall be completed in triplicate and filed with the Kansas Corporation Commission, 200 Colorado Derby Building, Wichita, Kansas 67202, within 120 days of the spud date of any well. Rule 82-3-130, 82-3-107 and 82-3-106 apply. Information on side two of this form will be held confidential for a period of 12 months if requested in writing and submitted with the form. See rule 82-3-107 for confidentiality in excess of 12 months. One copy of all wireline logs and drillers time log shall be attached with this form. Submit CP-4 form with all plugged wells. Submit CP-111 form with all temporarily abandoned wells.

All requirements of the statutes, rules and regulations promulgated to regulate the oil and gas industry have been fully complied with and the statements herein are complete and correct to the best of my knowledge.

Signature Elwyn H. Nagel
Title Manager Date 10-11-88

Subscribed and sworn to before me this 12 day of October 1988.
Notary Public Mary D. Slagle
Date Commission Expires

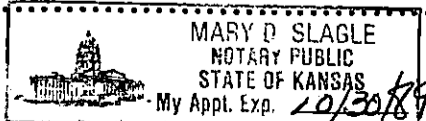

K.C.C. OFFICE USE ONLY
F Letter of Confidentiality Attached
C Wireline Log Received
C Drillers Timelog Received
Distribution
 KCC SWD/Rep NGPA
 KGS Plug Other
(Specify)
10-13-88
Form ACO-1 (5-86)

Sec 20 Twp 24 Rge 16 W

Operator Name F. G. Holl Company Lease Name Brasfield Well # 2-20

Sec. 20 Twp. 24 Rge. 16W East West County Edwards

WELL LOG

INSTRUCTIONS: Show important tops and base of formations penetrated. Detail all cores. Report all drill stem tests giving interval tested, time tool open and closed, flowing and shut-in pressures, whether shut-in pressure reached static level, hydrostatic pressures, bottom hole temperature, fluid recovery, and flow rates if gas to surface during test. Attach extra sheet if more space is needed. Attach copy of log.

Drill Stem Tests Taken Yes No
 Samples Sent to Geological Survey Yes No
 Cores Taken Yes No

Formation Description
 Log Sample

DST #1 4251-4291

30-60-30-60

IFP: 66#-55#

ISIP: 154#

FFP: 66#-55#

FSIP: 132#

Weak blow on initial and final.

Rcd: 30' DM

Name	Top	Bottom
Heebner	3698	(-1603)
Brown Lime	3829	(-1734)
LKC	3838	(-1743)
BKC	4117	(-2022)
Cherokee sh.	4260	(-2165)
Mississippi	4271	(-2176)
Base/ Chert	4291	(-2196)
Viola	4386	(-2291)
RTD	4433	(-2338)

CASING RECORD <input checked="" type="checkbox"/> New <input type="checkbox"/> Used Report all strings set-conductor, surface, intermediate, production, etc.							
Purpose of String	Size Hole Drilled	Size Casing Set (in O.D.)	Weight Lbs/Ft.	Setting Depth	Type of Cement	#Sacks Used	Type and Percent Additives
Surface	12 1/4"	8 5/8"	23#	307' KB	60/40 Poz	225	2% gel 3% cc
PERFORATION RECORD				Acid, Fracture, Shot, Cement Squeeze Record			
Shots Per Foot	Specify Footage of Each Interval Perforated			(Amount and Kind of Material Used)		Depth	
TUBING RECORD				Liner Run <input type="checkbox"/> Yes <input checked="" type="checkbox"/> No			
Date of First Production		Producing Method					
P & A		<input type="checkbox"/> Flowing <input type="checkbox"/> Pumping <input type="checkbox"/> Gas Lift <input type="checkbox"/> Other (explain).....					
Estimated Production Per 24 Hours	Oil	Gas	Water	Gas-Oil Ratio	Gravity		
	Bbls	MCF	Bbls	CFPB			

METHOD OF COMPLETION Production Interval

Disposition of gas: Vented Open Hole Perforation
 Sold Other (Specify).....
 Used on Lease Dually Completed
 Commingled