

STATE CORPORATION COMMISSION OF KANSAS  
OIL & GAS CONSERVATION DIVISION

WELL COMPLETION OR RECOMPLETION FORM  
ACO-1 WELL HISTORY

DESCRIPTION OF WELL AND LEASE

Operator: License # 5056  
Name F.G. Holl  
Address 6427 E. Kellogg  
City/State/Zip Wichita, Ks. 67207

Purchaser.....

Operator Contact Person W.J. "Jerry" Monk  
Phone (316) 684-8481

Contractor: License # 5142  
Name Sterling Drilling Co.

Wellsite Geologist Don Solze  
Phone.....

Designate Type of Completion  
 New Well  Re-Entry  Workover  
 Oil  SWD  Temp Abd  
 Gas  Inj  Delayed Comp.  
 Dry  Other (Core, Water Supply etc.)

If OWWO: old well info as follows:  
Operator.....  
Well Name.....  
Comp. Date.....Old Total Depth.....

WELL HISTORY

Drilling Method:  
 Mud Rotary  Air Rotary  Cable

10-8-84 10-16-84  
Spud Date Date Reached TD Completion Date

4495  
Total Depth PBDT

Amount of Surface Pipe Set and Cemented at 258 feet  
Multiple Stage Cementing Collar Used?  Yes  No  
If yes, show depth set.....feet  
If alternate 2 completion, cement circulated  
from.....feet depth to.....w/.....SX cmt

API NO. 15-047-21,212-0000

County Edwards

NE NE NE Sec. 10 Twp. 24 Rge. 17W  West

4950 Ft North from Southeast Corner of Section  
330 Ft West from Southeast Corner of Section  
(Note: Locate well in section plat below)

Lease Name Leon Smith Well # 4-10

Field Name Massey

Producing Formation Mississippi

Elevation: Ground 2095 KB. 2104

Section Plat

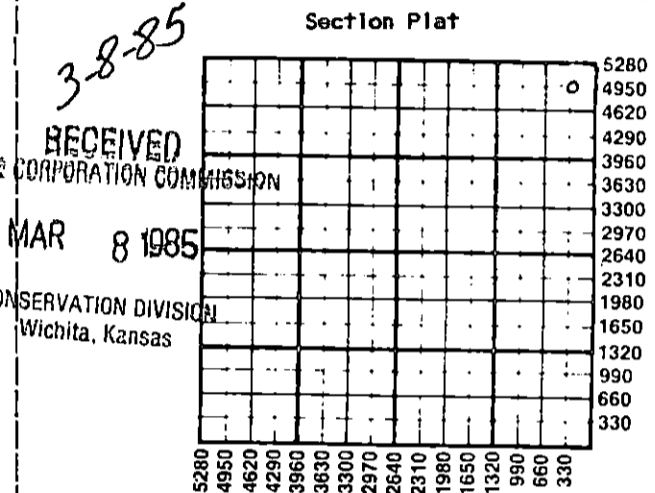

WATER SUPPLY INFORMATION

Disposition of Produced Water:  Disposal  Repressuring  
Docket # .....

Questions on this portion of the ACO-1 call:  
Water Resources Board (913) 296-3717

Source of Water:  
Division of Water Resources Permit #.....

Groundwater.....Ft North from Southeast Corner  
(Well) .....Ft West from Southeast Corner of  
Sec Twp Rge  East  West

Surface Water.....Ft North from Southeast Corner  
(Stream, pond etc).....Ft West from Southeast Corner  
Sec Twp Rge  East  West

Other (explain).....  
(purchased from city, R.W.D. #)

INSTRUCTIONS: This form shall be completed in duplicate and filed with the Kansas Corporation Commission, 200 Colorado Derby Building, Wichita, Kansas 67202, within 90 days after completion or recompletion of any well. Rule 82-3-130 and 82-3-107 apply.

Information on side two of this form will be held confidential for a period of 12 months if requested in writing and submitted with the form. See rule 82-3-107 for confidentiality in excess of 12 months. One copy of all wireline logs and drillers time log shall be attached with this form. Submit CP-4 form with all plugged wells. Submit CP-111 form with all temporarily abandoned wells.

All requirements of the statutes, rules and regulations promulgated to regulate the oil and gas industry have been fully complied with and the statements herein are complete and correct to the best of my knowledge.

Signature Wilfred J. Monk  
Title Geologist Date 3-6-85

Subscribed and sworn to before me this 6 day of March 1985  
Notary Public Mary D. Slagle

Date Commission Expires

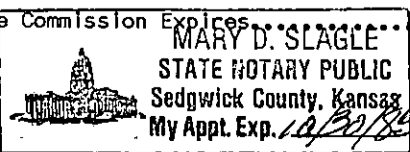

K.C.C. OFFICE USE ONLY  
F  Letter of Confidentiality Attached  
C  Wireline Log Received  
C  Drillers Timelog Received  
Distribution  
 KCC  SWD/Rep  NGPA  
 KGS  Plug  Other  
(Specify)

Sec. 10, Twp. 24, Rge. 17W

SIDE TWO

Operator Name F.G. Holl Lease Name Leon Smith Well # 4-10

Sec. 10 Twp. 24 Rge. 17W County Edwards

East  
 West

WELL LOG

INSTRUCTIONS: Show important tops and base of formations penetrated. Detail all cores. Report all drill stem tests giving interval tested, time tool open and closed, flowing and shut-in pressures, whether shut-in pressure reached static level, hydrostatic pressures, bottom hole temperature, fluid recovery, and flow rates if gas to surface during test. Attach extra sheet if more space is needed. Attach copy of log.

Drill Stem Tests Taken  Yes  No  
 Samples Sent to Geological Survey  Yes  No  
 Cores Taken  Yes  No

Formation Description  
 Log  Sample

Name Top Bottom

DST #1 4286-4354 Mississippi  
 30-33-60-36  
 Rcd: 120' OCGM  
 Rcd: 430' SMCGO (5% mud; 20% water; 60% oil; 15% gas)

Heebner	3725	(-1621)
Brown Lime	3850	(-1747)
LKC	3862	(-1758)
BKC	4150	(-2046)
Cherokee	4270	(-2166)
Mississippi	4327	(-2223)
Kinderhook	4388	(-2284)
Kinderhook sd	4410	(-2306)
Viola	4450	(-2346)
LTD	4454	(-2350)

Initial flow period weak blow building to a strong blow. Final flow period strong blow. Gas to surface in 50 minutes.

IFP: 96#-157#  
 ISIP: 901#  
 FFP: 169#-189#  
 FSIP: 824#  
 BHT: 130F

CASING RECORD <input checked="" type="checkbox"/> New <input type="checkbox"/> Used Report all strings set-conductor, surface, intermediate, production, etc.							
Purpose of String	Size Hole Drilled	Size Casing Set (in O.D.)	Weight Lbs/Ft.	Setting Depth	Type of Cement	#Sacks Used	Type and Percent Additives
Surface		8.5/8"	23#	258' KB	60/40 Poz	210	3% cc
Production		4.1/2"	10.5#	4489' KB	Lite	100	regular
					50/50 Poz	125	
PERFORATION RECORD				Acid, Fracture, Shot, Cement Squeeze Record			
Shots Per Foot	Specify Footage of Each Interval Perforated			(Amount and Kind of Material Used)		Depth	
1	4326-4336			1500 gal. 7 1/2% NE-FE acid. Frac w/ 1000 bbls x-link gel w/ 20,000# 20/40 and 20,000# 10/20 sand			
TUBING RECORD				Liner Run <input type="checkbox"/> Yes <input checked="" type="checkbox"/> No			
Date of First Production		Producing Method					
NA		<input type="checkbox"/> Flowing <input checked="" type="checkbox"/> Pumping <input type="checkbox"/> Gas Lift <input type="checkbox"/> Other (explain)					
Estimated Production Per 24 Hours	Oil	Gas	Water	Gas-Oil Ratio	Gravity		
	Bbls	MCF	Bbls	CFPB			

METHOD OF COMPLETION

Production Interval

Disposition of gas:  Vented  Open Hole  Perforation  
 Sold  Other (Specify) .....  
 Used on Lease  Dually Completed .....  
 Commingled .....