

STATE OF KANSAS
STATE CORPORATION COMMISSION

WELL PLUGGING RECORD
OR
FORMATION PLUGGING RECORD

Strike out upper line
when reporting plug-
ging of formations.

Give All Information Completely
Make Required Affidavit
Mail or Deliver Report to:
Conservation Division
State Corporation Commission
800 Bittling Building
Wichita, Kansas

Stafford County, Sec. 14 Twp. 24 Rge. 12 (E) 12 (W)
Location as "NE $\frac{1}{4}$ NW $\frac{1}{4}$ SW $\frac{1}{4}$ " or footage from lines CW/2, NW $\frac{1}{4}$, SW $\frac{1}{4}$

Lease Owner Stanolind Oil and Gas Co.
Lease Name L. M. Russell Well No. 1
Office Address Box 591 Tulsa, Oklahoma
Character of Well (completed as Oil, Gas or Dry Hole) Dry Hole
Date, well completed Dry Hole December 2 1940
Application for plugging filed Verbal request June 26 1941
Application for plugging approved July 2 1941
Plugging Commenced June 26 1941
Plugging Completed June 29 1941
Reason for abandonment of well or producing formation
Initially a Dry Hole
If a producing well is abandoned, date of last production None 193
Was permission obtained from the Conservation Division or its agents before plugging was commenced? Yes

T
24
S

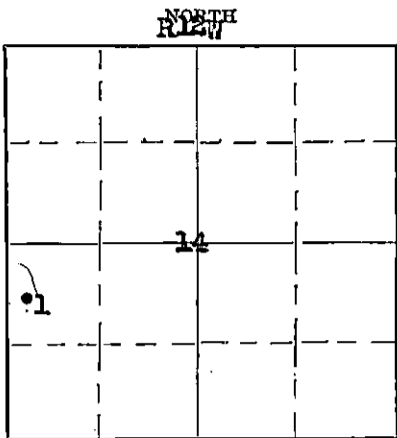

Locate well correctly on above
Section Plat

Name of Conservation Agent who supervised plugging of this well C. T. Alexander
Producing formation Viola ls. Depth to top 3859 Bottom 3886 Total Depth of Well 3886 Feet
Show depth and thickness of all water, oil and gas formations.

OIL, GAS OR WATER RECORDS

CASING RECORD

Formation	Content	From	To	Size	Put In	Pulled Out
<u>Viola Lime</u>	<u>Water (no oil)</u>	<u>3859</u>	<u>3886</u>	<u>8-5/8"OD</u>	<u>265'</u>	<u>None</u>
				<u>5-1/2"OD</u>	<u>3879'</u>	<u>2175'</u>

Describe in detail the manner in which the well was plugged, indicating where the mud fluid was placed and the method or methods used in introducing it into the hole. If cement or other plugs were used, state the character of same and depth placed, from.....feet to.....feet for each plug set.

Plugged back with cement 3886' to 3851'
Mud 3851' to 270'
Rock bridge 270' to 265'
15 sacks of cement 265' to 220'
Mud 220' to 14'
Cap - 10 sacks cement 14' to Cellar base.

(If additional description is necessary, use BACK of this sheet)

Correspondence regarding this well should be addressed to Stanolind Oil and Gas Co.
Address P. O. Box 591 Tulsa, Oklahoma

STATE OF Kansas, COUNTY OF Stafford, ss.

..... (employee of owner) or (owner or operator) of the above-described well,
being first duly sworn on oath, says: That I have knowledge of the facts, statements, and matters herein contained and the log of the above-described well as filed and that the same are true and correct. So help me God.

(Signature) [Signature] Field Supt.

P. O. Box 8 Ellinwood, Kansas
(Address)

SUBSCRIBED AND SWORN to before me this 17th day of July, 19 41

My commission expires September 14, 1942

Notary Public.

JUL 18 1941 7-18-41
STATE CORP COM
CONSERV DIV

14 24 07 24
144 22

640 Acres

B12

copy

STANOLIND OIL AND GAS COMPANY

WELL RECORD

T
24
S

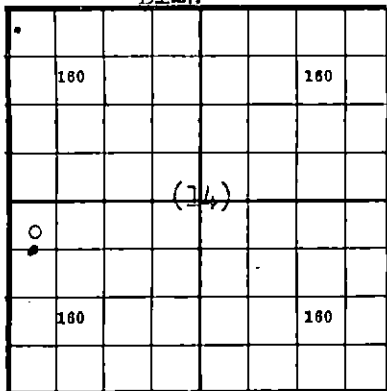

Locate Well Correctly

COUNTY Stafford, SEC. 14, TWP. 24, RGE. 12 W
 COMPANY OPERATING Stanolind Oil and Gas
 OFFICE ADDRESS P. O. Box No. 591, Tulsa, Oklahoma
 FARM NAME L. M. Russell WELL NO. 1
 DRILLING STARTED 10-24 19 40, DRILLING FINISHED 11-12 19 40
 WELL LOCATED CWL $\frac{1}{4}$ NW $\frac{1}{4}$ SW $\frac{1}{4}$ 1980 ft. North of South
 Line and 330 ft. East of West Line of Quarter Section.
 ELEVATION (Relative to sea level) DERRICK FLR. 1868 GROUND 1865'-8"
 CHARACTER OF WELL (Oil, gas or dry hole) dry hole

OIL OR GAS SANDS OR ZONES

Name	From	To	Name	From	To
1 Anhydrite	644		4		
2 Viola	3859	3886	6		
3			6		

WATER SANDS

Name	From	To	Water Level	Name	From	To	Water Level
1				4			
2				5			
3				6			

CASING RECORD

Size	Wt.	Thds.	Make	Amount Set		Amount Pulled		Packer Record		
				Ft.	In.	Ft.	In.	Size	Length	Depth Set
8 5/8"	32#	8	Used	262		2	tds. off		landed	270'-2"
5 1/2"	14#	8	Pitts	3849		9	"		"	3858'-1"

Liner Record: Amount _____ Kind _____ Top _____ Bottom _____

CEMENTING AND MUDDING RECORD

Size	Amount Set		Sacks Cement	Chemical		Method Cementing	Amount	Mudding Method	Results (See Note)
	Feet	In.		Gal.	Make				
8 5/8	264	11	130	Incor		Halliburton			
5 1/2	3874	9	100	Lone Star		Halliburton			

NOTE: What method was used to protect sands when outer strings were pulled? _____

NOTE: Were bottom hole plugs used? _____ If so, state kind, depth set and results obtained _____

14 24 12W
144 22

TOOLS USED

Rotary tools were used from 0 feet to 3886 feet, and from _____ feet to _____ feet
 Cable tools were used from drill plug and test. feet to _____ feet, and from _____ feet to _____ feet

Type Rig _____

PRODUCTION DATA

Production first 24 hours _____ bbls. Gravity _____, Emulsion _____ per cent., Water _____ per cent
 Filled up w/ 3000' of water
 Production second 24 hours _____ bbls. Gravity _____, Emulsion _____ per cent., Water _____ per cent
 If gas well, cubic feet per 24 hours _____ Rock Pressure, lbs. per square inch _____

I, the undersigned, being first duly sworn upon oath, state that this well record is true, correct and complete according to the records of this office and to the best of my knowledge and belief.

Original S/ C. B. Snyder Production Foreman
 Name and Title

Subscribed and sworn to before me this the 5th day of February, 19 41

My commission expires Sept. 14, 1942 Original S/ L. I. Young

Notary Public.

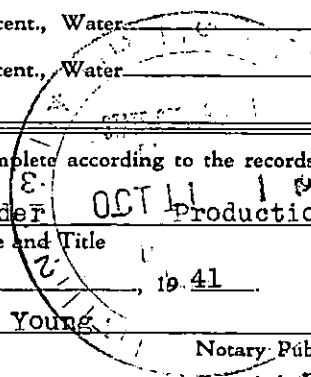

FORMATION RECORD

Give detailed description and thickness of all formations drilled through and contents of sand, whether dry, water, oil or gas.

Formation	Top	Bottom	Formation	Top	Bottom
cellar	0	10'-2"			
clay and sand	10'-2"	91'			
sand	91'	110			
red bed and shells	110	276			
red rock	276	644			
anhydrite	644	672			
blue shale	672	726			
red bed shale and shells	726	1149			
shale and shells	1149	1235			
salt	1235	1405			
shale and salt	1405	1510			
broken lime and shale	1510	1693			
broken lime	1693	1773			
lime	1773	1855			
shale	1855	1857			
broken lime and shale	1857	1955			
sandy shale	1955	2000			
lime	2000	2100			
broken lime w/ streak of shale	2100	2205			
shale	2205	2255			
lime	2255	2315			
shale	2315	2400			
broken lime	2400	2463			
shale and shells	2463	2650			
lime	2650	2680			
shale	2680	2738			
broken lime	2738	2761			
lime	2761	2808			
shale	2808	2840			
broken lime	2840	2878			
shale and lime	2878	2993			
lime	2993	3335			
shale	3335	3460			
lime	3460	3751			
shale	3751	3758			
shale and chert	3758	3777			
shale	3777	3837			
shale and lime	3837	3864			
cherty lime	3864	3870			
cherty dolomite	3870	3886			
<u>Total depth</u>	<u>3886</u>				
P.B. w/ cement	3886	3851			
<u>P.B. Total Depth</u>	<u>3851</u>				