

STATE OF KANSAS
STATE CORPORATION COMMISSION
200 Colorado Derby Bldg.
Wichita, Kansas 67202

Form CP-4
Rev. 12-15-80

WELL PLUGGING RECORD

Give All Information Completely
Make Required Affidavit

COUNTY Stafford SEC. 3 TWP 24S RGE 14W E/W
Location as in quarters or footage from lines:
NW SW SW

Locate Well
correctly on above
Section Platt.

Lease Owner A.L. Abercrombie, Inc.
Lease Name Hager #1 Well No. _____
Office Address 801 Union Center Wichita, Kansas 67202
Character of Well (Completed as Oil, Gas or Dry Hole): _____
Date Well Completed _____
Application for plugging filed _____
Plugging commenced 8-16-83
Plugging completed 8-18-83
Reason for abandonment of well or producing formation _____

Depleted
Was permission obtained from the Conservation Division or it's
Agent's before plugging was commenced? Yes

Name of Conservation Agent who supervised plugging of this well Robert Tarbutton
Producing formation _____ Depth to top _____ bottom T.D. 4310'
Show depth and thickness of all water, oil and gas formations.

OIL, GAS OR WATER RECORDS Casing Record

Formation	Content	From	To	Size	Put in	Pulled Out
				8-5/8"	254'	none
				4-1/2"	3942'	1735'

Describe in detail the manner in which the well was plugged, indicating where the mud fluid was placed and the method or methods used in introducing it into the hold. If cement or other plugs were used, state the character of same and depth placed, from _____ feet to _____ feet for each plug set.

Plugged off bottom with sand to 3715' and ran 4 sacks cement. Shot casing @3000', 2500', 2000', 1800', 1710' and pulled a total of 43 joints (1735') of 4-1/2" casing. Plugged well with 3 hulls, 10 gel, 50 60/40 pos, 2% gel, 3% cc., 10 gel, 1 hull, released plug and displaced with 100 sx. 60/40 pos, 2% gel, 3% cc.

Plugging Complete.

(If additional description is necessary, use BACK of this sheet)
Name of Plugging Contractor Kelso Casing Pulling

STATE OF Kansas COUNTY OF Rice, ss.
R. Darrell Kelso (employee of owner) or (owner or operator) of the above-described well, being first duly sworn on oath, says: That I have knowledge of the facts, statements, and matters herein contained and the log of the above-described well as filed and that the same are true and correct. So help me God.

(Signature) R. Darrell Kelso
Box 347 Chase, Ks. 67524
(Address)

SUBSCRIBED AND SWORN TO before me this 23rd. day of August 19 83

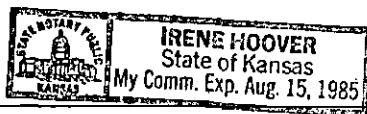

My Commission expires:

RECEIVED
STATE CORPORATION COMMISSION
Notary Public.

Rec'd
8-25-83
AUG 25 1983
WICHITA, KANSAS

KANSAS DRILLERS LOG

API No. 15 — 185 — 20,910
 County Number

S. 3 T. 24S R. 14W^E_W
 Loc. NW SW SW
 County Stafford

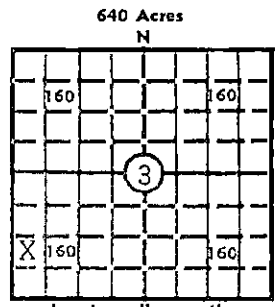

Locate well correctly
 Elev.: Gr. 1963'
 DF 1969' KB 1971'

Operator
Abercrombie Drilling, Inc.

Address
801 Union Center, Wichita, Kansas 67202

Well No. 1 Lease Name Hager

Footage Location
990' feet from XX (S) line 330' feet from XX (W) line

Principal Contractor Abercrombie Drilling, Inc. Geologist Bill Darrow

Spud Date May 01, 1979 Total Depth 4310' P.B.T.D.

Date Completed May 23, 1979 Oil Purchaser Clear Creek, Inc.

CASING RECORD

Report of all strings set— surface, intermediate, production, etc.

Purpose of string	Size hole drilled	Size casing set (in O.D.)	Weight lbs/ft.	Setting depth	Type cement	Sacks	Type and percent additives
Surface	12 1/4"	8-5/8"	28#	254'	common	185	3% Ca.Cl. 2% gel.
Production	7-7/8"	4 1/2"	10 1/2#	3942'	posmix common	50 150	2% gel., salt sat. 2% gel., salt sat.

LINER RECORD

PERFORATION RECORD

Top, ft.	Bottom, ft.	Sacks cement	Shots per ft.	Size & type	Depth interval
			4		3765' - 3769'

Size	Setting depth	Packer set at

ACID, FRACTURE, SHOT, CEMENT SQUEEZE RECORD

Amount and kind of material used	Depth interval treated
500 gallons of 15% Non-E	3765' - 3769'

RECEIVED
 STATE CORPORATION COMMISSION
 JUL 19 1983

INITIAL PRODUCTION

Date of first production 08-27-79 Producing method (flowing, pumping, gas lift, etc.) Pumping CONSERVATION DIVISION
 Wichita, Kansas

RATE OF PRODUCTION PER 24 HOURS
 Oil 36 bbls. Gas -- MCF Water trace bbls. Gas-oil ratio -- CFPB

Disposition of gas (vented, used on lease or sold) -- Producing interval(s) 3765' - 3769'

INSTRUCTIONS: As provided in KCC Rule 82-2-125, within 90 days after completion of a well, one completed copy of this Drillers Log shall be transmitted to the State Geological Survey of Kansas, 4150 Monroe Street, Wichita, Kansas 67209. Copies of this form are available from the Conservation Division, State Corporation Commission, 3830 So. Meridian (P.O. Box 17027), Wichita, Kansas 66217. Phone AC 316-522-2206. If confidential custody is desired, please note Rule 82-2-125. Drillers Logs will be on open file in the Oil and Gas Division, State Geological Survey of Kansas, Lawrence, Kansas 66044.

Operator
Abercrombie Drilling, Inc.

DESIGNATE TYPE OF COMP.: OIL, GAS,
DRY HOLE, SWDW, ETC.:
Oil

Well No. 1 Lease Name Hager

S 3 T 24 S R 14 W

WELL LOG

Show all important zones of porosity and contents thereof; cored intervals, and all drill-stem tests, including depth interval tested, cushion used, time tool open, flowing and shut-in pressures, and recoveries.

SHOW GEOLOGICAL MARKERS, LOGS RUN, OR OTHER DESCRIPTIVE INFORMATION.

FORMATION DESCRIPTION, CONTENTS, ETC.	TOP	BOTTOM	NAME	DEPTH
Sand and clay	0	254	SAMPLE TOPS:	
Red beds and shale	254	1981		
Lime and shale	1981	2859	Anhydrite	901' (+1070)
Shale and lime	2859	3075	B/Anhydrite	921' (+1050)
Lime and shale	3075	4310	Heebner	3489' (-1518)
Rotary Total Depth		4310	Toronto	3510' (-1539)
			Douglas	3530' (-1559)
DST #1 (3758-3785') 30", 45", 60", 45"			Brown Lime	3630' (-1659)
Rec. 60' mco, 180' hgc froggy oil, 350' gassy oil. GTS 25"			Lansing	3646' (-1675)
IFP 106-127, IBHP 1160, FFP 191-213, FBHP 1098.			Viola	4035' (-2064)
			B/KC	3910' (-1939)
DST #2 (3803-3818') 30", 45", 60", 45"			Simpson	4185' (-2214)
Weak blow, died in 60".			Arbuckle	4237' (-2266)
IFP 63-21, IBHP 21, FFP 10-10, FBHP 21.			ELECTRIC LOG TOPS:	
DST #3 (3838-3862') 30", 45", 60", 45"			Anhydrite	890' (+1081)
Rec. 63' oil specked drilling mud.			B/Anhydrite	910' (+1061)
IFP 53-31, IBHP 63, FFP 42-31, FBHP 53.			Heebner	3475' (-1504)
DST #4 (3878-3898') 30", 30", 30", 30"			Toronto	3496' (-1525)
Rec. 5' mud. Weak blow 5".			Douglas	3513' (-1542)
IFP 53-10, IBHP 10, FFP 0-0, FBHP 0.			Brown Lime	3618' (-1647)
			Lansing	3633' (-1662)
			B/KC	3898' (-1927)
			Cong.	3924' (-1953)
			Viola	4024' (-2053)
			Simpson	4173' (-2202)
			Arbuckle	4231' (-2260)
			LTD	4303'
			DTD	4310'

USE ADDITIONAL SHEETS, IF NECESSARY, TO COMPLETE WELL RECORD.

Date Received	
	Signature
	Jack L. Partridge, Asst. Sec.-Treas.
	Title
	September 4, 1979
	Date