

Give All Information Completely
Make Required Affidavit
Mail or Deliver Report to:
Conservation Division
State Corporation Commission
211 No. Broadway
Wichita, Kansas

WELL PLUGGING RECORD

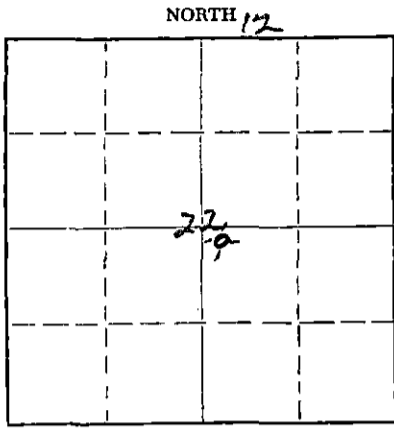

Locate well correctly on above
Section Plat

Stafford County, Sec. 22 Twp 24 Rge. (E) 12 (W)
Location as "NE/CNW%SW%" or footage from lines NW NW NE
Lease Owner Vaughan Drilling, Inc.
Lease Name Garey Well No. 1
Office Address Box 825 (1314 Kansas) Great Bend, Kansas
Character of Well (completed as Oil, Gas or Dry Hole) dry hole
Date well completed 1-7-65 19
Application for plugging filed 1-9-65 19
Application for plugging approved A.M. 19
Plugging commenced 10:00/1-7-65 19
Plugging completed 12:00 M. 1-7-65 19
Reason for abandonment of well or producing formation dry hole

If a producing well is abandoned, date of last production 19
Was permission obtained from the Conservation Division or its agents before plugging was commenced? yes

Name of Conservation Agent who supervised plugging of this well Archie Elvins
Producing formation _____ Depth to top _____ Bottom _____ Total Depth of Well _____ Feet
Show depth and thickness of all water, oil and gas formations.

OIL, GAS OR WATER RECORDS

CASING RECORD

FORMATION	CONTENT	FROM	TO	SIZE	PUT IN	PULLED OUT
		0'	236'	8 5/8"	236	none

Describe in detail the manner in which the well was plugged, indicating where the mud fluid was placed and the method or methods used in introducing it into the hole. If cement or other plugs were used, state the character of same and depth placed, from _____ feet to _____ feet for each plug set.
Bottom plug @ 225' with 1/4 sack hulls and 25 sx cement.
Top Plug @ 40' with 1/2 sack hulls and 10 sx cement.
2 sx cement in rat hole.

RECEIVED
STATE CORPORATION COMMISSION
JAN 11 1965
1-11-65
CONSERVATION DIVISION
Wichita, Kansas

(If additional description is necessary, use BACK of this sheet)
Name of Plugging Contractor Vaughan Drilling, Inc.
Address Box 825, Great Bend, Kansas

STATE OF KANSAS, COUNTY OF BARTON, ss.
Donald D. Vaughan (employee of owner) or (owner or operator) of the above-described well, being first duly sworn on oath, says: That I have knowledge of the facts, statements, and matters herein contained and the log of the above-described well as filed and that the same are true and correct. So help me God.

(Signature) Donald D. Vaughan
Box 825, Great Bend, Kansas
(Address)

SUBSCRIBED AND SWORN TO before me this 9th day of January, 1965
Dorothy Tully
Dorothy Tully, Notary Public.

My commission expires Jan. 24, 1968.

WELL LOG

COMPANY Vaughan Drilling, Inc.
 CONTRACTOR Vaughan Drilling, Inc.
 FARM #1 Garey
 LOCATION NW NW NE of sec. 22-24-12W
 Stafford County, Kansas
 ELEVATION 1870 K. B.
 SURFACE PIPE 8 5/8" set @ 236' with 190 sx posmix sunset.
 PRODUCTION D & A
 COMMENCED 12-22-64
 COMPLETED 1-7-65

<u>FORMATION</u>	<u>DEPTH</u>
Surface Clay	20
Sandstone & Clay	135
Red Bed	679
Anhydrite	698
Shale & Shells	1640
Limestone & Shale	1725
Limestone	2120
Shale & W/Lime streaks	2160
Limestone & Shale	3065
Limestone	3320
Limestone & Shale	3478
Limestone	3755
Limestone, Chert, & Shale	3838
Chert	3843
Shale & Limestone	3863
Chert	3931
Chert & Shale	3956
Shale, Chert & Limestone	4075
Shale	4079
Arbuckle	4105
Limestone	4109
RTD	4109

RECEIVED
 STATE CORPORATION COMMISSION
 JAN 11 1965
 CONSERVATION DIVISION
 Wichita, Kansas

FORMATION TOPS

Anhydrite	679 (+1191)	Mississippi	3852 (-1982)
Heebner	3320 (-1450)	Kinderhook	3930 (-2060)
Toronto	3334 (-1464)	Viola	3974 (-2104)
Douglas	3355 (-1485)	Simpson	4004 (-2134)
Brn. Lime	3477 (-1607)	Simpson Sand	4024 (-2154)
Lansing	3503 (-1633)	Arbuckle	4086 (-2216)
Base Kansas City	3778 (-1908)	RTD	4108 (-2238)
Marmaton	3788 (-1918)		
Conglomerate	3819 (-1949)		

A F F I D A V I T

STATE OF KANSAS., COUNTY OF BARTON, SS:

I, Donald D. Vaughan, of the VAUGHAN DRILLING, INC., being first duly sworn on oath, state; that I have knowledge of the facts, statements and matters herein contained and that the same are true and correct.

Donald D. Vaughan
 Donald D. Vaughan

Subscribed and sworn to before me this 9th day of January, 1965

My commission expires: Jan. 24, 1968

Dorothy Tully
 Dorothy Tully, Notary Public