

STATE OF KANSAS
STATE CORPORATION COMMISSION

WELL PLUGGING RECORD

Give All Information Completely
Make Required Affidavit
Mail or Deliver Report to:
Conservation Division
State Corporation Commission
212 North Market, Insurance Bldg.
Wichita, Kansas

Reno County, Sec. 24 Twp. 24S Rge. (E) 8 (W)

Location as "NE/CNW/SW" or footage from lines SW/4 SE/4 SW/4
Lease Owner Skelly Oil Company
Lease Name L. A. Smith Well No. 3
Office Address Box 1650, Tulsa, Oklahoma
Character of Well (completed as Oil, Gas or Dry Hole) Salt Wtr. Repressure
Date well completed July 27, 1937
Application for plugging filed August 18, 1960
Application for plugging approved August 22, 1960
Plugging commenced September 14, 1960
Plugging completed September 18, 1960
Reason for abandonment of well or producing formation All wells on lease being abandoned, no further need for well
If a producing well is abandoned, date of last production 19
Was permission obtained from the Conservation Division or its agents before plugging was commenced? Yes

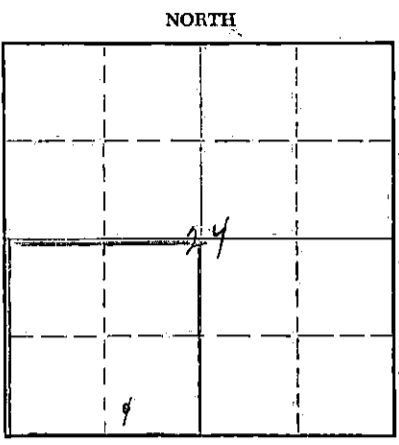

Locate well correctly on above Section Plat

Name of Conservation Agent who supervised plugging of this well Mr. Fred Hampel
Producing formation _____ Depth to top _____ Bottom _____ Total Depth of Well 3544 Feet
Show depth and thickness of all water, oil and gas formations.

OIL, GAS OR WATER RECORDS

CASING RECORD

FORMATION	CONTENT	FROM	TO	OD. SIZE	PUT IN	PULLED OUT
Lans.-Kans. City	Oil	3526'	3541'	10-3/4"	238'1"	None
				7"	3554'9"	2724'

Describe in detail the manner in which the well was plugged, indicating where the mud fluid was placed and the method or methods used in introducing it into the hole. If cement or other plugs were used, state the character of same and depth placed, from _____ feet to _____ feet for each plug set.

Sand	3544' to 3500'
4 sacks of cement	3500' to 3480'
Mud	3480' to 250'
Rock bridge	250' to 240'
25 sacks of cement	240' to 190'
Mud	190' to 45'
Rock bridge	45' to 35'
15 sacks of cement	35' to 6'
Rock and surface soil	6' to Surface

RECEIVED
STATE CORPORATION COMMISSION
OCT 11 1960
10-11-60
CONSERVATION DIVISION
Wichita, Kansas

(If additional description is necessary, use BACK of this sheet)
Name of Plugging Contractor Ace Pipe Pulling Company
Address Box 304, Great Bend, Kansas

STATE OF Kansas COUNTY OF Reno, ss.
H. E. Wamsley (employee of owner) or (owner or operator) of the above-described well, being first duly sworn on oath, says: That I have knowledge of the facts, statements, and matters herein contained and the log of the above-described well as filed and that the same are true and correct. So help me God.

(Signature) [Signature]
Box 391, Hutchinson, Kansas (Address)

SUBSCRIBED AND SWORN TO before me this 10th day of October, 1960

My commission expires April 7, 1963 [Signature] Notary Public.

SKELLY OIL COMPANY

REPORT OF CHANGE IN WELL RECORD

Give complete description of all cleaning out, deepening, plugging back and fishing jobs, changes in casing, material lost in hole, etc., not recorded in original well record.

3577

L. A. Smith

LEASE 3 WELL NO. Western Kansas DISTRICT

SEC. 26 T. 24S R. 6E7 COUNTY Reno 6378 JOB NO.

SURVEY _____ BLOCK _____ STATE Kansas

CLEANING OUT RECORD	PLUGGING BACK OR DEEPENING RECORD
Date commenced..... 19.....	Date commenced..... <u>September 14,</u> 19 <u>60</u>
Date completed..... 19.....	Date completed..... <u>September 10,</u> 19 <u>60</u>
Cleaned out from..... to..... T. D.....	Plugged back or deepened from <u>3544'</u> to <u>Surf.</u> T. D. <u>P & A</u>
Prod. before..... bbls. bbls. cu. ft. oil water gas	Prod. before..... bbls. bbls. cu. ft. oil water gas
Prod. after..... bbls. bbls. cu. ft. oil water gas	Prod. after..... bbls. bbls. cu. ft. oil water gas
Kind of tools used:.....	Kind of tools used:.....
Tools owned by:.....	Tools owned by: <u>Acc Pipe Pulling Co.</u>

SHOT RECORD

Date	Size shot	Qt.	Qt.	Qt.	Qt.	
Shot between	Ft. and	Ft.	Ft. and	Ft.	Ft. and	Ft.
Size of shell						
Put in by (Co.)						
Length anchor						
Distance below casing						
Damage to casing or casing shoulder						

CHANGES IN CASING RECORD

SIZE	Wt.	Thds.	Where Set	PULLED OUT			LEFT IN			KIND	Cond'n	CEMENTING	
				Jts.	Feet	In.	Jts.	Feet	In.			Sacks Used	Method Employed
<u>7"</u>	<u>20</u>	<u>10</u>		<u>67</u>	<u>2726</u>	<u>0</u>	<u>25</u>	<u>630</u>	<u>9</u>	<u>12 NEW</u>	<u>C</u>		

.....Liner set at..... Length..... Perforated at.....

Packer set at..... Size and kind.....

[Handwritten Signature]

Superintendent.

REMARKS (Give review of work accomplished and any other comment of interest) On September 16,
1960, moved in machine of Ace Pipe Pulling Company and plugged
the well as follows:

Send 3544' to 3500'
 4 sacks of cement 3500' to 3480'

Shot off 7" casing at 2900', casing would not pull.
 Shot off casing at 2696' and pulled 87 lbs. (2724' of 7"
 casing (C cond.).

Mud 3480' to 250'
 Rock bridge 250' to 240'
 25 sacks of cement 240' to 190'
 Mud 190' to 45'
 Rock bridge 45' to 35'
 15 sacks of cement 35' to 6'
 Rock and surface soil 6' to Surface

Plugged and abandoned September 18, 1960.

RECORD OF FORMATIONS

FORMATION	TOP	BOTTOM	REMARKS Indicate Casing Points, Describe Shows of Oil, Gas and Water, etc.
-----------	-----	--------	---

SKELLY OIL COMPANY

REPORT OF CHANGE IN WELL RECORD

Give complete description of all cleaning out, deepening, plugging back and fishing jobs, changes in casing, material lost in hole, etc., not recorded in original well record.

L. A. Smith SURT 3 Southern Kansas
 LEASE _____ WELL NO. _____ DISTRICT _____
 SEC. 24 T. 24S R. 67 COUNTY Reno Dist. 119
 SURVEY _____ BLOCK _____ STATE Kansas JOB NO. _____

ACID CLEANING OUT RECORD	PLUGGING BACK OR DEEPENING RECORD
Date commenced..... <u>January 4,</u> 19 <u>50</u>	Date commenced..... 19
Date completed..... <u>January 6</u> 19 <u>50</u>	Date completed..... 19
Cleaned out from..... to..... T.D. <u>3544'</u>	Plugged back or deepened from..... to..... T.D.....
Prod. before..... bbls. <u>50</u> oil..... bbls. <u>per day</u> water..... cu. ft. <u>gas</u>	Prod. before..... bbls. oil..... bbls. water..... cu. ft. gas
Prod. after..... bbls. <u>64</u> oil..... bbls. <u>in 55 min</u> water..... cu. ft. <u>gas</u>	Prod. after..... bbls. oil..... bbls. water..... cu. ft. gas
Kind of tools used: <u>Pulling Unit</u>	Kind of tools used:.....
Tools owned by: <u>Storling Well Service</u>	Tools owned by:.....

ACID SHOT RECORD							
Date	<u>1/7/50</u>						
Size shot	<u>2000 Gal. Qts.</u>			Qts.		Qts.	Qts.
Shot between	<u>3526</u> Ft. and <u>3544</u> Ft.		Ft. and	Ft.		Ft. and	Ft.
Size of shell							
Put in by (Co.)	<u>Holliburton</u>						
Length anchor							
Distance below casing							
Damage to casing or casing shoulder							

CHANGES IN CASING RECORD													
SIZE	-Wt.	Thds.	Where Set	PULLED OUT			LEFT IN			KIND	Cond'n	CEMENTING	
				Jts.	Feet	In.	Jts.	Feet	In.			Sacks Used	Method Employed

.....Liner set at..... Length..... Perforated at.....
 Packer set at..... Size and kind.....

Superintendent.

EMARKS (Give review of work accomplished and any other comment of interest)

On January 4, 1958, moved in pulling unit of Sterling Well Service and pulled 2 1/2" cement lined tubing. Ran 1 1/2" tubing and treated with 2000 gallons of Halliburton 30% acid as follows:

ACID TREATMENT NO. 3 - Between 3526' and 3544'

Treatment put in 1/7/58 by Halliburton, using 2000 gallons of acid and 70 barrels of water.

TIME	OP	TP	REMARKS
4:20 pm			Start acid
4:22 pm		500'	Acid on bottom
4:47 pm		500'	1000 gallons of acid in
5:36 pm		500'	2000 gallons of acid in
5:46 pm		500'	Finished flush, treatment completed

Pulled 1" tubing and tested input through 7" casing.

Well took 64 barrels of water by gravity in 55 minutes. Ran 2 1/2" EUB cement lined tubing and set 7" x 2 1/2" Baker packer at 3376'

RECORD OF FORMATIONS

FORMATION	TOP	BOTTOM	REMARKS
			Indicate Casing Points, Describe Shows of Oil, Gas and Water, etc.

SKELLY OIL COMPANY

REPORT OF CHANGE IN WELL RECORD

Give complete description of all cleaning out, deepening, plugging back and fishing jobs, changes in casing, material lost in hole, etc., not recorded in original well record.

LEASE NAME Laura A. Smith WELL NO. 3 (S.O.R.O.)

ACID CLEANING-OUT RECORD	PLUGGING BACK OR DEEPENING RECORD
Date commenced..... <u>January 26, 19 48</u>	Date commenced..... 19
Date completed..... <u>January 29, 19 48</u>	Date completed..... 19
Cleaned out from..... to..... T. D. <u>3544'</u>	Plugged back or deepened from..... to..... T.D.....
Prod. before..... <u>---</u> bbls. <u>---</u> bbls. <u>---</u> cu. ft. oil..... water..... gas	Prod. before..... bbls. bbls. cu. ft. oil..... water..... gas
Prod. after..... <u>---</u> bbls. <u>---</u> bbls. <u>---</u> cu. ft. oil..... water..... gas	Prod. after..... bbls. bbls. cu. ft. oil..... water..... gas
Kind of tools used: <u>Unit 28508</u>	Kind of tools used:.....
Tools owned by: <u>Skelly Oil Company</u>	Tools owned by:.....

ACID SHOT RECORD

Date	<u>1/26/48</u>				
Size shot	<u>3000 Gals. 5/8"</u>	Qts.	Qts.	Qts.	Qts.
Shot between	<u>3526 Ft. and 3544 Ft.</u>	Ft. and Ft.	Ft. and Ft.	Ft. and Ft.	Ft. and Ft.
Size of shell					
Put in by (Co.)	<u>Halliburton</u>				
Length anchor					
Distance below casing					
Damage to casing or casing shoulder					

CHANGES IN CASING RECORD

SIZE	Wt.	Thds.	Where Set	PULLED OUT			LEFT IN			KIND	Cond'n	CEMENTING	
				Jts.	Feet	In.	Jts.	Feet	In.			Sacks Used	Method Employed

Liner set at..... Length..... Perforated at.....
 Packer set at 3436' Size and kind 2 1/2" x 7" 00 Lane-Cole Hookwall Packer

REMARKS (Give review of work accomplished and any other comment of interest).....
The formation would not take water in sufficient quantities for salt water repressuring, and on January 26, 1948, treated with 3000 gallons of Halliburton acid as follows:

RECEIVED

STATE CORPORATION COMMISSION

(Use reverse side for continuation of remarks and for formation record).

OCT 11 1960

CONSERVATION DIVISION
 Wichita, Kansas



Superintendent.

REMARKS (Continued)

ACID TREATMENT NO. 2 - Between 3436' and 3544'

Treatment put in 1/26/48 by Halliburton using 3000 gallons of acid and 180 barrels of water to flush.

TIME	GP	REMARKS
1:55 PM		Start acid in casing
2:10 PM		3000 gallons of acid in casing
2:20 PM	150'	Hole loaded, acid on bottom
2:35 PM	150'	600 gallons of acid in formation
2:40 PM	100'	1200 gallons of acid in formation
2:45 PM	75'	1800 gallons of acid in formation

RECORD OF FORMATIONS

FORMATION	TOP	BOTTOM	REMARKS Indicate Casing Points, Describe Shows of Oil, Gas and Water, etc.
2:50 PM	75'	2400 gallons of acid in formation	
2:55 PM	60'	3000 gallons of acid in formation	
3:10 PM	60'	Flushed hole with 180 barrels of water and treatment completed.	

On January 30, ran 2 1/2" tubing on Lane-Jella hookwall packer and set packer at 3436', then started using well for salt water producing.

During the month of February, 1948, the well took 2,065 barrels of water.

SKELLY OIL COMPANY

Well Record

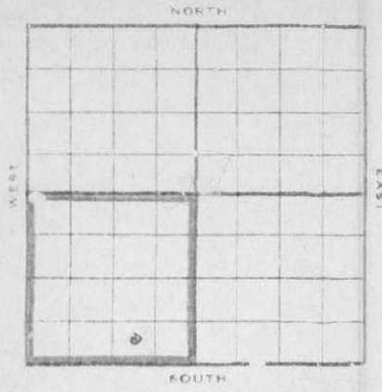

Lease Name and No. **L. A. Smith (3819)** Well No. **3** Elev. **1633° DP.**
 Lease Description **SW/4 Sec. 24-24S-8W,**
Reno County, Kansas. (160 Acres).
 Location made **June 14,** 19 **37** by **H. V. Morse**
 feet from North line **990** feet from East line of
330 feet from South line feet from West Line

Rig com'd. **June 15,** 19 **37** Rig comp'd **June 20,** 19 **37** Drlg. com'd **June 26,** 19 **37** Drlg. comp'd **July 27,** 19 **37**
 Rig Contractor **Mahan, McCarty & Besse, Inc. - Tulsa, Oklahoma.**
 Drilling Contractor **Claude Drilling Co. - Tulsa, Oklahoma.**
 Rotary Drilling from **Top** to **3526 1/2'** Cable Tool Drilling from **3526 1/2'** to **3544'**
 Commenced Producing **July 27,** 19 **37** Initial Prod. before shot or acid **1500' OIH. in 20 hours.**
 Initial Prod. after shot or acid **386 (Pumped in 24-hour test).**
 Dry Gas Well Pressure Volume
 Casing Head Gas Pressure Volume **Est. 100 M.**
 Braden Head (**10-3/4" x 7" OD.**) Gas Pressure Volume
 Braden Head () Gas Pressure Volume

PRODUCING FORMATION **Kansas City Lime** Top **3526** Bottom **3541'** TOTAL DEPTH **3544'**

CASING RECORD

Size	Wt.	Thds.	Where Set	PULLED OUT			LEFT IN			KIND	Cond'n	Sacks Used	CEMENTING Method Employed
				Jts.	Feet	In.	Jts.	Feet	In.				
10-3/4" OD.	35		245				8	238	1	Armco Spiral "A"	200	Halliburton.	
7" OD.	20	10	3526				115	3554	9	Elec. Weld "A"	100	"	

Top of the 10-3/4" casing is 8" in cellar, and the 7" is cased to derrick floor.

RECEIVED
STATE CORPORATION COMMISSION

Liner Set at Length Perforated at
 Liner Set at Length Perforated at
 Packet Set at Size and Kind
 Packet Set at Size and Kind

OCT 11 1960
CONSERVATION DIVISION
Wichita, Kansas

SHOT OR ACID TREATMENT RECORD

Date	Acid Used	Size Shot	Shot Between	Size of Shell	Put in by (Co.)	Length anchor	Distance below Cas'g Damage to Casing or Casing Shoulder	FIRST		SECOND		THIRD		FOURTH	
								Ft.	Ft.	Ft.	Ft.	Ft.	Ft.	Ft.	Ft.
July 28, 1937		2000	3526 Ft. and 3544 Ft.		Morgan Acid Co.		None								

SIGNIFICANT GEOLOGICAL FORMATIONS

NAME	Top	Bottom	GAS		OIL		REMARKS
			From	To	From	To	
Lansing-Kansas City line series	3194				3526	3541	Main body pay formation.

CLEANING OUT RECORDS

	DATE COMMENCED	DATE COMPLETED	PROD. BEFORE	PROD. AFTER	REMARKS
1st					See Reverse for other details
2nd					
3rd					
4th					

PLUGGING BACK AND DEEPENING RECORDS

	Date Commenced	Date Completed	No. Feet Plugged Back or Deepened	Prod. Before	Prod. After	REMARKS
1st						See Reverse for other details
2nd						
3rd						
4th						

(See Reverse for Record of Formations)

RECORD OF FORMATIONS

Form N-C-25 (2)

FORMATION	TOP	BOTTOM	REMARKS
			Indicate Casing Points, Describe Shows of Oil, Gas and Water, etc.
Sand	0	70	
Red rock	70	100	
Shale & shells	100	212	
Shells	212	257	Set and cemented 10-3/4" OD. Armco Spiral Weld casing at 245' w/ 200 sacks - Halliburton process.
Lime & shells	257	654	
Shale & lime shells	654	810	
Salt	810	930	
Shale & salt	930	1170	
Shale & lime shells	1170	1250	
Broken lime	1250	1780	
Blue shale & shells	1780	1856	
Shale	1856	1888	
Shale & shells	1888	2092	
Broken lime	2092	2260	
Shale & lime	2260	2355	
Lime	2355	2395	
Broken lime	2395	2447	
Shale & lime shells	2447	2533	
Lime	2533	2591	
Shale & shells	2591	2760	
Broken lime	2760	2797	
Lime	2797	2835	
Broken lime	2835	3097	
Shale & sand	3097	3153	
Hard sandy shale	3153	3200	Top Lansing-Kansas City lime series 3194'.
Lime & broken lime	3200	3280	
Lime	3280	3300	
Broken lime	3300	3335	
Lime	3335	3350	
Broken lime	3350	3390	
Lime	3390	3495	
Broken lime	3495	3515	
Cherty lime & shale	3515	3524	
Black shale	3524	3526	
Brown oolitic lime	3526	3527	Porous w/ little saturation.
Steel line correction	3527	3526 1/2	Top oolitic Kansas City lime pay 3526'. Ran and cemented 7" OD. casing at 3526' w/ 100 sacks - Halliburton process. While waiting cement to set, moved out rotary, moved in drilling in unit and rigged up cable tools. Commenced bailing July 23, 1937. Bailed hole dry on 25th, and 7" tested OK. Drilled plug and cement job tested OK.
Brown porous oolitic lime	3526 1/2	3529	Saturated. 500' OIH. in 2 hours.
Same w/ 40% dense gray crystalline lime	3529	3534	Soft 3529-3532'. 800' OIH. in 4 hours.
Dense gray cherty lime	3534	3537	No increase. 1100' OIH. in 7 hours. Shut down to repair rig front 8 hours and had 1400' OIH. in 16 hours. Gas est. 25 M. per day.
Gray & brown crystalline lime	3537	3544	Oil stained. Med. hard 3541-3544'. 1500' OIH. in 20 hours. Swabbed and bailed hole to bottom, 50 bbls. oil in 3 hours. Stopped drilling July 27, 1937 at depth 3544', and ran 2-1/2" tubing to treat w/ acid as follows:
TOTAL DEPTH		3544'	

Acid Treatment No. 1: July 28, 1937, by Morgan Co., using 2000 gal. acid solution w/ 150 bbls. oil during treatment.

Time	CF.	TP.	
5.15 PM.	500#	500#	Filled hole w/ 100 bbls. oil and tested all connections to 500#.
5.29	360#	0#	Had 19 bbls. acid in hole.
5.35	0#	26" Vac.	" 24 " " " "
5.40	26" Vac.	26" "	" 34 " " " "
5.45	26" "	26" "	" 48 " " " " (2000 gal.)
6.15	26" "	26" "	" 30 " " " " oil in hole.
6.30	26" "	15" "	Finished flushing tubing and chasing acid w/ 50 bbls.

oil and shut well in for acid to act. After treatment, left well shut in for 25 hours, then started potential test at 7.45 PM. July 29, 1937 and following 24 hours, pumped 386 bbls. oil w/ no water. This potential permitted a daily allowable of 59 bbls. oil per day for the balance of month of July and month of August, 1937. Equipment is being moved in to equip the well to pump on jack which will be powered by rod line to back crank at well No. 2A.

Slope Test Data

Depth	Angle (In deg.)	Horiz.	Vert.	Depth	Angle (In deg.)	Horiz.	Vert.
				1750'	1/4	2.3'	.0'
				2000	1/4	2.3	.0
250'	1/4	2.3°	.0'	2250	1/4	2.3	.0
500	1/4	2.3	.0	2500	1	4.4	.1
750	1/4	2.3	.0	2750	1/4	2.3	.0
1000	1/4	2.3	.0	3000	1	4.4	.1
1250	1/4	2.3	.0	3250	1/4	2.3	.0
1500	1/4	2.3	.0	3500'	1/4	2.3	.0
Total deflections						36.4'	.2'