

CARD MUST BE TYPED

State of Kansas

CARD MUST BE SIGNED

NOTICE OF INTENTION TO DRILL

(see rules on reverse side)

Expected Spud Date 10-15-87
month day year

API Number 15-151-21,859-00-00

OPERATOR: License # 5046
Name Raymond Oil Company, Inc.
Address P. O. Box 48788
City/State/Zip Wichita, Kansas 67201
Contact Person Pat Raymond
Phone 316/267-4214

N/2 NW SE Sec. 17 Twp. 29 S, Rg. 15 East
2310 West
1980 Ft. from South Line of Section
Ft. from East Line of Section

(Note: Locate well on Section Plat on reverse side)

CONTRACTOR: License # 5929
Name Duke Drilling Company, Inc.
City/State Wichita, Kansas 67202

Nearest lease or unit boundary line 330 feet
County Pratt
Lease Name Perdue Well # 1 "B"
Ground surface elevation Est. 2040 feet MSL
Domestic well within 330 feet: no yes no
Municipal well within one mile: no yes no
Depth to bottom of fresh water 90'
Depth to bottom of usable water 250' 200'
Surface pipe by Alternate: 1 X 2
Surface pipe planned to be set 325±
Conductor pipe required none
Projected Total Depth 4950 feet
Formation Arbuckle

Well Drilled For: Well Class: Type Equipment:
 Oil Storage Infield Mud Rotary
 Gas Inj Pool Ext. Air Rotary
 OWWO Expl Wildcat Cable

If OWWO: old well info as follows:

Operator
Well Name
Comp Date Old Total Depth

I certify that well will comply with K.S.A. 55-101, et seq., plus eventually plugging hole to KCC specifications.

Date 9-22-87 Signature of Operator or Agent Pat Raymond Title Vice President

For KCC Use:

Conductor Pipe Required _____ feet; Minimum Surface Pipe Required 220 feet per Alt.
This Authorization Expires 10-6-88 effective Approved By Pat Raymond 10-6-87

Must be filed with the K.C.C. five (5) days prior to commencing well
 This card void if drilling not started within six (6) months of date received by K.C.C.

Important procedures to follow:

A Regular Section of Land
 1 Mile = 5,280 Ft.

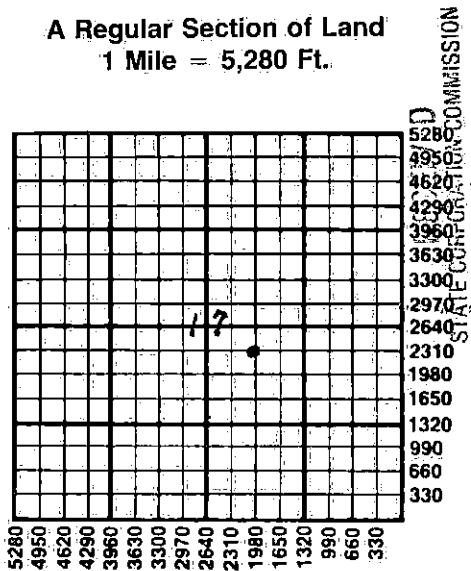

STATE CORPORATION COMMISSION
 CONSERVATION DIVISION
 Wichita, Kansas
 Rec'd OCT 6 1987
 10-6-87

1. Notify District office before setting surface casing.
2. Set surface casing by circulating cement to the top.
3. File completion forms ACO-1 with K.C.C. within 120 days of well spud date, following instructions on ACO-1, side 1, and including copies of wireline logs.
 Notify District office 48 hours prior to old well workover or re-entry.
 Prior to filing Intent, prepare a proposed plugging plan in case well is D & A, then obtain approval of plan when calling district office prior to setting surface pipe.
6. Submit plugging report (CP-4) to K. C. C. after plugging is completed.
7. Obtain an approved injection docket number before disposing of salt water.
8. Notify K.C.C. within 10 days when injection commences or terminates.
9. If an alternate 2 completion, cement in the production pipe from below any usable water to surface within 120 days of spud date.

State Corporation Commission of Kansas
 Conservation Division
 200 Colorado Derby Building
 Wichita, Kansas 67202-1212
 (316) 263-3236