

CARD MUST BE TYPED

State of Kansas
NOTICE OF INTENTION TO DRILL

1948
CARD MUST BE SIGNED

(see rules on reverse side)

Starting Date: 12-28-84
month day year

API Number 15- 151-21,545-00-00

OPERATOR: License # 5313
Name F & M OIL CO., INC.

SE NW SW Sec 21 Twp 26 S, Rge 13W East
(location) West

Address 422 Union Center

City/State/Zip Wichita, Kansas 67202

Contact Person Debra FitzGerald

Phone (316)262-2636

1650 Ft North from Southeast Corner of Section

4290 Ft West from Southeast Corner of Section

(Note: Locate well on Section Plat on reverse side)

CONTRACTOR: License # 5103
Name Union Drilling Co., Inc.

Nearest lease or unit boundary line 990 feet.

County Pratt

Lease Name Frisbie "C" Well# 1

City/State Wichita, Kansas 67202

Well Drilled For: Well Class: Type Equipment:

- Oil Swd Infield Mud Rotary
- Gas Inj Pool Ext. Air Rotary
- OWWO Expl Wildcat Cable

Domestic well within 330 feet: yes no

Municipal well within one mile: yes no

If OWWO: old well info as follows:

Operator N/A

Well Name -----

Comp Date ----- Old Total Depth -----

Projected Total Depth 4575' feet

Projected Formation at TD Arbuckle

Expected Producing Formations Lns./KC

Depth to Bottom of fresh water 190 feet

Lowest usable water formation Top Permian

Depth to Bottom of usable water 300 feet

Surface pipe by Alternate: 1 2

Surface pipe to be set 400 feet

Conductor pipe if any required ----- feet

Ground surface elevation ----- feet MSL

This Authorization Expires 6-21-85

Approved By 12-21-84 *Debra FitzGerald*

I certify that we will comply with K.S.A. 55-101, et seq., plus eventually plugging hole to K.C.C. specifications.

Date 12-20-84 Signature of Operator or Agent

Debra FitzGerald

Petroleum Geologist

Form C-1 4/84

mhc/DOHE 12/21/84

Must be filed with the K.C.C. five (5) days prior to commencing well
This card void if drilling not started within six (6) months of date received by K.C.C.

Important procedures to follow :

A Regular Section of Land
1 Mile = 5,280 Ft.

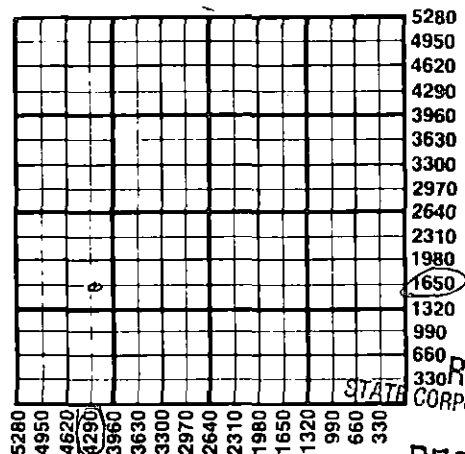

1. Notify District office before setting surface casing.
2. Set surface casing by circulating cement to the top.
3. File completion forms ACO-1 with K.C.C. within 90 days of well completion, following instructions on ACO-1, side 1, and including copies of wireline logs.
4. Notify District office 48 hours prior to old well workover or re-entry.
5. Prior to plugging, prepare a plugging plan, then obtain agreement from the appropriate district office for an approved plugging plan.
6. Submit plugging report (CP-4) to K.C.C. after plugging is completed.
7. Obtain an approved injection docket number before disposing of salt water.
8. Notify K.C.C. within 10 days when injection commences or terminates.
9. If an alternate 2 completion, cement in the production pipe from below any usable water to surface within 120 days of spud date.

RECEIVED
CORPORATION COMMISSION

DEC 21 1984
12-21-84
CONSERVATION DIVISION
Wichita, Kansas

State Corporation Commission of Kansas
Conservation Division
200 Colorado Derby Building
Wichita, Kansas 67202
(316) 263-3238