

Look for Lost Circ Zone 600-800

RECEIVED
STATE CORPORATION COMMISSION

* For KCC Use:
Effective Date: 1-29-02
District # _____
SGA? Yes No

KANSAS CORPORATION COMMISSION
OIL & GAS CONSERVATION DIVISION

JAN 23 2002
1-23-02

Form C-1
September 1999
Form must be Typed
Form must be Signed
All blanks must be Filled

NOTICE OF INTENT TO DRILL

CONSERVATION DIVISION

Must be approved by KCC five (5) days prior to commencing wellfichita, Kansas

Expected Spud Date January 28 2002
month day year

Spot NW - SE - NE Sec. 14 Twp. 26 S. R. 13 East West
3630 feet from (S) / N (circle one) Line of Section
990 feet from (E) / W (circle one) Line of Section

OPERATOR: License# 9408
Name: Trans Pacific Oil Corporation
Address: 100 S. Main, Suite 200
City/State/Zip: Wichita, Kansas 67202
Contact Person: Alan D. Banta
Phone: 316-262-3596

Is SECTION Regular Irregular?

(Note: Locate well on the Section Plat on reverse side)

CONTRACTOR: License# 5929
Name: Duke Drilling Co., Inc.

County: Pratt
Lease Name: Shupe "A" Well #: 1-14
Field Name: Wildcat

Is this a Prorated / Spaced Field? Yes No

Target Formation(s): Lansing, Mississippi

Nearest Lease or unit boundary: 990'

Ground Surface Elevation: 1920 est. feet MSL

Water well within one-quarter mile: Yes No

Public water supply well within one mile: Yes No

Depth to bottom of fresh water: 180

Depth to bottom of usable water: 200

Surface Pipe by Alternate: X 1 2

Length of Surface Pipe Planned to be set: 240

Length of Conductor Pipe required: NA

Projected Total Depth: 4420'

Formation at Total Depth: Arbuckle

Water Source for Drilling Operations:
Well X Farm Pond _____ Other _____

DWR Permit #: Duke Drilling will apply for permit.

(Note: Apply for Permit with DWR)

Will Cores be taken? Yes No

If Yes, proposed zone: LOOK FOR LOST CIRC. ZONE 600-800 feet.

AFFIDAVIT

The undersigned hereby affirms that the drilling, completion and eventual plugging of this well will comply with K.S.A. 55-101, et. seq.
It is agreed that the following minimum requirements will be met:

1. Notify the appropriate district office **prior** to spudding of well;
2. A copy of the approved notice of intent to drill **shall be** posted on each drilling rig;
3. The minimum amount of surface pipe as specified below **shall be set** by circulating cement to the top; in all cases surface pipe **shall be set** through all unconsolidated materials plus a minimum of 20 feet into the underlying formation.
4. If the well is dry hole, an agreement between the operator and the district office on plug length and placement is necessary **prior to plugging**;
5. The appropriate district office will be notified before well is either plugged or production casing is cemented in;
6. If an ALTERNATE II COMPLETION, production pipe shall be cemented from below any usable water to surface within **120 days** of spud date. **In all cases, NOTIFY district office** prior to any cementing.

I hereby certify that the statements made herein are true and to the best of my knowledge and belief.

Date: 1/23/02 Signature of Operator or Agent: [Signature] Title: Executive Vice-President

For KCC Use ONLY

API # 15 - 151-22188-0000

Conductor pipe required NONE feet

Minimum surface pipe required 240 feet per Alt. (1)

Approved by: RJP 1-24-2002

This authorization expires: 7-24-2002
(This authorization void if drilling not started within 6 months of effective date.)

Spud date: _____ Agent: _____

Remember to:

- File Drill Pit Application (form CDP-1) with Intent to Drill;
- File Completion Form ACO-1 within 120 days of spud date;
- File acreage attribution plat according to field proration orders;
- Notify appropriate district office 48 hours prior to workover or re-entry;
- Submit plugging report (CP-4) after plugging is completed;
- Obtain written approval before disposing or injecting salt water.

14
26
13

JAN 23 2002

IN ALL CASES PLOT THE INTENDED WELL ON THE PLAT BELOW

Plat of acreage attributable to a well in a prorated or spaced field

CONSERVATION DIVISION
Wichita, Kansas

If the intended well is in a prorated or spaced field, please fully complete this side of the form. If the intended well is in a prorated or spaced field complete the plat below showing that the well will be properly located in relationship to other wells producing from the common source of supply. Please show all the wells and within 1 mile of the boundaries of the proposed acreage attribution unit for gas wells and within 1/2 mile of the boundaries of the proposed acreage attribution unit for oil wells.

API No. 15 - _____
Operator: _____
Lease: _____
Well Number: _____
Field: _____

Location of Well: County: _____
3630 _____ feet from S / N (circle one) Line of Section
990 _____ feet from E / W (circle one) Line of Section
Sec. 14 Twp. 26 S. R. 13 East West

Number of Acres attributable to well: _____
QTR / QTR / QTR of acreage: NW - SE - NE

Is Section Regular or _____ Irregular

If Section is Irregular, locate well from nearest corner boundary.
Section corner used: ___NE ___NW ___SE ___SW

PLAT

*(Show location of the well and shade attributable acreage for prorated or spaced wells.)
(Show footage to the nearest lease or unit boundary line.)*

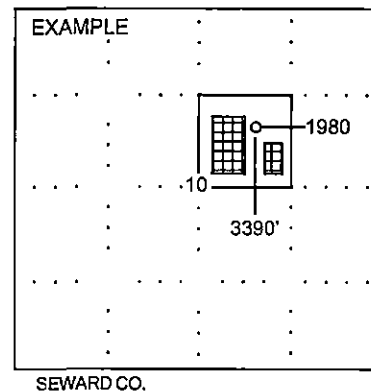
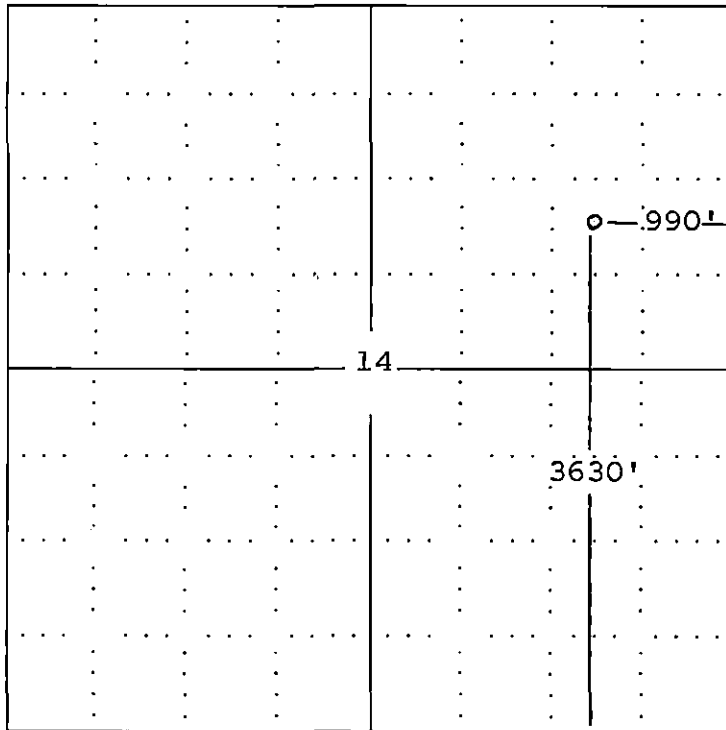

NOTE: In all cases locate the spot of the proposed drilling location.

In plotting the proposed location of the well, you must show:

1. The manner in which you are using the depicted plat by identifying section lines, i.e. 1 section, 1 section with 8 surrounding sections, 4 sections, etc.
2. The distance of the proposed drilling location from the section's south / north and east / west.
3. The distance to the nearest lease or unit boundary line.
4. If proposed location is located within a prorated or spaced field a certificate of acreage attribution plat must be attached: (C0-7 for oil wells; CG-8 for gas wells).