

STATE OF KANSAS
STATE CORPORATION COMMISSION

WELL PLUGGING RECORD

Give ALL Information Completely
Make Required Affidavit
Mail or Deliver Report to:
Conservation Division
State Corporation Commission
800 Bittling Building
Wichita, Kansas

PRATT County. Sec. 36 Twp. 29 Rge. 14 (X) (W)

Location as "NE/CNW $\frac{1}{4}$ SW $\frac{1}{4}$ " or footage from lines 660' FROM W. LINE & 330' FROM S LINE

Lease Owner R. W. RINE DRILLING COMPANY, ETAL

Lease Name EARLYWINE Well No. 3

Office Address 320 CENTRAL BUILDING

Character of Well (completed as Oil, Gas or Dry Hole) OIL WELL

Date well completed 12-21 19 48

Application for plugging filed 5-8 19 52

Application for plugging approved 5-10 19 52

Plugging commenced 5-8 19 52

Plugging completed 5-12 19 52

Reason for abandonment of well or producing formation WELL QUIT PRODUCING

If a producing well is abandoned, date of last production SEPTEMBER 19 51

Was permission obtained from the Conservation Division or its agents before plugging was commenced? YES

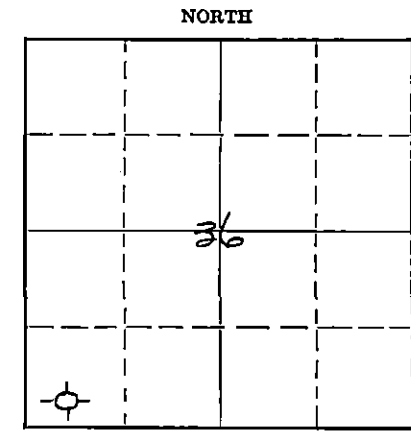

Locate well correctly on above Section Plat

Name of Conservation Agent who supervised plugging of this well M. A. RIVES

Producing formation SIMPSON SAND Depth to top 4524 Bottom 4510 Total Depth of Well 4575 Feet

Show depth and thickness of all water, oil and gas formations.

OIL, GAS OR WATER RECORDS

CASING RECORD

Formation	Content	From	To	Size	Put In	Pulled Out
WATER SAND	WATER	60	90	8-5/8"	358'	-
KANS. CITY LANSING	DRY	3989	4357			
MISS. Ls.	DRY	4386	4404			
VIOLA	DRY	4420	4499			
SIMPSON SHALE	DRY	4499	4510			
SIMPSON SAND	OIL	4510	4570	5 1/2"	4570'	3310

Describe in detail the manner in which the well was plugged; indicating where the mud fluid was placed and the method or methods used in introducing it into the hole. If cement or other plugs were used, state the character of same and depth placed, from _____ feet to _____ feet for each plug set.

SANDED HOLE FROM 4412' TO 3850' AND RAN 5 SACKS CEMENT. BAILED OFF FLUID. MUDDED HOLE FROM 3800' TO 300'. SET 10' ROCK BRIDGE AND RAN 15 SACKS CEMENT. MUDDED HOLE TO 35', SET ROCK BRIDGE AND RAN 10 SACKS CEMENT.

RECEIVED
STATE CORPORATION COMMISSION
MAY 26 1952
CONSERVATION DIVISION
Wichita, Kansas

Correspondence regarding this well should be addressed to R. W. RINE DRILLING COMPANY
Address 320 CENTRAL BUILDING, WICHITA, KANSAS.

STATE OF KANSAS, COUNTY OF SEDGWICK, ss.
E. H. SLOYER (employee of owner) or (owner or operator) of the above-described well,

being first duly sworn on oath, says: That I have knowledge of the facts, statements, and matters herein contained and the log of the above-described well as filed and that the same are true and correct. So help me God.

(Signature) E. H. Sloyer
SAME (Address)

SUBSCRIBED AND SWORN TO before me this 24th day of May, 19 52

(Signature) D. M. Green
Notary Public.

My commission expires Dec 29, 1952

PLUGGING
FILE SEC 36 T 29 R 14W
BOOK PAGE 15 LINE 1

Earlywine Well No. 3

S/2 SW/4 SW/4
Sec. 36-29S-14W
Pratt County, Kansas

Contractor: The R. W. Rine Drilling Company
Started: 11-28-48 Finished: 12-18-48

Log

Soil, sand	0-	40	
Shale	40-	185	
Red bed, red rock	185-	470	8-5/8" @ 358' w/ 255' sx.
Red rock, shale	470-	930	
Shale, shells	930-	1210	
Shale	1210-	1365	
Shale, shells	1365-	1940	
Shale, lime	1940-	2445	
Shale, sand, lime	2445-	2555	
Lime, shale	2555-	2775	
Shale	2775-	2935	
Shale, shells	2935-	3090	
Shale, lime	3090-	3173	
Shale	3173-	3230	
Lime	3230-	3260	
Shale, lime	3260-	4060	
Lime	4060-	4165	
Lime, shale	4165-	4543	
Sand, shale	4543-	4569	
Sand, lime, shale	4569-	4575	5 1/2" w/ 200' sx. @ 4570' TD. 4575'

State of Kansas)
County of Sedgwick) ss

I, E. H. Sloyer, do hereby certify that the above is a true and accurate log of the Earlywine No. 3 well located in the S/2 of the SW/4 of the SW/4 of Sec. 36-29S-14W, Pratt County, Kansas.

E. H. Sloyer
Secretary

Sworn to and subscribed before me this 21st day of November, 1949.

J. M. Green
Notary Public

My commission expires Dec. 29, 1952

RECEIVED
STATE CORPORATION COMMISSION
MAY 10 1952
CONSERVATION DIVISION
Wichita, Kansas

5-10-52

PLUGGING
FILE SEC 36-29-14W
BOOK PAGE 15 LINE 1