

11/16/85  
11-16-86

STATE CORPORATION COMMISSION OF KANSAS  
OIL & GAS CONSERVATION DIVISION

WELL COMPLETION OR RECOMPLETION FORM  
ACO-1 WELL HISTORY

DESCRIPTION OF WELL AND LEASE

Operator: License # 5171  
Name TXO Production Corp.  
Address 155 N. Market, Suite 1000  
City/State/Zip Wichita, Kansas 67202

Operator Contact Person Harold R. Trapp  
Phone (316) 269-7600

Contractor: License # 5829  
Name Aldebaran Drilling Co.

Wellsite Geologist William Stobbe  
Phone 722-9327

PURCHASER Purchaser not yet determined

Designate Type of Completion

- New Well  Re-Entry  Workover
- Oil  SWD  Temp Abd
- Gas  Inj  Delayed Comp.
- Dry  Other (Core, Water Supply etc.)

If ONWO: old well info as follows:

Operator  
Well Name  
Comp. Date Old Total Depth

WELL HISTORY

Drilling Method:

- Mud Rotary  Air Rotary  Cable

8-1-85 8-8-85 8-16-85  
Spud Date Date Reached TD Completion Date  
4921' 4907'  
Total Depth PBTD

Amount of Surface Pipe Set and Cemented at 8-5/8" @ 371' feet

Multiple Stage Cementing Collar Used?  Yes  No  
If yes, show depth set feet

If alternate 2 completion, cement circulated from feet depth to feet depth

API NO. 15-151-21,662-0000  
County Pratt  
NW/4 Sec 17 Twp 29S Rge 15  East  West

4950 Ft North from Southeast Corner of Section  
4950 Ft West from Southeast Corner of Section  
(Note: Locate well in section plat below)

Lease Name KERR ESTATE "A" Well # 1

Field Name Springvale S.W. Northeast

Producing Formation Viola

Elevation: Ground 2052' KB 2059'

Section Plat

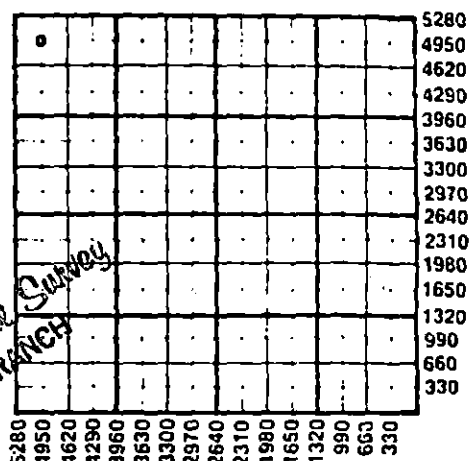

WATER SUPPLY INFORMATION

Source of Water: N/A  
Division of Water Resources Permit #

Groundwater Ft North from Southeast Corner (Well) Sec Twp Rge  East  West

Surface Water Ft North from Southeast Corner (Stream, pond etc) Ft West from Southeast Corner Sec Twp Rge  East  West

Other (explain) (purchased from city, R.W.D.)

Disposition of Produced Water:  Disposal  Repressuring

Docket # None

INSTRUCTIONS: This form shall be completed in duplicate and filed with the Kansas Corporation Commission, 200 Colorado Derby Building, Wichita, Kansas 67202, within 90 days after completion or recompletion of any well. Rule 82-3-130 and 82-3-107 apply.

Information on side two of this form will be held confidential for a period of 12 months if requested in writing and submitted with the form. See rule 82-3-107 for confidentiality in excess of 12 months. One copy of all wireline logs and drillers time log shall be attached with this form. Submit CP-4 form with all plugged wells. Submit CP-111 form with all temporarily abandoned wells.

All requirements of the statutes, rules and regulations promulgated to regulate the oil and gas industry have been fully complied with and the statements herein are complete and correct to the best of my knowledge.

Signature Harold R. Trapp  
Title District Geologist Date 10-9-85

Subscribed and sworn to before me this 22nd day of October 1985

Notary Public Nancy K. Gastineau  
Date Commission Expires January 30, 1988

Nancy K. Gastineau  
NOTARY PUBLIC  
State of Kansas  
Exp. Expires 1-30-88

Rec'd 10-24-85

K.C.C. OFFICE USE ONLY  
 Letter of Confidentiality Attached  
 Wireline Log Received  
 Drillers Timelog Received  
Distribution  
 KCC  SWD/Rep  NGPA  
 KGS  Plug  Other (Specify)

TXO Production Corp. Kerr Estate "A" #1  
 Operator Name ..... Lease Name ..... Well# ..... SEC. 17 TWP. 29S RGE. 15  East  West

WELL LOG

INSTRUCTIONS: Show important tops and base of formations penetrated. Detail all cores. Report all drill stem tests giving interval tested, time tool open and closed, flowing and shut-in pressures, whether shut-in pressure reached static level, hydrostatic pressures, bottom hole temperature, fluid recovery, and flow rates if gas to surface during test. Attach extra sheet if more space is needed. Attach copy of log.

Drill Stem Tests Taken  Yes  No  
 Samples Sent to Geological Survey  Yes  No  
 Cores Taken  Yes  No

Formation Description  
 Log  Sample

Name	Top	Bottom
Heebner	3973	-1914
Brown Lime	4136	-2077
Lansing	4149	-2090
Dennis	4402	-2343
Swope	4443	-2384
Hertha	4481	-2422
BKC	4520	-2461
Marmaton	4534	-2475
Cherokee	4634	-2575
Kinderhook "D"	4698	-2639
Viola	4757	-2698
Viola Dolomite Pay	4802	-2743
Simpson Shale	4834	-2775
Simpson Sand	4850	-2791

CONFIDENTIAL  
 RELEASED  
 DEC 22 1987

CASING RECORD <input checked="" type="checkbox"/> New <input type="checkbox"/> Used				FROM CONFIDENTIAL			
Report all strings set-conductor, surface, intermediate, production, etc.							
Purpose of String	Size Hole Drilled	Size Casing Set (in O.D.)	Weight Lbs/Ft.	Setting Depth	Type of Cement	#Sacks Used	Type and Percent Additives
Surface	12-1/4"	8-5/8"	23#	371'	175 sxs. White t.	125 sxs. Class. "A"	
Production	7-7/8"	5-1/2"	14#	4920'	150 sxs. Surefill	w/10# Gilsonite	
PERFORATION RECORD				Acid, Fracture, Shot, Cement Squeeze Record			
Shots Per Foot	Specify Footage of Each Interval Perforated			Amount and Kind of Material Used			Depth
4 (40 holes)	4800-10' Viola						4800-10'
TUBING RECORD				Liner Run <input type="checkbox"/> Yes <input checked="" type="checkbox"/> No			
Date of First Production		Producing Method					
8-16-85		<input type="checkbox"/> Flowing <input checked="" type="checkbox"/> Pumping <input type="checkbox"/> Gas Lift <input type="checkbox"/> Other (explain).....					
Estimated Production Per 24 Hours		Oil	Gas	Water	Gas-Oil Ratio		Gravity
No gauge		No gauge	0 MCFD	No gauge			
		Bbls	MCF	Bbls	CFPB		

METHOD OF COMPLETION Production Interval

Disposition of gas:  Vented  Open Hole  Perforation 4800-10'  
 Sold  Other (Specify) .....  
 Used on Lease  Dually Completed .....  
 Commingled .....

MM DD YY  
8 8 85

CONTRACT NO. 283572

DIRECT CORRESPONDENCE TO: P.O. BOX 4442 HOUSTON, TX 77210  
NET: 30 DAYS FROM DATE OF CONTRACT  
P.O. BOX 200416 HOUSTON, TX 77216

ORDER NO.

**CUSTOMER**  
NAME: TXO  
ADDRESS:  
CITY:  
STATE:  
ZIP CODE:  
AUTHORIZED BY: Gornall

**DESCRIPTION OF WELL**  
WELL NO.:  
OIL / GAS: /  
NEW / OLD: /  
STATE: KS  
COUNTY/PARISH: /  
LEASE NAME: /  
FIELD NAME: /  
OWNER: /  
MR. DISTRICT: /

**JOB INFORMATION**  
ARRIVED: 10:00 AM 8/8/85  
RELEASED: 4:00 PM 8/8/85  
JOB CODE: /  
TYPE OF JOB: Production  
API OR IC NO.: /  
AVG. PSI: /  
BUSINESS CODE: /  
INJ. RATE (BPM): /  
WORKING WELL DEPTH: 4920'

LEASE LINES:  
SURVEY LINES: CONFIDENTIAL  
SURVEY: Hole 1927.0A 4942 Set 4920 Sk 20.5 375.718  
DIRECTIONS TO LOCATION: /  
SECTION, TOWNSHIP, RANGE: 17 29 15  
QUADRANT: Med Lodge

**DIST. NO.** 33-105  
**DISTRICT NAME** Mod. Lodge  
**LEASING** 131

**CONTRACT CONDITIONS**

This contract must be signed before the job is started or merchandise delivered. The undersigned is authorized to execute this contract as an Agent of the Customer. As such, the undersigned acknowledges that this contract for services, materials, products and/or supplies includes all of and only those terms and conditions appearing on the front and back of this document. No additional substitute terms and/or conditions shall become a part of this contract without the written consent of an Officer of BJ-TITAN SERVICES COMPANY.

SIGNED: *[Signature]*  
(WELL OWNER: OPERATOR, CONTRACTOR OR AGENT)

PRICE BOOK REF. NO.	SERVICES/MATERIAL	UM	QUANTITY	PRICE	EXTENSION
01 10100320	Pipe of into 3000'		3000'	86200	86200
02 10100325	Other ches to 4920'		1920'	.09/ft.	172 80
03 10109005	Pumpkin Lodge - P-att		21 n.les	1.50/m.	31 50
04 10410504	Class A	105	150 sk.	5.00/sk.	750 00
05 10415050	Galv		14 sk.	23/16.	32 43
06 10420045	Galv 1 1/2" + 1 sk		1 sk	6.25/sk	6 27
07 10415048	KCL		199 #	20/16.	39 80
08 10422030	Fl check		440 gals	1.75/gal	770 00
09 10415080	D70		1500 #	32/16.	480 00
10 10980095	D4H		150 sk.	.92/sk.	138 00
11 10940175	BTM - Med Lodge		7.2 ton	.68/ton	
12 10430520	Plug - Top Rubber		1-5 1/2"	31 00	31 00
13 10433014	Insert - Arrow		1-5 1/2"	162 00	162 00
14 10433051	Centralizers - Baker		6-5 1/2"	46 80	280 80
15 10432045	Rocket - Arrow		1-5 1/2"	121 50	121 50
16					

SERVICE REPRESENTATIVE: *[Signature]*  
PR. BOOK: 7  
The above material and service ordered by the Customer and received by: *[Signature]*  
(WELL OWNER, OPERATOR, CONTRACTOR OR AGENT)

**BJ-TITAN SERVICES COMPANY**

ORIGINAL

INVOICE DATE

07/31/85

DIRECT BILLING INQUIRIES TO: <i>13-295-5221</i>	TERMS NET AMOUNT DUE TO PAYS FROM DATE OF INVOICE	REMIT TO: BJ-TITAN SERVICES P.O. BOX 200415 HOUSTON, TX - 77216
--	--	--

PAGE 1	INVOICE NO. 283408
-----------	-----------------------

TXO PRODUCTION CORPORATION  
BOX 329  
MEDICINE LODGE KS  
67104

**CONFIDENTIAL**

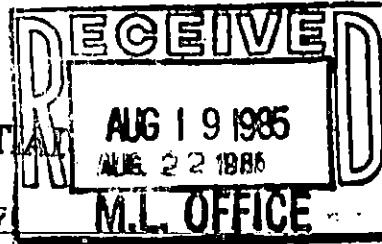

AUTHORIZED BY GERRY PARIS
------------------------------

PURCH. ORDER REF. NO.
-----------------------

07903027

LEASE NAME AND NUMBER KERR ESTATE/PPATT C A-1	STATE KS	COUNTY/PARISH BARBER	CITY	DISTRICT NAME MEDICINE LOD	DISTR. NO. 33105
JOB LOCATION/FIELD	MTA DISTRICT	DATE OF JOB 07/31/85	TYPE OF SERVICE LAND-CONDUCTOR/SURFACE		

PRODUCT NUMBER	QUANTITY	DESCRIPTION	UNIT PRICE	U/M	EXTENDED PRICE
10100305	1.00	CEMENTING CASING 300 TO 1500 FT.	370.00	00	370.00
10100310	74.00	PLUS PER FOOT BELOW 300 FT.	0.41	00	30.34
10109005	26.00	MILEAGE CHRG, FROM NEAREST CASE OF	1.50	HR	39.00
10410504	125.00	CLASS A	5.00	CF	625.00
10415005	175.00	LITE	4.30	CF	752.50
10415048	8.15	CALCIUM CHLORIDE, FLAKE	23.00	SX	187.45
10420145	2.35	BJ-TITAN GEL, BENTONITE, BULK SALES	6.75	CF	15.86
10430530	1.00	8-5/8" TOP RUBBER PLUG	58.00	EA	58.00
10433053	1.00	MODEL M CASING GENT 8-5/8"	58.50	EA	58.50
10880095	300.00	HANDLING AND DUMPING CHRG FOR CEMENT	0.68	00	276.00
10940115	366.60	HAULING BULK CEMENT	0.68	00	249.29

*NOV 26 1985*  
*State Geological Survey*  
*WICHITA BRANCH*

**KANSAS**

CHARGE TO: <i>Kerr Estate A#1</i>	AFE - PROJECT <i>852602</i>
USED FOR: <i>233-Cementing</i>	

AUG 25 1985

Administration  
Texas Oil & Gas Corp.

Wichita

ACCOUNT	3.000000 STATE TAX	00	1494.00	44.84
	1.000000 (DRUG) COMP, L&W W/O OPER OTHER	00	1494.00	14.93

TAX EXEMPTION STATUS:

PAY THIS AMOUNT

2721.68

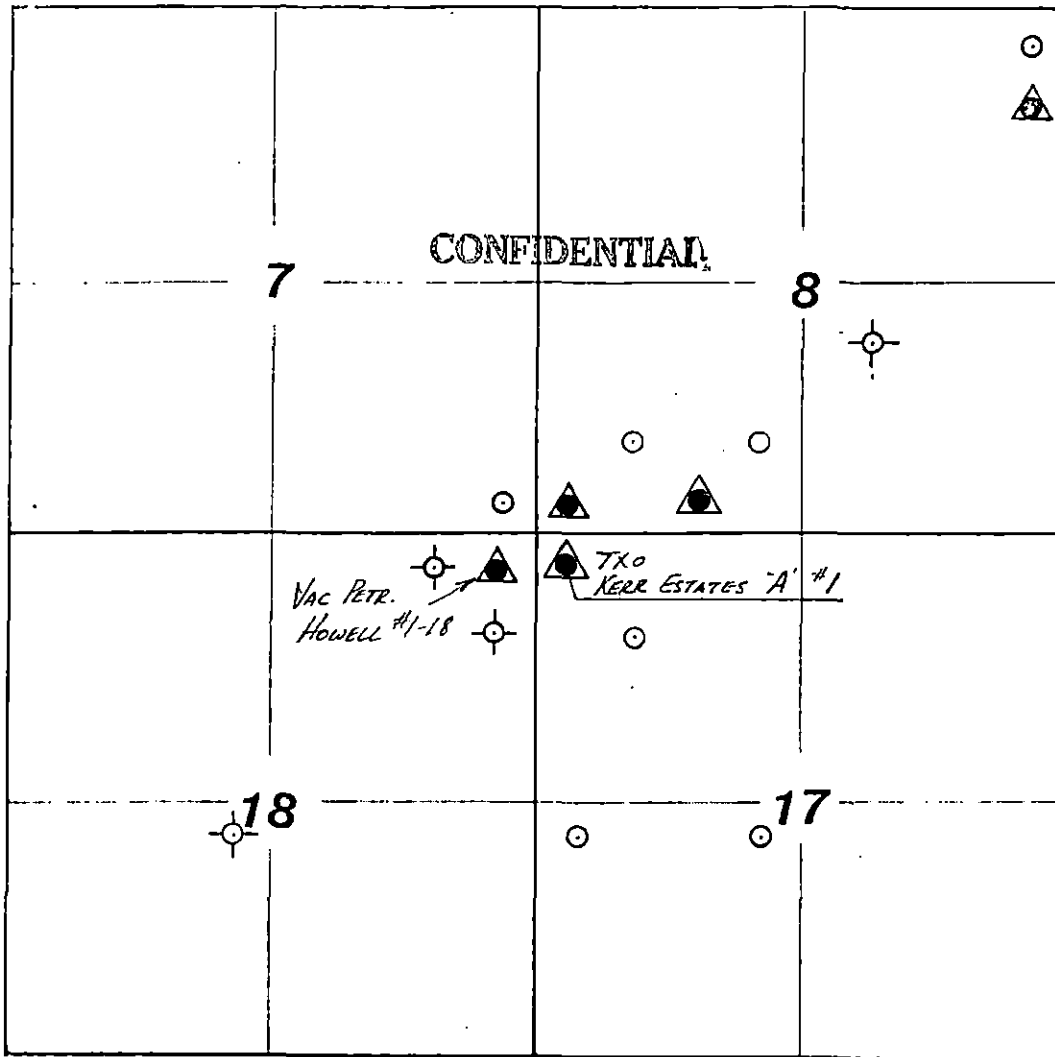

T29S R15W

NOV 26 1985

State Geological Survey  
WICHITA BRANCH

**LEGEND**

- |  |   |  |
|--|---|--|
| <ul style="list-style-type: none"> <li>/ - SCOUT TICKET (ST)</li> <li>Y - SAMPLE LOG (SL) B ST</li> <li>⊕ - ELECTRIC LOG (EL) B ST B SL</li> <li>N/R - NOT REPORTED</li> <li>N/P - NOT PENETRATED</li> <li>Abst - ABSENT</li> <li>NEI - NOT ENOUGH INFORMATION</li> <li>NCE - NOT DEEP ENOUGH</li> <li>----- PIPE LINE</li> <li>- X-SECTION TRACE</li> <li>MAP NO. _____ OF _____</li> </ul> | <p><b>PRODUCTION ZONES</b></p> <p><u>VIOLA</u> </p> <p></p> <p></p> <p></p> <p></p> <p></p> | <ul style="list-style-type: none"> <li> - TXO PROPERTY</li> <li> - RECOMMENDED ACREAGE</li> <li> - DRILLING WELL</li> <li> - OIL WELL</li> <li> - GAS WELL</li> <li> - OIL/GAS WELL</li> <li> - DRY/ABANDONED WELL</li> <li> - WATER DEPOSIT WELL</li> <li> - INJECTION WELL</li> <li> - PROPOSED LOCATION</li> <li> - PLUGGED PRODUCER</li> </ul> |
|--|---|--|

<p><b>TXO PRODUCTION CORP.</b> KANSAS DISTRICT WICHITA, KANSAS</p> <p><small>A Subsidiary of Texas Oil &amp; Gas Corp</small></p>	<p>PROSPECT <u>BRYANT</u></p> <p>COUNTY <u>PRATT</u></p> <p>PROPOSED LOCATION _____</p>
	<p>MAP _____ DATUM _____</p> <p>CONTOUR INTERVAL _____ TEST FORMATION <u>VIOLA</u></p> <p>GEOLOGIST <u>D. FLINN</u> PTD <u>4950</u> DATE <u>8-85</u></p>