

STATE CORPORATION COMMISSION OF KANSAS
OIL & GAS CONSERVATION DIVISION
WELL COMPLETION OR RECOMPLETION FORM
ACO-1 WELL HISTORY
DESCRIPTION OF WELL AND LEASE

S

API No. 15-151-21-815-00-00
County Pratt
SE SW SW Sec. 8 Twp. 29S Rge. 15 East
X West

Operator: License # 5046
Name Raymond Oil Company, Inc.
Address P. O. Box 48788
Wichita, Kansas 67201
City/State/Zip

330 Ft North from Southeast Corner of Section
4290 Ft West from Southeast Corner of Section
(Note: Locate well in section plat below)

Purchaser

Lease Name Watson Well # 3

Operator Contact Person Pat Raymond
Phone 316/267-4214

Field Name North Kroft

Producing Formation

Contractor: License # 5829
Name Aldebaran Drilling Co., Inc.

Elevation: Ground 2053 KB 2061

Wellsite Geologist Timothy D. Hellman
Phone 316/267-4214

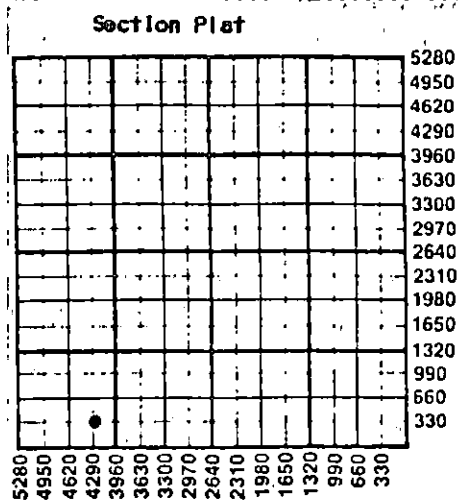

Designate Type of Completion
X New Well Re-Entry Workover
Oil SWD Temp Abd
Gas Inj Delayed Comp.
X Dry Other (Core, Water Supply etc.)

WATER SUPPLY INFORMATION

If OWNED: old well info as follows:
Operator
Well Name
Comp. Date Old Total Depth

Disposition of Produced Water: Disposal
Docket # Repressuring

WELL HISTORY

Drilling Method:
X Mud Rotary Air Rotary Cable

Questions on this portion of the ACO-1 call:
Water Resources Board (913) 296-3717

11-16-86 11-25-86 11-25-86
Spud Date Date Reached TD Completion Date
4865' PBDT
Total Depth

Source of Water:
Division of Water Resources Permit #
X Groundwater Ft North from Southeast Corner
(Well) Ft West from Southeast Corner of
Sec Twp Rge East West
Surface Water Ft North from Southeast Corner
(Stream, pond etc) Ft West from Southeast Corner
Sec Twp Rge East West
Other (explain)
(purchased from city, R.W.D. #)

INSTRUCTIONS: This form shall be completed in triplicate and filed with the Kansas Corporation Commission, 200 Colorado Derby Building, Wichita, Kansas, 67202, within 120 days of the spud date of any well. Rule 82-3-130, 82-3-107 and 82-3-106 apply. Information on side two of this form will be held confidential for a period of 12 months if requested in writing and submitted with the form. See rule 82-3-107 for confidentiality in excess of 12 months. One copy of all wireline logs and drillers time log shall be attached with this form. Submit CP-4 form with all plugged wells. Submit CP-111 form with all temporarily abandoned wells.

All requirements of the statutes, rules and regulations promulgated to regulate the oil and gas industry have been fully complied with and the statements herein are complete and correct to the best of my knowledge.

Signature Pat Raymond
Title Vice President Date 12-10-86

K.C.C. OFFICE USE ONLY
F Letter of Confidentiality Attached
C Wireline Log Received
C Drillers Timelog Received
Distribution
KCC SWD/Rep NGPA
KGS Plug Other
(Specify)

Subscribed and sworn to before me this 10th day of Dec 1986
Notary Public Shirley Wilkie
Date Commission Expires January 29 1988

STATE CORPORATION COMMISSION

DEC 11 1986
CONSERVATION DIVISION
Wichita, Kansas
12-11-86

Sec. 8, Twp. 29S, Rge. 15W

SIDE TWO

Operator Name Raymond Oil Company, Inc. Lease Name Watson Well # 3

Sec. 8 Twp. 29S Rge. 15 East West County Pratt

WELL LOG

INSTRUCTIONS: Show important tops and base of formations penetrated. Detail all cores. Report all drill stem tests giving interval tested, time tool open and closed, flowing and shut-in pressures, whether shut-in pressure reached static level, hydrostatic pressures, bottom hole temperature, fluid recovery, and flow rates if gas to surface during test. Attach extra sheet if more space is needed. Attach copy of log.

Drill Stem Tests Taken Yes No
 Samples Sent to Geological Survey Yes No
 Cores Taken Yes No

Formation Description
 Log Sample

DST #1: 4550' - 4655', 30-30-30-27, IFP 58-59, ISIP 67, FFP 67-68, FSIP 68, IHP 2238, FHP 2170. Temp. 121°. Recovered 20' mud.

Name	Top	Bottom
Base Florence	2585'	
Admire	3112'	
Stotler	3291'	
Heebner	3968'	
Brown Lime	4128'	
Marmaton	4533'	
Mississippi	Absent	
Kind. Chert	4725'	
Viola Dolomite	4818'	
Simpson Shale	4830'	
Simpson Sand	4844'	
Arbuckle	NR	
LTD	4861'	

CASING RECORD <input checked="" type="checkbox"/> New <input type="checkbox"/> Used							
Report all strings set-conductor, surface, intermediate, production, etc.							
Purpose of String	Size Hole Drilled	Size Casing Set (in O.D.)	Weight Lbs/Ft.	Setting Depth	Type of Cement	#Sacks Used	Type and Percent Additives
Surface	12 1/4"	8-5/8"	24#	373'	60-40 pct	275	2% Gel, 3% c.p.
PERFORATION RECORD				Acid, Fracture, Shot, Cement Squeeze Record			
Shots Per Foot	Specify Footage of Each Interval Perforated			(Amount and Kind of Material Used)		Depth	
TUBING RECORD				Liner Run	<input type="checkbox"/> Yes <input type="checkbox"/> No		
Date of First Production	Producing Method						
	<input type="checkbox"/> Flowing <input type="checkbox"/> Pumping <input type="checkbox"/> Gas Lift <input type="checkbox"/> Other (explain).....						
Estimated Production Per 24 Hours	Oil	Gas	Water	Gas-Oil Ratio	Gravity		
	Bbls	MCF	Bbls	CFPB			

METHOD OF COMPLETION

Production Interval

Disposition of gas: Vented Open Hole Perforation
 Sold Other (Specify)
 Used on Lease Dually Completed Commingled