

STATE CORPORATION COMMISSION OF KANSAS
OIL & GAS CONSERVATION DIVISION

WELL COMPLETION OR RECOMPLETION FORM
ACO-1 WELL HISTORY

DESCRIPTION OF WELL AND LEASE

Operator: License # 5063
Name Energy Exploration, Inc.
Address 1002 S. Broadway
City/State/Zip Wichita, KS 67211

Purchaser N/A

Operator Contact Person Brad Lehl
Phone (316) 267-7336

Contractor: License # 5107
Name H-30, Inc.

Wellsite Geologist Chris Dilts
Phone (316) 263-7092

Designate Type of Completion
 New Well Re-Entry Workover
 Oil SWD Temp Abd
 Gas Inj Delayed Comp.
 Dry Other (Core, Water Supply etc.)

If OWWO: old well info as follows:
Operator N/A
Well Name
Comp. Date Old Total Depth

WELL HISTORY

Drilling Method:
 Mud Rotary Air Rotary Cable
10-9-84 10-17-84 10-18-84
Spud Date Date Reached TD Completion Date
4500' PBDT
Total Depth

Amount of Surface Pipe Set and Cemented at 398 feet
Multiple Stage Cementing Collar Used? Yes No
If yes, show depth set...feet
If alternate 2 completion, cement circulated from...feet depth to...w/...SX cmt

API NO. 15-151-21,474-00-00
County Pratt
NW SW SE Sec. 33 Twp. 26 Rge. 13 East West

980 Ft North from Southeast Corner of Section
2310 Ft West from Southeast Corner of Section
(Note: Locate well in section plat below)

Lease Name Smith-Miller Well # 2
Field Name N/A
Producing Formation N/A
Elevation: Ground 1958 KB 1967
Section Plat

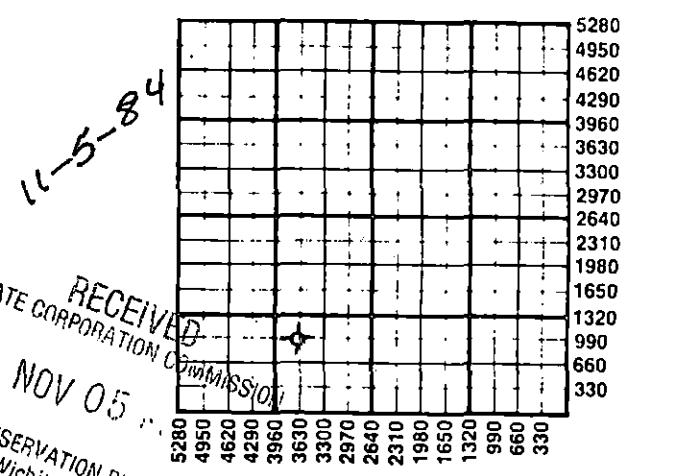

WATER SUPPLY INFORMATION
Disposition of Produced Water: Disposal Repressuring
Docket #

Questions on this portion of the ACO-1 call:
Water Resources Board (913) 296-3717
Source of Water:
Division of Water Resources Permit #
 Groundwater...Ft North from Southeast Corner (Well) ...Ft West from Southeast Corner of Sec Twp Rge East West
 Surface Water...Ft North from Southeast Corner (Stream, pond etc)...Ft West from Southeast Corner Sec Twp Rge East West
 Other (explain) (purchased from city, R.W.D. #)

INSTRUCTIONS: This form shall be completed in duplicate and filed with the Kansas Corporation Commission, 200 Colorado Derby Building, Wichita, Kansas 67202, within 90 days after completion or recompletion of any well. Rule 82-3-130 and 82-3-107 apply. Information on side two of this form will be held confidential for a period of 12 months if requested in writing and submitted with the form. See rule 82-3-107 for confidentiality in excess of 12 months. One copy of all wireline logs and drillers time log shall be attached with this form. Submit CP-4 form with all plugged wells. Submit CP-111 form with all temporarily abandoned wells.

All requirements of the statutes, rules and regulations promulgated to regulate the oil and gas industry have been fully complied with and the statements herein are complete and correct to the best of my knowledge.

Signature [Signature] Title Date 11-1-84

Subscribed and sworn to before me this 1st day of November 1984. Notary Public Donna C. Alvord Date Commission Expires 6-20-84

K.C.C. OFFICE USE ONLY
F Letter of Confidentiality Attached
C Wireline Log Received
C Drillers Timelog Received
Distribution
 KCC SWD/Rep NGPA
 KGS Plug Other (Specify)

Sec...Twp...Rge...

SIDE TWO

Operator Name Energy Exploration, Inc. Lease Name Smith-Miller Well # 2

Sec. 33 Twp. 26 Rge. 13 East West County Pratt

WELL LOG

INSTRUCTIONS: Show important tops and base of formations penetrated. Detail all cores. Report all drill stem tests giving interval tested, time tool open and closed, flowing and shut-in pressures, whether shut-in pressure reached static level, hydrostatic pressures, bottom hole temperature, fluid recovery, and flow rates if gas to surface during test. Attach extra sheet if more space is needed. Attach copy of log.

Drill Stem Tests Taken Yes No
 Samples Sent to Geological Survey Yes No
 Cores Taken Yes No

Formation Description
 Log Sample

DST #1 3150-64, 30-57-30-57, Rec. 625' of gas above fluid, 20' of sli. oil & gas cut mud, 2% gas; 8% oil; 90% mud, IFP 58-58, FFP 58-58 ISIP 580, FSIP 407, IHP 1478, FHP 1478, BHT 118 'F.

DST #2 3936-51, 30-60-55-60, Rec. 415' of gas above fluid, 25' of oil & gas cut mud, 5% gas 5% oil; 90% mud, 180' of salt water, IFP 56-73, FFP 111-138, ISIP 1065, FSIP 1029, IHP 2012, FHP 2012, BHT 121 'F.

DST #3 3988-4002, 30-60-40-30, Rec. 25' of drlg. mud w/sli. oil spotting, 40' of salt wtr., IFP 49-49, FFP 69-69, ISIP 1178, FSIP 580, IHP 1946, FHP 1918, BHT 122 'F.

DST #4 4263-82, 30-60-30-36, Rec. 15' of drlg. mud, IFP 23-23, FFP 29-34, ISIP 105, FSIP 80, IHP 2078, FHP 2078, BHT 124 'F.

Name	Top	Bottom
Sand & red bed	0'	399'
Red bed & shale	399'	1382'
Red bed, shale & lime	1382'	1810'
Shale & lime	1810'	2703'
Lime & shale	2703'	3164'
Shale	3164'	3470'
Lime & shale	3470'	4130'
Shale	4130'	4500'
Rotary total depth	4500'	

CASING RECORD <input type="checkbox"/> New <input type="checkbox"/> Used							
Report all strings set-conductor, surface, intermediate, production, etc.							
Purpose of String	Size Hole Drilled	Size Casing Set (in O.D.)	Weight Lbs/Ft.	Setting Depth	Type of Cement	#Sacks Used	Type and Percent Additives
CONDUCTOR		16"		80'	5-1/2 xds. grout		
SURFACE	14-3/4"	10-3/4"	40.5#	398'	Lite Class A	240 100	3% cc 3% cc

PERFORATION RECORD		Acid, Fracture, Shot, Cement Squeeze Record	
Shots Per Foot	Specify Footage of Each Interval Perforated	(Amount and Kind of Material Used)	Depth
	N/A		

TUBING RECORD			
Size	Set At	Packer at	Liner Run <input type="checkbox"/> Yes <input type="checkbox"/> No

Date of First Production	Producing Method			
N/A	<input type="checkbox"/> Flowing	<input type="checkbox"/> Pumping	<input type="checkbox"/> Gas Lift	<input type="checkbox"/> Other (explain) <u>Dry</u>
Estimated Production Per 24 Hours	Oil N/A Bbls	Gas N/A MCF	Water N/A Bbls	Gas-Oil Ratio N/A CFPB

METHOD OF COMPLETION

Production Interval

Disposition of gas: Vented Open Hole Perforation
 Sold Other (Specify)
 Used on Lease Dually Completed
 Commingled

